

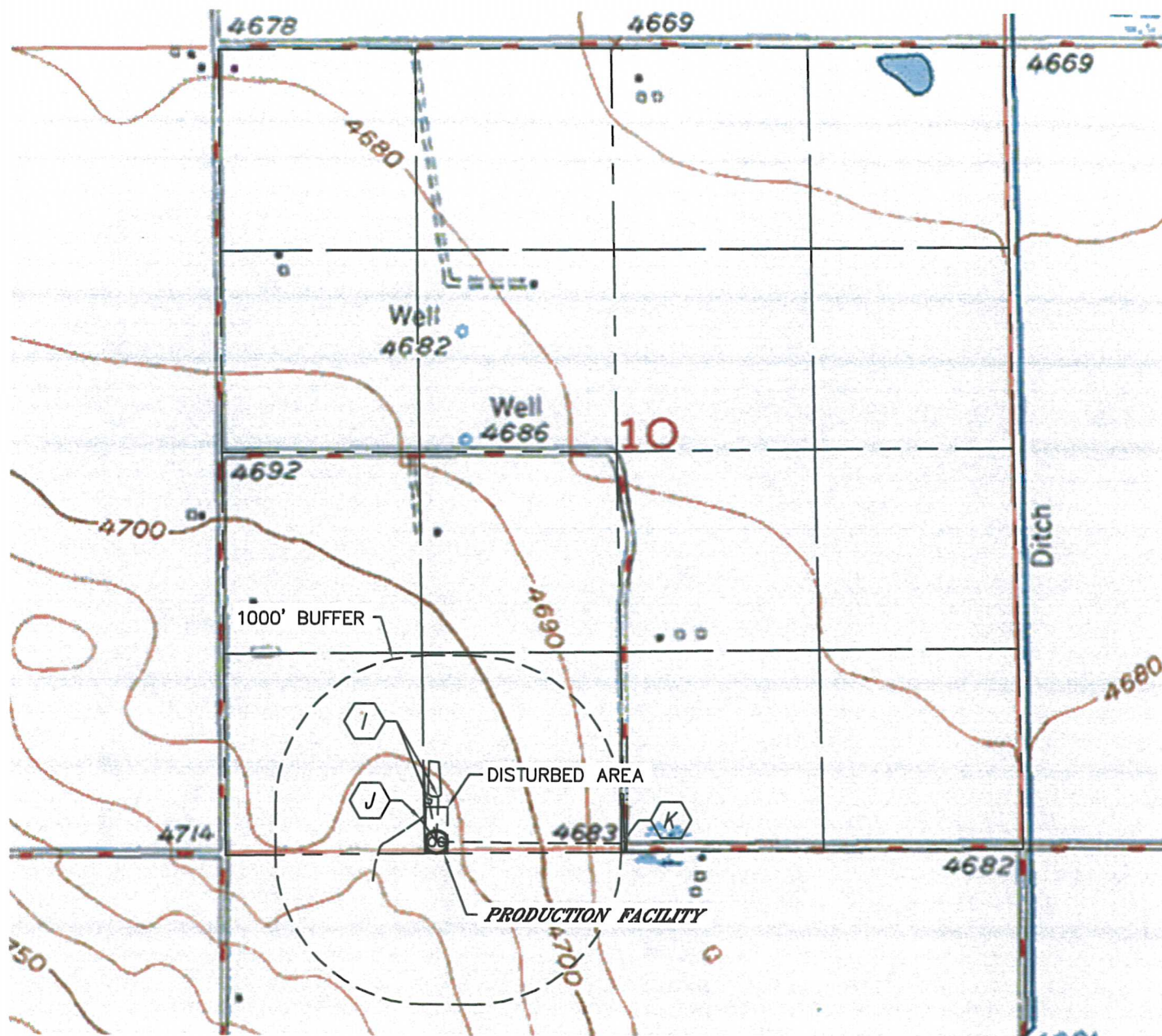

Lat40°, Inc. 1635 Foxtrail Drive, Suite 325 Loveland, CO 970-776-3321

PRODUCTION FACILITY HYDROLOGY MAP

MOSER PC G10-20D, 21D, 24D

SECTION: 10
TOWNSHIP: 4N
RANGE: 65W

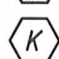

-  IRRIGATION POND 298' N, 255' NW
-  DITCH 184' NW
-  BARROW DITCH 1228' E

