



KERR MCGEE OIL & GAS ONSHORE LP

Location: COLORADO Slot: SLOT#12 SWEETGRASS 12-14A (2139'FSL & 710'FWL)
Field: WELD COUNTY (KERR MCGEE) Well: SWEETGRASS 12-14A
Facility: SEC.14-T1N-R68W Wellbore: SWEETGRASS 12-14A PWB



Not reference wellpath is SWEETGRASS 12-14A (REV-A.G) PWB	
True vertical depths are referenced to XTREME 12 (RWB)	Grid System: NAD83 / Lambert Colorado SP, Northern Zone (801), US feet
Measured depths are referenced to XTREME 12 (RWB)	North Reference: True north
XTREME 12 (RWB) to Mean Sea Level: 5130 feet	Scale: True distance
Mean Sea Level to Mud line (at Slot: SLOT#12 SWEETGRASS 12-14A (2139'FSL & 710'FWL)): 0 feet	Depths are in feet
Coordinates are in feet referenced to Slot	Created by: cookdam on 7/20/2011

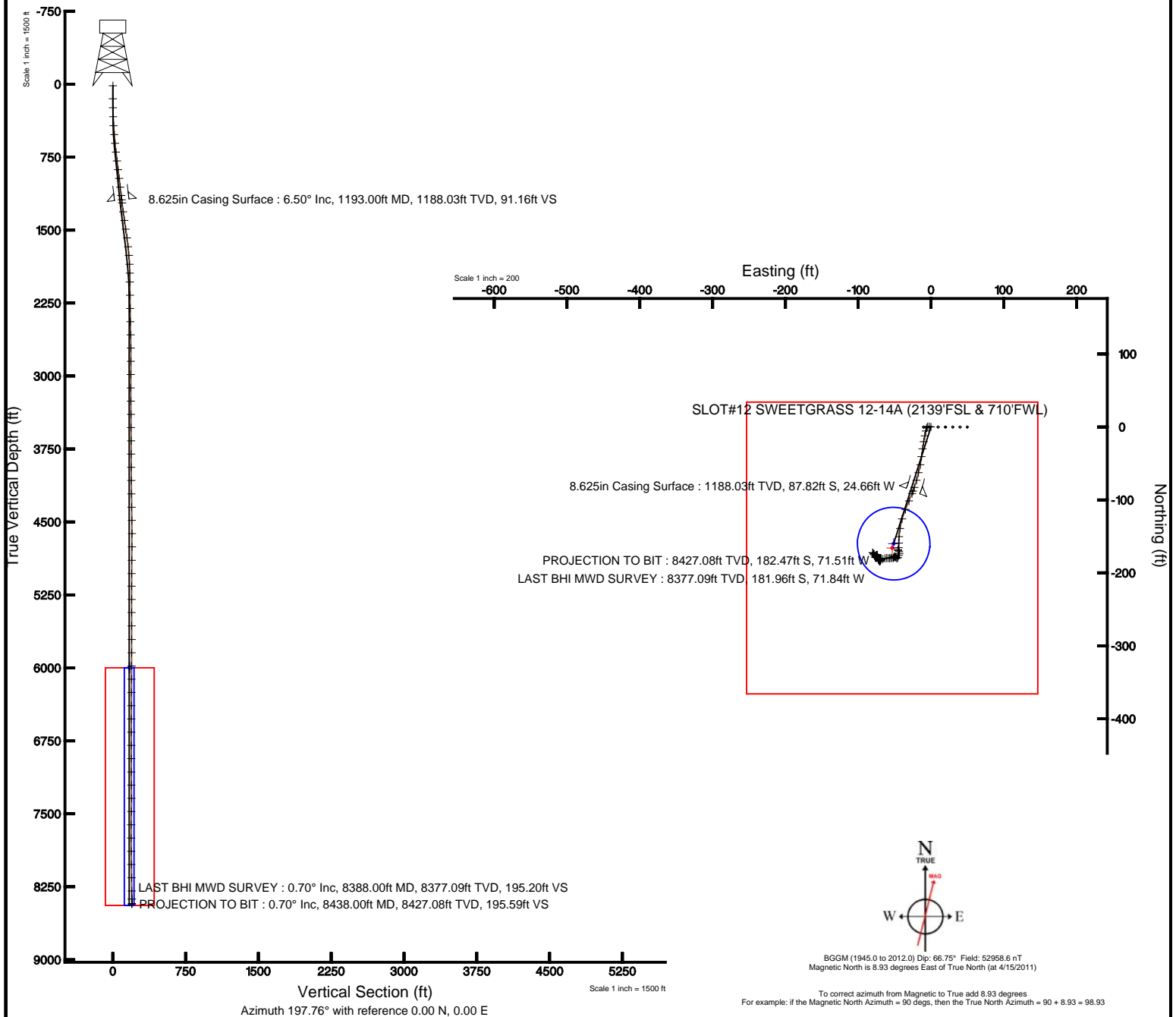



Actual Wellpath Report

SWEETGRASS 12-14A AWP

Page 1 of 4



REFERENCE WELLPATH IDENTIFICATION

Operator	KERR MCGEE OIL & GAS ONSHORE LP	Slot	SLOT#12 SWEETGRASS 12-14A (2139'FSL & 710'FWL)
Area	COLORADO	Well	SWEETGRASS 12-14A
Field	WELD COUNTY (KERR MCGEE)	Wellbore	SWEETGRASS 12-14A AWB
Facility	SEC.14-T1N-R68W		

REPORT SETUP INFORMATION

Projection System	NAD83 / Lambert Colorado SP, Northern Zone (501), US feet	Software System	WellArchitect® 3.0.0
North Reference	True	User	Cookdanm
Scale	0.999963	Report Generated	7/20/2011 at 2:54:48 PM
Convergence at slot	0.34° East	Database/Source file	WA_DENVER/SWEETGRASS_12-14A_AWB.xml

WELLPATH LOCATION

	Local coordinates		Grid coordinates		Geographic coordinates	
	North[ft]	East[ft]	Easting[US ft]	Northing[US ft]	Latitude	Longitude
Slot Location	201.73	-3721.22	3146281.91	1261439.84	40°02'59.489"N	104°58'38.878"W
Facility Reference Pt			3150004.14	1261260.61	40°02'57.498"N	104°57'51.026"W
Field Reference Pt			3197771.84	1268891.29	40°04'09.600"N	104°47'36.000"W

WELLPATH DATUM

Calculation method	Minimum curvature	XTREME 12 (RKB) to Facility Vertical Datum	5120.00ft
Horizontal Reference Pt	Slot	XTREME 12 (RKB) to Mean Sea Level	5120.00ft
Vertical Reference Pt	XTREME 12 (RKB)	XTREME 12 (RKB) to Mud Line at Slot (SLOT#12 SWEETGRASS 12-14A (2139'FSL & 710'FWL))	5120.00ft
MD Reference Pt	XTREME 12 (RKB)	Section Origin	N 0.00, E 0.00 ft
Field Vertical Reference	Mean Sea Level	Section Azimuth	197.76°



Actual Wellpath Report

SWEETGRASS 12-14A AWP

Page 2 of 4



REFERENCE WELLPATH IDENTIFICATION

Operator	KERR MCGEE OIL & GAS ONSHORE LP	Slot	SLOT#12 SWEETGRASS 12-14A (2139'FSL & 710'FWL)
Area	COLORADO	Well	SWEETGRASS 12-14A
Field	WELD COUNTY (KERR MCGEE)	Wellbore	SWEETGRASS 12-14A AWB
Facility	SEC.14-T1N-R68W		

WELLPATH DATA (72 stations) † = interpolated/extrapolated station

MD [ft]	Inclination [°]	Azimuth [°]	TVD [ft]	Vert Sect [ft]	North [ft]	East [ft]	DLS [°/100ft]	Comments
0.00†	0.000	286.500	0.00	0.00	0.00	0.00	0.00	
15.00	0.000	286.500	15.00	0.00	0.00	0.00	0.00	
149.00	1.900	286.500	148.98	0.05	0.63	-2.13	1.42	
242.00	1.100	242.900	241.95	0.71	0.66	-4.40	1.44	
334.00	1.900	206.700	333.92	2.84	-1.10	-5.87	1.31	
426.00	3.800	191.200	425.80	7.38	-5.46	-7.15	2.21	
518.00	4.700	191.200	517.54	14.15	-12.14	-8.48	0.98	
608.00	5.700	188.800	607.17	22.23	-20.18	-9.88	1.14	
699.00	6.700	190.200	697.64	31.96	-29.87	-11.51	1.11	
790.00	6.900	186.000	788.00	42.57	-40.53	-13.02	0.59	
881.00	7.400	189.800	878.29	53.72	-51.74	-14.59	0.76	
971.00	6.800	196.200	967.60	64.79	-62.57	-17.06	1.10	
1062.00	6.900	192.600	1057.95	75.62	-73.08	-19.76	0.48	
1148.00	6.900	201.100	1143.33	85.92	-82.94	-22.74	1.19	
1226.00	6.200	202.500	1220.82	94.80	-91.20	-26.04	0.92	
1317.00	7.700	201.400	1311.15	105.78	-101.42	-30.15	1.65	
1407.00	8.400	203.500	1400.27	118.34	-113.06	-34.97	0.84	
1498.00	9.000	196.200	1490.22	132.07	-125.99	-39.60	1.38	
1589.00	8.200	188.100	1580.20	145.58	-139.25	-42.51	1.59	
1680.00	5.900	184.900	1670.51	156.54	-150.34	-43.82	2.56	
1770.00	5.300	178.200	1760.08	164.97	-159.10	-44.08	0.98	
1861.00	2.800	191.600	1850.85	171.14	-165.48	-44.40	2.92	
1952.00	1.000	208.500	1941.79	174.13	-168.36	-45.22	2.05	
2043.00	0.700	117.800	2032.79	175.00	-169.31	-45.11	1.35	
2179.00	1.100	156.100	2168.77	176.12	-170.89	-43.85	0.52	
2315.00	1.000	183.500	2304.75	178.25	-173.27	-43.39	0.37	
2451.00	1.100	207.800	2440.73	180.69	-175.61	-44.07	0.33	
2587.00	1.700	195.500	2576.68	183.99	-178.71	-45.22	0.49	
2723.00	0.800	298.500	2712.66	185.83	-180.20	-46.59	1.50	
2859.00	0.600	309.400	2848.65	185.39	-179.30	-47.98	0.18	
2995.00	0.600	312.900	2984.64	184.82	-178.36	-49.05	0.03	
3132.00	0.600	312.900	3121.64	184.21	-177.38	-50.10	0.00	
3268.00	1.400	189.100	3257.62	185.55	-178.54	-50.89	1.33	
3404.00	0.700	304.100	3393.61	186.96	-179.71	-51.84	1.33	
3540.00	0.800	263.700	3529.60	187.11	-179.35	-53.47	0.39	
3676.00	0.600	258.400	3665.59	187.85	-179.60	-55.11	0.15	
3813.00	0.800	260.800	3802.58	188.64	-179.90	-56.76	0.15	
3949.00	0.900	274.900	3938.56	189.30	-179.96	-58.76	0.17	
4085.00	0.900	273.100	4074.55	189.81	-179.81	-60.89	0.02	
4222.00	1.000	257.300	4211.53	190.69	-180.01	-63.13	0.20	
4359.00	1.600	246.400	4348.49	192.56	-181.04	-66.05	0.47	
4495.00	1.800	240.800	4484.43	195.38	-182.84	-69.65	0.19	
4631.00	0.700	125.800	4620.41	197.20	-184.37	-70.84	1.61	
4767.00	0.900	31.600	4756.40	196.42	-183.95	-69.61	0.87	
4905.00	0.800	11.200	4894.39	194.41	-182.08	-68.86	0.23	
5041.00	0.500	345.900	5030.38	192.96	-180.57	-68.82	0.30	
5171.00	0.400	273.200	5160.38	192.59	-180.00	-69.41	0.41	
5307.00	0.800	266.100	5296.37	193.06	-180.04	-70.83	0.30	
5442.00	0.700	284.300	5431.36	193.46	-179.90	-72.57	0.19	
5580.00	0.800	288.300	5569.34	193.50	-179.39	-74.30	0.08	
5719.00	0.800	287.200	5708.33	193.50	-178.79	-76.15	0.01	
5855.00	0.600	100.000	5844.33	193.41	-178.64	-76.35	1.03	
5991.00	0.400	32.300	5980.32	192.86	-178.36	-75.40	0.43	
6128.00	0.400	59.400	6117.32	192.04	-177.71	-74.73	0.14	
6264.00	0.400	20.400	6253.32	191.21	-177.03	-74.16	0.20	
6400.00	0.300	334.300	6389.31	190.48	-176.26	-74.15	0.21	
6536.00	0.200	20.000	6525.31	189.98	-175.72	-74.22	0.16	
6672.00	0.300	252.800	6661.31	189.95	-175.60	-74.48	0.33	
6808.00	0.400	78.400	6797.31	189.92	-175.61	-74.35	0.51	
6944.00	0.200	61.900	6933.31	189.52	-175.40	-73.68	0.16	



Actual Wellpath Report

SWEETGRASS 12-14A AWP

Page 3 of 4



REFERENCE WELLPATH IDENTIFICATION

Operator	KERR MCGEE OIL & GAS ONSHORE LP	Slot	SLOT#12 SWEETGRASS 12-14A (2139'FSL & 710'FWL)
Area	COLORADO	Well	SWEETGRASS 12-14A
Field	WELD COUNTY (KERR MCGEE)	Wellbore	SWEETGRASS 12-14A AWB
Facility	SEC.14-T1N-R68W		

WELLPATH DATA (72 stations)

MD [ft]	Inclination [°]	Azimuth [°]	TVD [ft]	Vert Sect [ft]	North [ft]	East [ft]	DLS [°/100ft]	Comments
7081.00	0.400	249.900	7070.31	189.64	-175.45	-73.92	0.44	
7217.00	1.100	246.100	7206.30	190.80	-176.14	-75.56	0.52	
7353.00	0.600	281.600	7342.28	191.74	-176.53	-77.45	0.52	
7489.00	1.700	344.200	7478.26	190.14	-174.45	-78.69	1.12	
7625.00	0.600	282.600	7614.23	188.52	-172.35	-79.94	1.11	
7761.00	0.600	107.900	7750.23	188.59	-172.41	-79.96	0.88	
7897.00	1.400	134.600	7886.21	189.34	-173.80	-78.09	0.67	
8033.00	1.700	128.600	8022.16	190.81	-176.22	-75.34	0.25	
8169.00	1.200	156.100	8158.11	192.59	-178.78	-73.18	0.62	
8305.00	0.800	161.000	8294.09	194.41	-180.98	-72.30	0.30	
8388.00	0.700	147.600	8377.09	195.20	-181.96	-71.84	0.24	LAST BHI MWD SURVEY
8438.00	0.700	147.600	8427.08	195.59	-182.47	-71.51	0.00	PROJECTION TO BIT

HOLE & CASING SECTIONS - Ref Wellbore: SWEETGRASS 12-14A AWB Ref Wellpath: SWEETGRASS 12-14A AWP

String/Diameter	Start MD [ft]	End MD [ft]	Interval [ft]	Start TVD [ft]	End TVD [ft]	Start N/S [ft]	Start E/W [ft]	End N/S [ft]	End E/W [ft]
12.25in Open Hole	15.00	1203.00	1188.00	15.00	1197.96	0.00	0.00	-88.86	-25.08
8.625in Casing Surface	15.00	1193.00	1178.00	15.00	1188.03	0.00	0.00	-87.82	-24.66
7.875in Open Hole	1203.00	8438.00	7235.00	1197.96	8427.08	-88.86	-25.08	-182.47	-71.51

TARGETS

Name	MD [ft]	TVD [ft]	North [ft]	East [ft]	Grid East [US ft]	Grid North [US ft]	Latitude	Longitude	Shape
SWEETGRASS 12-14A GEO TARGET 50' RADIUS (1980'FSL & 660'FWL, REV-1)		6000.00	-159.96	-51.20	3146231.65	1261279.58	40°02'57.908"N	104°58'39.536"W	circle
SWEETGRASS 12-14A LEGAL BOX (194'N,206'S,198'E,202'W FROM GEO TARGET)		6000.00	-165.92	-53.23	3146229.66	1261273.62	40°02'57.849"N	104°58'39.562"W	square

WELLPATH COMPOSITION - Ref Wellbore: SWEETGRASS 12-14A AWB Ref Wellpath: SWEETGRASS 12-14A AWP

Start MD [ft]	End MD [ft]	Positional Uncertainty Model	Log Name/Comment	Wellbore
15.00	8388.00	NaviTrak (Standard)	BHI MWD SURVEYS <149-8388>	SWEETGRASS 12-14A AWB
8388.00	8438.00	Blind Drilling (std)	Projection to bit	SWEETGRASS 12-14A AWB



Actual Wellpath Report

SWEETGRASS 12-14A AWP

Page 4 of 4



REFERENCE WELLPATH IDENTIFICATION			
Operator	KERR MCGEE OIL & GAS ONSHORE LP	Slot	SLOT#12 SWEETGRASS 12-14A (2139'FSL & 710'FWL)
Area	COLORADO	Well	SWEETGRASS 12-14A
Field	WELD COUNTY (KERR MCGEE)	Wellbore	SWEETGRASS 12-14A AWP
Facility	SEC.14-T1N-R68W		

WELLPATH COMMENTS				
MD [ft]	Inclination [°]	Azimuth [°]	TVD [ft]	Comment
8388.00	0.700	147.600	8377.09	LAST BHI MWD SURVEY
8438.00	0.700	147.600	8427.08	PROJECTION TO BIT