



KERR MCGEE OIL & GAS ONSHORE LP

Location: COLORADO Slot: SLOT#09 BADDING 9-35SX (952'FSL & 1565'FEL)
 Field: WELD COUNTY (KERR MCGEE) Well: BADDING 9-35SX
 Facility: SEC.35-T2N-R66W Wellbore: BADDING 9-35SX PWB



Bit reference wellbore is BADDING 9-35SX (REV 8.0) PWB	
True vertical depths are referenced to XTREME 15 (RKB)	Grid System: NAD83 / Lambert Colorado SP, Northern Zone (501), US feet
Measured depths are referenced to XTREME 15 (RKB)	North Reference: True north
XTREME 15 (RKB) to Mean Sea Level: 5100 feet	Scale: True distance
Mean Sea Level to Mud line (At Slot: SLOT#09 BADDING 9-35SX (952'FSL & 1565'FEL)): 0 feet	Depths are in feet
Coordinates are in feet referenced to Slot	Created by: cookdam on 6/27/2011

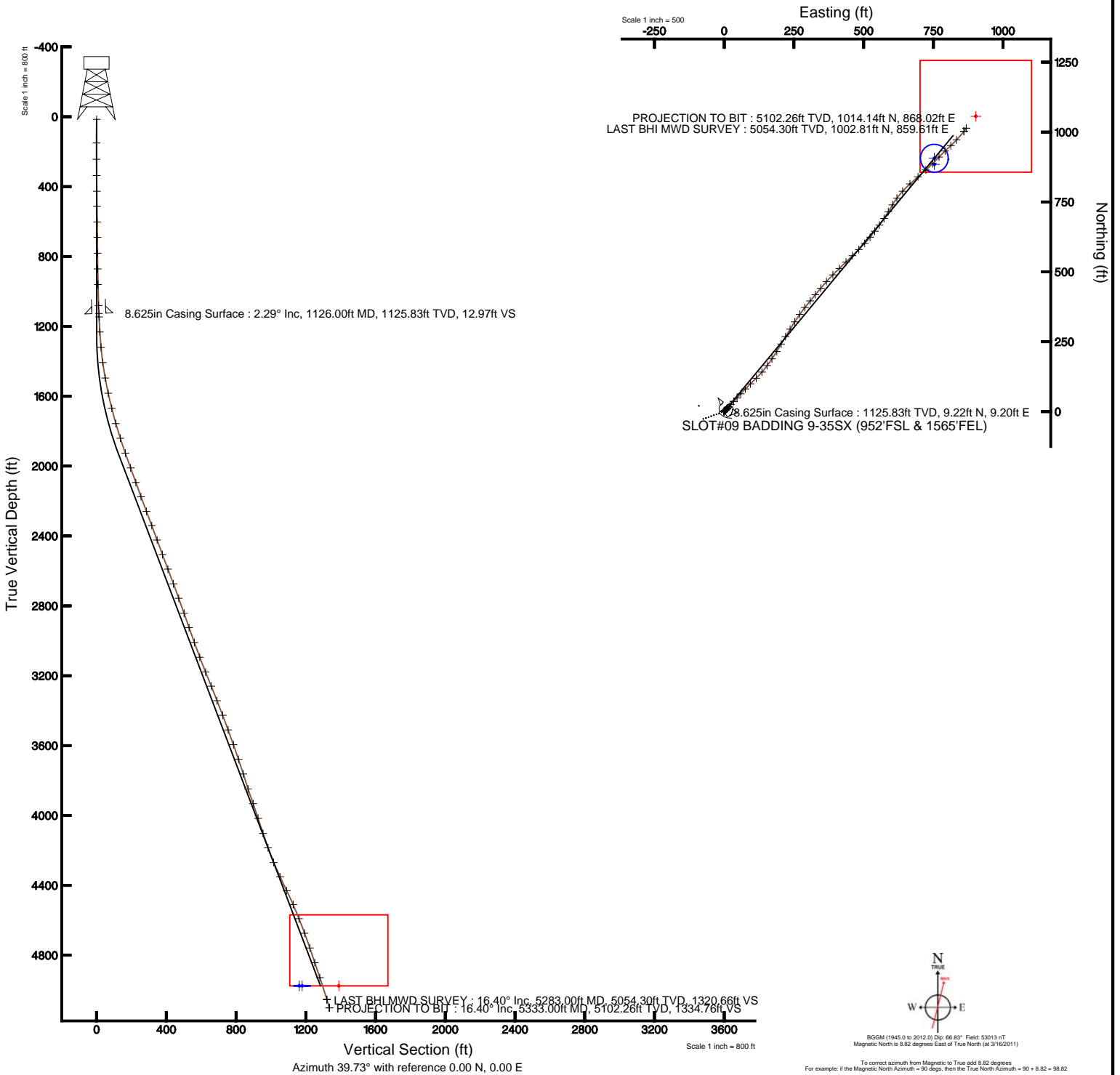



Actual Wellpath Report

BADDING 9-35SX awp

Page 1 of 5



REFERENCE WELLPATH IDENTIFICATION

Operator	KERR MCGEE OIL & GAS ONSHORE LP	Slot	SLOT#09 BADDING 9-35SX (952'FSL & 1565'FEL)
Area	COLORADO	Well	BADDING 9-35SX
Field	WELD COUNTY (KERR MCGEE)	Wellbore	BADDING 9-35SX awb
Facility	SEC.35-T2N-R66W		

REPORT SETUP INFORMATION

Projection System	NAD83 / Lambert Colorado SP, Northern Zone (501), US feet	Software System	WellArchitect® 3.0.0
North Reference	True	User	Cookdanm
Scale	0.999961	Report Generated	6/27/2011 at 10:14:28 PM
Convergence at slot	0.49° East	Database/Source file	WA_DENVER/BADDING_9-35SX_awb.xml

WELLPATH LOCATION

	Local coordinates		Grid coordinates		Geographic coordinates	
	North[ft]	East[ft]	Easting[US ft]	Northing[US ft]	Latitude	Longitude
Slot Location	26.96	75.26	3212512.08	1276531.97	40°05'23.903"N	104°44'25.559"W
Facility Reference Pt			3212437.05	1276504.37	40°05'23.636"N	104°44'26.527"W
Field Reference Pt			3197771.84	1268891.29	40°04'09.600"N	104°47'36.000"W

WELLPATH DATUM

Calculation method	Minimum curvature	XTREME 15 (RKB) to Facility Vertical Datum	5100.00ft
Horizontal Reference Pt	Slot	XTREME 15 (RKB) to Mean Sea Level	5100.00ft
Vertical Reference Pt	XTREME 15 (RKB)	XTREME 15 (RKB) to Mud Line at Slot (SLOT#09 BADDING 9-35SX (952'FSL & 1565'FEL))	5100.00ft
MD Reference Pt	XTREME 15 (RKB)	Section Origin	N 0.00, E 0.00 ft
Field Vertical Reference	Mean Sea Level	Section Azimuth	39.73°



Actual Wellpath Report

BADDING 9-35SX awp

Page 2 of 5



REFERENCE WELLPATH IDENTIFICATION

Operator	KERR MCGEE OIL & GAS ONSHORE LP	Slot	SLOT#09 BADDING 9-35SX (952'FSL & 1565'FEL)
Area	COLORADO	Well	BADDING 9-35SX
Field	WELD COUNTY (KERR MCGEE)	Wellbore	BADDING 9-35SX awb
Facility	SEC.35-T2N-R66W		

WELLPATH DATA (61 stations) † = interpolated/extrapolated station

MD [ft]	Inclination [°]	Azimuth [°]	TVD [ft]	Vert Sect [ft]	North [ft]	East [ft]	DLS [°/100ft]	Comments
0.00†	0.000	242.600	0.00	0.00	0.00	0.00	0.00	
15.00	0.000	242.600	15.00	0.00	0.00	0.00	0.00	
150.00	0.900	242.600	149.99	-0.98	-0.49	-0.94	0.67	
243.00	0.400	12.300	242.99	-1.36	-0.51	-1.52	1.29	
336.00	0.800	31.000	335.99	-0.43	0.37	-1.12	0.47	
426.00	0.700	50.600	425.98	0.73	1.25	-0.37	0.30	
513.00	1.000	46.800	512.97	2.00	2.11	0.60	0.35	
602.00	0.600	53.100	601.96	3.23	2.92	1.53	0.46	
690.00	0.500	45.700	689.96	4.06	3.47	2.18	0.14	
781.00	0.600	57.000	780.95	4.91	4.00	2.86	0.16	
871.00	0.800	60.100	870.94	5.95	4.57	3.80	0.23	
960.00	1.100	54.200	959.93	7.36	5.38	5.03	0.35	
1081.00	2.500	46.800	1080.87	11.10	7.87	7.90	1.17	
1146.00	2.200	38.000	1145.82	13.75	9.82	9.70	0.72	
1232.00	3.400	45.400	1231.71	17.94	12.91	12.53	1.45	
1321.00	5.600	43.300	1320.43	24.90	17.93	17.39	2.48	
1408.00	7.700	41.900	1406.84	34.97	25.36	24.19	2.42	
1498.00	10.400	44.000	1495.71	49.09	35.69	33.87	3.02	
1587.00	12.000	42.200	1583.02	66.35	48.32	45.66	1.84	
1675.00	14.200	41.900	1668.72	86.28	63.14	59.02	2.50	
1766.00	16.100	44.000	1756.55	110.02	80.52	75.24	2.17	
1854.00	18.200	46.100	1840.64	135.85	98.83	93.62	2.49	
1944.00	19.500	45.700	1925.81	164.75	119.07	114.50	1.45	
2034.00	19.600	41.500	2010.62	194.78	140.87	135.25	1.57	
2122.00	20.100	35.500	2093.40	224.62	164.23	153.81	2.38	
2209.00	19.800	35.200	2175.18	254.22	188.44	170.99	0.36	
2299.00	21.200	32.000	2259.48	285.54	214.70	188.40	1.99	
2386.00	20.600	29.900	2340.76	316.21	241.31	204.37	1.10	
2474.00	20.200	30.300	2423.24	346.45	267.85	219.75	0.48	
2563.00	20.800	32.700	2506.61	377.29	294.42	236.04	1.16	
2652.00	20.600	32.000	2589.86	408.49	320.99	252.87	0.36	
2742.00	21.100	35.500	2673.97	440.34	347.61	270.67	1.49	
2830.00	19.600	38.700	2756.48	470.89	372.02	289.10	2.12	
2921.00	19.300	38.300	2842.29	501.19	395.74	307.96	0.36	
3009.00	19.200	41.200	2925.37	530.19	418.04	326.51	1.09	
3099.00	20.100	39.400	3010.13	560.45	441.13	346.07	1.21	
3189.00	20.800	41.500	3094.45	591.89	465.04	366.48	1.13	
3280.00	22.100	45.400	3179.15	625.08	489.17	389.37	2.12	
3367.00	21.800	46.400	3259.85	657.41	511.80	412.73	0.55	
3457.00	21.600	44.700	3343.47	690.51	535.10	436.48	0.73	
3546.00	21.100	46.800	3426.36	722.73	557.71	459.68	1.03	
3636.00	20.000	44.700	3510.64	754.14	579.74	482.32	1.47	
3726.00	20.200	43.600	3595.16	784.98	601.93	503.86	0.48	
3815.00	17.900	38.700	3679.28	813.99	623.74	523.01	3.15	
3903.00	17.800	37.300	3763.05	840.95	644.99	539.62	0.50	



Actual Wellpath Report

BADDING 9-35SX awp

Page 3 of 5



REFERENCE WELLPATH IDENTIFICATION

Operator	KERR MCGEE OIL & GAS ONSHORE LP	Slot	SLOT#09 BADDING 9-35SX (952'FSL & 1565'FEL)
Area	COLORADO	Well	BADDING 9-35SX
Field	WELD COUNTY (KERR MCGEE)	Wellbore	BADDING 9-35SX awb
Facility	SEC.35-T2N-R66W		

WELLPATH DATA (61 stations)

MD [ft]	Inclination [°]	Azimuth [°]	TVD [ft]	Vert Sect [ft]	North [ft]	East [ft]	DLS [°/100ft]	Comments
3993.00	18.200	37.300	3848.64	868.74	667.12	556.47	0.44	
4082.00	19.900	31.700	3932.77	897.62	691.06	572.86	2.80	
4171.00	17.800	33.800	4016.99	926.16	715.26	588.38	2.48	
4262.00	19.300	29.900	4103.27	954.81	739.85	603.62	2.14	
4349.00	18.900	36.700	4185.49	983.05	763.62	619.21	2.60	
4439.00	23.200	42.200	4269.47	1015.34	788.45	639.84	5.25	
4529.00	25.500	47.500	4351.47	1052.25	814.68	666.04	3.52	
4617.00	26.300	49.900	4430.63	1090.21	840.04	694.92	1.50	
4705.00	24.000	48.200	4510.28	1127.11	864.52	723.18	2.74	
4793.00	21.400	45.400	4591.46	1160.79	887.73	747.95	3.20	
4882.00	21.100	43.300	4674.41	1192.94	910.79	770.50	0.92	
4972.00	18.500	46.800	4759.09	1223.28	932.36	792.02	3.17	
5061.00	18.600	46.400	4843.46	1251.39	951.81	812.60	0.18	
5151.00	19.200	44.300	4928.61	1280.40	972.30	833.33	1.01	
5283.00	16.400	36.600	5054.30	1320.66	1002.81	859.61	2.77	LAST BHI MWD SURVEY
5333.00	16.400	36.600	5102.26	1334.76	1014.14	868.02	0.00	PROJECTION TO BIT

HOLE & CASING SECTIONS - Ref Wellbore: BADDING 9-35SX awb Ref Wellpath: BADDING 9-35SX awp

String/Diameter	Start MD [ft]	End MD [ft]	Interval [ft]	Start TVD [ft]	End TVD [ft]	Start N/S [ft]	Start E/W [ft]	End N/S [ft]	End E/W [ft]
12.25in Open Hole	15.00	1136.00	1121.00	15.00	1135.82	0.00	0.00	9.52	9.46
8.625in Casing Surface	15.00	1126.00	1111.00	15.00	1125.83	0.00	0.00	9.22	9.20
7.875in Open Hole	1126.00	5333.00	4207.00	1125.83	5102.26	9.22	9.20	1014.14	868.02



Actual Wellpath Report

BADDING 9-35SX awp

Page 4 of 5



REFERENCE WELLPATH IDENTIFICATION

Operator	KERR MCGEE OIL & GAS ONSHORE LP	Slot	SLOT#09 BADDING 9-35SX (952'FSL & 1565'FEL)
Area	COLORADO	Well	BADDING 9-35SX
Field	WELD COUNTY (KERR MCGEE)	Wellbore	BADDING 9-35SX awb
Facility	SEC.35-T2N-R66W		

TARGETS

Name	MD [ft]	TVD [ft]	North [ft]	East [ft]	Grid East [US ft]	Grid North [US ft]	Latitude	Longitude	Shape
BADDING 9-35SX BHL ON PLAT (1830'FSL & 810'FEL, REV-1)		4976.00	884.51	753.46	3213257.91	1277422.87	40°05'32.644"N	104°44'15.864"W	point
BADDING 9-35SX GEO TARGET 50' RADIUS (1852'FSL & 810'FEL, REV-2)		4976.00	906.51	753.46	3213257.72	1277444.86	40°05'32.861"N	104°44'15.864"W	circle
BADDING 9-35SX LEGAL BOX (50'S,350'N,51'W,349'E OF GEO TARGET)		4976.00	1056.51	902.46	3213405.42	1277596.13	40°05'34.343"N	104°44'13.947"W	square

WELLPATH COMPOSITION - Ref Wellbore: BADDING 9-35SX awb Ref Wellpath: BADDING 9-35SX awp

Start MD [ft]	End MD [ft]	Positional Uncertainty Model	Log Name/Comment	Wellbore
15.00	1081.00	NaviTrak (Standard)	BHI MWD NAVITRAK 12.25 HOLE <150-1081>	BADDING 9-35SX awb
1081.00	5283.00	NaviTrak (Standard)	BHI MWD NAVITRAK 7.875 HOLE <1146-5283>	BADDING 9-35SX awb
5283.00	5333.00	Blind Drilling (std)	Projection to bit	BADDING 9-35SX awb



Actual Wellpath Report

BADDING 9-35SX awp

Page 5 of 5



REFERENCE WELLPATH IDENTIFICATION

Operator	KERR MCGEE OIL & GAS ONSHORE LP	Slot	SLOT#09 BADDING 9-35SX (952'FSL & 1565'FEL)
Area	COLORADO	Well	BADDING 9-35SX
Field	WELD COUNTY (KERR MCGEE)	Wellbore	BADDING 9-35SX awb
Facility	SEC.35-T2N-R66W		

WELLPATH COMMENTS

MD [ft]	Inclination [°]	Azimuth [°]	TVD [ft]	Comment
5283.00	16.400	36.600	5054.30	LAST BHI MWD SURVEY
5333.00	16.400	36.600	5102.26	PROJECTION TO BIT