

Encana OIL & GAS (USA) INC.

LOCATION DRAWING FOR

WELL PAD 004 696

SECTION 4, T6S, R96W, 6th P.M.

NW 1/4 SE 1/4

SCALE: 1" = 200'
 DATE: 05-23-11
 DRAWN BY: D.R.B.
 Revised: 06-27-11 D.R.B.
 Revised: 09-08-11 D.R.B.

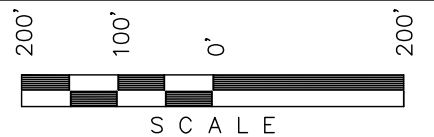

Sheet 7a of 11



1/4 Section Line



Encana Oil & Gas (USA) Inc.

Lot 9

Lot 8

400' Offset from edge of Disturbance

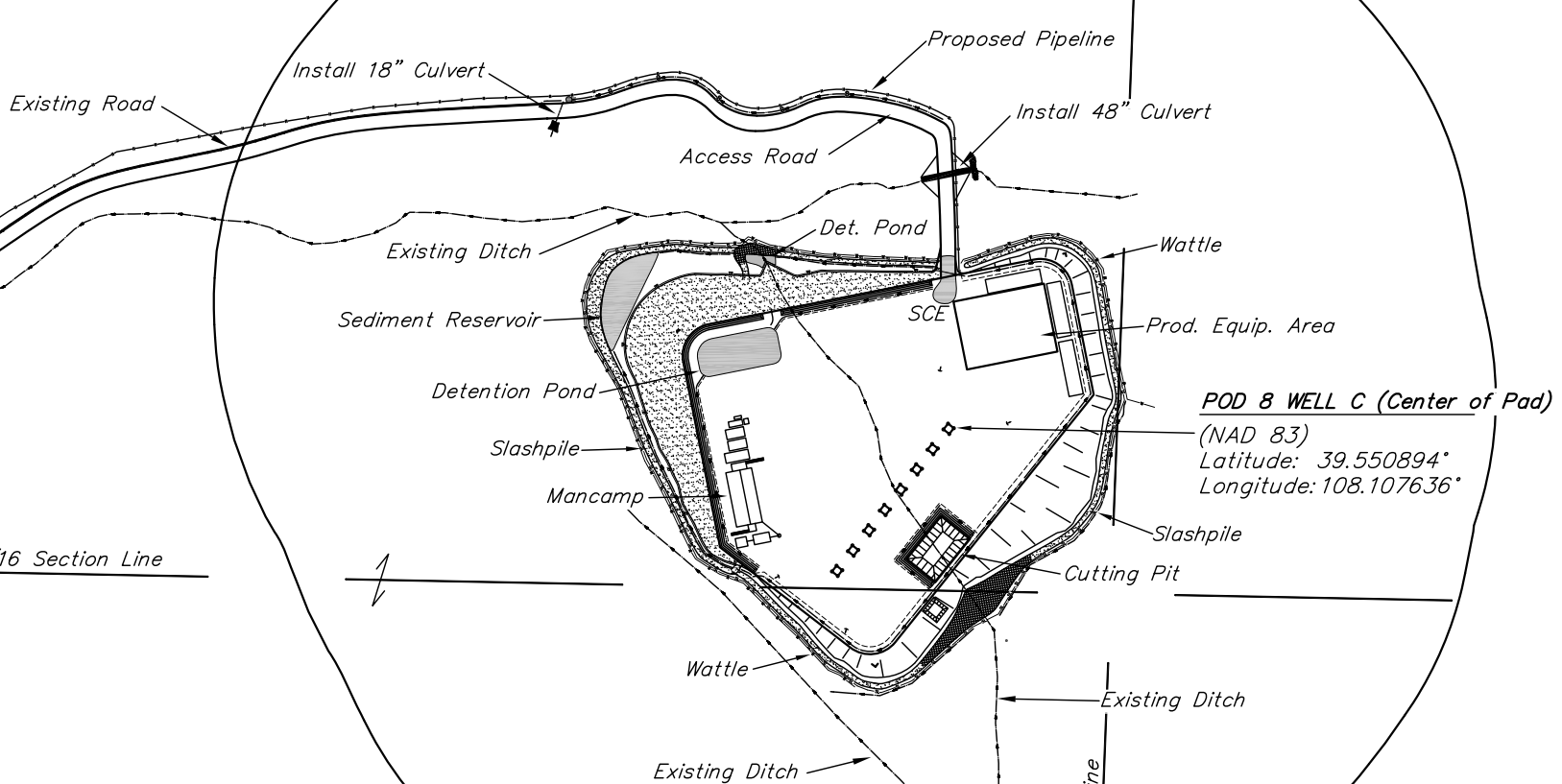

Encana Oil & Gas (USA) Inc.

DISTURBANCE ACREAGE:
 2.863 ± DRILLING OPERATIONS
 1.741 ± INTERIM RECLAIM

Lot 13

Lot 14

CURRENT LAND USE	
CROP LAND:	<input type="checkbox"/> IRRIGATED <input type="checkbox"/> DRY LAND <input type="checkbox"/> IMPROVED PASTURE <input type="checkbox"/> HAY MEADOW <input type="checkbox"/> CRP
NON-CROP LAND:	<input checked="" type="checkbox"/> RANGELAND <input type="checkbox"/> TIMBER <input type="checkbox"/> RECREATIONAL <input type="checkbox"/> OTHER (Describe)
SUBDIVIDED:	<input type="checkbox"/> INDUSTRIAL <input type="checkbox"/> COMMERCIAL <input type="checkbox"/> RESIDENTIAL

FUTURE LAND USE	
CROP LAND:	<input type="checkbox"/> IRRIGATED <input type="checkbox"/> DRY LAND <input type="checkbox"/> IMPROVED PASTURE <input type="checkbox"/> HAY MEADOW <input type="checkbox"/> CRP
NON-CROP LAND:	<input checked="" type="checkbox"/> RANGELAND <input type="checkbox"/> TIMBER <input type="checkbox"/> RECREATIONAL <input type="checkbox"/> OTHER (Describe)
SUBDIVIDED:	<input type="checkbox"/> INDUSTRIAL <input type="checkbox"/> COMMERCIAL <input type="checkbox"/> RESIDENTIAL

PLANT COMMUNITY	Existing Features (Distance from POD 8 WELL C)	
<input type="checkbox"/> DISTURBED GRASSLAND	Building	N15°W 5,660'
<input type="checkbox"/> NATIVE GRASSLAND	Public Road	N84°W 2,550'
<input type="checkbox"/> SHRUB LAND	Property Line	S62°W 2,222'
<input type="checkbox"/> PLAINS RIPARIAN	Utility	N84°W 2,694'
<input type="checkbox"/> MOUNTAIN RIPARIAN	Surface Water	N81°W 3,212'
<input checked="" type="checkbox"/> FOREST LAND	Railroad	S10°E 28,540'
<input type="checkbox"/> WETLANDS AQUATIC		
<input type="checkbox"/> ALPINE		
<input type="checkbox"/> OTHER (Describe):		

SE Cor Sec 4
 1912 Brass Cap
 1.5' High
 Lat: 39.546703°
 Long: 108.102369°

True Position

Section Line

W.C. 1912 Brass
 Cap 1.5' High
 Lat: 39.546711°
 Long: 108.110881°

N89°56'20"W - 2719.79' (Meas.)