

QUICKSILVER RESOURCES, INC.
K-DIAMOND RANCH #32-10
LOCATED IN MOFFAT COUNTY, COLORADO
SECTION 10, T6N, R93W, 6th P.M.

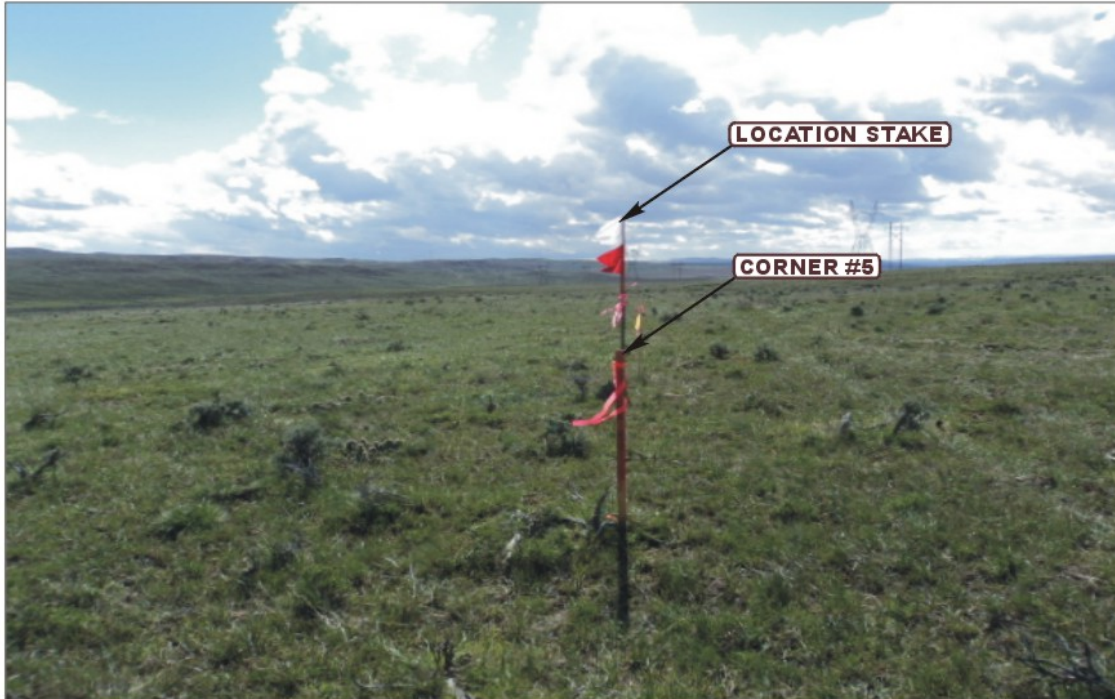

PHOTO: VIEW FROM CORNER #5 TO LOCATION STAKE

CAMERA ANGLE: SOUTHEASTERLY



PHOTO: VIEW FROM BEGINNING OF PROPOSED ACCESS

CAMERA ANGLE: NORTHERLY



UELS Uintah Engineering & Land Surveying
85 South 200 East Vernal, Utah 84078
(435) 789-1017 * FAX (435) 789-1813

LOCATION PHOTOS

05 **28** **11**
MONTH DAY YEAR

PHOTO
P1

TAKEN BY: G.M.

DRAWN BY: S.F.

REVISED: 00-00-00

QUICKSILVER RESOURCES, INC.
K-DIAMOND RANCH #32-10
LOCATED IN MOFFAT COUNTY, COLORADO
SECTION 10, T6N, R93W, 6th P.M.



PHOTO: VIEW OF LOCATION STAKE

CAMERA ANGLE: NORTHERLY



PHOTO: VIEW OF LOCATION STAKE

CAMERA ANGLE: EASTERLY



Uintah Engineering & Land Surveying
85 South 200 East Vernal, Utah 84078
(435) 789-1017 * FAX (435) 789-1813

LOCATION PHOTOS

05 28 11
MONTH DAY YEAR

PHOTO
P2

TAKEN BY: G.M.

DRAWN BY: S.F.

REVISED: 00-00-00

QUICKSILVER RESOURCES, INC.
K-DIAMOND RANCH #32-10
LOCATED IN MOFFAT COUNTY, COLORADO
SECTION 10, T6N, R93W, 6th P.M.



PHOTO: VIEW OF LOCATION STAKE

CAMERA ANGLE: SOUTHERLY



PHOTO: VIEW OF LOCATION STAKE

CAMERA ANGLE: WESTERLY



UELS Uintah Engineering & Land Surveying
85 South 200 East Vernal, Utah 84078
(435) 789-1017 * FAX (435) 789-1813

LOCATION PHOTOS

05 **28** **11**
MONTH DAY YEAR

PHOTO
P3

TAKEN BY: G.M.

DRAWN BY: S.F.

REVISED: 00-00-00