

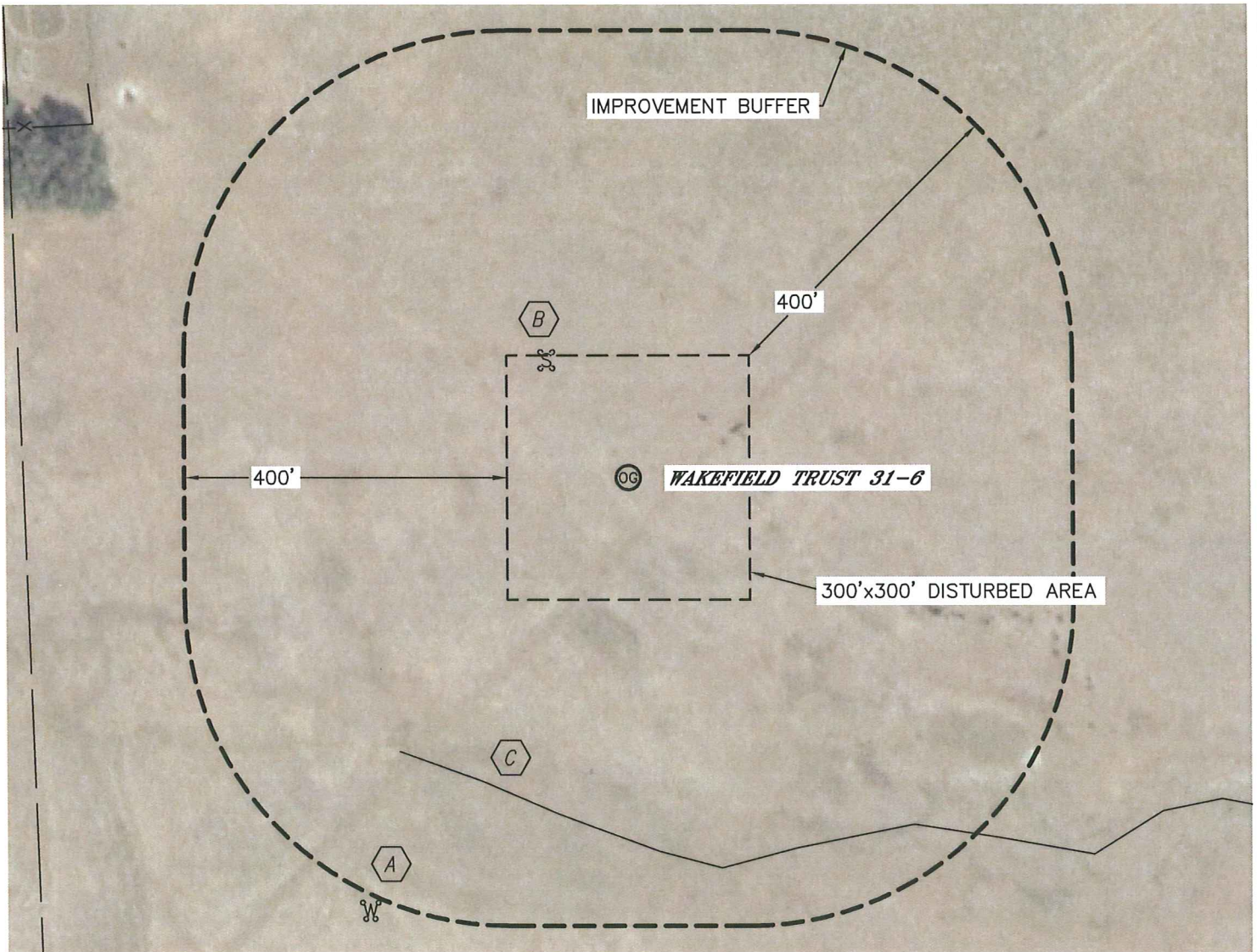



LOCATION DRAWING

WAKEFIELD TRUST 31-6

SECTION: 6
TOWNSHIP: 1S
RANGE: 45W



-  WOOD POST 621'SW
-  STEEL POST 176'NW
-  CENTERLINE NORTH FORK REPUBLICAN RIVER 410'SW

NEAREST:
BUILDING=940' NW
PUBLIC ROAD=743' N
ABOVE GROUND UTILITY=720' N
RAILROAD=5280'+ N
PROPERTY LINE=750' N

