

Anadarko, Weld County CO

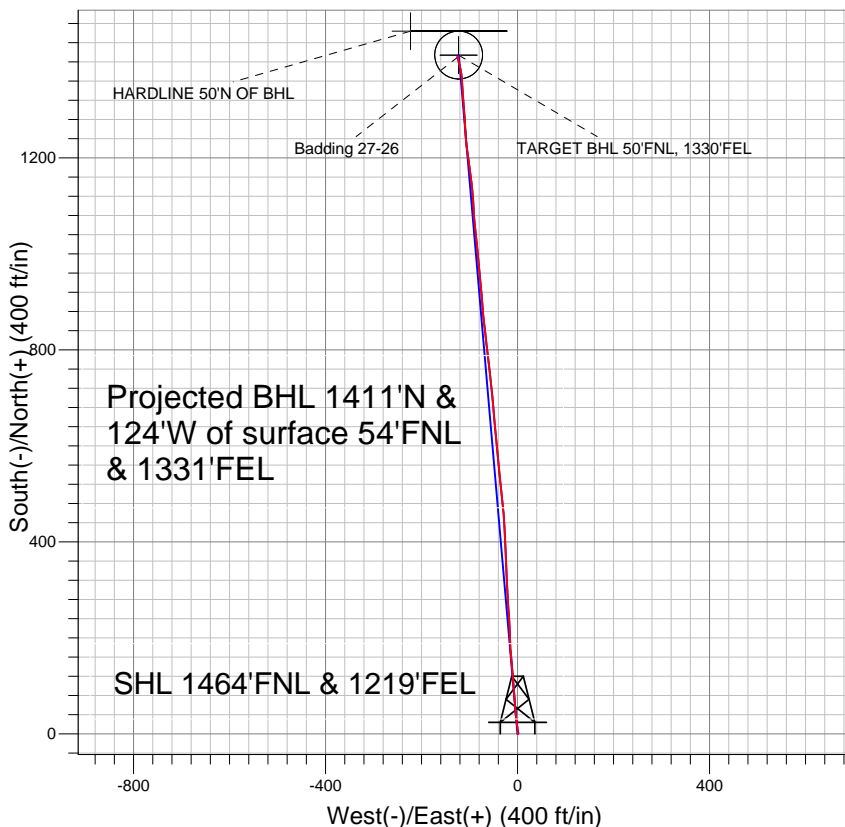

LEGEND

- ✕ Badding 27-26, Wellbore #1, Plan #1 (5-9-11) V0
- Wellbore #1
- Survey #1

Final Survey Plot

Projected Final Survey -
8319'MD & 8113'TVD @ 1416'VS
0.1 deg Inc 101.0 deg AZ

Project: SEC.26-T2N-R66W
Site: Badding 17-26 Pad Sec.26-T2N-R66W
Well: Badding 27-26
Plan: Wellbore #1



Anadarko, Weld County CO

SEC.26-T2N-R66W

Badding 17-26 Pad Sec.26-T2N-R66W

Badding 27-26

Wellbore #1

Survey: Survey #1

Standard Survey Report

13 July, 2011



Company:	Anadarko, Weld County CO	Local Co-ordinate Reference:	Well Badding 27-26
Project:	SEC.26-T2N-R66W	TVD Reference:	WELL @ 5081.0ft (Original Well Elev)
Site:	Badding 17-26 Pad Sec.26-T2N-R66W	MD Reference:	WELL @ 5081.0ft (Original Well Elev)
Well:	Badding 27-26	North Reference:	True
Wellbore:	Wellbore #1	Survey Calculation Method:	Minimum Curvature
Design:	Wellbore #1	Database:	Landmark

Project	SEC.26-T2N-R66W, Weld County, Colorado		
Map System:	US State Plane 1983	System Datum:	Mean Sea Level
Geo Datum:	North American Datum 1983		Using Well Reference Point
Map Zone:	Colorado Northern Zone		Using geodetic scale factor

Site	Badding 17-26 Pad Sec.26-T2N-R66W		
Site Position:		Northing:	1,284,730.44 ft
From:	Lat/Long	Easting:	3,212,820.01 ft
Position Uncertainty:	0.0 ft	Slot Radius:	"
		Latitude:	40.112471
		Longitude:	-104.739081
		Grid Convergence:	0.49 °

Well	Badding 27-26		
Well Position	+N/-S	0.0 ft	Northing:
	+E/-W	0.0 ft	Easting:
Position Uncertainty	0.0 ft	Wellhead Elevation:	ft
		Latitude:	40.112471
		Longitude:	-104.739295
		Ground Level:	5,067.0 ft

Wellbore	Wellbore #1				
Magnetics	Model Name	Sample Date	Declination (°)	Dip Angle (°)	Field Strength (nT)
	IGRF2010	5/9/2011	8.84	66.83	52,992

Design	Wellbore #1			
Audit Notes:				
Version:	1.0	Phase:	ACTUAL	Tie On Depth:
Vertical Section:	Depth From (TVD) (ft)	+N/-S (ft)	+E/-W (ft)	Direction (°)
	0.0	0.0	0.0	355.05

Survey Program	Date	7/12/2011		
From (ft)	To (ft)	Survey (Wellbore)	Tool Name	Description
118.0	8,319.0	Survey #1 (Wellbore #1)	MWD	MWD - Standard

Survey									
Measured Depth (ft)	Inclination (°)	Azimuth (°)	Vertical Depth (ft)	+N/-S (ft)	+E/-W (ft)	Vertical Section (ft)	Dogleg Rate (°/100ft)	Build Rate (°/100ft)	Turn Rate (°/100ft)
0.0	0.00	0.00	0.0	0.0	0.0	0.0	0.00	0.00	0.00
118.0	0.80	84.30	118.0	0.1	0.8	0.0	0.68	0.68	0.00
210.0	0.80	11.20	210.0	0.8	1.6	0.6	1.04	0.00	-79.46
303.0	2.30	350.40	303.0	3.3	1.4	3.1	1.70	1.61	-22.37
413.0	4.50	352.30	412.8	9.7	0.5	9.6	2.00	2.00	1.73
501.0	5.90	350.10	500.4	17.6	-0.8	17.6	1.61	1.59	-2.50
590.0	7.30	353.80	588.8	27.7	-2.2	27.8	1.64	1.57	4.16
679.0	9.20	355.20	676.9	40.4	-3.4	40.6	2.15	2.13	1.57
767.0	11.40	355.90	763.4	56.1	-4.6	56.3	2.50	2.50	0.80
856.0	13.10	354.80	850.4	74.9	-6.1	75.2	1.93	1.91	-1.24
945.0	15.20	355.60	936.7	96.6	-8.0	96.9	2.37	2.36	0.90
1,033.0	16.10	355.10	1,021.5	120.3	-9.9	120.7	1.03	1.02	-0.57
1,122.0	16.00	355.70	1,107.0	144.8	-11.9	145.3	0.22	-0.11	0.67

Company:	Anadarko, Weld County CO	Local Co-ordinate Reference:	Well Badding 27-26
Project:	SEC.26-T2N-R66W	TVD Reference:	WELL @ 5081.0ft (Original Well Elev)
Site:	Badding 17-26 Pad Sec.26-T2N-R66W	MD Reference:	WELL @ 5081.0ft (Original Well Elev)
Well:	Badding 27-26	North Reference:	True
Wellbore:	Wellbore #1	Survey Calculation Method:	Minimum Curvature
Design:	Wellbore #1	Database:	Landmark

Survey

Measured Depth (ft)	Inclination (°)	Azimuth (°)	Vertical Depth (ft)	+N/-S (ft)	+E/-W (ft)	Vertical Section (ft)	Dogleg Rate (°/100ft)	Build Rate (°/100ft)	Turn Rate (°/100ft)
1,197.0	15.10	354.70	1,179.2	164.8	-13.5	165.4	1.25	-1.20	-1.33
1,286.0	16.60	357.10	1,264.9	189.1	-15.2	189.7	1.84	1.69	2.70
1,375.0	17.70	357.70	1,349.9	215.3	-16.4	215.9	1.25	1.24	0.67
1,463.0	17.70	357.20	1,433.7	242.0	-17.6	242.6	0.17	0.00	-0.57
1,552.0	17.70	355.80	1,518.5	269.0	-19.3	269.7	0.48	0.00	-1.57
1,641.0	18.00	356.70	1,603.2	296.2	-21.1	297.0	0.46	0.34	1.01
1,729.0	18.10	357.80	1,686.9	323.5	-22.4	324.2	0.40	0.11	1.25
1,818.0	17.90	357.30	1,771.5	351.0	-23.5	351.7	0.28	-0.22	-0.56
1,907.0	18.10	357.70	1,856.2	378.4	-24.7	379.2	0.26	0.22	0.45
1,995.0	17.40	357.50	1,940.0	405.2	-25.9	406.0	0.80	-0.80	-0.23
2,084.0	17.50	357.10	2,024.9	431.9	-27.1	432.6	0.18	0.11	-0.45
2,173.0	17.00	355.50	2,109.9	458.2	-28.8	459.0	0.77	-0.56	-1.80
2,261.0	17.40	353.50	2,194.0	484.1	-31.3	485.0	0.81	0.45	-2.27
2,350.0	17.80	354.70	2,278.8	510.9	-34.1	511.9	0.61	0.45	1.35
2,438.0	17.50	354.30	2,362.7	537.5	-36.6	538.6	0.37	-0.34	-0.45
2,527.0	18.00	353.20	2,447.4	564.4	-39.6	565.7	0.68	0.56	-1.24
2,616.0	17.70	354.60	2,532.1	591.5	-42.5	593.0	0.59	-0.34	1.57
2,704.0	18.50	355.30	2,615.8	618.8	-44.9	620.3	0.94	0.91	0.80
2,793.0	18.10	355.10	2,700.3	646.6	-47.2	648.3	0.45	-0.45	-0.22
2,882.0	18.00	355.00	2,784.9	674.1	-49.6	675.9	0.12	-0.11	-0.11
2,970.0	18.40	354.40	2,868.5	701.5	-52.2	703.4	0.50	0.45	-0.68
3,059.0	18.20	353.70	2,953.0	729.3	-55.1	731.3	0.33	-0.22	-0.79
3,148.0	19.00	353.80	3,037.3	757.5	-58.1	759.7	0.90	0.90	0.11
3,236.0	19.00	353.00	3,120.6	785.9	-61.4	788.3	0.30	0.00	-0.91
3,325.0	18.40	354.00	3,204.9	814.3	-64.7	816.8	0.76	-0.67	1.12
3,413.0	18.20	352.50	3,288.4	841.7	-67.9	844.5	0.58	-0.23	-1.70
3,502.0	18.60	355.10	3,372.9	869.7	-70.9	872.5	1.03	0.45	2.92
3,591.0	18.30	355.30	3,457.3	897.7	-73.3	900.7	0.34	-0.34	0.22
3,679.0	18.30	355.00	3,540.8	925.3	-75.6	928.3	0.11	0.00	-0.34
3,768.0	17.90	354.10	3,625.4	952.8	-78.3	956.0	0.55	-0.45	-1.01
3,857.0	18.00	354.70	3,710.1	980.1	-80.9	983.4	0.24	0.11	0.67
3,945.0	19.30	355.10	3,793.5	1,008.1	-83.4	1,011.5	1.48	1.48	0.45
4,034.0	19.30	354.10	3,877.5	1,037.4	-86.2	1,041.0	0.37	0.00	-1.12
4,123.0	18.90	353.70	3,961.6	1,066.3	-89.3	1,070.1	0.47	-0.45	-0.45
4,211.0	19.30	356.90	4,044.7	1,095.0	-91.6	1,098.9	1.27	0.45	3.64
4,300.0	19.20	355.90	4,128.7	1,124.3	-93.5	1,128.2	0.39	-0.11	-1.12
4,389.0	19.60	352.80	4,212.7	1,153.7	-96.4	1,157.7	1.24	0.45	-3.48
4,477.0	18.60	351.70	4,295.9	1,182.3	-100.3	1,186.5	1.21	-1.14	-1.25
4,566.0	18.10	352.70	4,380.3	1,210.0	-104.1	1,214.5	0.66	-0.56	1.12
4,654.0	16.90	354.70	4,464.3	1,236.3	-107.0	1,240.9	1.53	-1.36	2.27
4,743.0	14.60	356.80	4,549.9	1,260.4	-108.8	1,265.1	2.66	-2.58	2.36
4,832.0	14.30	356.80	4,636.1	1,282.6	-110.1	1,287.3	0.34	-0.34	0.00
4,920.0	13.10	355.60	4,721.6	1,303.4	-111.4	1,308.1	1.40	-1.36	-1.36
5,009.0	11.30	355.20	4,808.6	1,322.1	-112.9	1,326.9	2.02	-2.02	-0.45
5,098.0	9.50	355.90	4,896.1	1,338.1	-114.2	1,343.0	2.03	-2.02	0.79
5,186.0	8.80	357.50	4,983.0	1,352.1	-115.0	1,357.0	0.85	-0.80	1.82
5,275.0	7.60	354.30	5,071.1	1,364.8	-115.9	1,369.7	1.44	-1.35	-3.60
5,364.0	6.70	352.70	5,159.4	1,375.8	-117.1	1,380.7	1.04	-1.01	-1.80
5,452.0	5.80	346.40	5,246.9	1,385.2	-118.8	1,390.3	1.28	-1.02	-7.16
5,541.0	4.60	345.40	5,335.5	1,393.0	-120.8	1,398.2	1.35	-1.35	-1.12
5,629.0	3.50	349.40	5,423.3	1,399.1	-122.2	1,404.4	1.29	-1.25	4.55
5,718.0	2.60	349.20	5,512.1	1,403.7	-123.0	1,409.1	1.01	-1.01	-0.22
5,807.0	1.10	350.10	5,601.1	1,406.5	-123.6	1,411.9	1.69	-1.69	1.01
5,940.0	0.30	357.10	5,734.1	1,408.1	-123.8	1,413.6	0.60	-0.60	5.26

Company:	Anadarko, Weld County CO	Local Co-ordinate Reference:	Well Badding 27-26
Project:	SEC.26-T2N-R66W	TVD Reference:	WELL @ 5081.0ft (Original Well Elev)
Site:	Badding 17-26 Pad Sec.26-T2N-R66W	MD Reference:	WELL @ 5081.0ft (Original Well Elev)
Well:	Badding 27-26	North Reference:	True
Wellbore:	Wellbore #1	Survey Calculation Method:	Minimum Curvature
Design:	Wellbore #1	Database:	Landmark

Survey										
Measured Depth (ft)	Inclination (°)	Azimuth (°)	Vertical Depth (ft)	+N/-S (ft)	+E/-W (ft)	Vertical Section (ft)	Dogleg Rate (°/100ft)	Build Rate (°/100ft)	Turn Rate (°/100ft)	
6,005.9	0.25	353.81	5,800.0	1,408.5	-123.8	1,413.9	0.08	-0.08	-4.98	
TARGET BHL 50'FNL, 1330'FEL										
6,073.0	0.20	348.80	5,867.1	1,408.7	-123.9	1,414.1	0.08	-0.07	-7.48	
6,206.0	0.40	355.70	6,000.1	1,409.4	-124.0	1,414.8	0.15	0.15	5.19	
6,339.0	0.30	355.70	6,133.1	1,410.2	-124.0	1,415.7	0.08	-0.08	0.00	
6,472.0	0.20	137.90	6,266.1	1,410.4	-123.9	1,415.8	0.36	-0.08	106.92	
6,605.0	0.40	187.40	6,399.1	1,409.8	-123.8	1,415.2	0.23	0.15	37.22	
6,737.0	0.40	146.10	6,531.1	1,408.9	-123.6	1,414.3	0.21	0.00	-31.29	
6,870.0	0.40	170.60	6,664.1	1,408.1	-123.3	1,413.5	0.13	0.00	18.42	
7,003.0	0.40	188.70	6,797.1	1,407.2	-123.3	1,412.5	0.09	0.00	13.61	
7,136.0	0.10	253.00	6,930.1	1,406.7	-123.4	1,412.1	0.28	-0.23	48.35	
7,269.0	0.10	298.90	7,063.1	1,406.7	-123.6	1,412.1	0.06	0.00	34.51	
7,367.9	0.25	312.46	7,162.0	1,406.9	-123.9	1,412.3	0.15	0.15	13.70	
TARGET CIRCLE 50'FNL, 1330'FEL										
7,402.0	0.30	314.00	7,196.1	1,407.0	-124.0	1,412.4	0.15	0.15	4.53	
7,535.0	0.40	322.00	7,329.1	1,407.6	-124.5	1,413.1	0.08	0.08	6.02	
7,668.0	0.80	340.00	7,462.1	1,408.8	-125.1	1,414.4	0.33	0.30	13.53	
7,801.0	0.10	357.00	7,595.1	1,409.8	-125.5	1,415.4	0.53	-0.53	12.78	
7,934.0	0.20	48.00	7,728.1	1,410.1	-125.3	1,415.6	0.12	0.08	38.35	
8,067.0	0.30	60.00	7,861.0	1,410.4	-124.8	1,415.9	0.08	0.08	9.02	
8,200.0	0.30	72.00	7,994.0	1,410.7	-124.2	1,416.2	0.05	0.00	9.02	
8,273.0	0.10	101.00	8,067.0	1,410.7	-123.9	1,416.2	0.30	-0.27	39.73	
HARDLINE 50'N OF BHL										
8,319.0	0.10	101.00	8,113.0	1,410.7	-123.9	1,416.2	0.00	0.00	0.00	

Checked By: _____	Approved By: _____	Date: _____
-------------------	--------------------	-------------