



KERR MCGEE OIL & GAS ONSHORE LP

Location: COLORADO Slot: SLOT#11 SWEETGRASS 33-14 (2139FSL & 700'FWL)
Field: WELD COUNTY (KERR MCGEE) Well: SWEETGRASS 33-14
Facility: SEC.14-T1N-R68W Wellbore: SWEETGRASS 33-14 PWB



Plot reference wellpath is SWEETGRASS 33-14 (REV.A.0) PWB	
True vertical depths are referenced to XTREME 12 (RKB)	Grid System: NAD83 / Lambert Colorado SP, Northern Zone (501), US feet
Measured depths are referenced to XTREME 12 (RKB)	North Reference: True north
XTREME 12 (RKB) to Mean Sea Level: 5120 feet	Scale: True distance
Mean Sea Level to Mud line (At Slot: SLOT#11 SWEETGRASS 33-14 (2139FSL & 700'FWL)): 0 feet	Depths are in feet
Coordinates are in feet referenced to Slot	Created by: cookdam on 7/21/2011

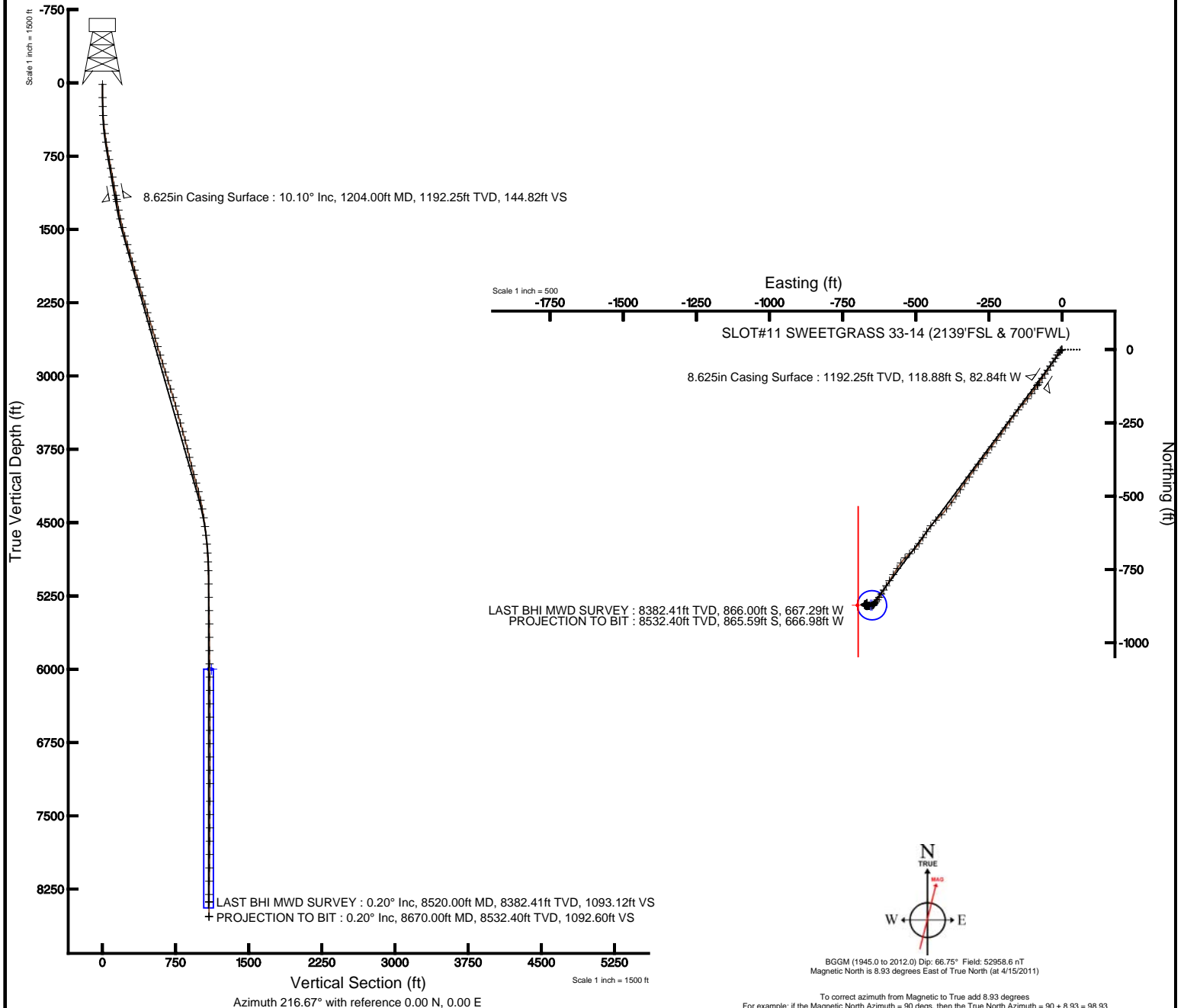



Actual Wellpath Report

SWEETGRASS 33-14 AWP

Page 1 of 4



REFERENCE WELLPATH IDENTIFICATION			
Operator	KERR MCGEE OIL & GAS ONSHORE LP	Slot	SLOT#11 SWEETGRASS 33-14 (2139'FSL & 700'FWL)
Area	COLORADO	Well	SWEETGRASS 33-14
Field	WELD COUNTY (KERR MCGEE)	Wellbore	SWEETGRASS 33-14 AWB
Facility	SEC.14-T1N-R68W		

REPORT SETUP INFORMATION			
Projection System	NAD83 / Lambert Colorado SP, Northern Zone (501), US feet	Software System	WellArchitect® 3.0.0
North Reference	True	User	Cookdanm
Scale	0.999963	Report Generated	7/21/2011 at 10:26:45 AM
Convergence at slot	0.34° East	Database/Source file	WA_DENVER/SWEETGRASS_33-14_AWB.xml

WELLPATH LOCATION						
	Local coordinates		Grid coordinates		Geographic coordinates	
	North[ft]	East[ft]	Easting[US ft]	Northing[US ft]	Latitude	Longitude
Slot Location	201.73	-3731.30	3146271.83	1261439.78	40°02'59.489"N	104°58'39.007"W
Facility Reference Pt			3150004.14	1261260.61	40°02'57.498"N	104°57'51.026"W
Field Reference Pt			3197771.84	1268891.29	40°04'09.600"N	104°47'36.000"W

WELLPATH DATUM			
Calculation method	Minimum curvature	XTREME 12 (RKB) to Facility Vertical Datum	5120.00ft
Horizontal Reference Pt	Slot	XTREME 12 (RKB) to Mean Sea Level	5120.00ft
Vertical Reference Pt	XTREME 12 (RKB)	XTREME 12 (RKB) to Mud Line at Slot (SLOT#11 SWEETGRASS 33-14 (2139'FSL & 700'FWL))	5120.00ft
MD Reference Pt	XTREME 12 (RKB)	Section Origin	N 0.00, E 0.00 ft
Field Vertical Reference	Mean Sea Level	Section Azimuth	216.67°



Actual Wellpath Report

SWEETGRASS 33-14 AWP

Page 2 of 4



REFERENCE WELLPATH IDENTIFICATION

Operator	KERR MCGEE OIL & GAS ONSHORE LP	Slot	SLOT#11 SWEETGRASS 33-14 (2139'FSL & 700'FWL)
Area	COLORADO	Well	SWEETGRASS 33-14
Field	WELD COUNTY (KERR MCGEE)	Wellbore	SWEETGRASS 33-14 AWP
Facility	SEC.14-T1N-R68W		

WELLPATH DATA (84 stations) † = interpolated/extrapolated station

MD [ft]	Inclination [°]	Azimuth [°]	TVD [ft]	Vert Sect [ft]	North [ft]	East [ft]	DLS [°/100ft]	Comments
0.00†	0.000	261.500	0.00	0.00	0.00	0.00	0.00	
15.00	0.000	261.500	15.00	0.00	0.00	0.00	0.00	
150.00	0.800	261.500	150.00	0.67	-0.14	-0.93	0.59	
242.00	2.000	242.200	241.97	2.57	-0.98	-2.99	1.38	
334.00	3.700	222.500	333.85	6.97	-3.92	-6.41	2.11	
426.00	5.600	216.500	425.55	14.42	-9.72	-11.09	2.13	
518.00	7.500	209.900	516.94	24.87	-18.53	-16.75	2.22	
608.00	8.800	211.300	606.03	37.56	-29.51	-23.26	1.46	
699.00	10.100	213.000	695.79	52.45	-42.15	-31.22	1.46	
790.00	10.800	214.100	785.28	68.93	-55.90	-40.35	0.80	
881.00	10.700	214.100	874.69	85.89	-69.95	-49.86	0.11	
971.00	10.600	212.000	963.14	102.48	-83.89	-58.93	0.45	
1062.00	10.500	213.700	1052.60	119.11	-97.89	-67.97	0.36	
1161.00	10.500	216.500	1149.94	137.14	-112.65	-78.34	0.52	
1226.00	9.900	214.400	1213.91	148.64	-122.02	-85.02	1.09	
1317.00	10.600	213.000	1303.46	164.81	-135.49	-94.00	0.82	
1407.00	12.800	216.900	1391.59	183.05	-150.41	-104.49	2.60	
1498.00	14.700	220.100	1479.98	204.65	-167.30	-117.98	2.25	
1589.00	16.400	220.800	1567.64	228.99	-185.86	-133.82	1.88	
1680.00	16.300	217.300	1654.97	254.58	-205.75	-149.95	1.09	
1771.00	16.000	215.800	1742.37	279.89	-226.08	-165.03	0.56	
1861.00	16.100	213.400	1828.87	304.75	-246.55	-179.15	0.75	
1952.00	16.100	216.900	1916.30	329.96	-267.18	-193.67	1.07	
2043.00	16.400	214.800	2003.67	355.42	-287.82	-208.58	0.72	
2134.00	17.500	217.300	2090.71	381.94	-309.25	-224.20	1.45	
2225.00	17.500	214.400	2177.50	409.30	-331.43	-240.23	0.96	
2315.00	16.200	220.100	2263.64	435.35	-352.20	-255.96	2.33	
2406.00	15.200	216.500	2351.25	459.96	-371.50	-271.23	1.53	
2497.00	16.900	217.600	2438.70	485.11	-391.57	-286.40	1.90	
2588.00	17.000	215.500	2525.75	511.64	-412.88	-302.20	0.68	
2679.00	17.900	213.700	2612.56	538.90	-435.34	-317.68	1.15	
2769.00	16.200	216.900	2698.60	565.27	-456.89	-332.89	2.16	
2860.00	16.800	215.100	2785.85	591.11	-477.80	-348.08	0.87	
2951.00	16.700	213.000	2872.99	617.31	-499.53	-362.76	0.67	
3042.00	17.600	216.900	2959.95	644.12	-521.50	-378.14	1.60	
3132.00	17.500	217.900	3045.76	671.25	-543.06	-394.63	0.35	
3223.00	17.000	223.900	3132.67	698.13	-563.44	-412.26	2.03	
3314.00	17.300	227.000	3219.63	724.64	-582.25	-431.38	1.06	
3405.00	15.900	217.900	3306.85	750.42	-601.32	-448.93	3.24	
3495.00	14.900	211.900	3393.62	774.28	-620.87	-462.62	2.09	
3586.00	15.900	212.700	3481.35	798.37	-641.30	-475.54	1.12	
3677.00	15.600	213.700	3568.94	823.03	-661.97	-489.06	0.44	
3768.00	15.800	224.300	3656.56	847.53	-681.02	-504.51	3.16	
3859.00	13.600	229.900	3744.58	870.23	-696.78	-521.35	2.88	
3949.00	13.600	226.000	3832.06	890.97	-710.94	-537.05	1.02	
4040.00	14.300	213.400	3920.40	912.75	-727.76	-550.94	3.42	
4131.00	15.000	213.700	4008.44	935.73	-746.94	-563.66	0.77	
4222.00	16.600	211.600	4096.00	960.44	-767.81	-577.01	1.87	
4313.00	14.700	213.700	4183.62	984.92	-788.49	-590.22	2.18	
4403.00	11.500	209.900	4271.27	1005.24	-805.77	-601.03	3.68	
4494.00	10.600	211.300	4360.58	1022.58	-820.79	-609.91	1.03	
4585.00	9.000	213.000	4450.25	1038.02	-833.91	-618.13	1.79	
4676.00	7.900	210.200	4540.26	1051.34	-845.29	-625.15	1.29	
4767.00	5.700	219.000	4630.62	1062.07	-854.20	-631.14	2.67	
4857.00	4.700	219.400	4720.25	1070.22	-860.53	-636.30	1.11	
4948.00	3.300	218.000	4811.02	1076.56	-865.47	-640.28	1.54	
5039.00	3.300	214.800	4901.87	1081.80	-869.69	-643.38	0.20	
5130.00	1.100	244.300	4992.80	1085.19	-872.22	-645.67	2.64	
5266.00	1.500	259.400	5128.77	1087.65	-873.11	-648.59	0.38	

5402.00	1.900	267.800	5264.71	1090.38	-873.52	-652.59	0.35
---------	-------	---------	---------	---------	---------	---------	------



Actual Wellpath Report

SWEETGRASS 33-14 AWP

Page 3 of 4



REFERENCE WELLPATH IDENTIFICATION

Operator	KERR MCGEE OIL & GAS ONSHORE LP	Slot	SLOT#11 SWEETGRASS 33-14 (2139'FSL & 700'FWL)
Area	COLORADO	Well	SWEETGRASS 33-14
Field	WELD COUNTY (KERR MCGEE)	Wellbore	SWEETGRASS 33-14 AWP
Facility	SEC.14-T1N-R68W		

WELLPATH DATA (84 stations)

MD [ft]	Inclination [°]	Azimuth [°]	TVD [ft]	Vert Sect [ft]	North [ft]	East [ft]	DLS [°/100ft]	Comments
5538.00	2.100	260.800	5400.62	1093.58	-874.01	-657.31	0.23	
5674.00	0.200	175.600	5536.59	1095.55	-874.64	-659.75	1.54	
5811.00	0.600	291.100	5673.59	1095.92	-874.62	-660.40	0.52	
5947.00	1.000	255.500	5809.58	1097.04	-874.67	-662.21	0.46	
6083.00	0.900	268.200	5945.56	1098.62	-875.00	-664.43	0.17	
6219.00	0.600	270.300	6081.55	1099.71	-875.03	-666.21	0.22	
6355.00	0.700	252.400	6217.54	1100.81	-875.27	-667.71	0.17	
6492.00	0.900	304.800	6354.53	1101.52	-874.91	-669.39	0.53	
6628.00	0.300	20.800	6490.52	1101.21	-873.97	-670.14	0.64	
6764.00	0.200	286.500	6626.52	1100.95	-873.57	-670.25	0.27	
6900.00	0.300	138.800	6762.52	1101.11	-873.77	-670.24	0.35	
7036.00	0.400	223.600	6898.52	1101.66	-874.38	-670.33	0.35	
7172.00	0.300	278.400	7034.51	1102.30	-874.67	-671.01	0.25	
7308.00	0.900	303.700	7170.51	1102.52	-874.03	-672.25	0.47	
7490.00	0.800	305.500	7352.49	1102.62	-872.50	-674.48	0.06	
7626.00	0.900	347.300	7488.47	1101.94	-870.90	-675.48	0.45	
7762.00	0.500	38.700	7624.46	1100.66	-869.40	-675.35	0.52	
7898.00	0.700	63.300	7760.46	1099.32	-868.56	-674.23	0.24	
8034.00	0.700	88.600	7896.45	1098.07	-868.17	-672.66	0.23	
8171.00	0.900	74.200	8033.43	1096.70	-867.86	-670.79	0.21	
8307.00	0.900	74.100	8169.42	1095.00	-867.27	-668.73	0.00	
8444.00	0.500	20.400	8306.41	1093.57	-866.42	-667.49	0.53	
8520.00	0.200	37.600	8382.41	1093.12	-866.00	-667.29	0.41	LAST BHI MWD SURVEY
8670.00	0.200	37.600	8532.40	1092.60	-865.59	-666.98	0.00	PROJECTION TO BIT

HOLE & CASING SECTIONS - Ref Wellbore: SWEETGRASS 33-14 AWP Ref Wellpath: SWEETGRASS 33-14 AWP

String/Diameter	Start MD [ft]	End MD [ft]	Interval [ft]	Start TVD [ft]	End TVD [ft]	Start N/S [ft]	Start E/W [ft]	End N/S [ft]	End E/W [ft]
12.25in Open Hole	15.00	1216.00	1201.00	15.00	1204.07	0.00	0.00	-120.60	-84.04
8.625in Casing Surface	15.00	1204.00	1189.00	15.00	1192.25	0.00	0.00	-118.88	-82.84
7.875in Open Hole	1216.00	8570.00	7354.00	1204.07	8432.41	-120.60	-84.04	-865.86	-667.19

TARGETS

Name	MD [ft]	TVD [ft]	North [ft]	East [ft]	Grid East [US ft]	Grid North [US ft]	Latitude	Longitude	Shape
SWEETGRASS 33-14 BHL ON PLAT (1280'FSL & 45'FWL, REV-1)		6000.00	-872.45	-654.57	3145622.44	1260563.53	40°02'50.867"N	104°58'47.424"W	point
SWEETGRASS 33-14 GEO TARGET 50' RADIUS (1280'FSL & 50'FWL, REV-2)		6000.00	-872.47	-649.57	3145627.44	1260563.53	40°02'50.867"N	104°58'47.360"W	circle
SWEETGRASS 33-14 HARDLINE 50'W OF GEO TARGET		6000.00	-872.47	-699.57	3145577.44	1260563.24	40°02'50.867"N	104°58'48.003"W	point

WELLPATH COMPOSITION - Ref Wellbore: SWEETGRASS 33-14 AWP Ref Wellpath: SWEETGRASS 33-14 AWP

Start MD [ft]	End MD [ft]	Positional Uncertainty Model	Log Name/Comment	Wellbore
15.00	8520.00	NaviTrak (Standard)	BHI MWD SURVEYS <150-8520>	SWEETGRASS 33-14 AWP
8520.00	8670.00	Blind Drilling (std)	Projection to bit	SWEETGRASS 33-14 AWP



Actual Wellpath Report

SWEETGRASS 33-14 AWP

Page 4 of 4



REFERENCE WELLPATH IDENTIFICATION

Operator	KERR MCGEE OIL & GAS ONSHORE LP	Slot	SLOT#11 SWEETGRASS 33-14 (2139'FSL & 700'FWL)
Area	COLORADO	Well	SWEETGRASS 33-14
Field	WELD COUNTY (KERR MCGEE)	Wellbore	SWEETGRASS 33-14 AWB
Facility	SEC.14-T1N-R68W		

WELLPATH COMMENTS

MD [ft]	Inclination [°]	Azimuth [°]	TVD [ft]	Comment
8520.00	0.200	37.600	8382.41	LAST BHI MWD SURVEY
8670.00	0.200	37.600	8532.40	PROJECTION TO BIT