



KERR MCGEE OIL & GAS ONSHORE LP

Location: COLORADO Slot: SLOT#07 SWEETGRASS 15-14 (1827'FSL & 880'FEL)
Field: WELD COUNTY (KERR MCGEE) Well: SWEETGRASS 15-14
Facility: SEC.14-T1N-R68W Wellbore: SWEETGRASS 15-14 PWB



Not reference wellpath is SWEETGRASS 15-14 (REV.B.0) PWP	
True vertical depths are referenced to XTREME 12 (RWB)	Grid System NAD83 / Lambert Colorado SP, Northern Zone (801), US feet
Measured depths are referenced to XTREME 12 (RWB)	North Reference: True north
XTREME 12 (RWB) to Mean Sea Level: 5151 feet	Scale: True distance
Mean Sea Level to Mud line (At Slot: SLOT#07 SWEETGRASS 15-14 (1827'FSL & 880'FEL)): 0 feet	Depths are in feet
Coordinates are in feet referenced to Slot	Created by: cookdenn on 7/20/2011

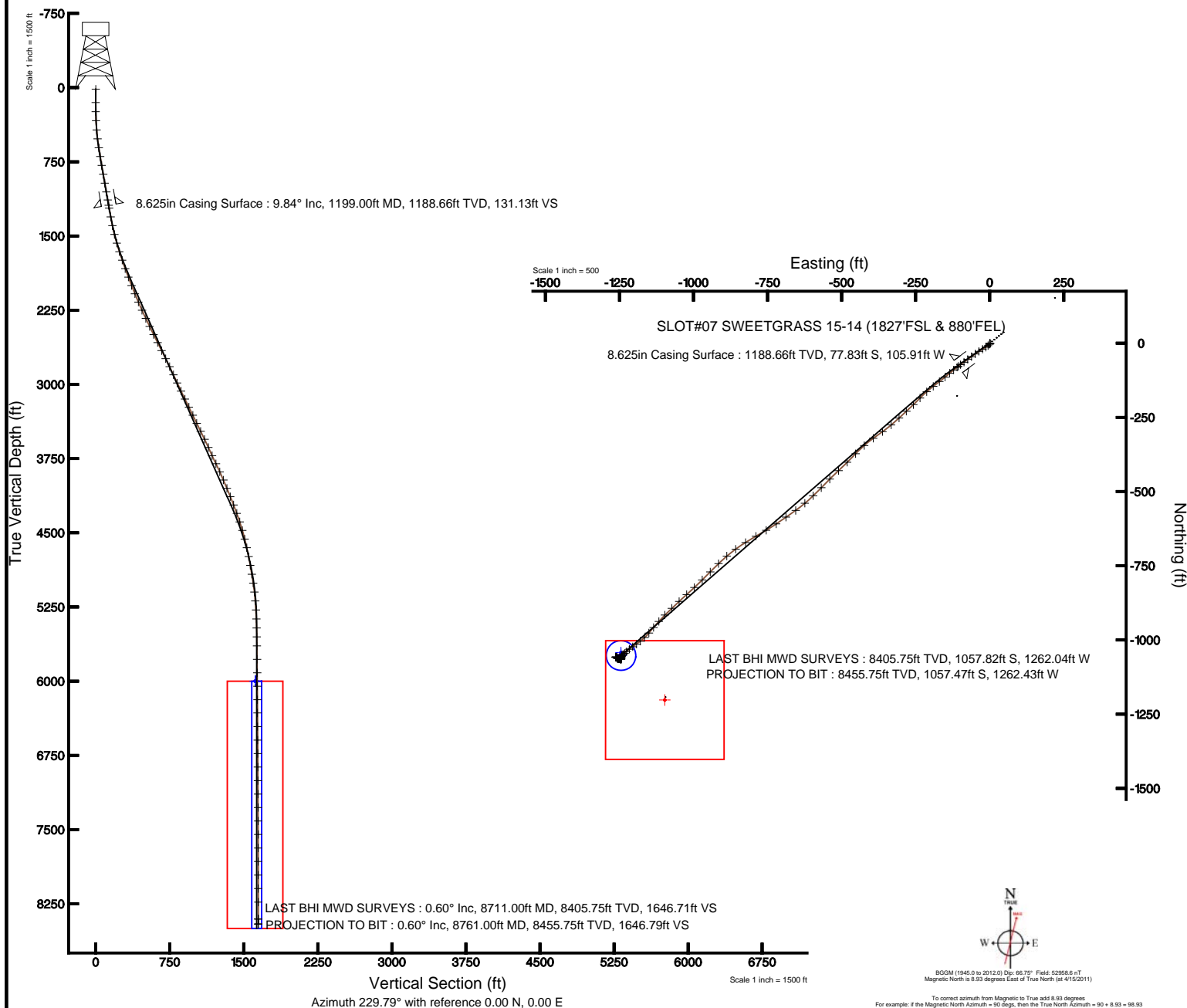



Actual Wellpath Report

SWEETGRASS 15-14 AWP

Page 1 of 5



REFERENCE WELLPATH IDENTIFICATION			
Operator	KERR MCGEE OIL & GAS ONSHORE LP	Slot	SLOT#07 SWEETGRASS 15-14 (1827'FSL & 880'FEL)
Area	COLORADO	Well	SWEETGRASS 15-14
Field	WELD COUNTY (KERR MCGEE)	Wellbore	SWEETGRASS 15-14 AWB
Facility	SEC.14-T1N-R68W		

REPORT SETUP INFORMATION			
Projection System	NAD83 / Lambert Colorado SP, Northern Zone (501), US feet	Software System	WellArchitect® 3.0.0
North Reference	True	User	Cookdanm
Scale	0.999963	Report Generated	7/20/2011 at 3:38:11 PM
Convergence at slot	0.35° East	Database/Source file	WA_DENVER/SWEETGRASS_15-14_AWB.xml

WELLPATH LOCATION						
	Local coordinates		Grid coordinates		Geographic coordinates	
	North[ft]	East[ft]	Easting[US ft]	Northing[US ft]	Latitude	Longitude
Slot Location	-37.16	-47.03	3149957.33	1261223.17	40°02'57.131"N	104°57'51.631"W
Facility Reference Pt			3150004.14	1261260.61	40°02'57.498"N	104°57'51.026"W
Field Reference Pt			3197771.84	1268891.29	40°04'09.600"N	104°47'36.000"W

WELLPATH DATUM			
Calculation method	Minimum curvature	XTREME 12 (RKB) to Facility Vertical Datum	5151.00ft
Horizontal Reference Pt	Slot	XTREME 12 (RKB) to Mean Sea Level	5151.00ft
Vertical Reference Pt	XTREME 12 (RKB)	XTREME 12 (RKB) to Mud Line at Slot (SLOT#07 SWEETGRASS 15-14 (1827'FSL & 880'FEL))	5151.00ft
MD Reference Pt	XTREME 12 (RKB)	Section Origin	N 0.00, E 0.00 ft
Field Vertical Reference	Mean Sea Level	Section Azimuth	229.79°



Actual Wellpath Report

SWEETGRASS 15-14 AWP

Page 2 of 5



REFERENCE WELLPATH IDENTIFICATION

Operator	KERR MCGEE OIL & GAS ONSHORE LP	Slot	SLOT#07 SWEETGRASS 15-14 (1827'FSL & 880'FEL)
Area	COLORADO	Well	SWEETGRASS 15-14
Field	WELD COUNTY (KERR MCGEE)	Wellbore	SWEETGRASS 15-14 AWP
Facility	SEC.14-T1N-R68W		

WELLPATH DATA (88 stations) † = interpolated/extrapolated station

MD [ft]	Inclination [°]	Azimuth [°]	TVD [ft]	Vert Sect [ft]	North [ft]	East [ft]	DLS [°/100ft]	Comments
0.00†	0.000	93.500	0.00	0.00	0.00	0.00	0.00	
15.00	0.000	93.500	15.00	0.00	0.00	0.00	0.00	
150.00	1.200	93.500	149.99	-1.02	-0.09	1.41	0.89	
242.00	1.200	202.800	241.98	-0.86	-1.03	2.00	2.13	
334.00	3.100	227.100	333.91	2.48	-3.62	-0.20	2.25	
427.00	5.100	231.700	426.67	9.13	-7.89	-5.28	2.18	
518.00	7.100	239.400	517.15	18.72	-13.26	-13.30	2.37	
609.00	8.900	240.100	607.26	31.19	-19.63	-24.24	1.98	
699.00	9.500	235.900	696.10	45.42	-27.27	-36.43	1.00	
790.00	9.500	234.500	785.86	60.37	-35.84	-48.76	0.25	
881.00	10.100	233.400	875.53	75.82	-44.96	-61.28	0.69	
972.00	10.100	234.100	965.12	91.74	-54.39	-74.15	0.13	
1062.00	9.800	232.400	1053.76	107.26	-63.69	-86.61	0.47	
1144.00	10.300	234.100	1134.51	121.54	-72.25	-98.08	0.71	
1228.00	9.600	235.500	1217.24	136.00	-80.62	-109.93	0.88	
1318.00	9.800	228.200	1305.96	151.13	-89.98	-121.83	1.38	
1409.00	12.100	231.700	1395.30	168.40	-101.05	-135.09	2.63	
1500.00	14.100	229.600	1483.92	189.02	-114.15	-151.02	2.26	
1591.00	16.300	233.100	1571.74	212.86	-129.00	-169.67	2.62	
1681.00	17.700	231.700	1657.80	239.14	-145.07	-190.51	1.62	
1772.00	19.000	229.200	1744.18	267.78	-163.32	-212.58	1.67	
1863.00	20.600	224.600	1829.80	298.54	-184.40	-235.04	2.45	
1954.00	20.400	226.100	1915.04	330.31	-206.80	-257.71	0.62	
2045.00	21.300	227.100	2000.08	362.65	-229.05	-281.24	1.06	
2135.00	22.700	227.400	2083.52	396.33	-251.93	-306.00	1.56	
2226.00	23.200	229.900	2167.32	431.80	-275.36	-332.64	1.20	
2317.00	24.600	234.500	2250.52	468.61	-297.91	-361.77	2.56	
2408.00	25.800	234.500	2332.86	507.22	-320.41	-393.32	1.32	
2498.00	25.400	228.200	2414.04	546.04	-344.65	-423.66	3.06	
2589.00	26.700	224.600	2495.80	585.92	-372.22	-452.56	2.25	
2680.00	26.500	225.000	2577.17	626.51	-401.13	-481.27	0.30	
2771.00	26.100	226.700	2658.75	666.73	-429.21	-510.20	0.94	
2862.00	27.800	225.400	2739.86	707.88	-457.85	-539.88	1.98	
2952.00	26.200	223.600	2820.05	748.56	-486.97	-568.53	2.00	
3043.00	23.900	228.100	2902.50	786.96	-513.84	-596.11	3.28	
3134.00	25.300	227.800	2985.23	824.83	-539.21	-624.23	1.54	
3225.00	25.700	235.200	3067.39	863.91	-563.54	-654.85	3.53	
3315.00	26.900	236.200	3148.07	903.57	-586.00	-687.79	1.42	
3406.00	25.700	234.500	3229.65	943.70	-608.91	-720.96	1.56	
3497.00	26.400	240.500	3311.42	983.25	-630.34	-754.64	2.99	
3588.00	26.100	239.400	3393.04	1022.86	-650.49	-789.48	0.63	
3678.00	27.500	238.000	3473.37	1062.95	-671.58	-824.14	1.71	
3769.00	25.100	234.100	3554.95	1103.00	-694.04	-857.60	3.25	
3860.00	24.300	230.600	3637.63	1140.97	-717.24	-887.71	1.83	
3951.00	24.900	224.600	3720.38	1178.78	-742.77	-915.63	2.82	
4042.00	26.500	225.000	3802.38	1218.09	-770.77	-943.44	1.77	
4132.00	24.000	226.400	3883.77	1256.38	-797.59	-970.90	2.86	
4223.00	23.600	225.500	3967.03	1293.02	-823.12	-997.29	0.59	
4314.00	22.100	228.900	4050.89	1328.30	-847.15	-1023.19	2.20	
4405.00	22.100	226.700	4135.21	1362.51	-870.14	-1048.55	0.91	
4495.00	22.400	227.400	4218.51	1396.55	-893.36	-1073.49	0.44	
4586.00	19.600	224.300	4303.46	1429.07	-916.02	-1096.92	3.31	
4677.00	18.500	222.200	4389.47	1458.58	-937.64	-1117.28	1.42	
4768.00	16.200	219.700	4476.33	1485.39	-958.11	-1135.09	2.66	
4859.00	14.600	220.800	4564.06	1509.22	-976.56	-1150.69	1.79	
4949.00	12.700	228.500	4651.52	1530.32	-991.70	-1165.51	2.92	
5040.00	11.000	228.900	4740.58	1549.00	-1004.04	-1179.55	1.87	
5131.00	10.000	235.900	4830.06	1565.54	-1014.18	-1192.64	1.78	
5222.00	9.600	235.500	4919.73	1580.95	-1022.90	-1205.43	0.45	

5313.00	8.500	231.700	5009.59	1595.22	-1031.37	-1216.96	1.38
---------	-------	---------	---------	---------	----------	----------	------



Actual Wellpath Report

SWEETGRASS 15-14 AWP

Page 3 of 5



REFERENCE WELLPATH IDENTIFICATION			
Operator	KERR MCGEE OIL & GAS ONSHORE LP	Slot	SLOT#07 SWEETGRASS 15-14 (1827'FSL & 880'FEL)
Area	COLORADO	Well	SWEETGRASS 15-14
Field	WELD COUNTY (KERR MCGEE)	Wellbore	SWEETGRASS 15-14 AWB
Facility	SEC.14-T1N-R68W		

WELLPATH DATA (88 stations)								
MD [ft]	Inclination [°]	Azimuth [°]	TVD [ft]	Vert Sect [ft]	North [ft]	East [ft]	DLS [°/100ft]	Comments
5404.00	6.800	226.400	5099.78	1607.32	-1039.25	-1226.14	2.02	
5494.00	4.400	231.700	5189.35	1616.09	-1045.07	-1232.71	2.73	
5585.00	3.800	236.200	5280.11	1622.57	-1048.91	-1237.96	0.75	
5676.00	2.000	212.300	5371.00	1627.09	-1051.93	-1241.31	2.34	
5767.00	1.300	210.600	5461.96	1629.58	-1054.16	-1242.69	0.77	
5858.00	1.200	193.700	5552.94	1631.32	-1055.97	-1243.44	0.42	
5949.00	1.200	193.000	5643.92	1632.85	-1057.83	-1243.88	0.02	
6085.00	0.800	190.200	5779.90	1634.73	-1060.15	-1244.37	0.30	
6221.00	0.800	180.300	5915.88	1636.07	-1062.03	-1244.54	0.10	
6357.00	0.700	182.900	6051.87	1637.26	-1063.81	-1244.59	0.08	
6493.00	0.500	182.100	6187.86	1638.23	-1065.24	-1244.65	0.15	
6627.00	0.500	340.600	6321.86	1638.41	-1065.27	-1244.87	0.73	
6765.00	0.700	274.900	6459.86	1638.79	-1064.63	-1245.91	0.49	
6901.00	0.900	281.100	6595.84	1640.05	-1064.35	-1247.78	0.16	
7037.00	0.900	284.100	6731.83	1641.34	-1063.89	-1249.87	0.03	
7174.00	0.800	292.800	6868.81	1642.40	-1063.25	-1251.79	0.12	
7311.00	0.500	271.000	7005.80	1643.28	-1062.87	-1253.27	0.28	
7447.00	0.400	261.500	7141.80	1644.13	-1062.93	-1254.33	0.09	
7583.00	0.400	273.100	7277.79	1644.88	-1062.98	-1255.28	0.06	
7719.00	0.400	280.200	7413.79	1645.53	-1062.87	-1256.22	0.04	
7855.00	0.400	293.900	7549.79	1646.04	-1062.59	-1257.12	0.07	
7992.00	1.200	341.700	7686.77	1645.71	-1061.04	-1258.01	0.71	
8129.00	0.100	331.500	7823.76	1645.15	-1059.57	-1258.51	0.80	
8266.00	0.400	289.300	7960.76	1645.37	-1059.31	-1259.02	0.24	
8402.00	0.400	288.300	8096.76	1645.86	-1059.00	-1259.92	0.01	
8539.00	0.400	293.500	8233.76	1646.32	-1058.66	-1260.81	0.03	
8711.00	0.600	311.800	8405.75	1646.71	-1057.82	-1262.04	0.15	LAST BHI MWD SURVEYS
8761.00	0.600	311.800	8455.75	1646.79	-1057.47	-1262.43	0.00	PROJECTION TO BIT

HOLE & CASING SECTIONS - Ref Wellbore: SWEETGRASS 15-14 AWB Ref Wellpath: SWEETGRASS 15-14 AWP									
String/Diameter	Start MD [ft]	End MD [ft]	Interval [ft]	Start TVD [ft]	End TVD [ft]	Start N/S [ft]	Start E/W [ft]	End N/S [ft]	End E/W [ft]
12.25in Open Hole	15.00	1199.00	1184.00	15.00	1188.66	0.00	0.00	-77.83	-105.91
8.625in Casing Surface	15.00	1199.00	1184.00	15.00	1188.66	0.00	0.00	-77.83	-105.91
7.875in Open Hole	1199.00	8042.00	6843.00	1188.66	7736.77	-77.83	-105.91	-1060.21	-1258.28



Actual Wellpath Report

SWEETGRASS 15-14 AWP

Page 4 of 5



REFERENCE WELLPATH IDENTIFICATION			
Operator	KERR MCGEE OIL & GAS ONSHORE LP	Slot	SLOT#07 SWEETGRASS 15-14 (1827'FSL & 880'FEL)
Area	COLORADO	Well	SWEETGRASS 15-14
Field	WELD COUNTY (KERR MCGEE)	Wellbore	SWEETGRASS 15-14 AWB
Facility	SEC.14-T1N-R68W		

TARGETS									
Name	MD [ft]	TVD [ft]	North [ft]	East [ft]	Grid East [US ft]	Grid North [US ft]	Latitude	Longitude	Shape
SWEETGRASS 15-14 BHL ON PLAT (810'FSL & 2130'FEL, REV-1)		6000.00	-1042.53	-1245.01	3148718.69	1260173.18	40°02'46.828"N	104°58'07.640"W	point
SWEETGRASS 15-14 GEO TARGET 50' RADIUS (800'FSL & 2130'FEL, REV-3)		6000.00	-1052.57	-1245.05	3148718.71	1260163.14	40°02'46.729"N	104°58'07.640"W	circle
SWEETGRASS 15-14 GEO TARGET 50' RADIUS (804'FSL & 2130'FEL, REV-2)		6000.00	-1048.57	-1245.05	3148718.69	1260167.14	40°02'46.768"N	104°58'07.640"W	point
SWEETGRASS 15-14 LEGAL BOX (50'N,350'S,52'W,348'E OF GEO TARGET)		6000.00	-1202.57	-1097.05	3148867.61	1260014.04	40°02'45.246"N	104°58'05.737"W	square

WELLPATH COMPOSITION - Ref Wellbore: SWEETGRASS 15-14 AWB					Ref Wellpath: SWEETGRASS 15-14 AWP	
Start MD [ft]	End MD [ft]	Positional Uncertainty Model	Log Name/Comment		Wellbore	
15.00	8711.00	NaviTrak (Standard)	BHI MWD SURVEYS <150-8711>		SWEETGRASS 15-14 AWB	
8711.00	8761.00	Blind Drilling (std)	Projection to bit		SWEETGRASS 15-14 AWB	



Actual Wellpath Report

SWEETGRASS 15-14 AWP

Page 5 of 5



REFERENCE WELLPATH IDENTIFICATION

Operator	KERR MCGEE OIL & GAS ONSHORE LP	Slot	SLOT#07 SWEETGRASS 15-14 (1827'FSL & 880'FEL)
Area	COLORADO	Well	SWEETGRASS 15-14
Field	WELD COUNTY (KERR MCGEE)	Wellbore	SWEETGRASS 15-14 AWB
Facility	SEC.14-T1N-R68W		

WELLPATH COMMENTS

MD [ft]	Inclination [°]	Azimuth [°]	TVD [ft]	Comment
8711.00	0.600	311.800	8405.75	LAST BHI MWD SURVEYS
8761.00	0.600	311.800	8455.75	PROJECTION TO BIT