

Anadarko, Weld County CO

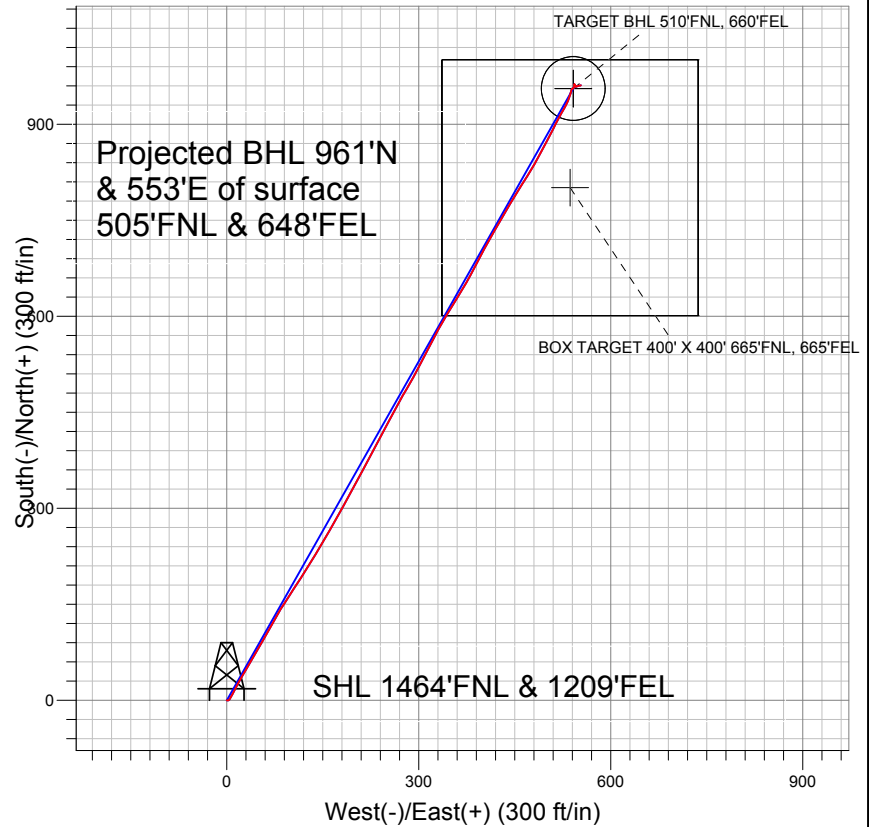

LEGEND

- Badding 1-26, Wellbore #1, Plan #1 (5-9-11) V0
- Wellbore #1
- Survey #1

Final Survey Plot

Projected Final Survey -
8491'MD & 8355'TVD @ 1109'VS
0.4 deg Inc 77.0 deg AZ

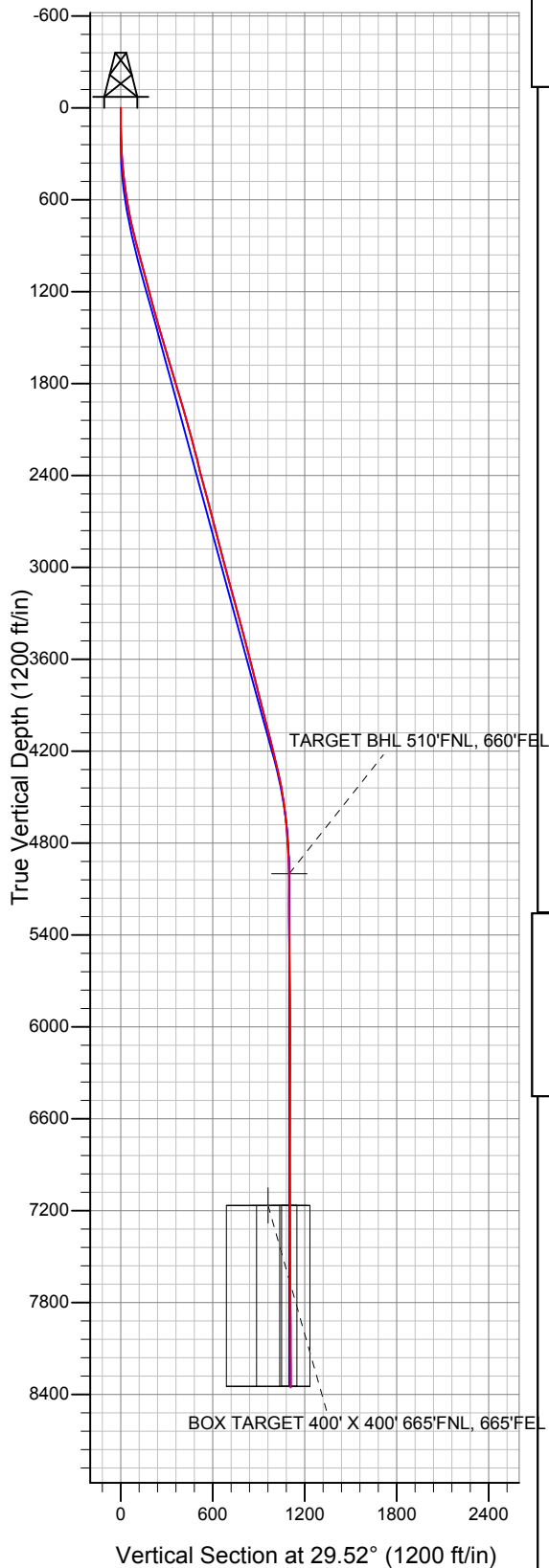

Project: SEC.26-T2N-R66W
Site: Badding 17-26 Pad Sec.26-T2N-R66W
Well: Badding 1-26
Plan: Wellbore #1



Directional

Anadarko, Weld County CO

SEC.26-T2N-R66W

Badding 17-26 Pad Sec.26-T2N-R66W

Badding 1-26

Wellbore #1

Survey: Survey #1

Standard Survey Report

27 June, 2011

Company:	Anadarko, Weld County CO	Local Co-ordinate Reference:	Well Badding 1-26
Project:	SEC.26-T2N-R66W	TVD Reference:	WELL @ 5081.0ft (Original Well Elev)
Site:	Badding 17-26 Pad Sec.26-T2N-R66W	MD Reference:	WELL @ 5081.0ft (Original Well Elev)
Well:	Badding 1-26	North Reference:	True
Wellbore:	Wellbore #1	Survey Calculation Method:	Minimum Curvature
Design:	Wellbore #1	Database:	Landmark

Project	SEC.26-T2N-R66W, Weld County, Colorado		
Map System:	US State Plane 1983	System Datum:	Mean Sea Level
Geo Datum:	North American Datum 1983		Using Well Reference Point
Map Zone:	Colorado Northern Zone		Using geodetic scale factor

Site	Badding 17-26 Pad Sec.26-T2N-R66W				
Site Position:		Northing:	1,284,730.44 ft	Latitude:	40.112471
From:	Lat/Long	Easting:	3,212,820.01 ft	Longitude:	-104.739081
Position Uncertainty:	0.0 ft	Slot Radius:	"	Grid Convergence:	0.49 °

Well	Badding 1-26					
Well Position	+N-S	0.0 ft	Northing:	1,284,729.93 ft	Latitude:	40.112471
	+E-W	0.0 ft	Easting:	3,212,770.23 ft	Longitude:	-104.739259
Position Uncertainty		0.0 ft	Wellhead Elevation:	ft	Ground Level:	5,067.0 ft

Wellbore	Wellbore #1				
Magnetics	Model Name	Sample Date	Declination (°)	Dip Angle (°)	Field Strength (nT)
	IGRF2010	5/9/2011	8.84	66.83	52,992

Design	Wellbore #1				
Audit Notes:					
Version:	1.0	Phase:	ACTUAL	Tie On Depth:	0.0
Vertical Section:	Depth From (TVD) (ft)	+N/-S (ft)	+E/-W (ft)	Direction (°)	
	0.0	0.0	0.0	29.52	

Survey Program	Date	6/27/2011			
From (ft)	To (ft)	Survey (Wellbore)	Tool Name	Description	
118.0	8,491.0	Survey #1 (Wellbore #1)	MWD	MWD - Standard	

Survey										
Measured Depth (ft)	Inclination (°)	Azimuth (°)	Vertical Depth (ft)	+N/-S (ft)	+E/-W (ft)	Vertical Section (ft)	Dogleg Rate (°/100ft)	Build Rate (°/100ft)	Turn Rate (°/100ft)	
0.0	0.00	0.00	0.0	0.0	0.0	0.0	0.00	0.00	0.00	
118.0	1.10	98.90	118.0	-0.2	1.1	0.4	0.93	0.93	0.00	
210.0	1.70	56.10	210.0	0.4	3.1	1.9	1.27	0.65	-46.52	
303.0	3.60	27.20	302.9	3.8	5.6	6.1	2.44	2.04	-31.08	
413.0	5.90	28.10	412.5	11.9	9.8	15.2	2.09	2.09	0.82	
501.0	7.40	28.50	499.9	20.8	14.7	25.4	1.71	1.70	0.45	
590.0	8.70	28.90	588.0	31.8	20.7	37.8	1.46	1.46	0.45	
679.0	10.70	30.40	675.7	44.8	28.1	52.8	2.26	2.25	1.69	
767.0	12.90	30.00	761.9	60.4	37.2	70.8	2.50	2.50	-0.45	
856.0	13.80	29.90	848.5	78.2	47.4	91.4	1.01	1.01	-0.11	
945.0	15.00	29.60	934.7	97.4	58.4	113.5	1.35	1.35	-0.34	
1,033.0	15.40	28.90	1,019.6	117.5	69.7	136.6	0.50	0.45	-0.80	
1,092.0	15.20	30.00	1,076.5	131.1	77.3	152.1	0.60	-0.34	1.86	

Company:	Anadarko, Weld County CO	Local Co-ordinate Reference:	Well Badding 1-26
Project:	SEC.26-T2N-R66W	TVD Reference:	WELL @ 5081.0ft (Original Well Elev)
Site:	Badding 17-26 Pad Sec.26-T2N-R66W	MD Reference:	WELL @ 5081.0ft (Original Well Elev)
Well:	Badding 1-26	North Reference:	True
Wellbore:	Wellbore #1	Survey Calculation Method:	Minimum Curvature
Design:	Wellbore #1	Database:	Landmark

Survey

Measured Depth (ft)	Inclination (°)	Azimuth (°)	Vertical Depth (ft)	+N/-S (ft)	+E/-W (ft)	Vertical Section (ft)	Dogleg Rate (°/100ft)	Build Rate (°/100ft)	Turn Rate (°/100ft)
1,197.0	14.30	33.60	1,178.0	153.8	91.4	178.8	1.22	-0.86	3.43
1,286.0	15.50	32.20	1,264.0	173.0	103.8	201.7	1.41	1.35	-1.57
1,375.0	16.10	32.90	1,349.7	193.4	116.8	225.9	0.71	0.67	0.79
1,463.0	15.60	31.90	1,434.3	213.7	129.7	249.9	0.65	-0.57	-1.14
1,552.0	16.00	30.70	1,520.0	234.4	142.3	274.1	0.58	0.45	-1.35
1,641.0	16.70	30.30	1,605.4	256.0	155.0	299.2	0.80	0.79	-0.45
1,729.0	17.20	29.70	1,689.5	278.2	167.8	324.8	0.60	0.57	-0.68
1,818.0	17.00	29.00	1,774.6	301.0	180.7	351.0	0.32	-0.22	-0.79
1,907.0	16.90	28.50	1,859.7	323.8	193.1	376.9	0.20	-0.11	-0.56
1,995.0	15.60	28.00	1,944.2	345.5	204.8	401.5	1.49	-1.48	-0.57
2,084.0	15.50	28.10	2,030.0	366.5	216.0	425.4	0.12	-0.11	0.11
2,173.0	15.10	27.10	2,115.8	387.3	226.9	448.9	0.54	-0.45	-1.12
2,261.0	15.40	29.30	2,200.7	407.7	237.8	472.0	0.74	0.34	2.50
2,350.0	14.30	28.20	2,286.7	427.7	248.8	494.8	1.28	-1.24	-1.24
2,438.0	14.10	27.80	2,372.1	446.8	259.0	516.4	0.25	-0.23	-0.45
2,527.0	14.50	28.10	2,458.3	466.2	269.3	538.4	0.46	0.45	0.34
2,616.0	15.00	31.60	2,544.4	485.8	280.5	561.0	1.15	0.56	3.93
2,704.0	15.00	28.20	2,629.4	505.6	291.9	583.8	1.00	0.00	-3.86
2,793.0	14.90	27.60	2,715.4	525.9	302.6	606.7	0.21	-0.11	-0.67
2,882.0	15.00	26.60	2,801.3	546.3	313.1	629.7	0.31	0.11	-1.12
2,970.0	14.20	27.80	2,886.5	566.0	323.2	651.8	0.97	-0.91	1.36
3,059.0	14.20	29.30	2,972.8	585.2	333.7	673.7	0.41	0.00	1.69
3,148.0	15.70	31.30	3,058.8	605.0	345.3	696.6	1.78	1.69	2.25
3,236.0	15.50	31.80	3,143.5	625.2	357.6	720.3	0.27	-0.23	0.57
3,325.0	15.20	30.50	3,229.4	645.4	369.8	743.8	0.51	-0.34	-1.46
3,413.0	14.90	28.10	3,314.3	665.3	381.0	766.7	0.79	-0.34	-2.73
3,502.0	15.20	27.60	3,400.3	685.7	391.8	789.8	0.37	0.34	-0.56
3,591.0	14.50	28.50	3,486.3	705.8	402.5	812.6	0.83	-0.79	1.01
3,679.0	14.50	30.00	3,571.5	725.1	413.3	834.6	0.43	0.00	1.70
3,768.0	14.00	29.50	3,657.8	744.1	424.2	856.5	0.58	-0.56	-0.56
3,857.0	13.70	29.80	3,744.2	762.6	434.7	877.8	0.35	-0.34	0.34
3,945.0	14.50	31.80	3,829.5	781.0	445.7	899.2	1.06	0.91	2.27
4,034.0	15.00	32.50	3,915.6	800.2	457.8	921.9	0.60	0.56	0.79
4,123.0	14.50	31.00	4,001.7	819.5	469.7	944.5	0.71	-0.56	-1.69
4,211.0	14.00	30.10	4,087.0	838.1	480.7	966.2	0.62	-0.57	-1.02
4,300.0	13.50	27.20	4,173.4	856.7	490.8	987.3	0.96	-0.56	-3.26
4,389.0	13.50	28.40	4,259.9	875.0	500.5	1,008.1	0.31	0.00	1.35
4,477.0	12.60	26.70	4,345.7	892.7	509.7	1,027.9	1.11	-1.02	-1.93
4,566.0	10.80	28.10	4,432.8	908.7	518.0	1,046.0	2.05	-2.02	1.57
4,654.0	8.40	29.70	4,519.6	921.5	525.1	1,060.6	2.74	-2.73	1.82
4,743.0	6.40	26.20	4,607.8	931.6	530.5	1,072.1	2.30	-2.25	-3.93
4,832.0	5.10	21.30	4,696.4	939.8	534.1	1,081.0	1.56	-1.46	-5.51
4,920.0	4.10	16.40	4,784.1	946.4	536.4	1,087.9	1.22	-1.14	-5.57
5,009.0	2.80	13.30	4,872.9	951.6	537.8	1,093.1	1.48	-1.46	-3.48
5,098.0	1.50	30.40	4,961.9	954.7	538.9	1,096.3	1.61	-1.46	19.21
5,136.2	0.89	30.91	5,000.0	955.4	539.3	1,097.1	1.59	-1.59	1.33
TARGET BHL 510°FNL, 660°FEL									
5,186.0	0.10	40.90	5,049.9	955.8	539.6	1,097.6	1.59	-1.59	20.05
5,319.0	0.30	112.50	5,182.9	955.7	540.0	1,097.7	0.21	0.15	53.83
5,452.0	0.30	60.40	5,315.9	955.8	540.6	1,098.1	0.20	0.00	-39.17
5,585.0	0.40	40.70	5,448.9	956.3	541.2	1,098.8	0.12	0.08	-14.81
5,718.0	0.60	28.60	5,581.9	957.3	541.8	1,100.0	0.17	0.15	-9.10
5,851.0	0.90	18.20	5,714.8	958.9	542.5	1,101.7	0.25	0.23	-7.82
5,984.0	1.10	8.90	5,847.8	961.1	543.0	1,103.9	0.19	0.15	-6.99

Company:	Anadarko, Weld County CO	Local Co-ordinate Reference:	Well Badding 1-26
Project:	SEC.26-T2N-R66W	TVD Reference:	WELL @ 5081.0ft (Original Well Elev)
Site:	Badding 17-26 Pad Sec.26-T2N-R66W	MD Reference:	WELL @ 5081.0ft (Original Well Elev)
Well:	Badding 1-26	North Reference:	True
Wellbore:	Wellbore #1	Survey Calculation Method:	Minimum Curvature
Design:	Wellbore #1	Database:	Landmark

Survey

Measured Depth (ft)	Inclination (°)	Azimuth (°)	Vertical Depth (ft)	+N/-S (ft)	+E/-W (ft)	Vertical Section (ft)	Dogleg Rate (°/100ft)	Build Rate (°/100ft)	Turn Rate (°/100ft)
6,117.0	0.10	317.50	5,980.8	962.5	543.1	1,105.1	0.78	-0.75	-38.65
6,250.0	0.20	150.90	6,113.8	962.3	543.2	1,105.0	0.22	0.08	-125.26
6,383.0	0.40	161.90	6,246.8	961.7	543.4	1,104.6	0.16	0.15	8.27
6,516.0	0.50	149.60	6,379.8	960.8	543.9	1,104.0	0.10	0.08	-9.25
6,649.0	0.40	150.00	6,512.8	959.9	544.4	1,103.5	0.08	-0.08	0.30
6,782.0	0.30	140.40	6,645.8	959.2	544.8	1,103.1	0.09	-0.08	-7.22
6,915.0	0.30	113.80	6,778.8	958.8	545.4	1,103.0	0.10	0.00	-20.00
7,048.0	0.10	98.80	6,911.8	958.6	545.8	1,103.1	0.15	-0.15	-11.28
7,181.0	0.10	45.50	7,044.8	958.7	546.0	1,103.3	0.07	0.00	-40.08
7,303.0	0.10	45.50	7,166.8	958.8	546.2	1,103.5	0.00	0.00	0.00
BOX TARGET 400' X 400' 665'FNL, 665'FEL									
7,303.2	0.10	45.50	7,167.0	958.8	546.2	1,103.5	0.00	0.00	0.00
TARGET CIRCLE 510'FNL, 660'FEL									
7,314.0	0.10	44.90	7,177.8	958.8	546.2	1,103.5	0.01	0.00	-5.55
7,447.0	0.22	47.90	7,310.8	959.1	546.4	1,103.8	0.09	0.09	2.26
7,580.0	0.40	72.00	7,443.8	959.4	547.1	1,104.4	0.16	0.14	18.12
7,712.0	0.31	78.60	7,575.8	959.6	547.9	1,105.0	0.07	-0.07	5.00
7,845.0	0.30	61.00	7,708.8	959.9	548.5	1,105.5	0.07	-0.01	-13.23
7,978.0	0.48	74.00	7,841.8	960.2	549.4	1,106.2	0.15	0.14	9.77
8,111.0	0.40	77.10	7,974.8	960.4	550.3	1,106.9	0.06	-0.06	2.33
8,244.0	0.50	85.10	8,107.8	960.6	551.4	1,107.6	0.09	0.08	6.02
8,377.0	0.40	77.00	8,240.8	960.8	552.4	1,108.2	0.09	-0.08	-6.09
8,491.0	0.40	77.00	8,354.8	960.9	553.2	1,108.8	0.00	0.00	0.00

Checked By: _____ Approved By: _____ Date: _____