

# KERR MCGEE OIL & GAS ONSHORE LP

Location: COLORADO Slot: SLOT#10 CARTER 9-32SX (2321'FSL & 1524'FEL)  
 Field: WELD COUNTY (KERR MCGEE) Well: CARTER 9-32SX  
 Facility: SEC.32-T2N-R66W Wellbore: CARTER 9-32SX PWB

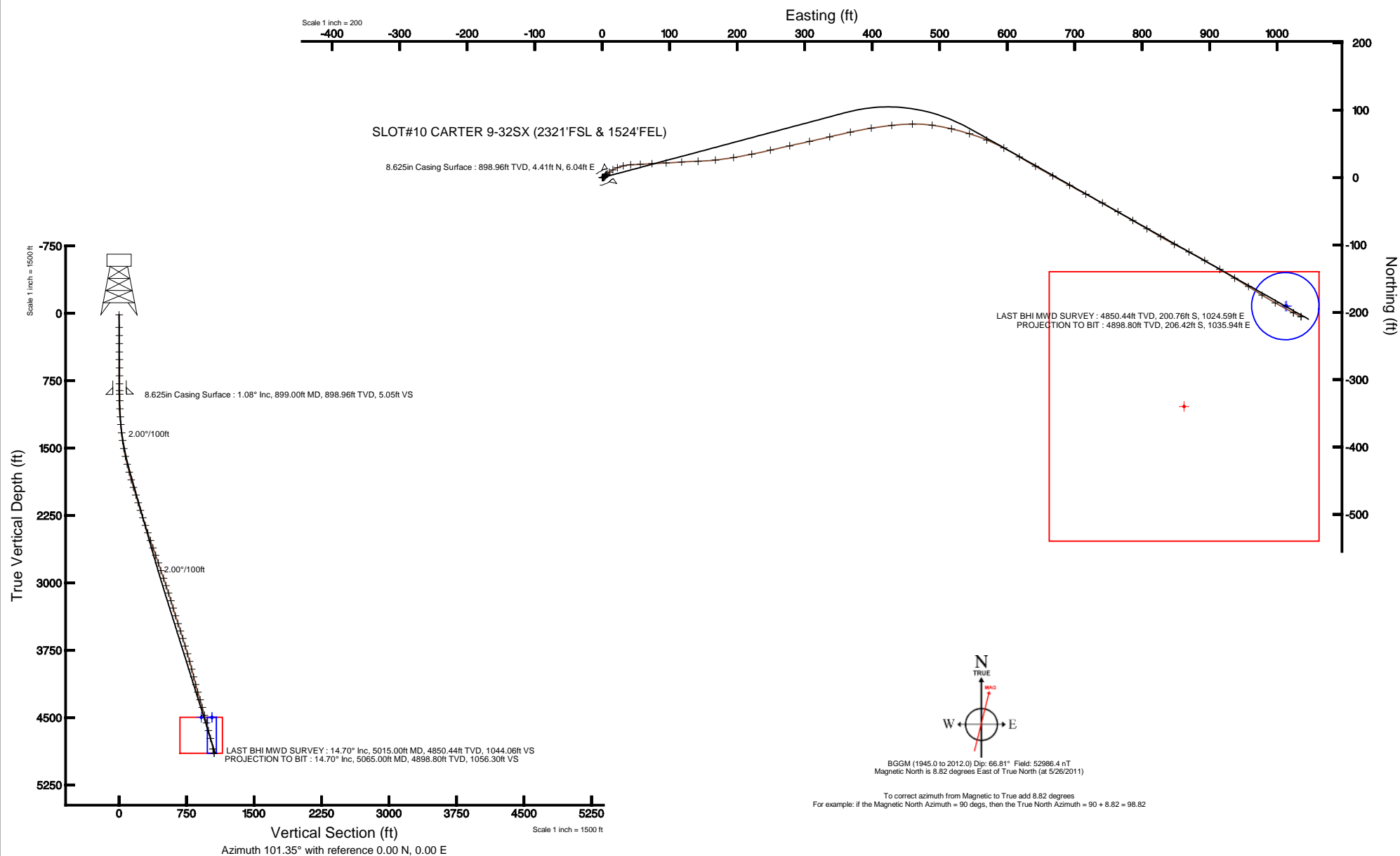

Plot reference wellpath is CARTER 9-32SX (REV-B.1) PWP	
True vertical depths are referenced to XTREME 6 (RKB)	Grid System: NAD83 / Lambert Colorado SP, Northern Zone (501), US feet
Measured depths are referenced to XTREME 6 (RKB)	North Reference: True north
XTREME 6 (RKB) to Mean Sea Level: 4929 feet	Scale: True distance
Mean Sea Level to Mud line (At Slot: SLOT#10 CARTER 9-32SX (2321'FSL & 1524'FEL)): 0 feet	Depths are in feet
Coordinates are in feet referenced to Slot	Created by: painsetr on 7/20/2011





# Actual Wellpath Report

CARTER 9-32SX AWP

Page 1 of 5



## REFERENCE WELLPATH IDENTIFICATION

Operator	KERR MCGEE OIL & GAS ONSHORE LP	Slot	SLOT#10 CARTER 9-32SX (2321'FSL & 1524'FEL)
Area	COLORADO	Well	CARTER 9-32SX
Field	WELD COUNTY (KERR MCGEE)	Wellbore	CARTER 9-32SX
Facility	SEC.32-T2N-R66W		

## REPORT SETUP INFORMATION

Projection System	NAD83 / Lambert Colorado SP, Northern Zone (501), US feet	Software System	WellArchitect® 3.0.0
North Reference	True	User	Painsetr
Scale	0.999961	Report Generated	7/20/2011 at 1:51:51 PM
Convergence at slot	0.45° East	Database/Source file	WA_Denver/CARTER_9-32SX.xml

## WELLPATH LOCATION

	Local coordinates		Grid coordinates		Geographic coordinates	
	North[ft]	East[ft]	Easting[US ft]	Northing[US ft]	Latitude	Longitude
Slot Location	-0.28	90.03	3196659.57	1277768.78	40°05'37.417"N	104°47'49.402"W
Facility Reference Pt			3196569.55	1277768.35	40°05'37.420"N	104°47'50.560"W
Field Reference Pt			3197771.84	1268891.29	40°04'09.600"N	104°47'36.000"W

## WELLPATH DATUM

Calculation method	Minimum curvature	XTREME 6 (RKB) to Facility Vertical Datum	4929.00ft
Horizontal Reference Pt	Slot	XTREME 6 (RKB) to Mean Sea Level	4929.00ft
Vertical Reference Pt	XTREME 6 (RKB)	XTREME 6 (RKB) to Mud Line at Slot (SLOT#10 CARTER 9-32SX (2321'FSL & 1524'FEL))	4929.00ft
MD Reference Pt	XTREME 6 (RKB)	Section Origin	N 0.00, E 0.00 ft
Field Vertical Reference	Mean Sea Level	Section Azimuth	101.35°



# Actual Wellpath Report

CARTER 9-32SX AWP

Page 2 of 5



## REFERENCE WELLPATH IDENTIFICATION

Operator	KERR MCGEE OIL & GAS ONSHORE LP	Slot	SLOT#10 CARTER 9-32SX (2321'FSL & 1524'FEL)
Area	COLORADO	Well	CARTER 9-32SX
Field	WELD COUNTY (KERR MCGEE)	Wellbore	CARTER 9-32SX
Facility	SEC.32-T2N-R66W		

## WELLPATH DATA (58 stations) † = interpolated/extrapolated station

MD [ft]	Inclination [°]	Azimuth [°]	TVD [ft]	Vert Sect [ft]	North [ft]	East [ft]	DLS [°/100ft]	Comments
0.00†	0.000	73.200	0.00	0.00	0.00	0.00	0.00	
16.00	0.000	73.200	16.00	0.00	0.00	0.00	0.00	
155.00	0.300	73.200	155.00	0.32	0.11	0.35	0.22	
245.00	0.400	80.600	245.00	0.82	0.22	0.88	0.12	
336.00	0.400	98.800	336.00	1.44	0.23	1.51	0.14	
427.00	0.400	79.900	426.99	2.05	0.23	2.14	0.14	
514.00	0.400	52.100	513.99	2.53	0.47	2.68	0.22	
605.00	0.700	41.900	604.99	3.02	1.08	3.30	0.35	
694.00	0.800	38.700	693.98	3.58	1.97	4.05	0.12	
783.00	1.000	37.700	782.97	4.21	3.07	4.91	0.23	
859.00	0.700	38.700	858.96	4.72	3.96	5.61	0.40	
972.00	1.800	52.800	971.93	6.21	5.57	7.45	1.00	
1062.00	3.300	50.700	1061.84	8.79	8.07	10.58	1.67	
1151.00	4.800	59.500	1150.62	13.19	11.58	15.78	1.82	
1238.00	5.200	68.600	1237.29	19.22	14.87	22.58	1.02	
1329.00	6.300	77.400	1327.83	27.25	17.46	31.30	1.55	
1417.00	7.900	85.500	1415.15	37.48	18.99	42.04	2.14	
1507.00	10.500	87.900	1503.99	51.41	19.77	56.40	2.92	
1596.00	12.300	86.200	1591.23	68.44	20.70	73.97	2.06	
1687.00	14.200	87.600	1679.80	88.64	21.81	94.79	2.12	
1777.00	15.500	86.200	1766.79	110.98	23.07	117.82	1.50	
1865.00	16.400	87.900	1851.41	134.41	24.30	141.97	1.15	
1954.00	17.500	84.100	1936.54	159.41	26.14	167.84	1.75	
2043.00	17.900	80.200	2021.33	184.94	29.84	194.63	1.41	
2133.00	17.800	78.800	2107.00	210.55	34.87	221.75	0.49	
2222.00	19.100	77.000	2191.42	236.38	40.79	249.28	1.59	
2311.00	19.400	77.400	2275.45	263.15	47.29	277.90	0.37	
2400.00	20.000	77.800	2359.24	290.61	53.73	307.20	0.69	
2489.00	20.500	76.700	2442.74	318.73	60.53	337.24	0.71	
2579.00	20.500	77.400	2527.04	347.46	67.59	367.96	0.27	



# Actual Wellpath Report

CARTER 9-32SX AWP

Page 3 of 5



## REFERENCE WELLPATH IDENTIFICATION

Operator	KERR MCGEE OIL & GAS ONSHORE LP	Slot	SLOT#10 CARTER 9-32SX (2321'FSL & 1524'FEL)
Area	COLORADO	Well	CARTER 9-32SX
Field	WELD COUNTY (KERR MCGEE)	Wellbore	CARTER 9-32SX
Facility	SEC.32-T2N-R66W		

## WELLPATH DATA (58 stations)

MD [ft]	Inclination [°]	Azimuth [°]	TVD [ft]	Vert Sect [ft]	North [ft]	East [ft]	DLS [°/100ft]	Comments
2668.00	20.800	80.900	2610.32	376.51	73.49	398.77	1.43	
2756.00	20.000	83.700	2692.81	405.49	77.61	429.16	1.43	
2847.00	19.500	89.000	2778.46	435.16	79.59	459.81	2.04	
2936.00	18.900	97.800	2862.53	464.06	77.89	488.95	3.32	
3026.00	18.900	103.800	2947.68	493.17	72.43	517.55	2.16	
3113.00	18.500	106.600	3030.09	521.00	65.13	544.47	1.13	
3200.00	17.900	113.300	3112.75	547.82	55.90	569.98	2.50	
3291.00	17.800	117.100	3199.37	574.89	44.03	595.20	1.28	
3378.00	17.800	122.000	3282.21	600.14	30.92	618.32	1.72	
3467.00	18.500	119.600	3366.78	626.28	16.74	642.13	1.15	
3558.00	19.300	118.900	3452.87	654.33	2.34	667.85	0.91	
3646.00	18.700	118.900	3536.08	681.64	-11.51	692.93	0.68	
3733.00	18.000	118.200	3618.66	707.81	-24.60	716.99	0.84	
3823.00	17.800	118.500	3704.30	734.26	-37.73	741.34	0.24	
3912.00	16.800	120.600	3789.27	759.40	-50.77	764.36	1.32	
4002.00	16.300	120.300	3875.54	783.63	-63.77	786.46	0.56	
4091.00	15.400	119.600	3961.16	806.67	-75.90	807.52	1.03	
4180.00	15.300	121.000	4046.98	828.95	-87.79	827.86	0.43	
4269.00	15.000	117.500	4132.89	851.07	-99.16	848.14	1.08	
4357.00	17.100	117.100	4217.46	874.46	-110.31	869.76	2.39	
4446.00	17.600	120.300	4302.41	899.78	-123.06	893.03	1.21	
4536.00	16.000	120.600	4388.57	924.36	-136.24	915.46	1.78	
4627.00	16.400	121.300	4475.95	948.28	-149.30	937.23	0.49	
4714.00	15.800	121.700	4559.54	970.93	-161.90	957.80	0.70	
4803.00	15.000	122.000	4645.34	993.07	-174.37	977.88	0.90	
4893.00	14.500	119.200	4732.38	1014.69	-186.04	997.59	0.97	
5015.00	14.700	118.000	4850.44	1044.06	-200.76	1024.59	0.30	LAST BHI MWD SURVEY
5065.00	14.700	115.000	4898.80	1056.30	-206.42	1035.94	1.52	PROJECTION TO BIT



# Actual Wellpath Report

CARTER 9-32SX AWP

Page 4 of 5



## REFERENCE WELLPATH IDENTIFICATION

Operator	KERR MCGEE OIL & GAS ONSHORE LP	Slot	SLOT#10 CARTER 9-32SX (2321'FSL & 1524'FEL)
Area	COLORADO	Well	CARTER 9-32SX
Field	WELD COUNTY (KERR MCGEE)	Wellbore	CARTER 9-32SX
Facility	SEC.32-T2N-R66W		

## HOLE & CASING SECTIONS - Ref Wellbore: CARTER 9-32SX Ref Wellpath: CARTER 9-32SX AWP

String/Diameter	Start MD [ft]	End MD [ft]	Interval [ft]	Start TVD [ft]	End TVD [ft]	Start N/S [ft]	Start E/W [ft]	End N/S [ft]	End E/W [ft]
8.625in Casing Surface	16.00	899.00	883.00	16.00	898.96	0.00	0.00	4.41	6.04

## TARGETS

Name	MD [ft]	TVD [ft]	North [ft]	East [ft]	Grid East [US ft]	Grid North [US ft]	Latitude	Longitude	Shape
CARTER 9-32SX BHL ON PLAT (2130'FSL & 510'FEL, REV-1)		4499.00	-190.85	1014.49	3197675.50	1277585.99	40°05'35.531"N	104°47'36.348"W	point
CARTER 9-32SX GEO TARGET 50' RADIUS (2130'FSL & 512'FEL, REV-2)		4499.00	-190.87	1012.49	3197673.50	1277585.95	40°05'35.531"N	104°47'36.374"W	circle
CARTER 9-32SX LEGAL BOX (51'N,349'S,50'E,350'W OF GEO TARGET)		4499.00	-339.87	862.49	3197524.69	1277435.77	40°05'34.058"N	104°47'38.304"W	square

## WELLPATH COMPOSITION - Ref Wellbore: CARTER 9-32SX Ref Wellpath: CARTER 9-32SX AWP

Start MD [ft]	End MD [ft]	Positional Uncertainty Model	Log Name/Comment	Wellbore
16.00	859.00	NaviTrak (Standard)	BHI MWD SURVEYS 12 1/4 HOLE<155-859>	CARTER 9-32SX
859.00	5015.00	NaviTrak (Standard)	BHI MWD SURVEYS 7 7/8 HOLE<972-5015>	CARTER 9-32SX
5015.00	5065.00	Blind Drilling (std)	Projection to bit	CARTER 9-32SX



# Actual Wellpath Report

CARTER 9-32SX AWP

Page 5 of 5



## REFERENCE WELLPATH IDENTIFICATION

Operator	KERR MCGEE OIL & GAS ONSHORE LP	Slot	SLOT#10 CARTER 9-32SX (2321'FSL & 1524'FEL)
Area	COLORADO	Well	CARTER 9-32SX
Field	WELD COUNTY (KERR MCGEE)	Wellbore	CARTER 9-32SX
Facility	SEC.32-T2N-R66W		

## WELLPATH COMMENTS

MD [ft]	Inclination [°]	Azimuth [°]	TVD [ft]	Comment
5015.00	14.700	118.000	4850.44	LAST BHI MWD SURVEY
5065.00	14.700	115.000	4898.80	PROJECTION TO BIT