

# NEI C18-24D

## Noble Energy, Inc

### NW/4SE/4 Section 18, Township 4 North, Range 64 West

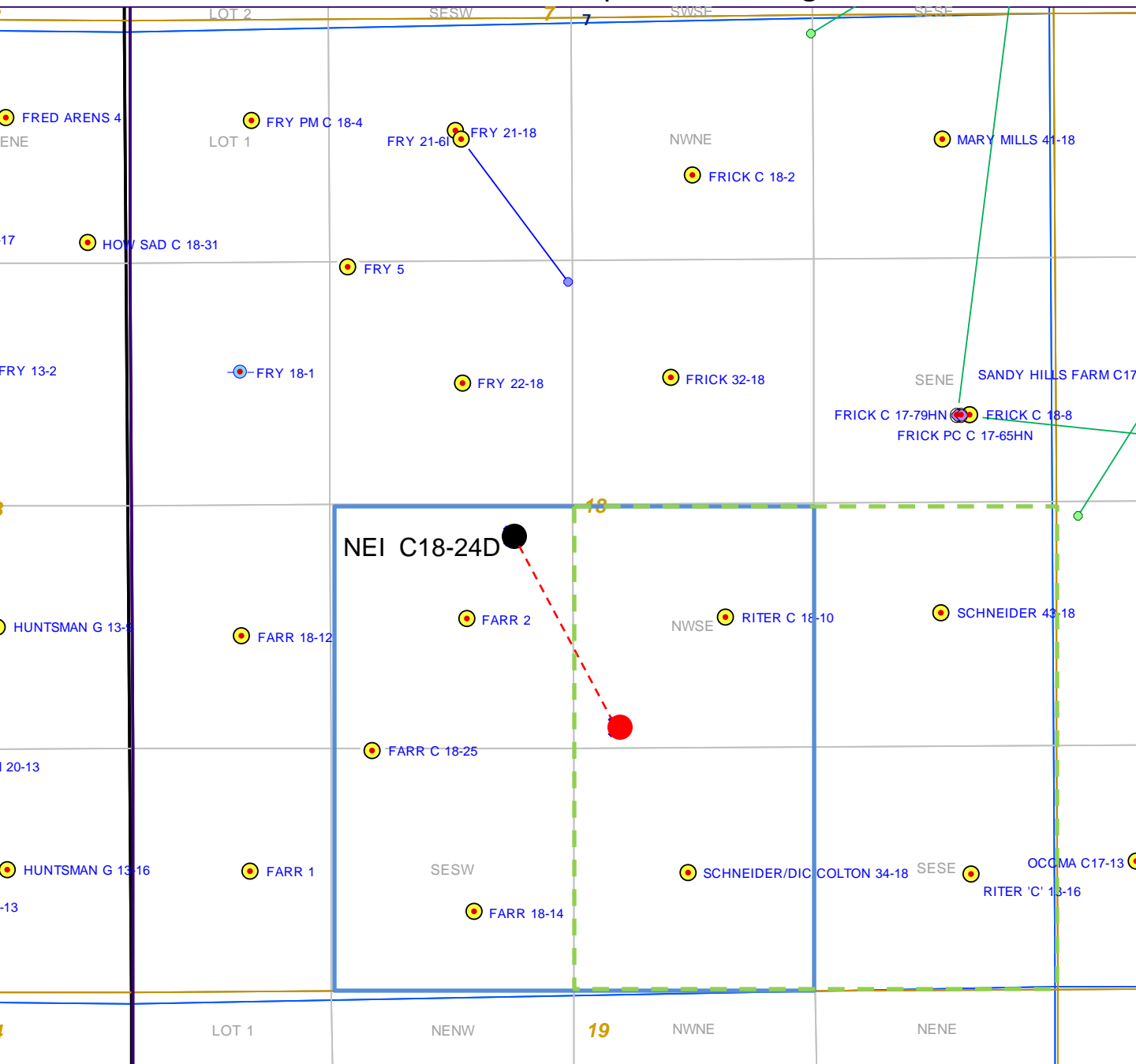

#### Legend



Proposed 160 acre spacing unit



Bottom Hole Location



Bottom Hole Located SE/4 Section 18, T4N-R64W

The governmental  $\frac{1}{4}$  Section has less than 8 bottom hole wells producing from the Codell, Niobrara, and J-Sand formations.