

EOG RESOURCES, INC.

ADDENDUM TO LEGAL PLAT FOR

LION CREEK #20-29H
SECTION 29, T11N, R64W, 6th P.M.
501' FNL 501' FWL

SCALE: 1" = 200'

DATE: 05-31-11

DRAWN BY: K.O.

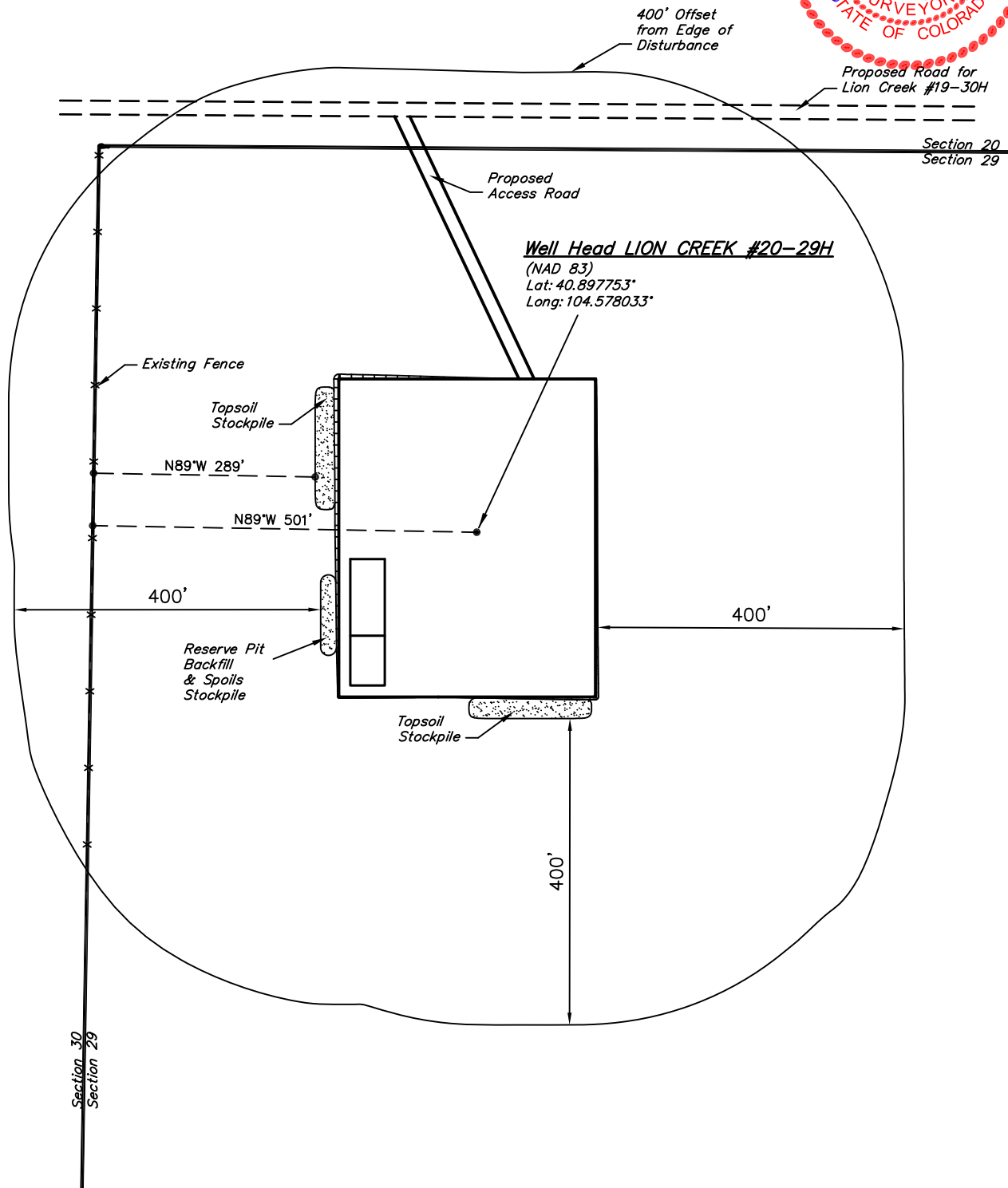
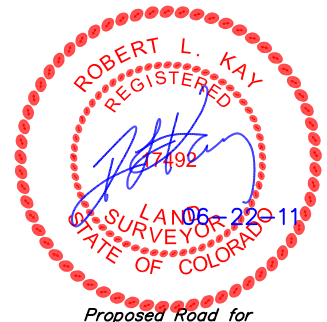

UINTAH ENGINEERING & LAND SURVEYING

85 So. 200 East * Vernal, Utah 84078 * (435) 789-1017

EOG RESOURCES, INC.

CONSTRUCTION LAYOUT FOR

LION CREEK #20-29H
SECTION 29, T11N, R64W, 6th P.M.
501' FNL 501' FWL

FIGURE #1

SCALE: 1" = 60'

DATE: 05-31-11

DRAWN BY: K.O.

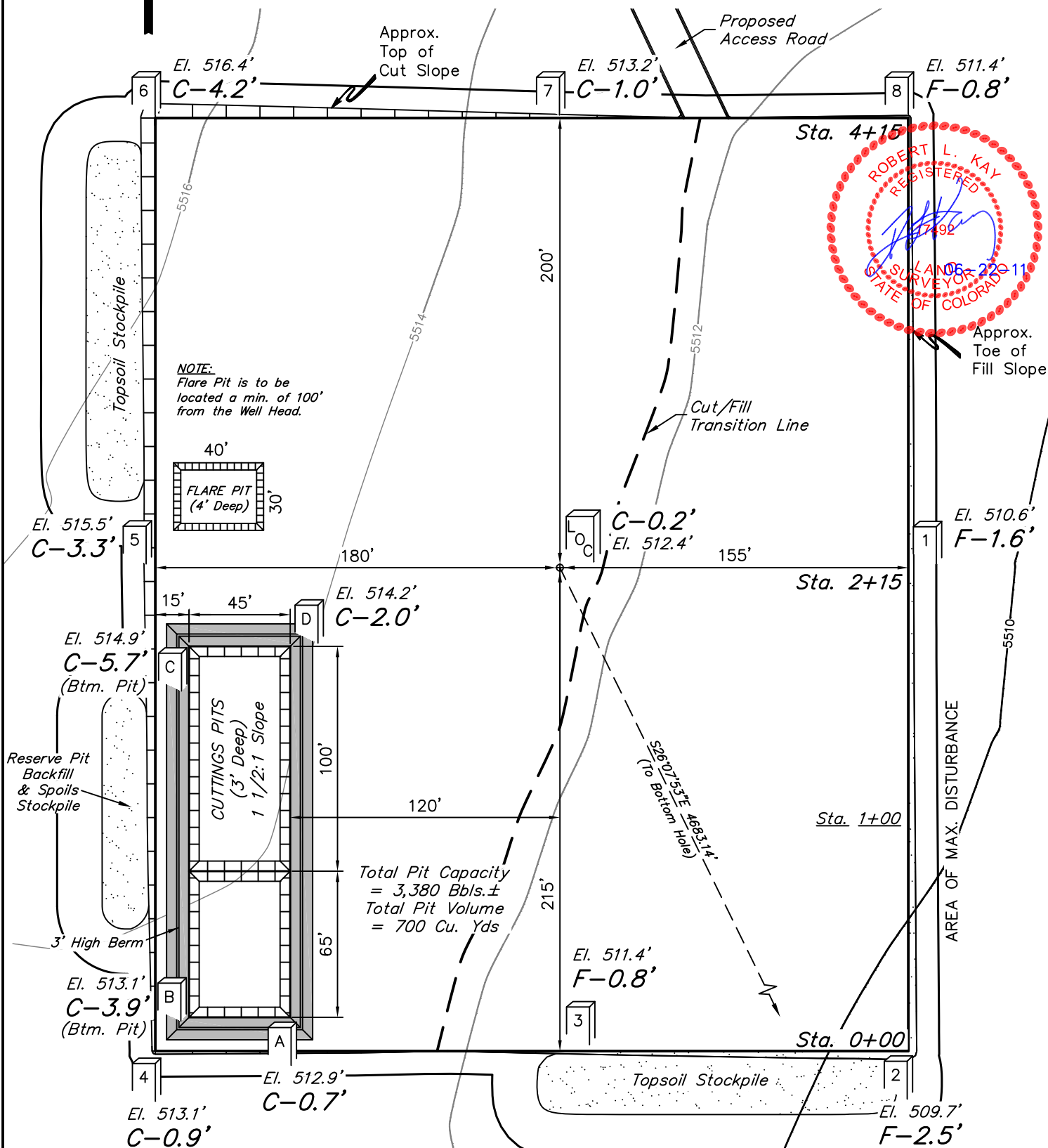

Elev. Ungraded Ground At Loc. Stake = 5512.4'
FINISHED GRADE ELEV. AT LOC. STAKE = 5512.2'

UINTAH ENGINEERING & LAND SURVEYING
85 So. 200 East * Vernal, Utah 84078 * (435) 789-1017

EOG RESOURCES, INC.

CONSTRUCTION LAYOUT CROSS SECTIONS FOR

LION CREEK #20-29H
SECTION 29, T11N, R64W, 6th P.M.
501' FNL 501' FWL

FIGURE #2

1" = 40'
X-Section
Scale
1" = 100'

DATE: 05-31-11
DRAWN BY: K.O.

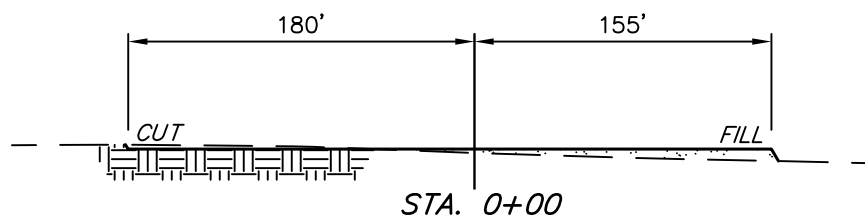
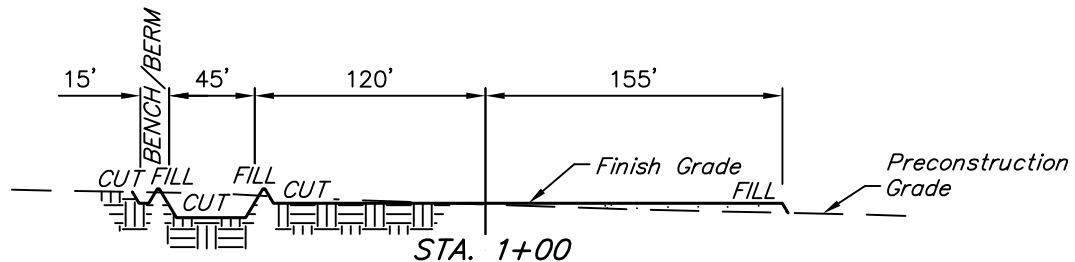
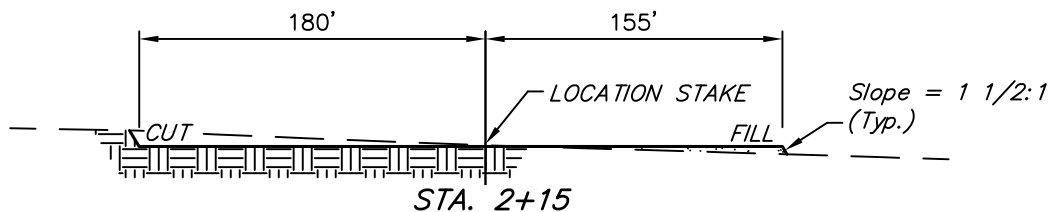
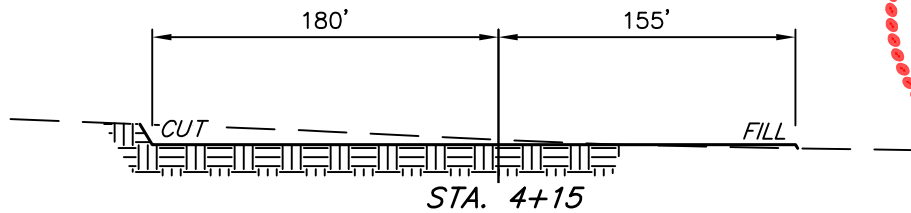

NOTE:

Topsoil should not be Stripped Below Finished Grade on Substructure Area.

APPROXIMATE ACREAGES

WELL SITE DISTURBANCE = ± 4.047 ACRES
ACCESS ROAD DISTURBANCE = ± 0.268 ACRES
TOTAL = ± 4.315 ACRES

* NOTE:
FILL QUANTITY INCLUDES 5% FOR COMPACTION

APPROXIMATE YARDAGES

(6") Topsoil Stripping = 2,690 Cu. Yds.
Remaining Location = 3,970 Cu. Yds.
TOTAL CUT = 6,660 CU.YDS.
FILL = 3,620 CU.YDS.

EXCESS MATERIAL = 3,040 Cu. Yds.
Topsoil & Pit Backfill (1/2 Pit Vol.) = 3,040 Cu. Yds.
EXCESS UNBALANCE = 0 Cu. Yds.
(After Interim Rehabilitation)

UINTAH ENGINEERING & LAND SURVEYING
85 So. 200 East * Vernal, Utah 84078 * (435) 789-1017

EOG RESOURCES, INC.

TYPICAL RIG LAYOUT FOR

LION CREEK #20-29H
SECTION 29, T11N, R64W, 6th P.M.
501' FNL 501' FWL

FIGURE #3

SCALE: 1" = 60'

DATE: 05-31-11

DRAWN BY: K.O.



Proposed
Access Road



DATA

NOTE:
Flare Pit is to be
located a min. of 100'
from the Well Head.

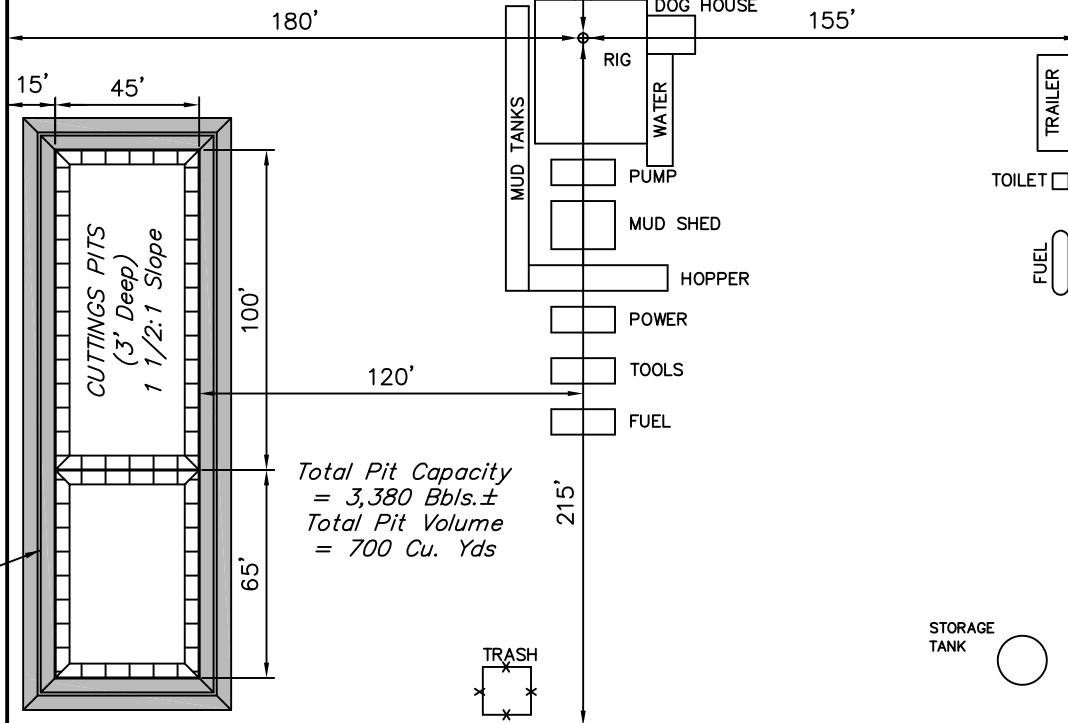
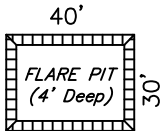

EOG RESOURCES, INC.
 RECLAMATION DIAGRAM FOR
 LION CREEK #20-29H
 SECTION 29, T11N, R64W, 6th P.M.
 501' FNL 501' FWL

FIGURE #4
 SCALE: 1" = 60'
 DATE: 05-31-11
 DRAWN BY: K.O.

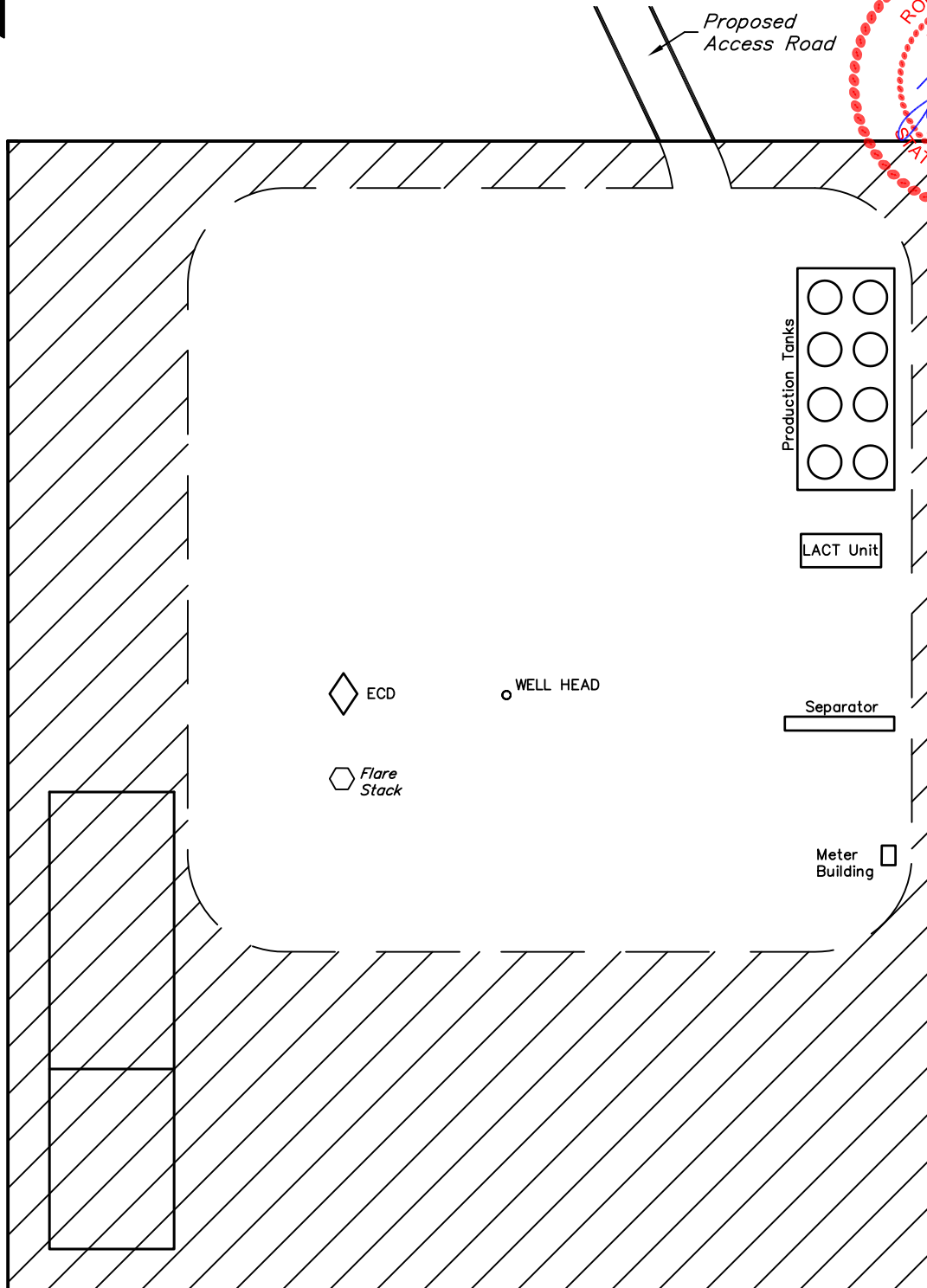
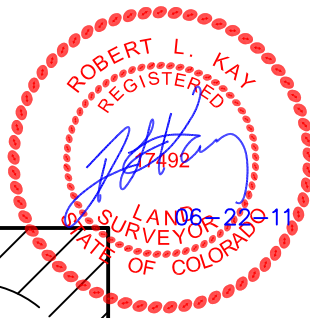

APPROXIMATE ACREAGES
 UN-RECLAIMED = ± 1.553 ACRES



EOG RESOURCES, INC.

LOCATION DRAWING FOR

LION CREEK #20-29H
SECTION 29, T11N, R64W, 6th P.M.
501' FNL 501' FWL

FIGURE #5

1920 Brass Cap,
0.6' Above Ground
Lat: 40.899133°
Long: 104.579819°

N89°37'52"W - 2642.77' (Meas.)

Proposed
Access Road

N64°E 5088'

(To Power Line)

N64°E 5104'

(To Building)

N89°W 501'

(To Property Line)

S63°W 14.6 Miles

(To Railroad)

S89°E 1.7 Miles
(To County Road #55)

S76°E 2209'

(To Water Well)

BEVJAC LAND
CATTLE LLC

1920 Brass Cap,
0.2' Below Ground
Lat: 40.899103°
Long: 104.570264°

1/16 Section Line

Section Line
500°55'55"W - 2641.99' (Meas.)

1/4 Section Line

1920 Brass Cap,
0.8' High Above Ground
Lat: 40.891886°
Long: 104.579953°

1/4 Section Line

29

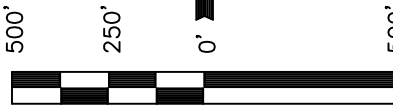

SCALE
DATE: 05-31-11
DRAWN BY: K.O.

PLANT COMMUNITY

- ☐ DISTURBED GRASSLAND
- ☐ NATIVE GRASSLAND
- ☐ SHRUB LAND
- ☐ PLAINS RIPARIAN
- ☐ MOUNTAIN RIPARIAN
- ☐ FOREST LAND
- ☐ WETLANDS AQUATIC
- ☐ ALPINE
- ☐ OTHER (Describe): _____

CURRENT LAND USE

- CROP LAND: ☐ IRRIGATED ☐ DRY LAND ☐ IMPROVED PASTURE ☐ HAY MEADOW ☐ CRP
- NON-CROP LAND: ☐ RANGELAND ☐ TIMBER ☐ RECREATIONAL ☐ OTHER (Describe) _____
- SUBDIVIDED: ☐ INDUSTRIAL ☐ COMMERCIAL ☐ RESIDENTIAL _____

FUTURE LAND USE

- CROP LAND: ☐ IRRIGATED ☐ DRY LAND ☐ IMPROVED PASTURE ☐ HAY MEADOW ☐ CRP
- NON-CROP LAND: ☐ RANGELAND ☐ TIMBER ☐ RECREATIONAL ☐ OTHER (Describe) _____
- SUBDIVIDED: ☐ INDUSTRIAL ☐ COMMERCIAL ☐ RESIDENTIAL _____

UINTAH ENGINEERING & LAND SURVEYING
85 So. 200 East * Vernal, Utah 84078 * (435) 789-1017