

LOCATION DRAWING

VEGETATION:
PASTURE

SURFACE USE:
GRAZING

REFERENCE POINT

LATITUDE: 40.55452
LONGITUDE: -104.12547
FOOTAGE: 400 FSL 600 FWL
GROUND ELEVATION: 4973.5
PDOP: 2.4 DATE: 8/15/2011
INSTRUMENT OPERATOR: GEORGE ALLEN

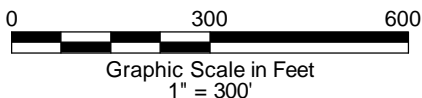
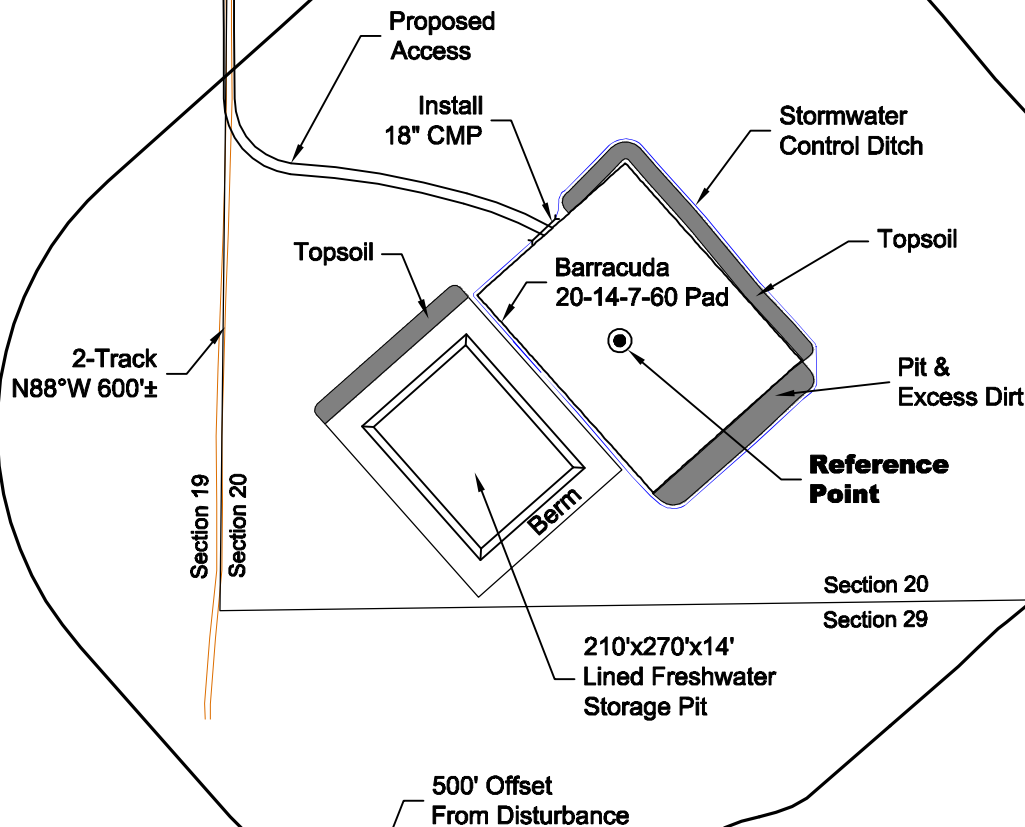

DISTURBANCE ACREAGE:
4.0± DRILLING OPERATIONS
2.6± FRESHWATER STORAGE PIT
1.0± INTERIM RECLAIM

NOTE:

ALL PRODUCTION FACILITIES WILL BE ON PAD.

8/18/11

GEO SURV

LAND SURVEYING AND MAPPING
LAFAYETTE - WINTER PARK
Ph 303 666 0379 Fx 303 665 6320

CARRIZO OIL & GAS, INC
BARRACUDA 20-14-7-60 PAD

SW1/4 SW1/4 SECTION 20 T7N R60W
6th PM WELD COUNTY COLORADO