

# ENSIGN

## Directional

### Well Name: Booth USX EE25-02D

Surface Location: Booth USX EE25-02D Pad Sec.25-T7N-R65W  
North American Datum 1983 , US State Plane 1983 , Colorado Northern Zone

Ground Elevation: 4821.0

+N/-S	+E/-W	Northing	Easting	Latitude	Longitude	Slot
0.0	0.0	1442876.89	3245511.39	40.545740	-104.616570	
Original Well Elev WELL @ 4834.0ft (Original Well Elev)						

## NOBLE ENERGY INC WELD COUNTY CO

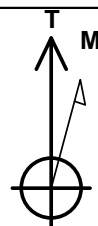
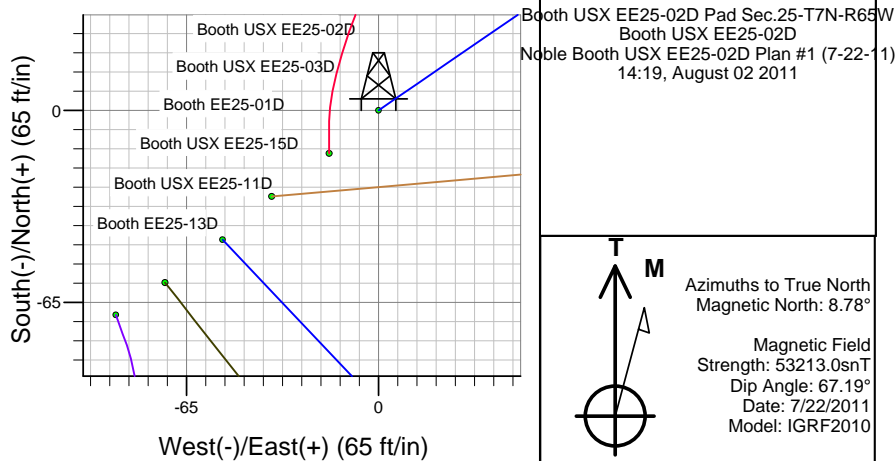
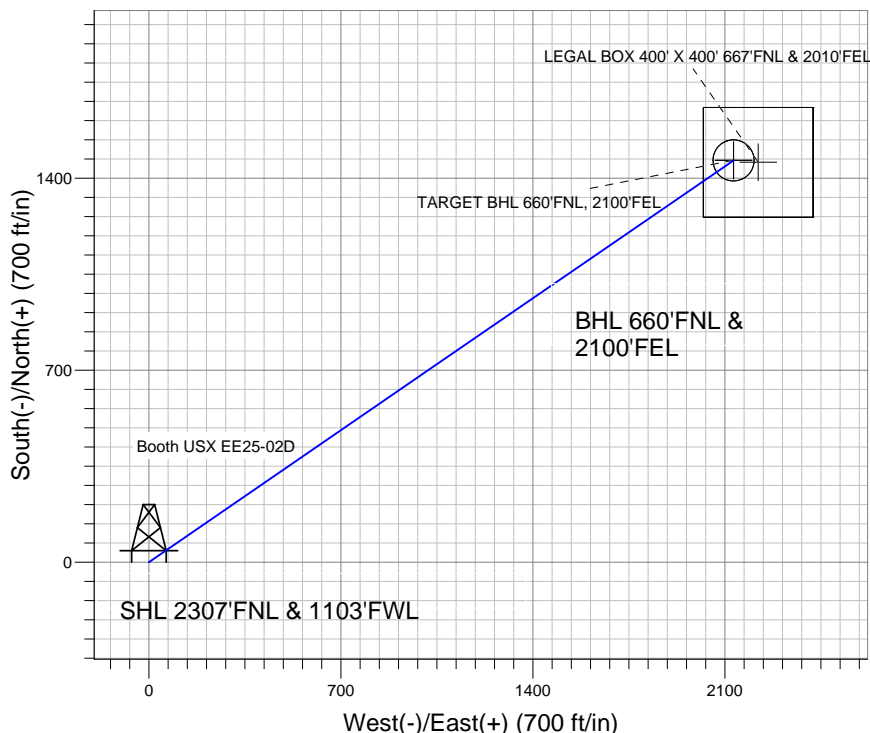
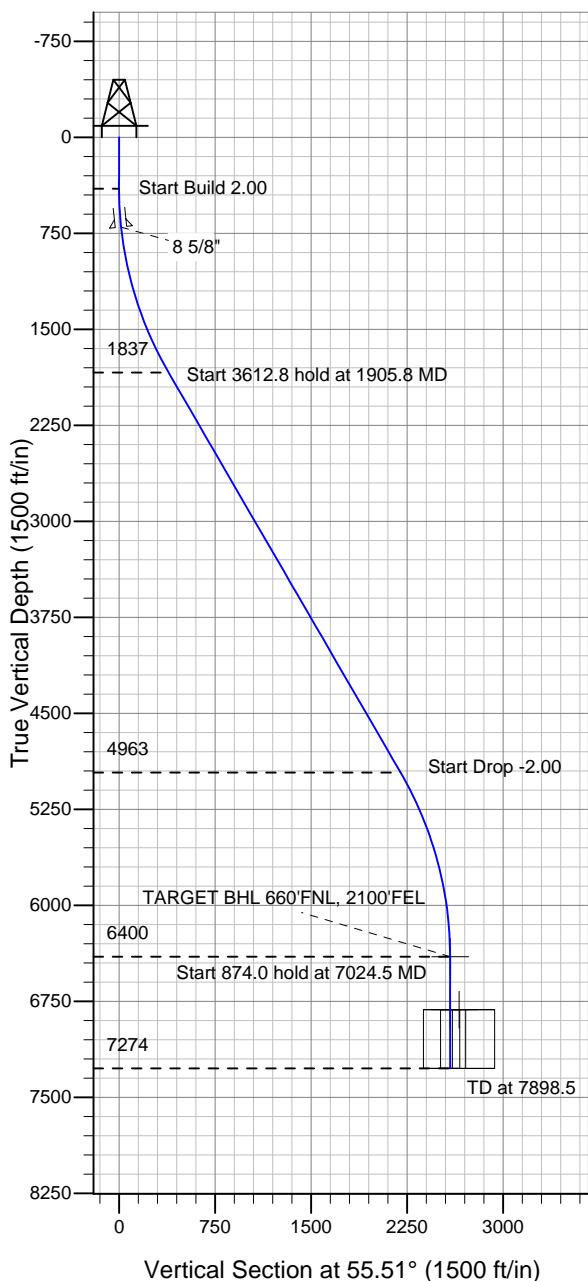

Azimuths to True North  
Magnetic North: 8.78°

Magnetic Field  
Strength: 53213.0snT  
Dip Angle: 67.19°  
Date: 7/22/2011  
Model: IGRF2010

### WELLBORE TARGET DETAILS (LAT/LONG)

Name	TVD	+N/-S	+E/-W	Latitude	Longitude	Shape
TARGET BHL 660'FNL, 2100'FEL	6400.0	1464.7	2131.5	40.549760	-104.608900	Point
LEGAL BOX 400' X 400' 667'FNL & 2010'FEL	6814.0	1457.7	2221.5	40.549741	-104.608576	Rectangle (Sides: L400.0 W400.0)
TARGET CIRCLE 660'FNL & 2100'FEL	6814.0	1464.7	2131.5	40.549760	-104.608900	Circle (Radius: 75.0)

### SECTION DETAILS

Sec	MD	Inc	Azi	TVD	+N/-S	+E/-W	DLeg	TFace	VSec	Target
1	0.0	0.00	0.00	0.0	0.0	0.0	0.00	0.00	0.0	
2	400.0	0.00	0.00	400.0	0.0	0.0	0.00	0.00	0.0	
3	1905.8	30.12	55.51	1837.4	219.0	318.7	2.00	55.51	386.7	
4	5518.7	30.12	55.51	4962.6	1245.7	1812.8	0.00	0.00	2199.5	
5	7024.5	0.00	0.00	6400.0	1464.7	2131.5	2.00	180.00	2586.2	TARGET BHL 660'FNL, 2100'FEL
6	7898.5	0.00	0.00	7274.0	1464.7	2131.5	0.00	0.00	2586.2	