

ACCESS ROAD MAP

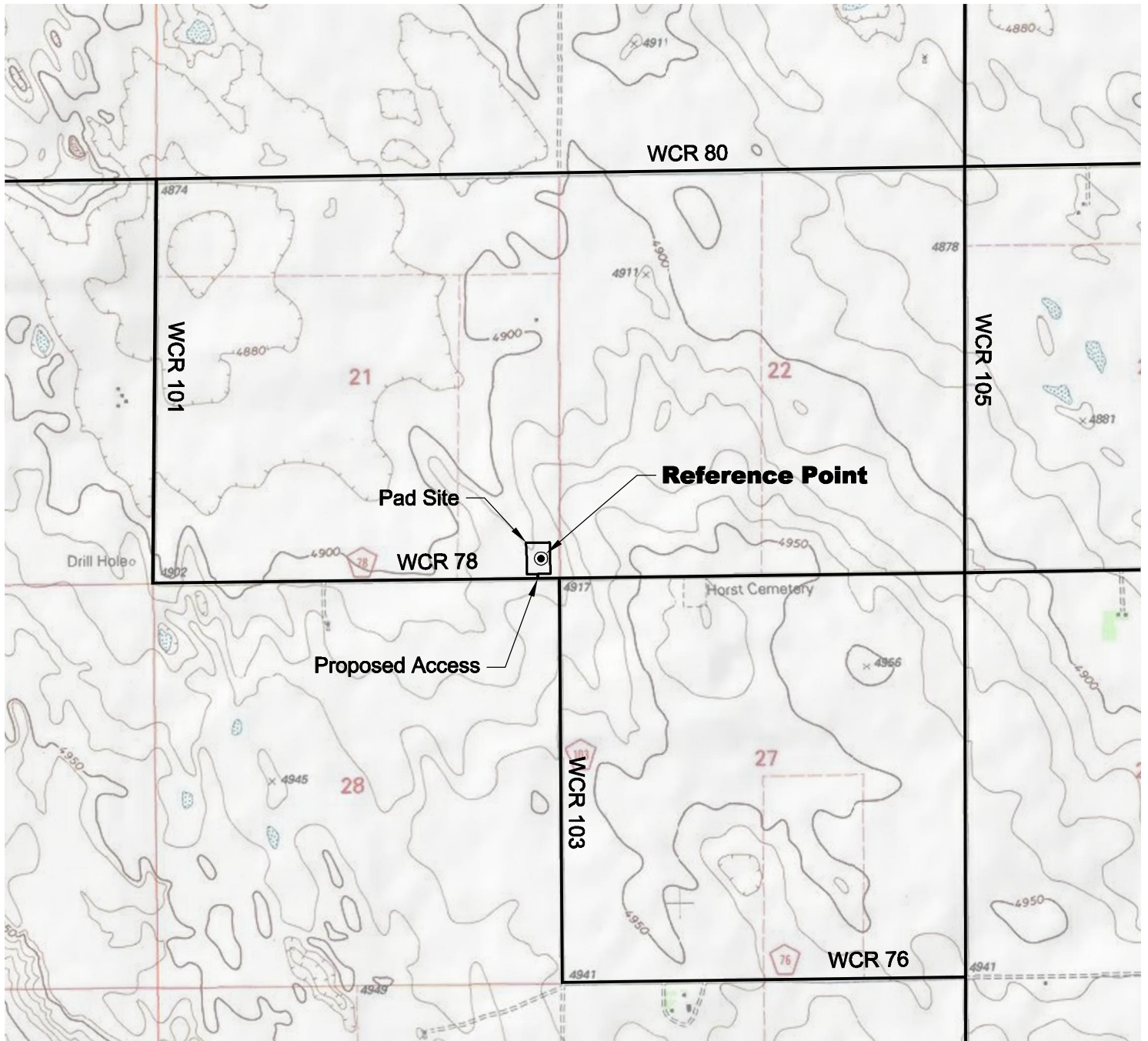

DRIVING DIRECTIONS:

MP 0.0 - Intersection of Highway 14 a.k.a. WCR 90 & Highway 392 a.k.a. WCR 77 in Briggsdale; East on Highway 14
 MP 13.9 - Right on WCR 105
 MP 19.9 - Right on WCR 78
 MP 21.0 - Right on access onto Orlando Hill 21-44-7-60 Pad

4/11/11

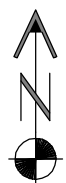

North



Graphic Scale in Feet
 1 inch = 2000 feet



LAND SURVEYING AND MAPPING
 LAFAYETTE - WINTER PARK
 Ph 303 666 0379 Fx 303 665 6320

CARRIZO OIL & GAS, INC
ORLANDO 21-44-7-60 PAD

SE1/4 SE1/4 SECTION 21 T7N R60W
6th PM WELD COUNTY COLORADO