

REFERENCE AREA MAP

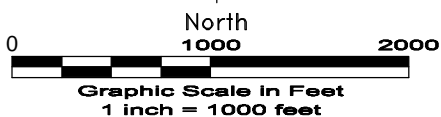
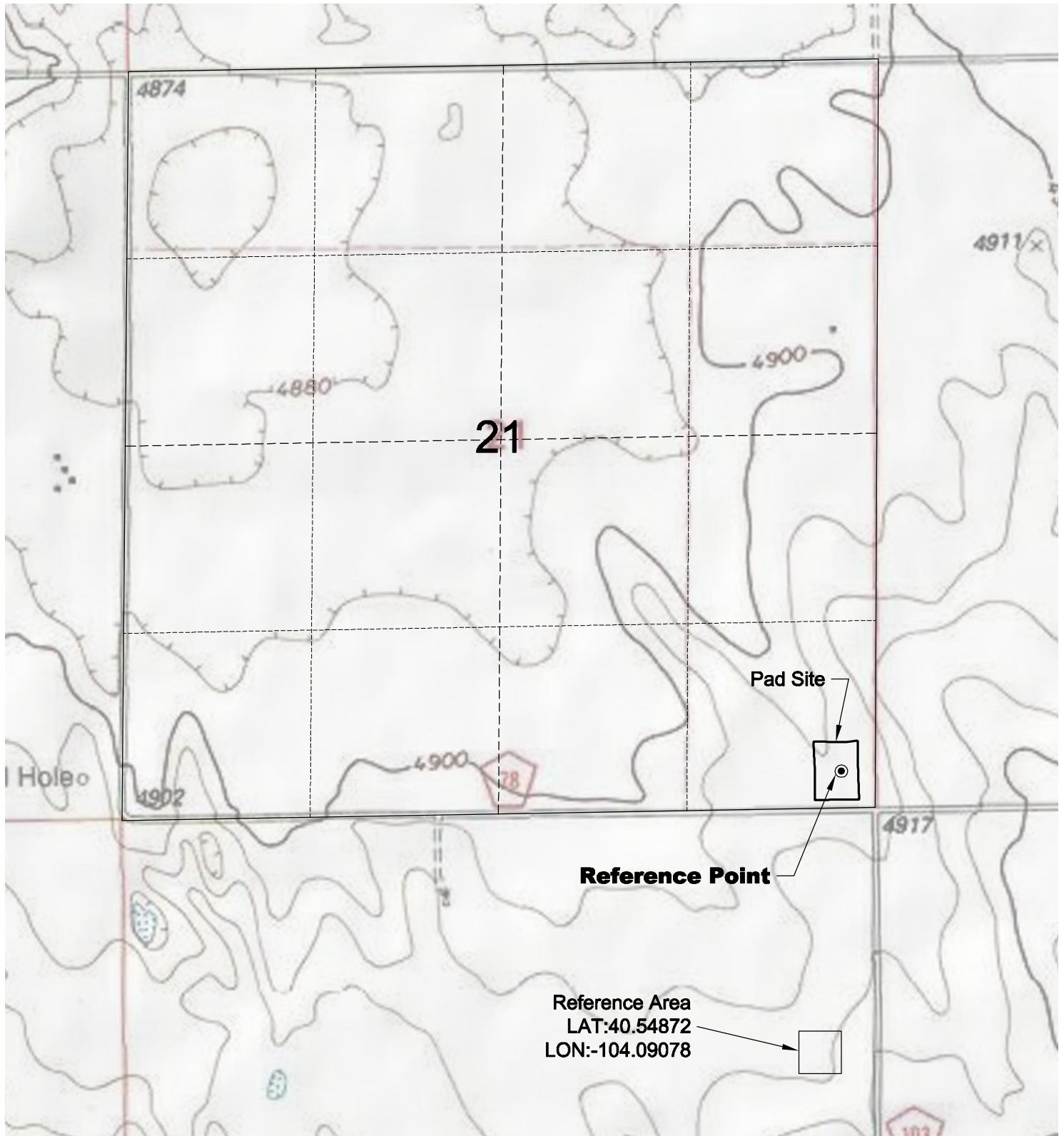

LAND SURVEYING AND MAPPING
LAFAYETTE - WINTER PARK
Ph 303 666 0379 Fx 303 665 6320

CARRIZO OIL & GAS, INC
ORLANDO 21-44-7-60 PAD

SE1/4 SE1/4 SECTION 21 T7N R60W
6th PM WELD COUNTY COLORADO

4/11/11