

SECTION: 10
TOWNSHIP: 11N
RANGE: 64W

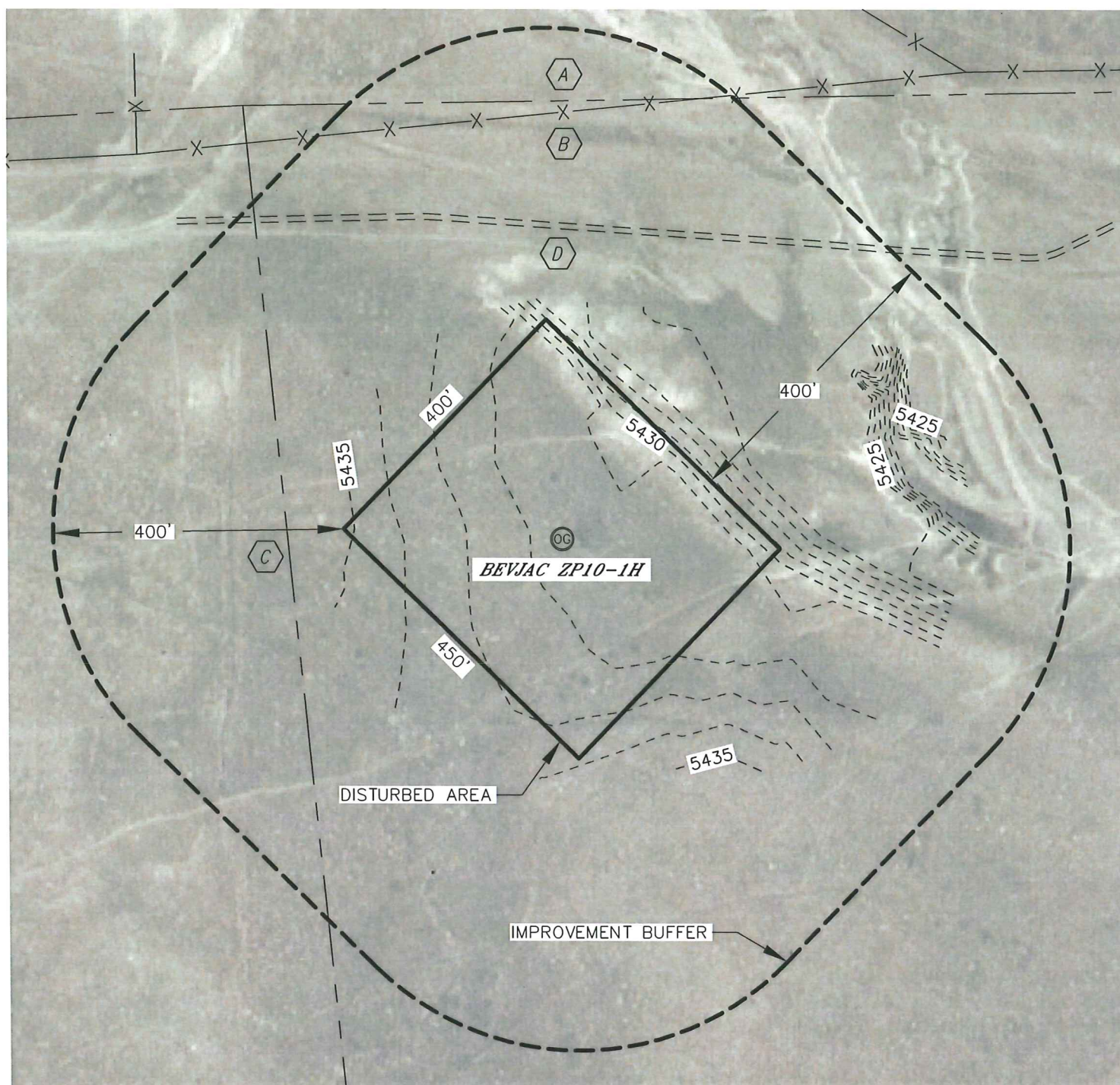

A PROPERTY LINE 600' NORTH

B FENCE 581' NORTH

C PROPERTY LINE 376' WEST

D 2-TRACK FIELD ROAD 423' NORTH

NEAREST: BUILDING=5280'+, PUBLIC ROAD=4934' E, ABOVE GROUND
UTILITY=5280'+, RAILROAD=5280'+, PROPERTY LINE=376' W

PROJECT#: 2011010

