

LEGEND:

 EXISTING LOCATION

EnCana OIL & GAS (USA) INC.

WELL PAD L27 496

SECTION 27, T4S, R96W, 6th P.M.

NW 1/4 SW 1/4

SHEET 8 of 11



Uintah Engineering & Land Surveying
85 South 200 East Vernal, Utah 84078
(435) 789-1017 * FAX (435) 789-1813



**TOPOGRAPHIC
MAP**

4 4 07
MONTH DAY YEAR

SCALE: 1:100,000 DRAWN BY: J.L.G. REV: 08-10-11 Z.L.



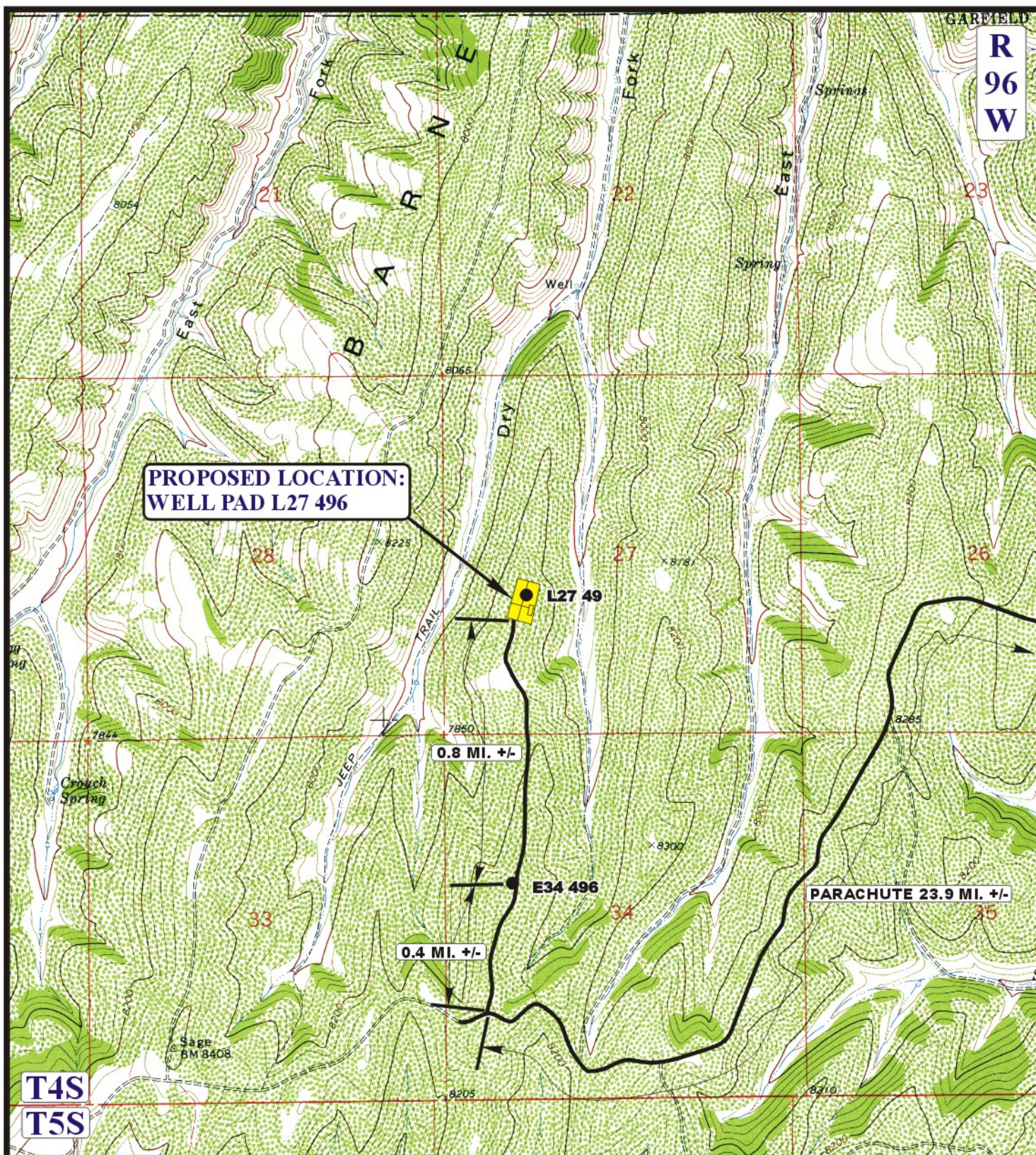

LEGEND:

— EXISTING ROAD



Encana OIL & GAS (USA) INC.

WELL PAD L27 496

SECTION 27, T4S, R96W, 6th P.M.

NW 1/4 SW 1/4

SHEET 9 of 11



Uintah Engineering & Land Surveying
85 South 200 East Vernal, Utah 84078
(435) 789-1017 * FAX (435) 789-1813

SCALE: 1" = 2000'

DRAWN BY: J.L.G.

4 MONTH 4 DAY 07 YEAR

REV: 08-10-11 Z.L.

B TOPO

Encana OIL & GAS (USA) INC.
WELL PAD L27 496
SECTION 27, T4S, R96W, 6th P.M.

PROCEED IN A NORTHWESTERLY DIRECTION FROM PARACHUTE, COLORADO ALONG COUNTY ROAD 215 APPROXIMATELY 10.8 MILES TO THE JUNCTION OF THIS ROAD AND AN EXISTING ROAD TO THE NORTHWEST; TURN LEFT AND PROCEED IN A NORTHWESTERLY DIRECTION APPROXIMATELY 10.0 MILES TO THE JUNCTION OF THIS ROAD AND AN EXISTING ROAD SOUTHWEST; TURN LEFT AND PROCEED IN A SOUTHWESTERLY DIRECTION APPROXIMATELY 3.1 MILES TO THE JUNCTION OF THIS ROAD AND AN EXISTING ROAD TO THE NORTH; TURN RIGHT AND PROCEED IN A NORTHERLY DIRECTION APPROXIMATELY 0.4 MILES TO THE E34 496 PAD AND AN EXISTING ROAD TO THE NORTH; PROCEED IN A NORTHERLY DIRECTION APPROXIMATELY 0.8 MILES TO THE PROPOSED WELL LOCATION.

TOTAL DISTANCE FROM PARACHUTE, COLORADO TO THE PROPOSED WELL LOCATION IS APPROXIMATELY 25.1 MILES.