

TRUE OIL COMPANY
CONSTRUCTION LAYOUT FOR

BREEZE UNIT #41-22
SECTION 22, T6N, R89W, 6th P.M.
883' FNL 661' FEL

SCALE 1"=60'
DATE: 07-11-11
Drawn By: LD

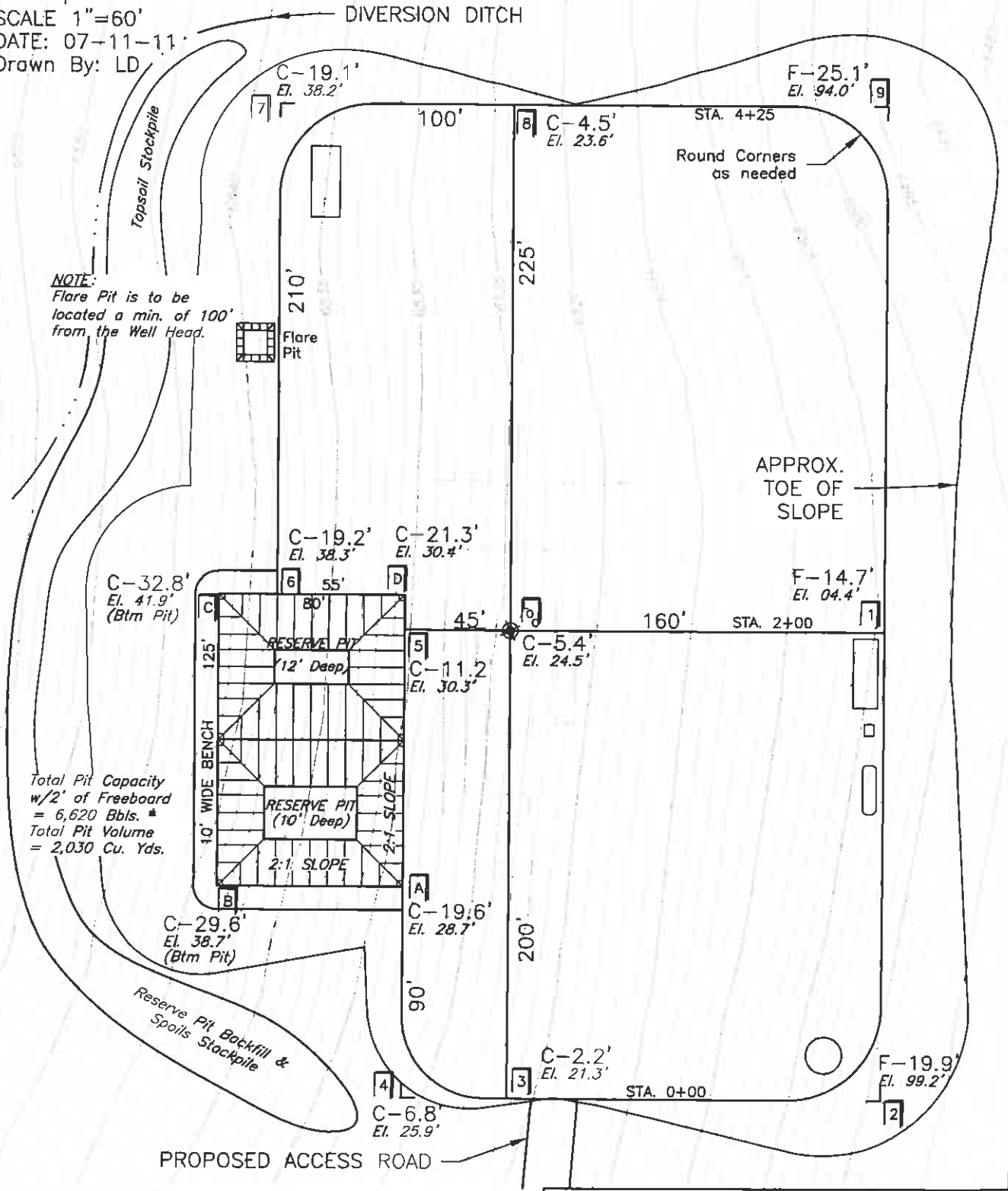

NOTE:
Flare Pit is to be located a min. of 100' from the Well Head.

Total Pit Capacity w/2' of Freeboard = 6,620 Bbls. *
Total Pit Volume = 2,030 Cu. Yds.

FIGURE #1

Elev. Ungraded Ground at Location Stake = 6524.54
Elev. Graded Ground at Location Stake = 6519.07



EPP & ASSOCIATES, INC.
PROFESSIONAL LAND SURVEYORS
433 4th Avenue West
P.O. Box 837
Craig, CO 81625
Phone (970) 824-8236
Fax (970) 824-5227

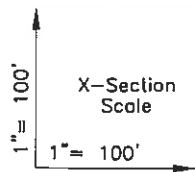

TRUE OIL COMPANY
CONSTRUCTION LAYOUT CROSS-SECTIONS for

FIGURE #2

BREEZE UNIT #41-22
SECTION 22, T6N, R89W, 6th P.M.
883' FNL 661' FEL

SCALE 1"=100'
DATE: 07-11-11
Drawn By: LD

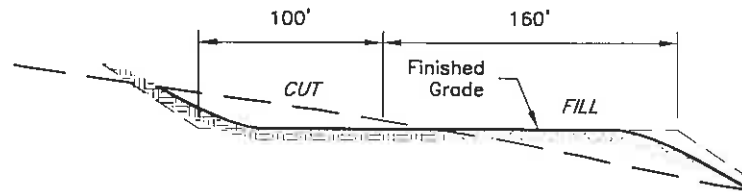

STA 4+00

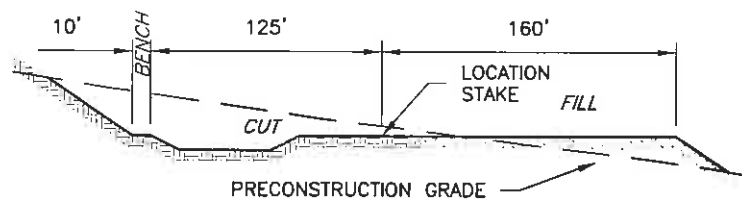

STA 2+00

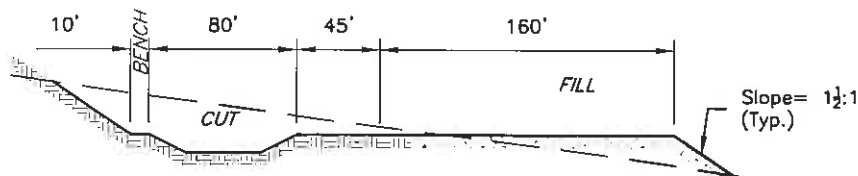

STA 0+65

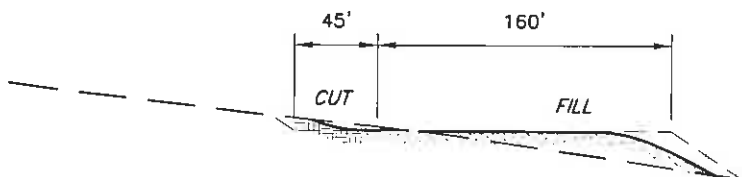

STA 0+00

NOTE:
Topsoil should not
be Stripped Below
Finished Grade on
Substructure Area

APPROXIMATE YARDAGES

CUT
(6") Topsoil Stripping = 2,803 cy
Remaining Location = 27,100 cy
TOTAL CUT = 29,903 cy
FILL = 23,384 cy

*NOTE:
FILL QUANTITY INCLUDES 5% FOR COMPACTION

EXCESS MATERIAL = 3,717 cy
Topsoil & Pit Backfill = 3,818 cy
(1/2 Pit Vol.)
EXCESS UNBALANCE
(After Rehabilitation) = 101 cy



EPP & ASSOCIATES, INC.
PROFESSIONAL LAND SURVEYORS
433 4th Avenue West
P.O. Box 837
Craig, CO 81625
Phone (970) 824-8236
Fax (970) 824-5227

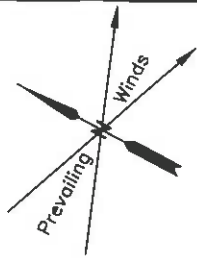

TRUE OIL COMPANY

TYPICAL RIG LAYOUT FOR

BREEZE UNIT #41-22
SECTION 22, T6N, R89W, 6th P.M.
883' FNL 661' FEL

SCALE 1"=60'
DATE: 07-11-11
Drawn By: LD

NOTE:
Flare Pit is to be
located a min. of 100'
from the Well Head.

Total Pit Capacity
w/2' of Freeboard
= 6,620 Bbls. ■
Total Pit Volume
= 2,030 Cu. Yds.

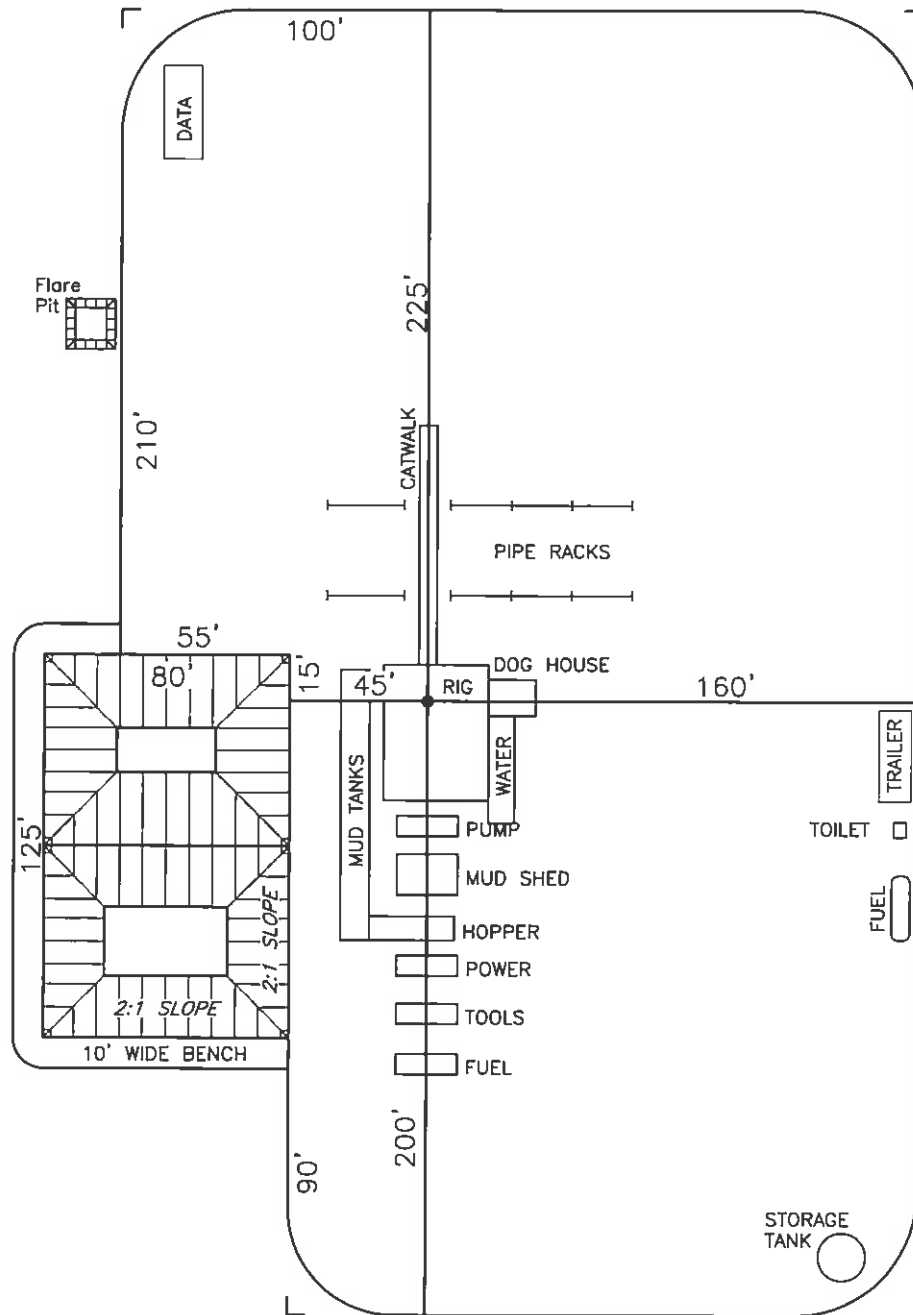

FIGURE #3



EPP & ASSOCIATES, INC.
PROFESSIONAL LAND SURVEYORS
433 4th Avenue West
P.O. Box 837
Craig, CO 81625
Phone (970) 824-8236
Fax (970) 824-5227