

SWEPI LP
CONSTRUCTION LAYOUT FOR
GNAT HILL #1-29
SECTION 29, T6N, R89W, 6th. P.M.
2374' FSL 360' FEL

FIGURE #1

SCALE: 1" = 50'
DATE: 07-07-11
DRAWN BY: J.I.

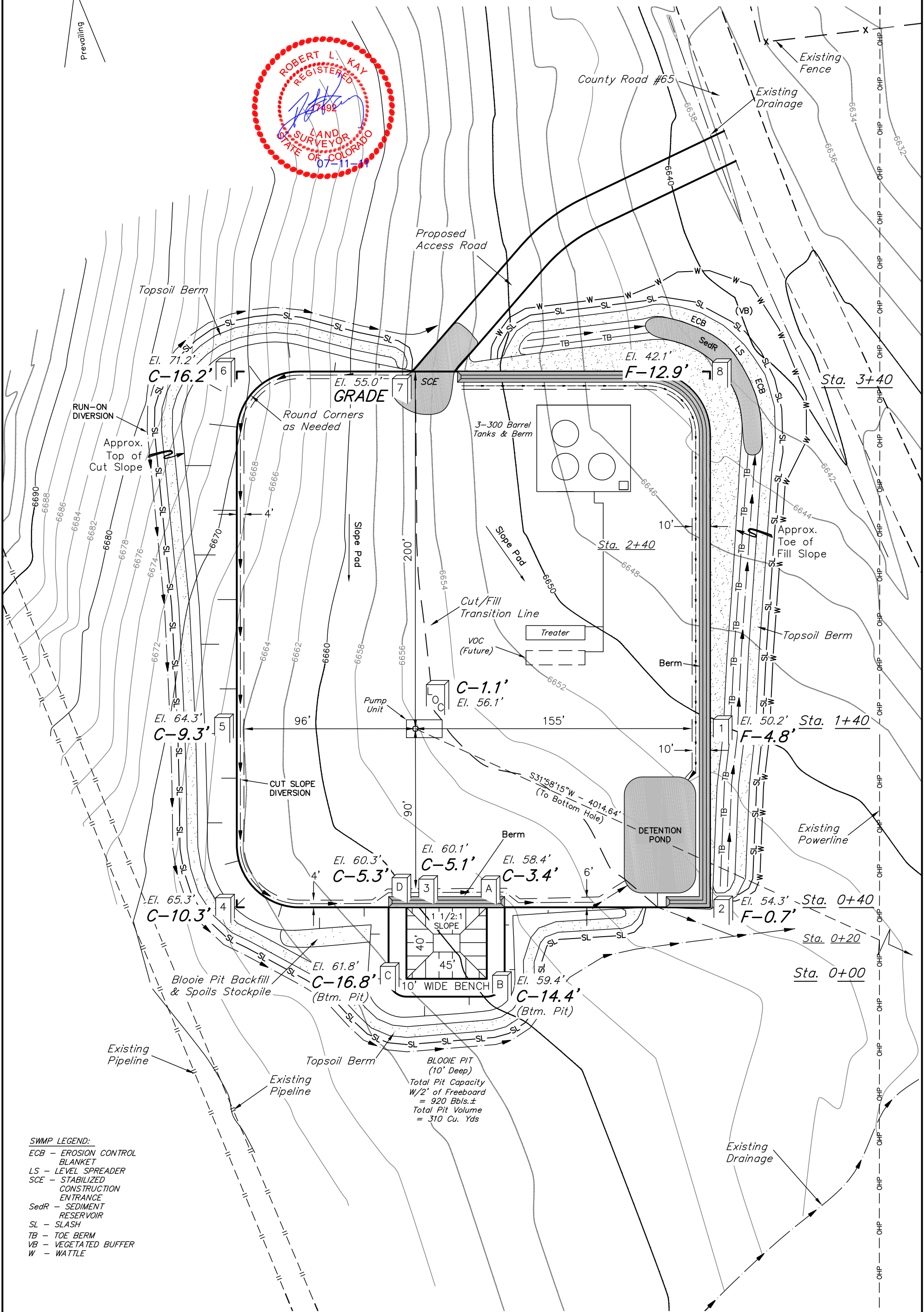

Elev. Ungraded Ground At Loc. Stake = 6656.1'
FINISHED GRADE ELEV. AT LOC. STAKE = 6655.0'

UINTAH ENGINEERING & LAND SURVEYING
85 So. 200 East * Vernal, Utah 84078 * (435) 789-1017

1" = 20'
X-Section
Scale
1" = 50'

DATE: 07-07-11
DRAWN BY: J.I.

SWEPI LP
CONSTRUCTION LAYOUT CROSS SECTIONS FOR
GNAT HILL #1-29
SECTION 29, T6N, R89W, 6th. P.M.
2374' FSL 360' FEL

FIGURE #2

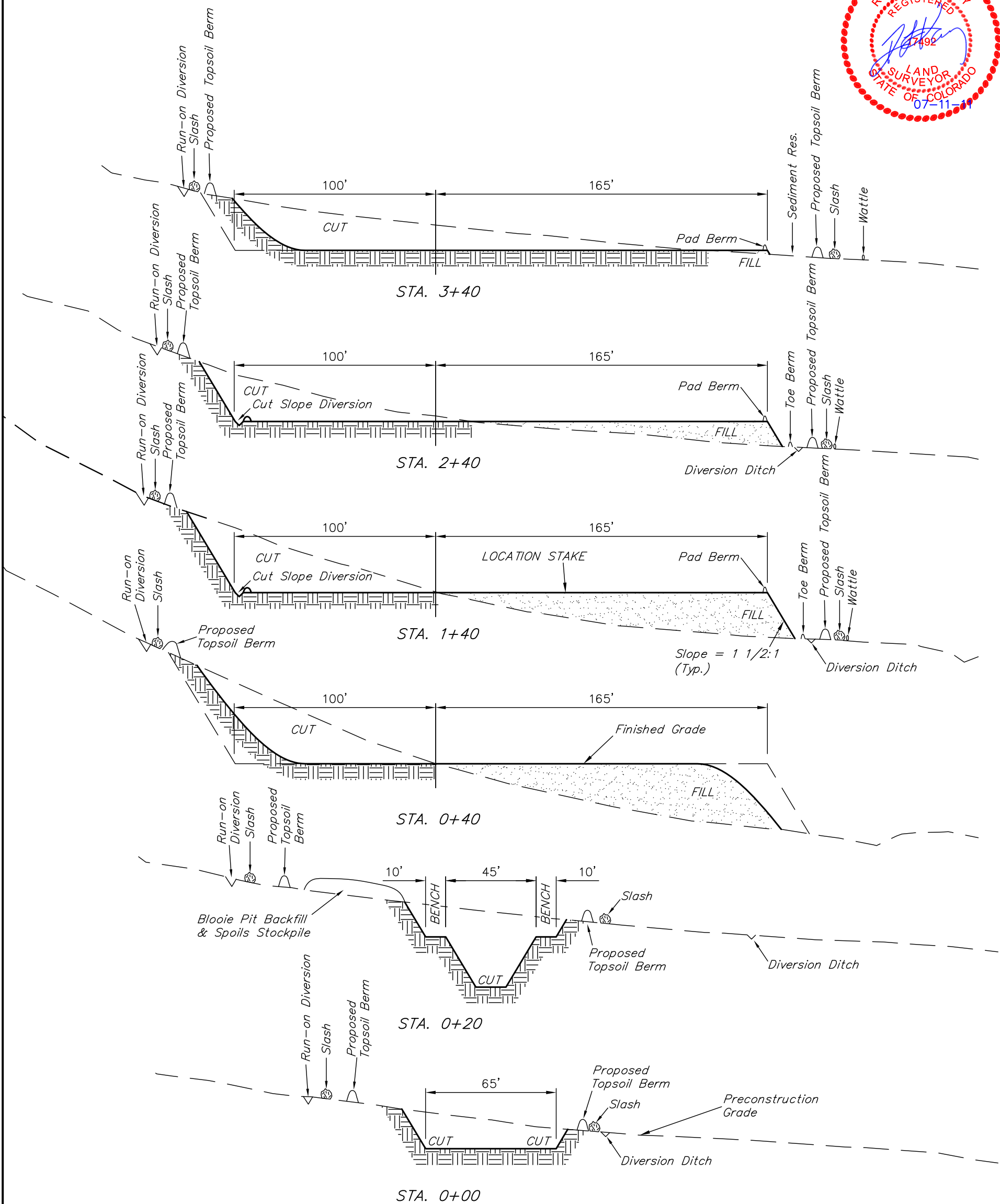

NOTE:
Topsoil should not be
Stripped Below Finished
Grade on Substructure Area.

* NOTE:
FILL QUANTITY INCLUDES
5% FOR COMPACTION

APPROXIMATE YARDAGES

(6") Topsoil Stripping	=	1,860 Cu. Yds.
Remaining Location	=	8,960 Cu. Yds.
TOTAL CUT	=	10,820 CU.YDS.
FILL	=	8,800 CU.YDS.

EXCESS MATERIAL	=	2,020 Cu. Yds.
Topsoil & Pit Backfill (1/2 Pit Vol.)	=	2,020 Cu. Yds.
EXCESS UNBALANCE (After Interim Rehabilitation)	=	0 Cu. Yds.

APPROXIMATE ACREAGES	
WELL SITE DISTURBANCE	= ± 2.378 ACRES
ACCESS ROAD DISTURBANCE	= ± 0.147 ACRES
TOTAL	= ± 2.525 ACRES