

Steil Surveying Services, LLC

1102 West 19th Street P.O. BOX 2073

Cheyenne, Wyoming 82001

### LOCATION DRAWING

THIS MAP DOES NOT REPRESENT A BOUNDARY SURVEY

SECTION 12  
TOWNSHIP 7 NORTH  
RANGE 64 WEST

DATE: 07/06/2011

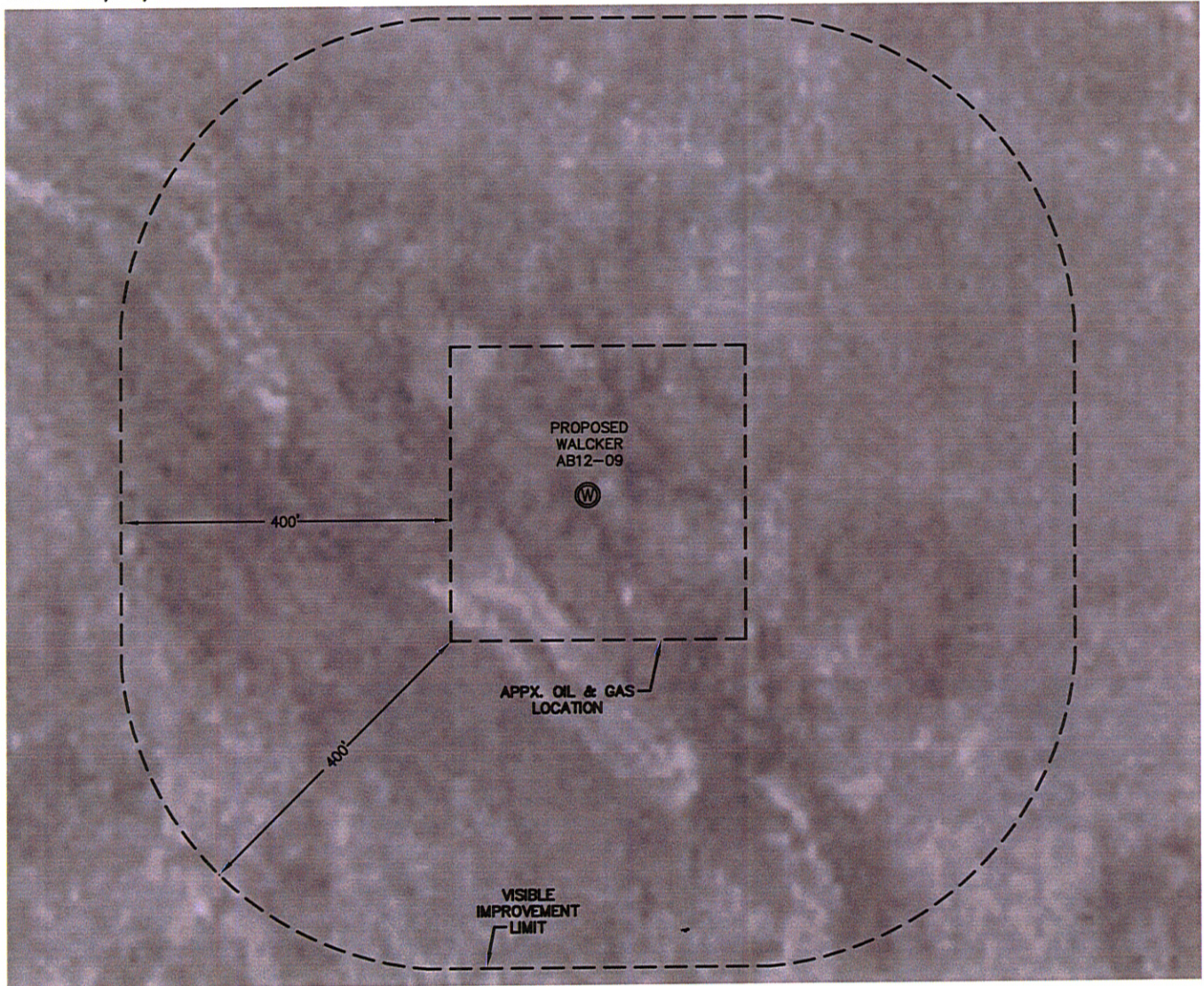

THERE ARE NO VISIBLE IMPROVEMENTS WITHIN THE VISIBLE IMPROVEMENT LIMIT.

THE NEAREST OVERHEAD POWER LINE IS 7420'+/- NORTHWEST.

#### NEW WELL DATA

ELEV = 4795', PDOP: 2.0

NE $\frac{1}{4}$ SE $\frac{1}{4}$  SEC 12

1810' FSL, 770' FEL

LAT: N 40.58561

LONG: W 104.49064

NEAREST PROP LINE: 770' EAST

NEAREST RAILROAD: MORE THAN ONE MILE AWAY

NEAREST BUILDING: 2800'+/- SOUTHWEST

COUNTY ROAD NO. 88: 2.7 MILES NORTH

NOTE: The orientation of the oil & gas location as shown was determined by Noble Energy.

NOTICE: According to Colorado law you MUST commence any legal action based upon any defect in this W.L.C. within three years after you first discover such defect. In no event may any action based upon any defect in this W.L.C. be commenced more than ten years from this said date of the certification shown hereon.



Scale: 1" = 200'