

Location Drawing KAISER 18-10

Multi-Well Pad

NE¼ NW¼ SECTION 10, TOWNSHIP 6 NORTH, RANGE 65 WEST OF THE 6TH PRINCIPAL MERIDIAN

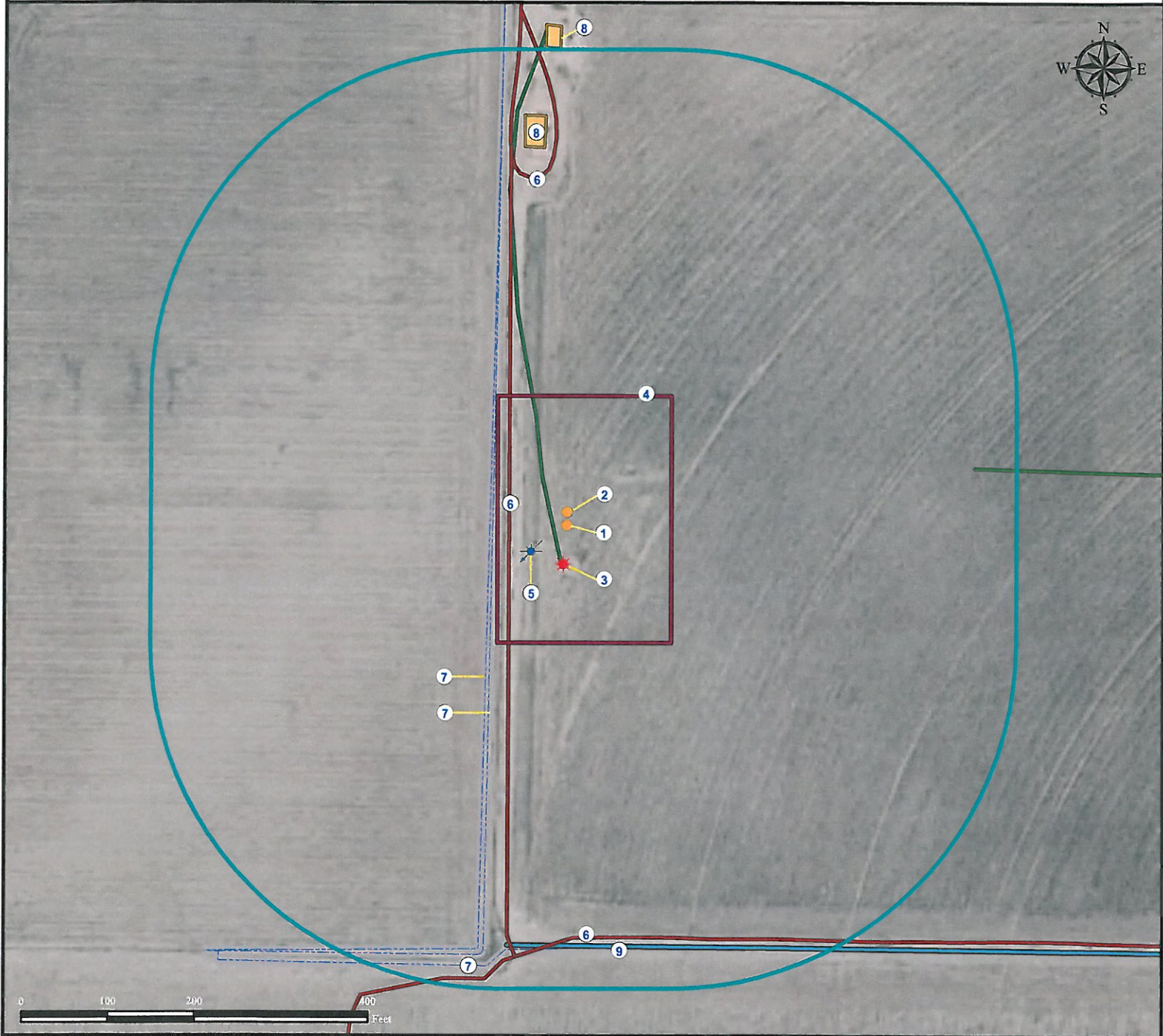

- | | | |
|-----------------------------------------------|------------------------------------------------------------------------------------------|--------------------------------------------------------------------|
| 1. Proposed Well KAISER 18-10. | 4. Operational disturbance area. | 7. Concrete ditches are $\pm 85'$ W, $\pm 90'$ W and $\pm 492'$ S. |
| 2. Proposed well KAISER 2-10. | 5. Water well (#5574) is $\pm 49'$ SW.
Feature not in this location per field verify. | 8. Existing Facilities are $\pm 439'$ N and $\pm 551'$ N. |
| 3. Existing well KAISER 21-10 is $\pm 47'$ S. | 6. Private roads are $\pm 65'$ W, $\pm 476'$ S and $\pm 404'$ NW. | 9. Ditch is $\pm 484'$ S. |

Legend

- | | | |
|-----------------|---------------------|---------------------|
| ● Proposed Well | ▭ Disturbance Area | — Ditch |
| ★ Existing Well | ▭ 400' Radius | — Existing Pipeline |
| ⚡ Water Well | ▭ Existing Facility | ▭ Fence |
| | ▭ Concrete Ditch | ▭ Private Road |

Reference Location
 ** All Measurements are Made from
 Reference Well KAISER 18-10 **
 Lat: 40.506773° Long: -104.651587° (NAD 83)
 Elevation: 4787 Feet

Surface Use: Irrigated Crop



Use our resources to find yours!
www.petro-fs.com
 (303) 928-7128

Field Date: 05/24/2011
 Drafting Date: 06/20/2011
 Drafter: DMM
 Checked By: BHF

Data Sources:
 - Aerial courtesy of NAIP (2009)
 - Water wells courtesy CDOWR

Prepared for:

