

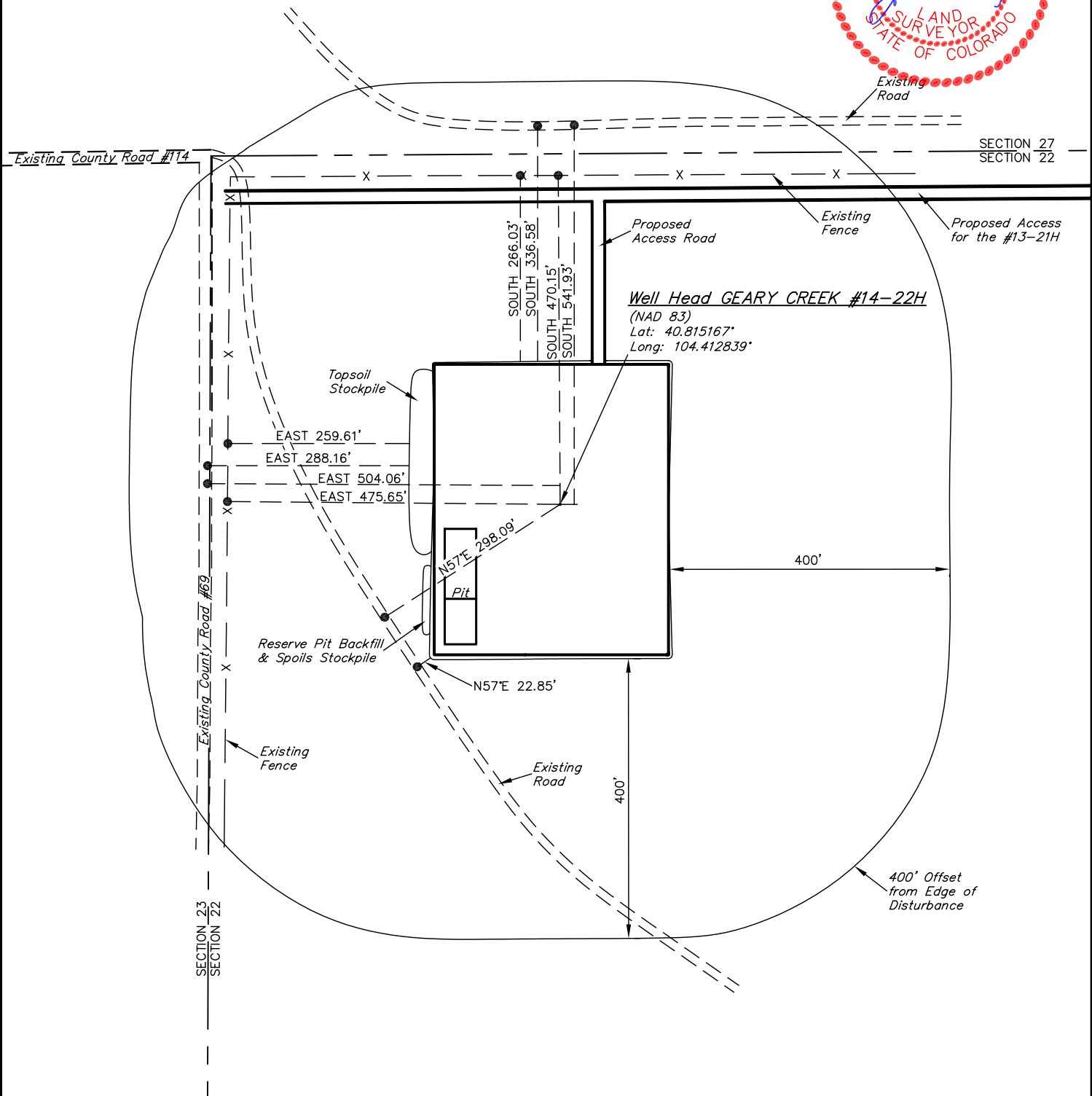

EOG RESOURCES, INC.  
ADDENDUM TO LEGAL PLAT FOR  
GEARY CREEK #14-22H  
SECTION 22, T10N, R63W, 6th. P.M.  
501' FSL 501' FEL

SCALE: 1" = 200'  
DATE: 01-21-11  
DRAWN BY: J.I.

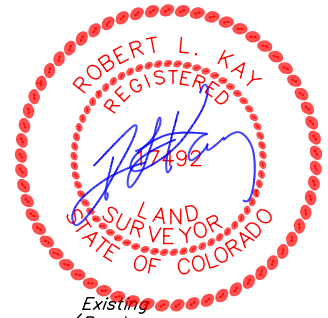

EOG RESOURCES, INC.  
CONSTRUCTION LAYOUT FOR  
GEARY CREEK #14-22H  
SECTION 22, T10N, R63W, 6th. P.M.  
501' FSL 501' FEL

FIGURE #1

SCALE: 1" = 60'

DATE: 01-21-11

DRAWN BY: J.I.

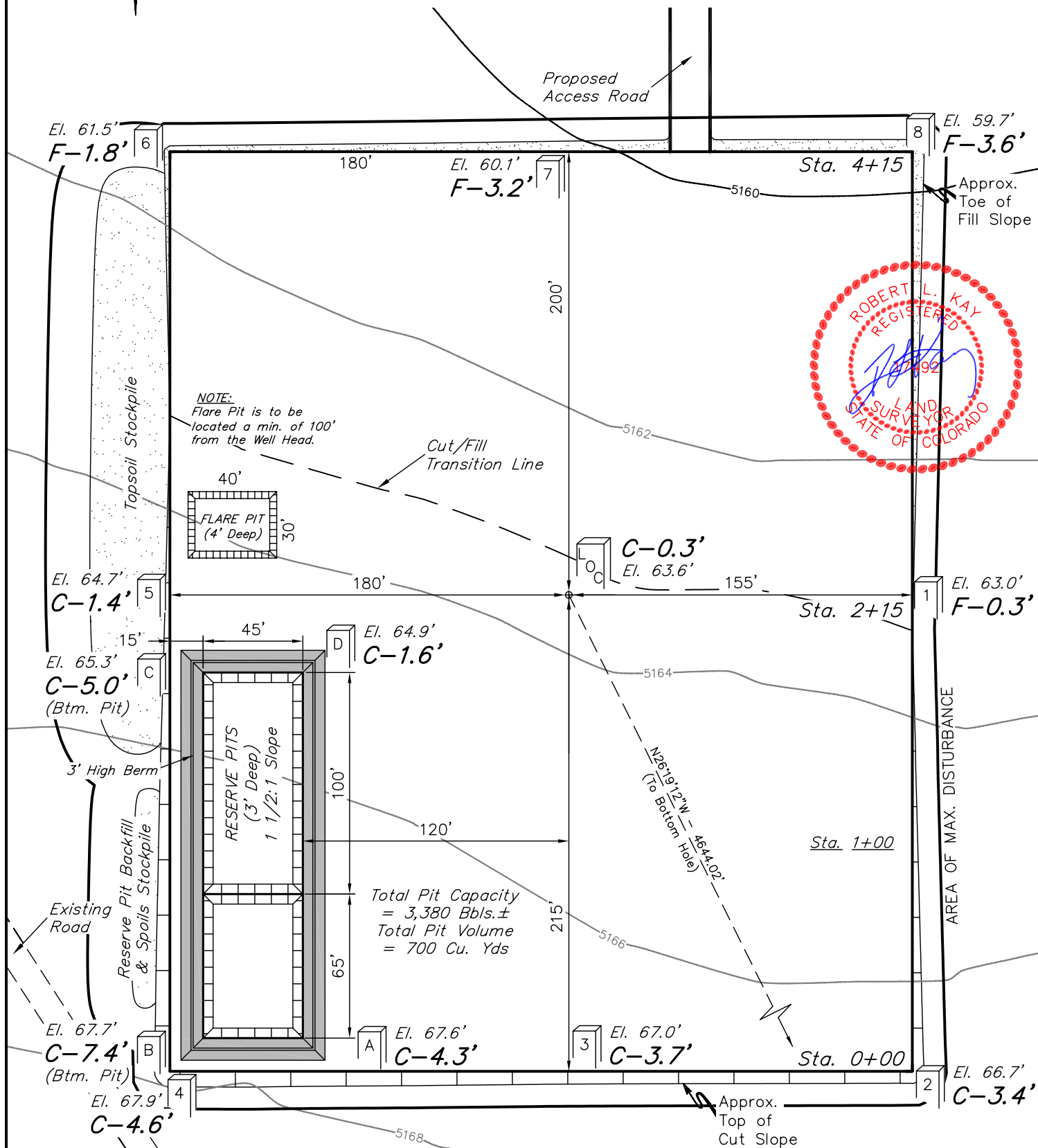
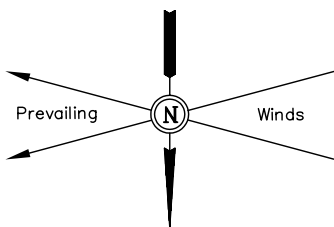

Elev. Ungraded Ground At Loc. Stake = **5163.6'**  
FINISHED GRADE ELEV. AT LOC. STAKE = **5163.3'**

UINTAH ENGINEERING & LAND SURVEYING  
85 So. 200 East \* Vernal, Utah 84078 \* (435) 789-1017

1" = 40'  
X-Section  
Scale  
1" = 100'

DATE: 01-21-11  
DRAWN BY: J.I.

EOG RESOURCES, INC.  
CONSTRUCTION LAYOUT CROSS SECTIONS FOR  
GEARY CREEK #14-22H  
SECTION 22, T10N, R63W, 6th. P.M.  
501' FSL 501' FEL

FIGURE #2

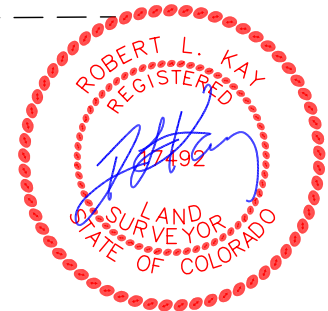
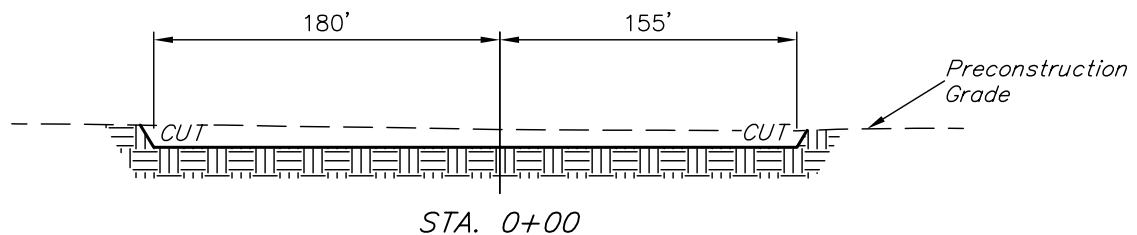
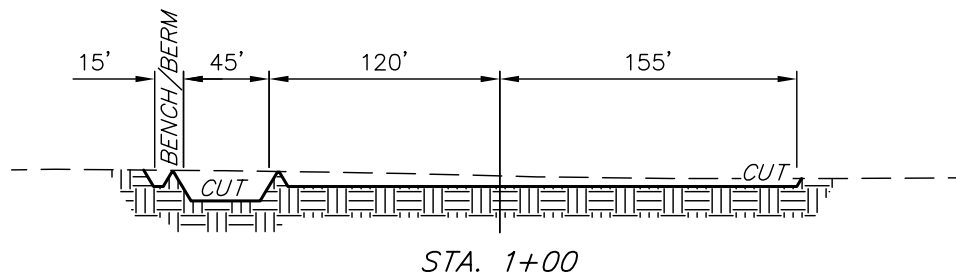
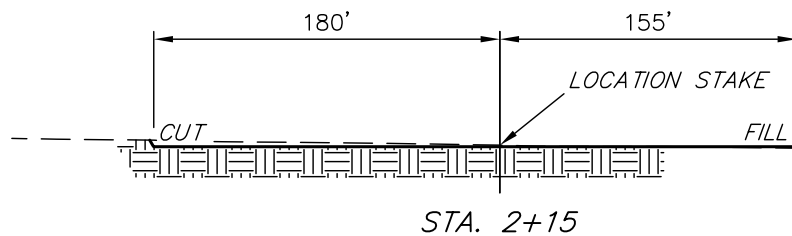
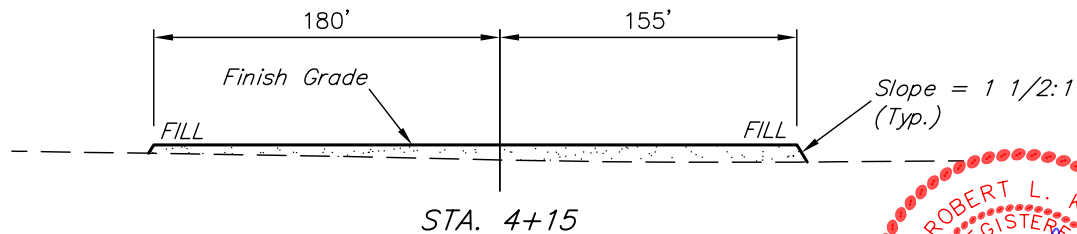

NOTE:

Topsoil should not be Stripped Below Finished Grade on Substructure Area.

APPROXIMATE ACREAGES  
WELL SITE DISTURBANCE = ± 4.025 ACRES  
ACCESS ROAD DISTURBANCE = ± 0.167 ACRES  
TOTAL = ± 4.192 ACRES

\* NOTE:  
FILL QUANTITY INCLUDES 5% FOR COMPACTION

APPROXIMATE YARDAGES

(6") Topsoil Stripping = 2,730 Cu. Yds.  
Remaining Location = 5,390 Cu. Yds.  
TOTAL CUT = 8,120 CU.YDS.  
FILL = 5,040 CU.YDS.

EXCESS MATERIAL = 3,080 Cu. Yds.  
Topsoil & Pit Backfill (1/2 Pit Vol.) = 3,080 Cu. Yds.  
EXCESS UNBALANCE = 0 Cu. Yds.  
(After Interim Rehabilitation)

UINTAH ENGINEERING & LAND SURVEYING  
85 So. 200 East \* Vernal, Utah 84078 \* (435) 789-1017



EOG RESOURCES, INC.  
TYPICAL RIG LAYOUT FOR  
GEARY CREEK #14-22H  
SECTION 22, T10N, R63W, 6th. P.M.  
501' FSL 501' FEL

FIGURE #3

SCALE: 1" = 60'

DATE: 01-21-11

DRAWN BY: J.I.

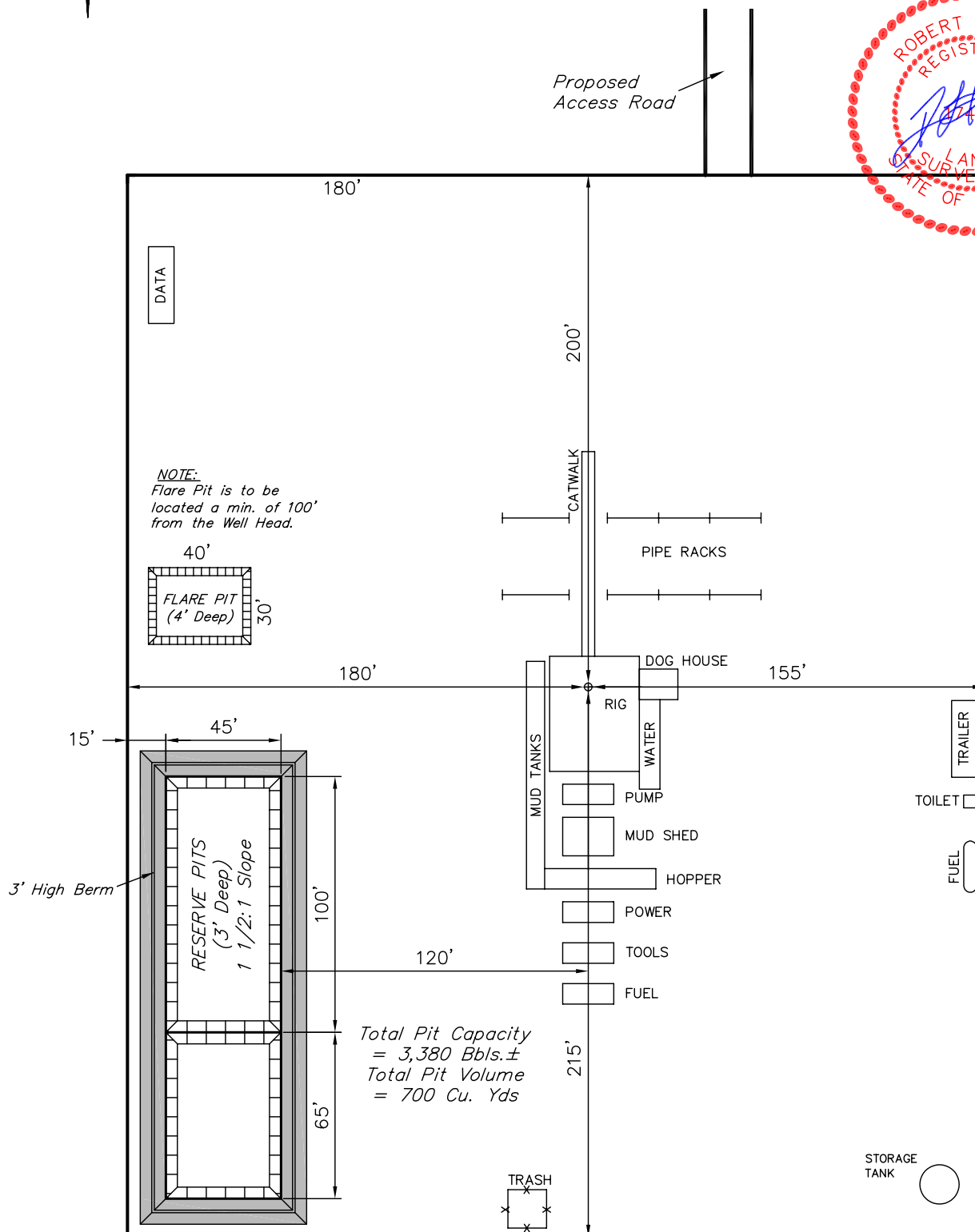
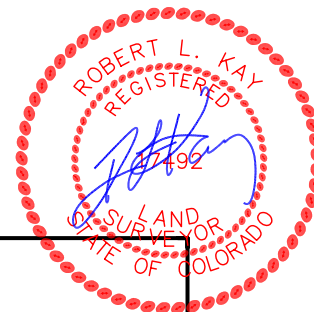



EOG RESOURCES, INC.  
RECLAMATION DIAGRAM FOR  
GEARY CREEK #14-22H  
SECTION 22, T10N, R63W, 6th. P.M.  
501' FSL 501' FEL

FIGURE #4

SCALE: 1" = 60'  
DATE: 01-21-11  
DRAWN BY: J.I.

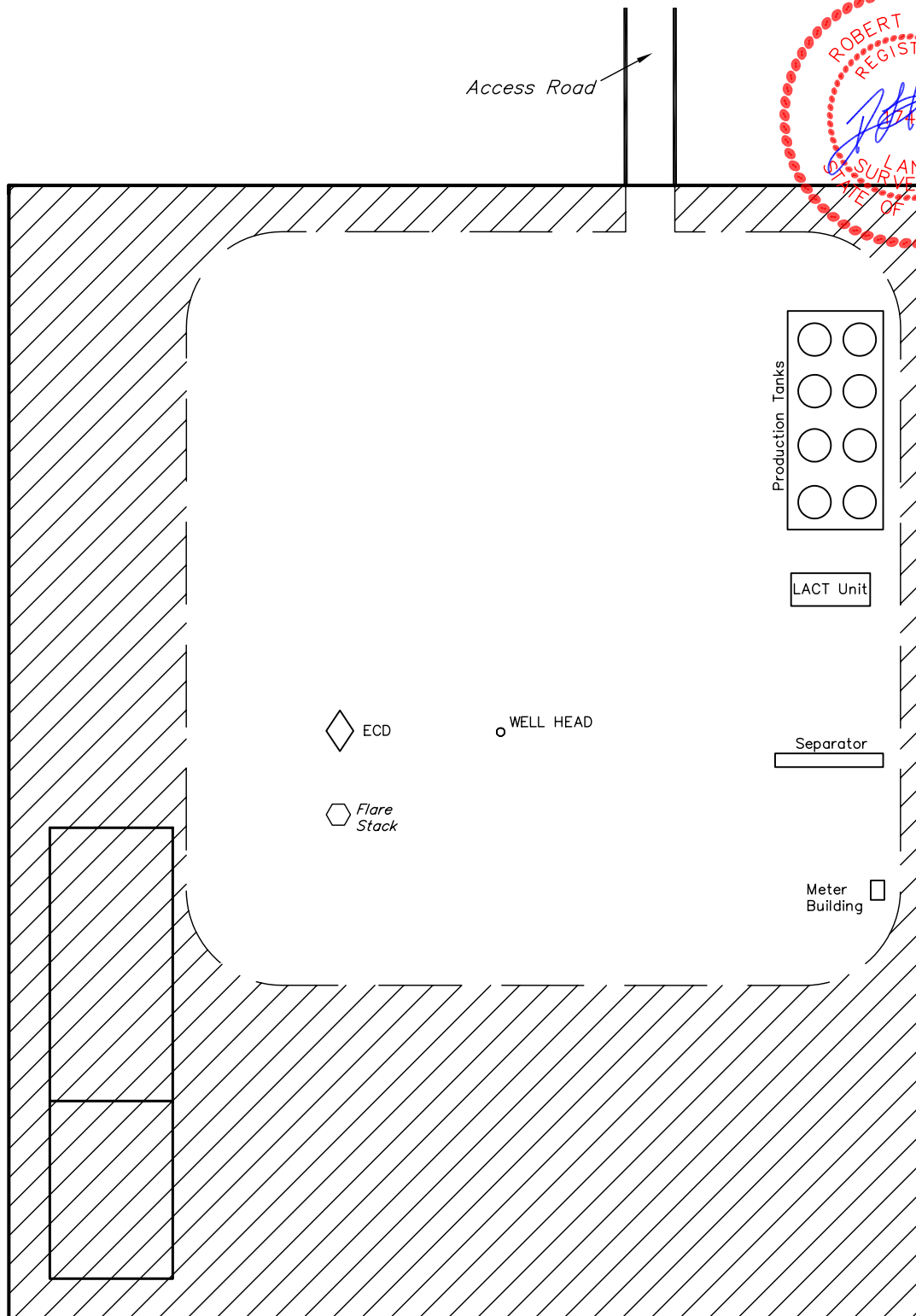
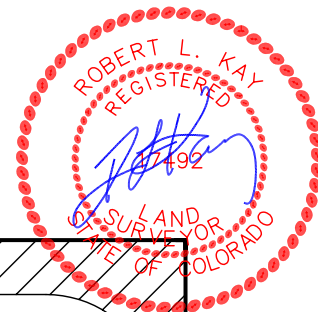

APPROXIMATE ACREAGES  
UN-RECLAIMED =  $\pm 1.638$  ACRES



# EOG RESOURCES, INC.

## LOCATION DRAWING FOR

GEARY CREEK #14-22H  
SECTION 22, T10N, R63W, 6th. P.M.  
501' FSL 501' FEL

FIGURE #5

NE Cor. Sec. 22  
2010 UELS Alum.  
Cap. 0.6' Below  
Road, Rebar  
Lat: 40.828275°  
Long: 104.410964°

1/4 Section Line 22

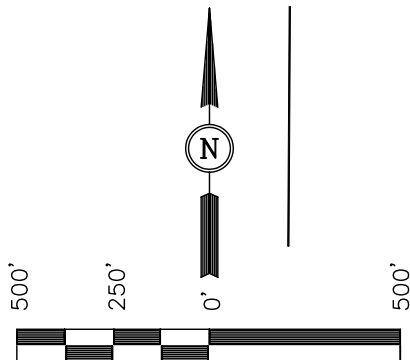

SCALE  
DATE: 01-24-11  
DRAWN BY: J.I.

LINE TABLE			
LINE	FEATURE	DIRECTION	LENGTH
L1	COUNTY ROAD #69	EAST	501.04'
L2	PROPERTY LINE	EAST	501.04'
L3	BUILDING	S87°00'00"E	6287.00'
L4	POWER LINE	S84°00'00"E	4562.00'
L5	WATER WELL	S75°00'00"E	4154.00'

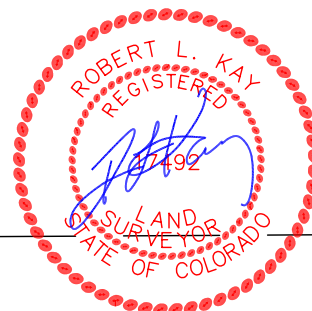

JAMES M.  
KONIG

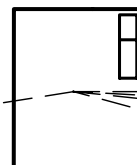

SW Cor. Sec. 22  
2010 UELS Alum.  
Cap. Flush W/Ground,  
Rebar  
Lat: 40.813711°  
Long: 104.429739°

1/16 Section Line SE 1/4

S80°59'29"W - 20.76 Miles  
(To Railroad)

Section Line

S89°40'28"W - 5178.15' (Meas.)

1996 Alum. Cap,  
1.5' Below Road,  
LS#17484  
Lat: 40.813800°  
Long: 104.411036°

### PLANT COMMUNITY

- ☐ DISTURBED GRASSLAND
- ☐ NATIVE GRASSLAND
- ☐ SHRUB LAND
- ☐ PLAINS RIPARIAN
- ☐ MOUNTAIN RIPARIAN
- ☐ FOREST LAND
- ☐ WETLANDS AQUATIC
- ☐ ALPINE
- ☐ OTHER (Describe): \_\_\_\_\_

### CURRENT LAND USE

- CROP LAND: ☐ IRRIGATED ☐ DRY LAND ☐ IMPROVED PASTURE ☐ HAY MEADOW ☐ CRP
- NON-CROP LAND: ☐ RANGELAND ☐ TIMBER ☐ RECREATIONAL ☐ OTHER (Describe) \_\_\_\_\_
- SUBDIVIDED: ☐ INDUSTRIAL ☐ COMMERCIAL ☐ RESIDENTIAL \_\_\_\_\_

### FUTURE LAND USE

- CROP LAND: ☐ IRRIGATED ☐ DRY LAND ☐ IMPROVED PASTURE ☐ HAY MEADOW ☐ CRP
- NON-CROP LAND: ☐ RANGELAND ☐ TIMBER ☐ RECREATIONAL ☐ OTHER (Describe) \_\_\_\_\_
- SUBDIVIDED: ☐ INDUSTRIAL ☐ COMMERCIAL ☐ RESIDENTIAL \_\_\_\_\_