

EOG RESOURCES, INC.
GEARY CREEK #14-22H
SECTION 22, T10N, R63W, 6th P.M.

PROCEED IN A SOUTHEASTERLY DIRECTION FROM GROVER, COLORADO ALONG COUNTY ROAD 390 APPROXIMATELY 0.3 MILES TO THE JUNCTION OF THIS ROAD AND COUNTY ROAD 120 3/4 TO THE WEST; TURN RIGHT AND PROCEED IN A WESTERLY DIRECTION APPROXIMATELY 0.8 MILES TO THE JUNCTION OF THIS ROAD AND COUNTY ROAD 87 TO THE SOUTH; TURN LEFT AND PROCEED IN A SOUTHERLY DIRECTION APPROXIMATELY 0.8 MILES TO THE JUNCTION OF THIS ROAD AND COUNTY ROAD 120 TO THE WEST; TURN RIGHT AND PROCEED A WESTERLY DIRECTION APPROXIMATELY 5.0 MILES TO THE JUNCTION OF THIS ROAD AND COUNTY ROAD 77 TO THE SOUTH; TURN LEFT AND PROCEED IN A SOUTHERLY DIRECTION APPROXIMATELY 3.0 MILES TO THE JUNCTION OF THIS ROAD AND COUNTY ROAD 114 TO THE WEST; TURN RIGHT AND PROCEED IN A WESTERLY DIRECTION APPROXIMATELY 4.0 MILES TO THE JUNCTION OF THIS ROAD AND COUNTY ROAD 69 TO THE NORTH; TURN RIGHT AND PROCEED IN A NORTHERLY DIRECTION APPROXIMATELY 60' TO THE BEGINNING OF THE PROPOSED ACCESS ROAD FOR GEARY CREEK #13-21H TO THE WEST; FOLLOW ROAD FLAGS IN A WESTERLY DIRECTION APPROXIMATELY 533' TO THE BEGINNING OF THE PROPOSED ACCESS TO THE NORTH; FOLLOW ROAD FLAGS IN A NORTHERLY DIRECTION APPROXIMATELY 242' TO THE PROPOSED LOCATION.

TOTAL DISTANCE FROM GROVER, COLORADO TO THE PROPOSED WELL LOCATION IS APPROXIMATELY 14.1 MILES.

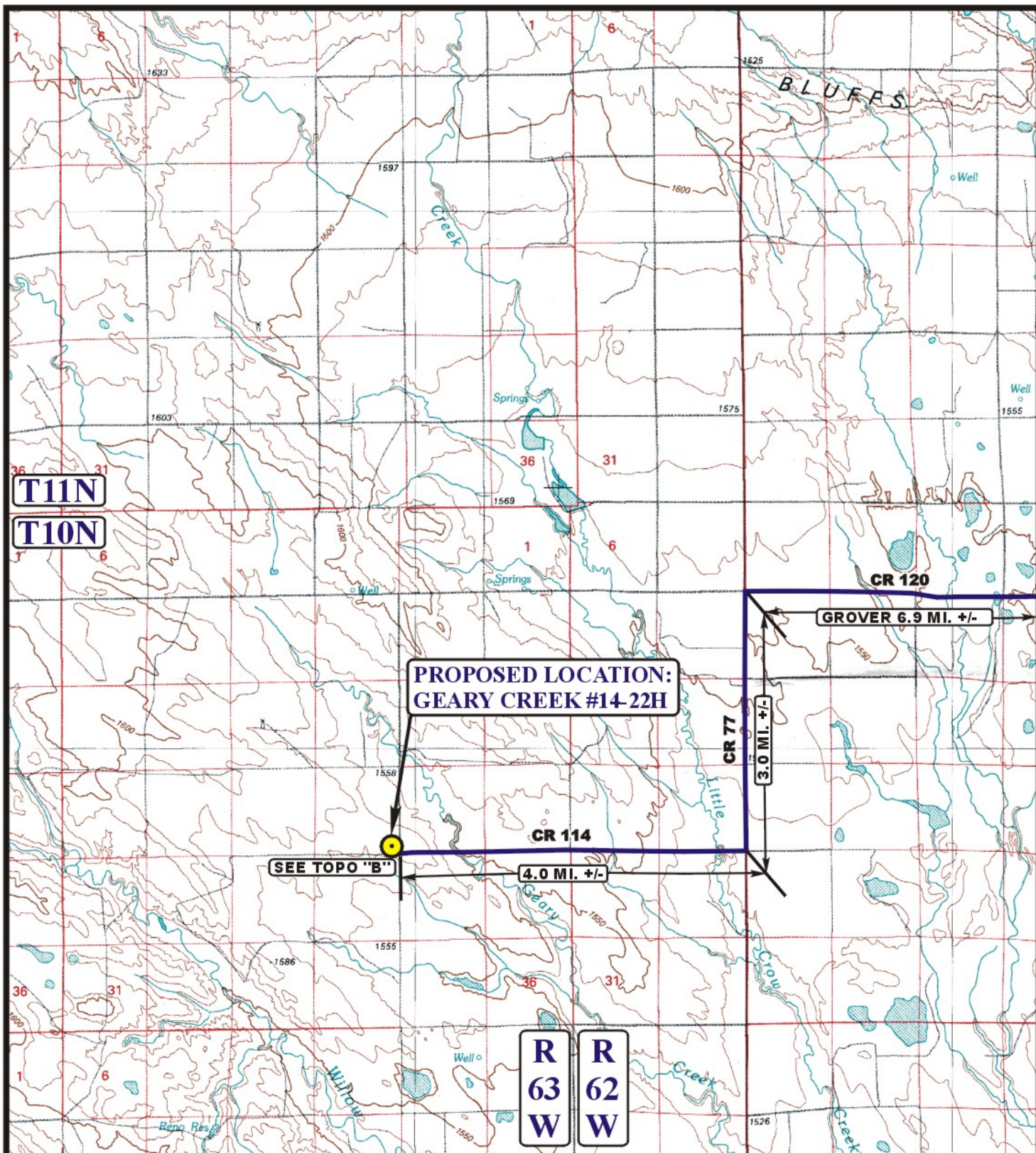

LEGEND:

 PROPOSED LOCATION

N

EOG RESOURCES, INC.

GEARY CREEK #14-22H
SECTION 22, T10N, R63W, 6th P.M.
501' FSL 501' FEL



Uintah Engineering & Land Surveying
85 South 200 East Vernal, Utah 84078
(435) 789-1017 * FAX (435) 789-1813

ACCESS ROAD
MAP

01 27 11
 MONTH DAY YEAR

SCALE: 1:100,000 DRAWN BY: S.F. REVISED: 00-00-00

A
TOPO

