

WATER WELL PROXIMITY MAP

SWORDFISH 13-31

NWSW SECTION 31, TOWNSHIP 19 SOUTH, RANGE 69 WEST OF THE 6TH PRINCIPAL MERIDIAN

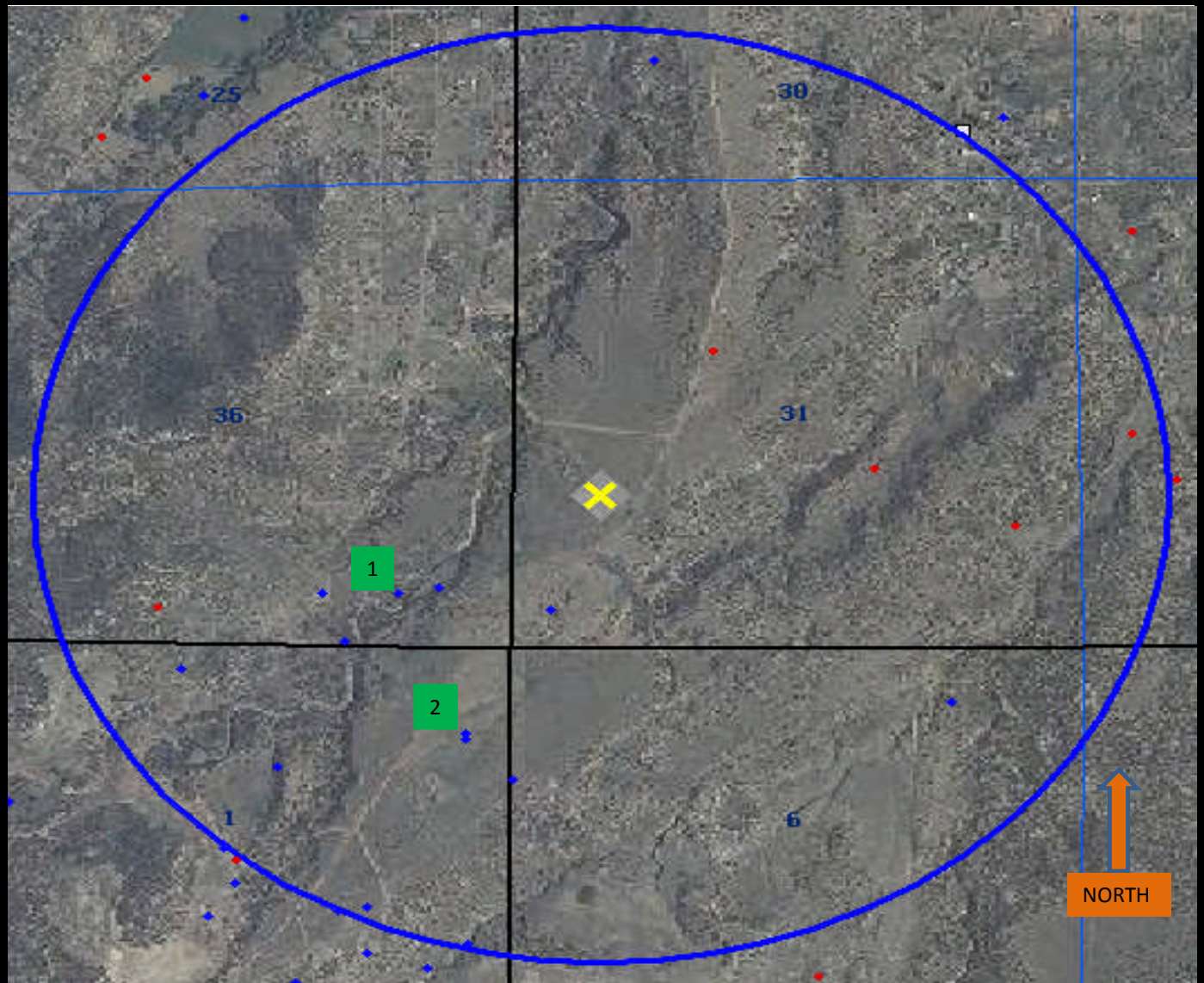

1. 2187' SW

Permit = # 227616
Receipt = # 465292
Depth = 525'
Status = Well Constructed
Elevation = 5540'

2. 2974' S/SW

Permit = #198128-A
Receipt = # 3608108
Depth = 600'
Status = Well Constructed
Elevation = 5680'

**All wells represented on this map are classified as active or constructed with a depth greater than zero. All values and locations are defined by the Colorado Division of Water Resources. Elevations estimated from COGCC Topos.

Data Sources:

Aerial courtesy of NAIP (2009)
Water wells courtesy of CDOWR



Legend

Proposed well
Water well
1 Mile Radius

