

HAHN 1-4H

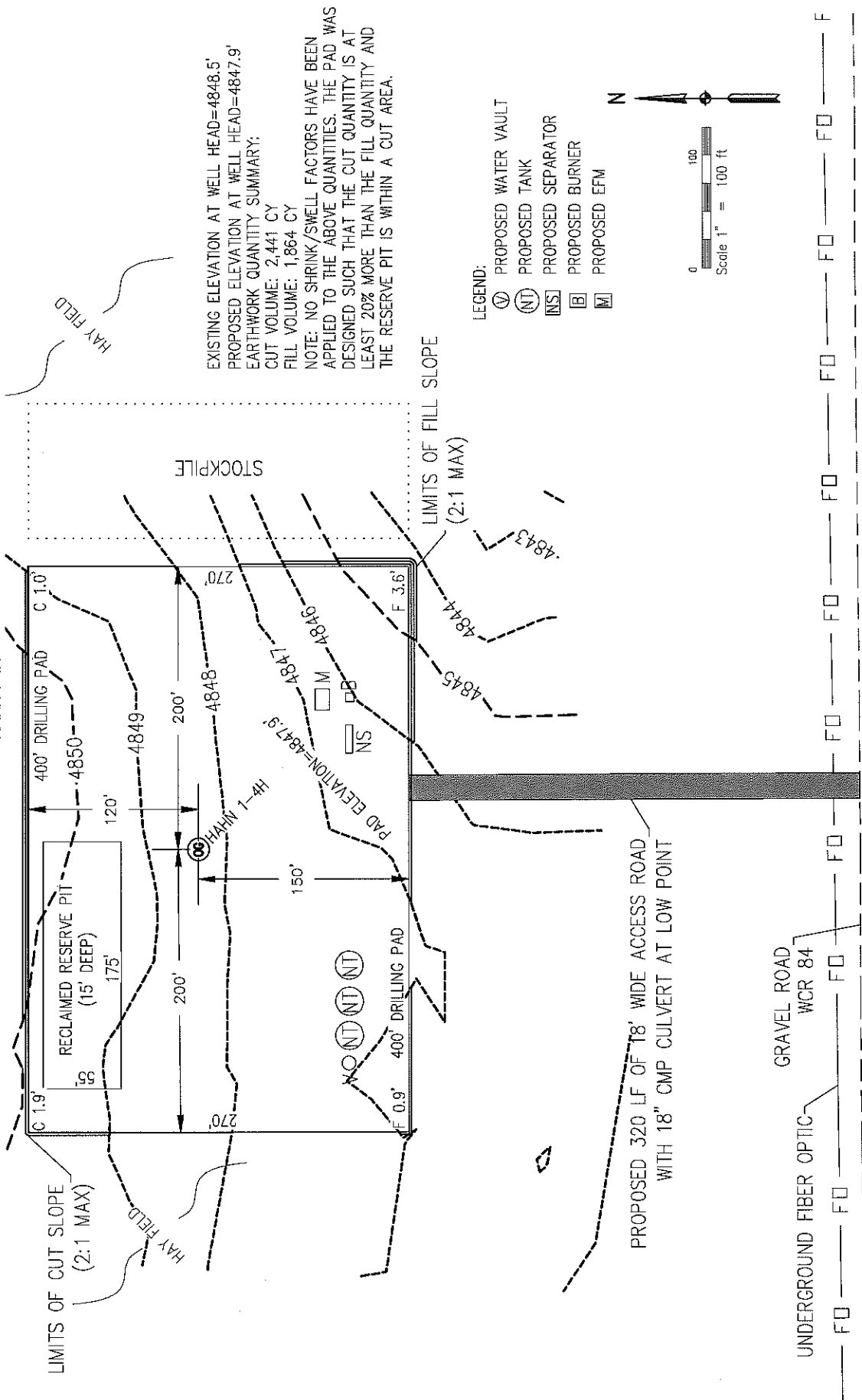

EXISTING ELEVATION AT WELL HEAD=4848.5'  
 PROPOSED ELEVATION AT WELL HEAD=4847.9'  
 EARTHWORK QUANTITY SUMMARY:  
 CUT VOLUME: 2,441 CY  
 FILL VOLUME: 1,864 CY  
 NOTE: NO SHRINK/SWELL FACTORS HAVE BEEN APPLIED TO THE ABOVE QUANTITIES. THE PAD WAS DESIGNED SUCH THAT THE CUT QUANTITY IS AT LEAST 20% MORE THAN THE FILL QUANTITY AND THE RESERVE PIT IS WITHIN A CUT AREA.

- LEGEND:
- ⊙ PROPOSED WATER VAULT
  - ⊙(NT) PROPOSED TANK
  - ▭(NS) PROPOSED SEPARATOR
  - ▭(B) PROPOSED BURNER
  - ▭(M) PROPOSED EFM

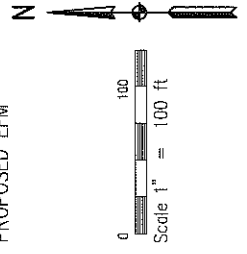

1  
S1|S1

HAHN 1-4H LOCATION PLAN

SE1/4 SE1/4 SECTION 4  
 TOWNSHIP 7 NORTH  
 RANGE 62 WEST