

Project: Weld County, CO (NAD 83)  
 Site: Sec. 5-T7N-R64W  
 Well: Dillard USX AB05-99HZ

Noble Energy

RECEIVED

JUL 14 2011

COGCC

HALLIBURTON

Sperry Drilling

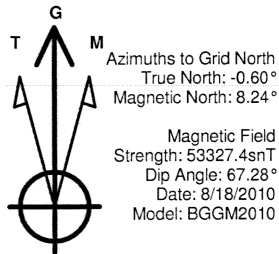

# LEGEND

— Dillard USX AB05-99HZ,  
 — MWD Survey

Halliburton Energy Services, Inc. ("Halliburton") recently completed directional drilling and MWD operations at the Dillard USX AB05-99HZ well located at Weld County, CO. At the conclusion of the job Halliburton performed a final survey on the well. Noble Energy has requested that Halliburton provide them the distances from BHL to section lines from that final survey to allow Noble Energy to meet its requirements under Colorado law. These distances are generated by a mathematical algorithm based on rough data collected after the well is drilled. Halliburton considers it to be a rough estimate only and it is not to be relied upon in any application where accurate data is required. In consideration for Halliburton releasing this data to Noble Energy, Noble Energy agrees to release Halliburton from any consequences of it or anyone else relying on such data.

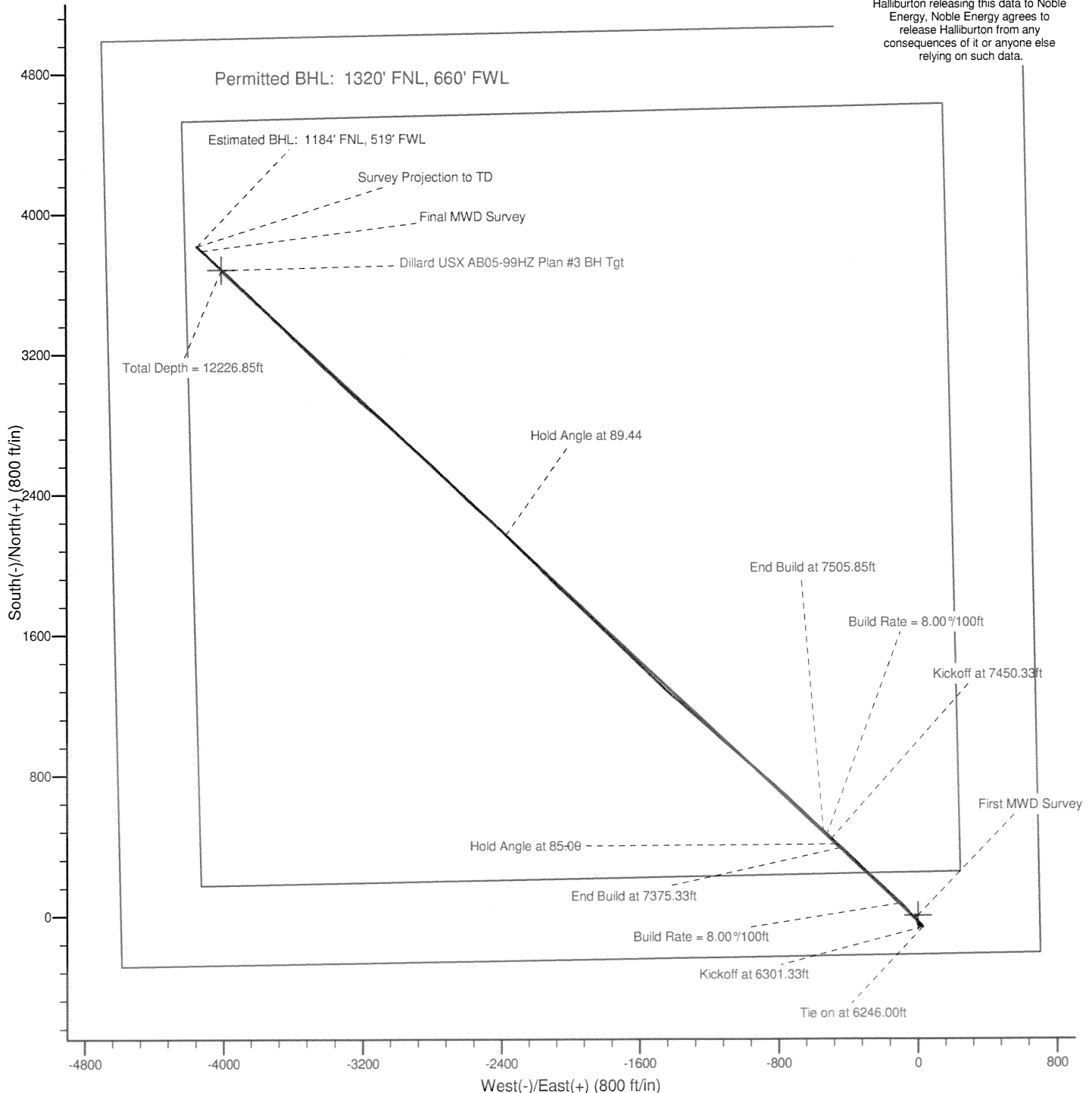

Project: Weld County, CO (NAD 83)  
 Site: Sec. 5-T7N-R64W  
 Well: Dillard USX AB05-99HZ

# Noble Energy

**HALLIBURTON**

Sperry Drilling

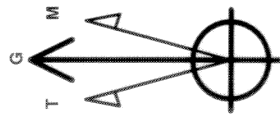

Azimuths to Grid North  
 True North:  $-0.60^\circ$   
 Magnetic North:  $8.24^\circ$   
 Magnetic Field  
 Strength: 53327.4nT  
 Dip Angle:  $67.28^\circ$   
 Date: 8/18/2010  
 Model: BGGIM2010

## LEGEND

— Dillard USX AB05-99HZ,  
 — MWD Survey

Halliburton Energy Services, Inc. ("Halliburton") recently completed directional drilling and MWD operations at the Dillard USX AB05-99HZ well located at Weld County, CO. At the conclusion of the job Halliburton performed a final survey on the well. Noble Energy has requested that Halliburton provide them the distances from BHL to section lines from that final survey to allow Noble Energy to meet its requirements under Colorado law. These distances are generated by a mathematical algorithm based on rough data collected after the well is drilled. Halliburton considers it to be a rough estimate only and it is not to be relied upon in any application where accurate data is required. In consideration for Halliburton releasing this data to Noble Energy, Noble Energy agrees to release Halliburton from any consequences of it or anyone else relying on such data.

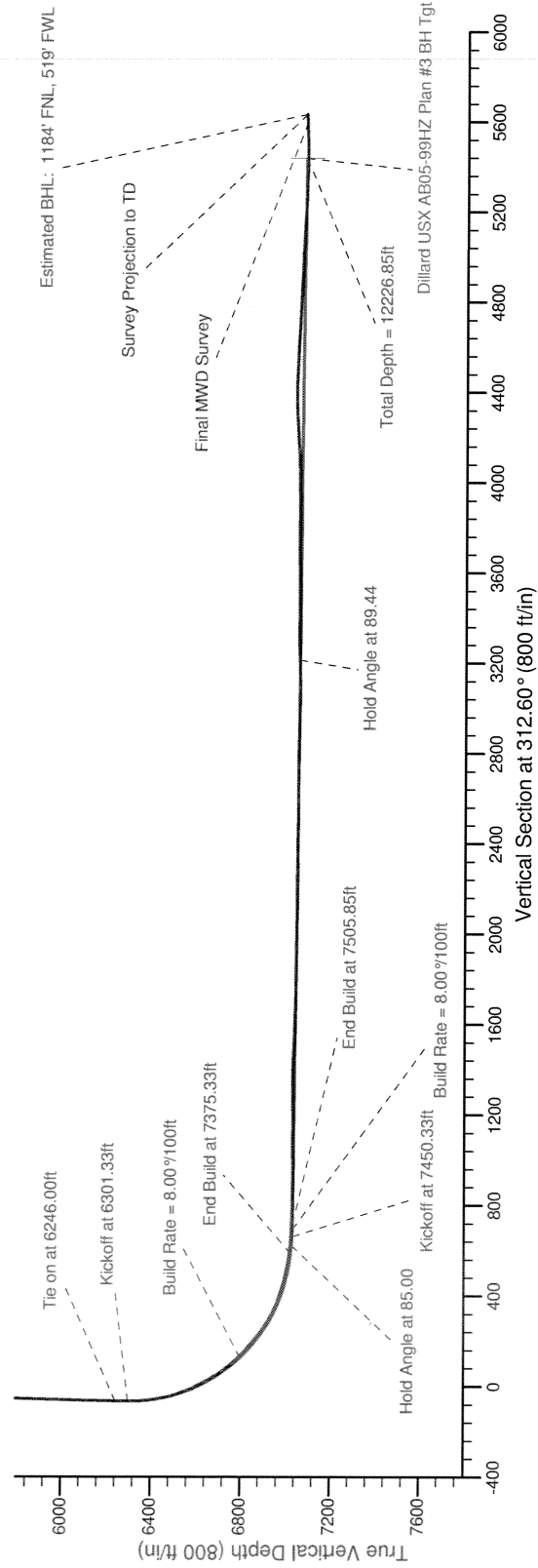

RECEIVED  
 JUL 14 2011  
 COGCC