

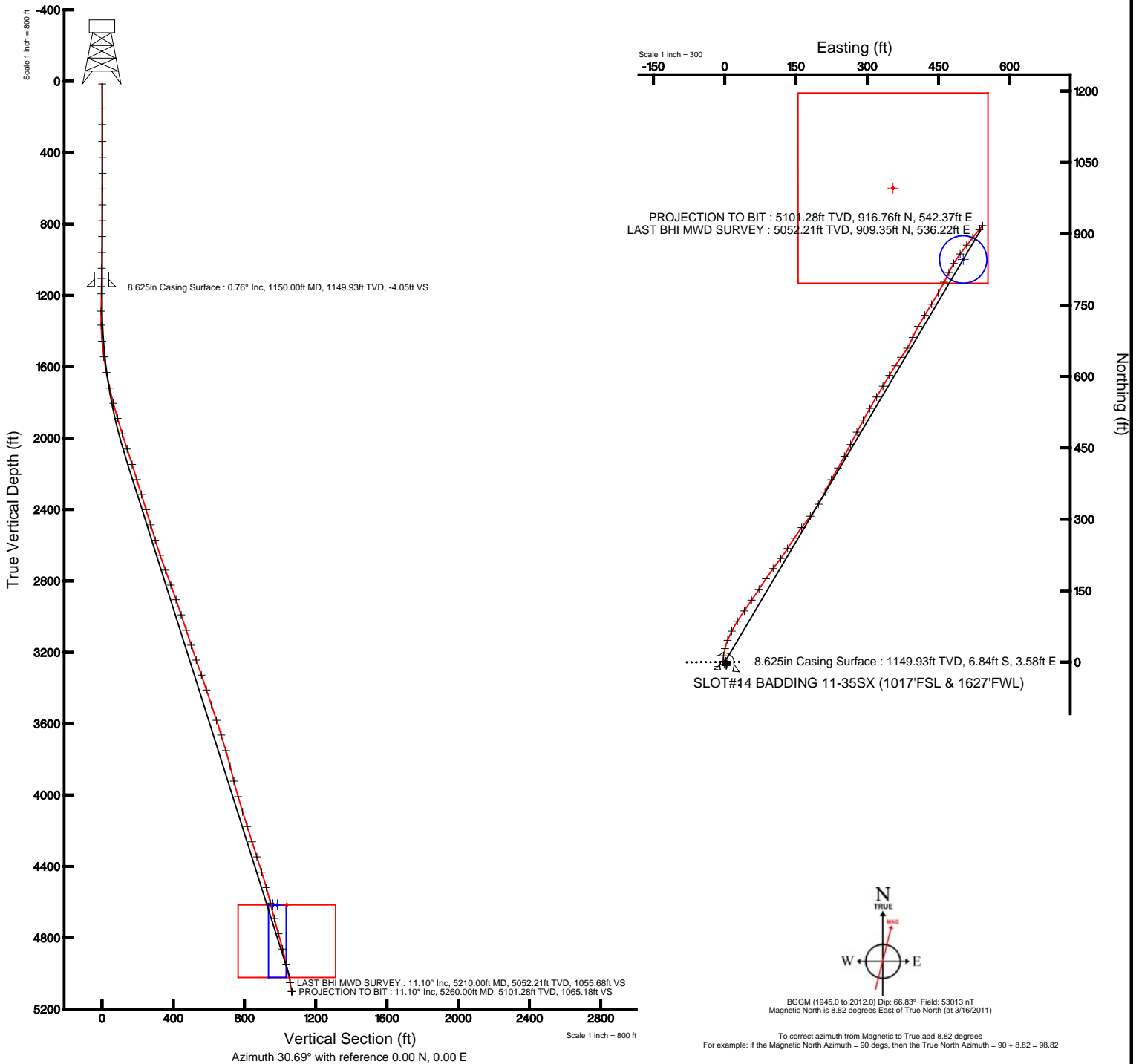

# KERR MCGEE OIL & GAS ONSHORE LP

Location: COLORADO Slot: SLOT#14 BADDING 11-35SX (1017'FSL & 1627'FWL)  
Field: WELD COUNTY (KERR MCGEE) Well: BADDING 11-35SX  
Facility: SEC.35-T2N-R66W Wellbore: BADDING 11-35SX PWB

Plot reference wellpath is BADDING 11-35SX (REV 8.0) PWB	
True vertical depths are referenced to XTREME 15 (RKB)	Grid System: NAD83 (Lambert Colorado SP, Northern Zone (501), US feet)
Measured depths are referenced to XTREME 15 (RKB)	North Reference: True north
XTREME 15 (RKB) to Mean Sea Level: 5123 feet	Scale: True distance
Mean Sea Level to Mud line (At Slot: SLOT#14 BADDING 11-35SX (1017'FSL & 1627'FWL)): 0 feet	Depths are in feet
Coordinates are in feet referenced to Slot	Created by: rockdawn on 6/22/2011





# Actual Wellpath Report

BADDING 11-35SX AWP

Page 1 of 5



REFERENCE WELLPATH IDENTIFICATION			
Operator	KERR MCGEE OIL & GAS ONSHORE LP	Slot	SLOT#14 BADDING 11-35SX (1017'FSL & 1627'FWL)
Area	COLORADO	Well	BADDING 11-35SX
Field	WELD COUNTY (KERR MCGEE)	Wellbore	BADDING 11-35SX AWB
Facility	SEC.35-T2N-R66W		

REPORT SETUP INFORMATION			
Projection System	NAD83 / Lambert Colorado SP, Northern Zone (501), US feet	Software System	WellArchitect® 3.0.0
North Reference	True	User	Cookdanm
Scale	0.999961	Report Generated	6/22/2011 at 5:41:33 PM
Convergence at slot	0.49° East	Database/Source file	WA_DENVER/BADDING_11-35SX_AWB.xml

WELLPATH LOCATION						
	Local coordinates		Grid coordinates		Geographic coordinates	
	North[ft]	East[ft]	Easting[US ft]	Northing[US ft]	Latitude	Longitude
Slot Location	75.85	-2018.72	3210417.84	1276562.93	40°05'24.385"N	104°44'52.501"W
Facility Reference Pt			3212437.05	1276504.37	40°05'23.636"N	104°44'26.527"W
Field Reference Pt			3197771.84	1268891.29	40°04'09.600"N	104°47'36.000"W

WELLPATH DATUM			
Calculation method	Minimum curvature	XTREME 15 (RKB) to Facility Vertical Datum	5123.00ft
Horizontal Reference Pt	Slot	XTREME 15 (RKB) to Mean Sea Level	5123.00ft
Vertical Reference Pt	XTREME 15 (RKB)	XTREME 15 (RKB) to Mud Line at Slot (SLOT#14 BADDING 11-35SX (1017'FSL & 1627'FWL))	5123.00ft
MD Reference Pt	XTREME 15 (RKB)	Section Origin	N 0.00, E 0.00 ft
Field Vertical Reference	Mean Sea Level	Section Azimuth	30.69°



# Actual Wellpath Report

BADDING 11-35SX AWP

Page 2 of 5



REFERENCE WELLPATH IDENTIFICATION			
Operator	KERR MCGEE OIL & GAS ONSHORE LP	Slot	SLOT#14 BADDING 11-35SX (1017'FSL & 1627'FWL)
Area	COLORADO	Well	BADDING 11-35SX
Field	WELD COUNTY (KERR MCGEE)	Wellbore	BADDING 11-35SX AWB
Facility	SEC.35-T2N-R66W		

WELLPATH DATA (61 stations) † = interpolated/extrapolated station								
MD [ft]	Inclination [°]	Azimuth [°]	TVD [ft]	Vert Sect [ft]	North [ft]	East [ft]	DLS [°/100ft]	Comments
0.00†	0.000	137.500	0.00	0.00	0.00	0.00	0.00	
15.00	0.000	137.500	15.00	0.00	0.00	0.00	0.00	
150.00	0.200	137.500	150.00	-0.07	-0.17	0.16	0.15	
243.00	0.500	41.900	243.00	0.28	0.01	0.54	0.60	
337.00	0.500	53.500	336.99	1.06	0.56	1.14	0.11	
426.00	0.500	66.800	425.99	1.74	0.94	1.81	0.13	
516.00	0.200	90.400	515.99	2.13	1.10	2.33	0.36	
603.00	0.400	143.500	602.99	2.09	0.85	2.66	0.37	
693.00	0.800	155.800	692.98	1.61	0.02	3.11	0.46	
781.00	0.900	161.400	780.97	0.80	-1.19	3.58	0.15	
870.00	0.900	174.700	869.96	-0.22	-2.55	3.87	0.23	
959.00	0.900	178.300	958.95	-1.37	-3.94	3.95	0.06	
1048.00	0.900	186.000	1047.94	-2.60	-5.34	3.90	0.14	
1105.00	0.900	190.200	1104.93	-3.43	-6.22	3.77	0.12	
1191.00	0.700	225.400	1190.93	-4.57	-7.26	3.28	0.60	
1288.00	2.000	282.000	1287.90	-5.68	-7.32	1.20	1.77	
1367.00	3.100	324.500	1366.83	-5.26	-5.30	-1.39	2.68	
1457.00	6.200	354.700	1456.53	-0.34	1.53	-3.25	4.28	
1546.00	8.700	8.500	1544.78	9.78	12.97	-2.70	3.44	
1635.00	11.300	13.700	1632.42	24.35	28.10	0.36	3.09	
1724.00	12.500	21.500	1719.51	42.20	45.54	5.96	2.25	
1812.00	15.100	25.700	1804.97	63.03	64.73	14.42	3.16	
1900.00	16.500	34.100	1889.65	86.92	85.41	26.40	3.04	
1990.00	17.300	33.400	1975.77	113.05	107.17	40.93	0.92	
2080.00	18.200	34.800	2061.48	140.44	129.88	56.32	1.11	
2170.00	17.600	33.800	2147.12	168.04	152.73	71.91	0.75	
2259.00	17.100	33.100	2232.07	194.55	174.87	86.54	0.61	
2347.00	17.800	37.600	2316.03	220.83	196.37	101.82	1.73	
2436.00	16.900	36.600	2400.98	247.20	217.53	117.83	1.07	
2525.00	16.100	31.700	2486.32	272.41	238.42	132.03	1.80	
2615.00	17.400	33.800	2572.50	298.33	260.22	146.07	1.59	
2703.00	18.700	36.900	2656.17	325.49	282.44	161.86	1.84	
2792.00	20.900	37.300	2739.90	355.45	306.48	180.05	2.48	
2881.00	19.300	31.000	2823.49	385.93	331.72	197.25	3.02	
2968.00	19.700	26.000	2905.50	414.92	357.22	211.08	1.97	
3058.00	18.000	28.500	2990.67	443.94	383.08	224.37	2.09	
3149.00	18.400	29.900	3077.12	472.35	407.89	238.24	0.65	
3237.00	18.500	28.500	3160.60	500.19	432.20	251.82	0.52	
3325.00	18.800	27.100	3243.98	528.29	457.09	264.94	0.61	
3414.00	19.400	26.700	3328.08	557.35	483.06	278.12	0.69	
3502.00	18.600	28.800	3411.28	585.96	508.42	291.45	1.20	
3591.00	18.400	30.300	3495.68	614.19	532.98	305.37	0.58	
3681.00	17.800	31.000	3581.23	642.15	557.04	319.62	0.71	
3768.00	17.300	29.900	3664.18	668.38	579.65	332.92	0.69	
3859.00	16.600	31.700	3751.23	694.91	602.44	346.50	0.96	



# Actual Wellpath Report

BADDING 11-35SX AWP

Page 3 of 5



REFERENCE WELLPATH IDENTIFICATION			
Operator	KERR MCGEE OIL & GAS ONSHORE LP	Slot	SLOT#14 BADDING 11-35SX (1017'FSL & 1627'FWL)
Area	COLORADO	Well	BADDING 11-35SX
Field	WELD COUNTY (KERR MCGEE)	Wellbore	BADDING 11-35SX AWB
Facility	SEC.35-T2N-R66W		

WELLPATH DATA (61 stations)								
MD [ft]	Inclination [°]	Azimuth [°]	TVD [ft]	Vert Sect [ft]	North [ft]	East [ft]	DLS [°/100ft]	Comments
3948.00	14.100	31.700	3837.05	718.46	622.48	358.87	2.81	
4036.00	14.400	37.500	3922.34	740.05	640.28	371.17	1.66	
4126.00	15.600	31.000	4009.28	763.26	659.54	384.22	2.29	
4215.00	17.700	23.200	4094.56	788.65	682.24	395.71	3.44	
4302.00	17.200	29.200	4177.56	814.63	705.62	407.20	2.15	
4391.00	18.100	32.000	4262.37	841.60	728.83	420.95	1.39	
4480.00	17.800	32.700	4347.04	869.02	752.01	435.62	0.42	
4570.00	17.800	28.500	4432.73	896.51	775.67	449.62	1.43	
4660.00	15.600	27.400	4518.93	922.35	798.51	461.75	2.47	
4750.00	13.400	25.300	4606.06	944.81	818.68	471.78	2.51	
4839.00	15.100	31.300	4692.32	966.67	837.91	482.21	2.53	
4928.00	16.000	36.600	4778.07	990.47	857.67	495.55	1.89	
5017.00	14.100	37.600	4864.01	1013.43	876.11	509.48	2.15	
5104.00	13.100	39.000	4948.57	1033.71	892.17	522.15	1.21	
5210.00	11.100	39.700	5052.21	1055.68	909.35	536.22	1.89	LAST BHI MWD SURVEY
5260.00	11.100	39.700	5101.28	1065.18	916.76	542.37	0.00	PROJECTION TO BIT

HOLE & CASING SECTIONS - Ref Wellbore: BADDING 11-35SX AWB      Ref Wellpath: BADDING 11-35SX AWP									
String/Diameter	Start MD [ft]	End MD [ft]	Interval [ft]	Start TVD [ft]	End TVD [ft]	Start N/S [ft]	Start E/W [ft]	End N/S [ft]	End E/W [ft]
12.25in Open Hole	15.00	1195.00	1180.00	15.00	1194.93	0.00	0.00	-7.29	3.24
8.625in Casing Surface	15.00	1150.00	1135.00	15.00	1149.93	0.00	0.00	-6.84	3.58
7.875in Open Hole	1150.00	5260.00	4110.00	1149.93	5101.28	-6.84	3.58	916.76	542.37



# Actual Wellpath Report

BADDING 11-35SX AWP

Page 4 of 5



REFERENCE WELLPATH IDENTIFICATION			
Operator	KERR MCGEE OIL & GAS ONSHORE LP	Slot	SLOT#14 BADDING 11-35SX (1017'FSL & 1627'FWL)
Area	COLORADO	Well	BADDING 11-35SX
Field	WELD COUNTY (KERR MCGEE)	Wellbore	BADDING 11-35SX AWB
Facility	SEC.35-T2N-R66W		

TARGETS									
Name	MD [ft]	TVD [ft]	North [ft]	East [ft]	Grid East [US ft]	Grid North [US ft]	Latitude	Longitude	Shape
BADDING 11-35SX BHL ON PLAT (1830'FSL & 2130'FWL, REV-1)		4616.00	817.11	502.22	3210913.09	1277384.24	40°05'32.460"N	104°44'46.039"W	point
BADDING 11-35SX GEO TARGET 50' RADIUS (1859'FSL & 2130'FWL, REV-2)		4616.00	846.11	502.22	3210912.84	1277413.24	40°05'32.747"N	104°44'46.039"W	circle
BADDING 11-35SX LEGAL BOX (50'S,350'N,52'E,348'W OF GEO TARGET)		4616.00	996.11	354.22	3210763.58	1277561.97	40°05'34.229"N	104°44'47.943"W	square

WELLPATH COMPOSITION - Ref Wellbore: BADDING 11-35SX AWB					Ref Wellpath: BADDING 11-35SX AWP				
Start MD [ft]	End MD [ft]	Positional Uncertainty Model			Log Name/Comment			Wellbore	
15.00	5210.00	NaviTrak (Standard)			BHI MWD SURVEYS <150-5210>			BADDING 11-35SX AWB	
5210.00	5260.00	Blind Drilling (std)			Projection to bit			BADDING 11-35SX AWB	



# Actual Wellpath Report

BADDING 11-35SX AWP

Page 5 of 5



REFERENCE WELLPATH IDENTIFICATION			
Operator	KERR MCGEE OIL & GAS ONSHORE LP	Slot	SLOT#14 BADDING 11-35SX (1017'FSL & 1627'FWL)
Area	COLORADO	Well	BADDING 11-35SX
Field	WELD COUNTY (KERR MCGEE)	Wellbore	BADDING 11-35SX AWB
Facility	SEC.35-T2N-R66W		

WELLPATH COMMENTS				
MD [ft]	Inclination [°]	Azimuth [°]	TVD [ft]	Comment
5210.00	11.100	39.700	5052.21	LAST BHI MWD SURVEY
5260.00	11.100	39.700	5101.28	PROJECTION TO BIT