

## REFERENCE INFORMATION

Co-ordinate (NE) Reference: Well File 4-2-17, True North  
Vertical (TVD) Reference: WELL @ 4896.0ft (Original Well Elev)  
Section (VS) Reference: Slot - (0.0N, 0.0E)  
Measured Depth Reference: WELL @ 4896.0ft (Original Well Elev)  
Calculation Method:

## WELL DETAILS: File 4-2-17

+N/-S	+E/-W	Northing	Ground Level:	4883.0	Longitude	Slot
0.0	0.0	1295292.24	Easting	3133131.57	40° 8' 34.764 N105° 1' 25.644 W	

## SECTION DETAILS

Sec	MD	Inc	Azi	TVD	+N/-S	+E/-W	DLeg	TFace	VSec	Target
1	0.0	0.00	0.00	0.0	0.0	0.0	0.00	0.00	0.0	
2	600.0	0.00	0.00	600.0	0.0	0.0	0.00	0.00	0.0	
3	1056.5	9.13	249.08	1054.6	-13.0	-33.9	2.00	249.08	36.3	
4	6578.3	9.13	249.08	6506.4	-325.8	-852.3	0.00	0.00	912.5	
5	7034.8	0.00	0.00	6961.0	-338.8	-886.2	2.00	180.00	948.8	
6	8084.8	0.00	0.00	8011.0	-338.8	-886.2	0.00	0.00	948.8	File 4-2-17

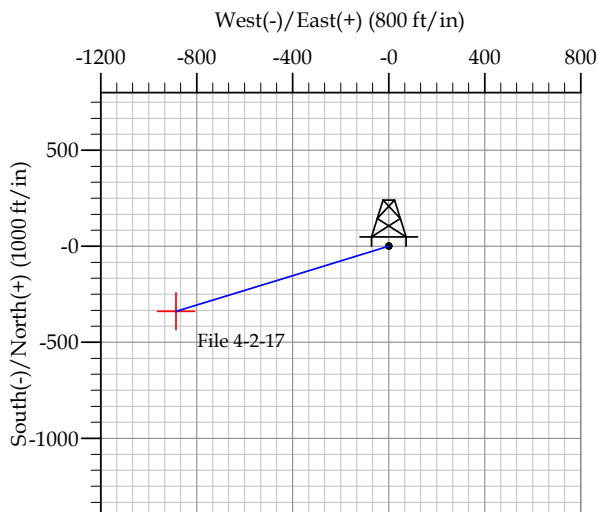

## FORMATION TOP DETAILS

TVDPath	MDPath	Formation
4156.0	4197.7	Sussex
5101.0	5154.9	Shannon
7156.0	7229.8	Niobrara
7446.0	7519.8	Codell
7861.0	7934.8	J Sand
7931.0	8004.8	A Marker

## CASING DETAILS

TVD	MD	Name	Size
550.0	550.0	Surface	8.625
8011.0	8084.8	Production	4.500

# EnCana Corporation

## Planning Report - Geographic

<b>Database:</b>	EDM	<b>Local Co-ordinate Reference:</b>	Well File 4-2-17
<b>Company:</b>	DJ/Paradox/WTX	<b>TVD Reference:</b>	WELL @ 4896.0ft (Original Well Elev)
<b>Project:</b>	Wattenberg	<b>MD Reference:</b>	WELL @ 4896.0ft (Original Well Elev)
<b>Site:</b>	New Drills	<b>North Reference:</b>	True
<b>Well:</b>	File 4-2-17	<b>Survey Calculation Method:</b>	Minimum Curvature
<b>Wellbore:</b>	Wellbore #1		
<b>Design:</b>	File 4-2-17		

<b>Project</b>	Wattenberg,		
<b>Map System:</b>	US State Plane 1983	<b>System Datum:</b>	Mean Sea Level
<b>Geo Datum:</b>	North American Datum 1983		
<b>Map Zone:</b>	Colorado Northern Zone		

Site		New Drills				
Site Position:		Northing:	1,278,589.08ft	Latitude:	40° 5' 49.848 N	
From:	Lat/Long	Easting:	3,130,247.44ft	Longitude:	105° 2' 3.912 W	
Position Uncertainty:		ft	Slot Radius:	in	Grid Convergence:	0.30 °

Well	File 4-2-17					
Well Position	+N-S	16,687.5 ft	Northing:	1,295,292.24 ft	Latitude:	40° 8' 34.764 N
	+E-W	2,973.8 ft	Easting:	3,133,131.57 ft	Longitude:	105° 1' 25.644 W
Position Uncertainty		ft	Wellhead Elevation:	ft	Ground Level:	4,883.0ft

<b>Wellbore</b>	Wellbore #1				
<b>Magnetics</b>	<b>Model Name</b>	<b>Sample Date</b>	<b>Declination (°)</b>	<b>Dip Angle (°)</b>	<b>Field Strength (nT)</b>
	IGRF200510	12/31/2009	9.14	66.86	53,140

<b>Design</b>	File 4-2-17				
<b>Audit Notes:</b>					
<b>Version:</b>	<b>Phase:</b>	PROTOTYPE		<b>Tie On Depth:</b>	0.0
<b>Vertical Section:</b>	<b>Depth From (TVD) (ft)</b>	<b>+N-S (ft)</b>	<b>+E-W (ft)</b>	<b>Direction (°)</b>	
	0.0	0.0	0.0	249.08	

<b>Plan Sections</b>										
Measured Depth (ft)	Inclination (°)	Azimuth (°)	Vertical Depth (ft)	+N-S (ft)	+E-W (ft)	Dogleg Rate (°/100ft)	Build Rate (°/100ft)	Turn Rate (°/100ft)	TFO (°)	Target
0.0	0.00	0.00	0.0	0.0	0.0	0.00	0.00	0.00	0.00	
600.0	0.00	0.00	600.0	0.0	0.0	0.00	0.00	0.00	0.00	
1,056.5	9.13	249.08	1,054.6	-13.0	-33.9	2.00	2.00	0.00	249.08	
6,578.3	9.13	249.08	6,506.4	-325.8	-852.3	0.00	0.00	0.00	0.00	
7,034.8	0.00	0.00	6,961.0	-338.8	-886.2	2.00	-2.00	0.00	180.00	
8,084.8	0.00	0.00	8,011.0	-338.8	-886.2	0.00	0.00	0.00	0.00	File 4-2-17

# EnCana Corporation

## Planning Report - Geographic

<b>Database:</b>	EDM	<b>Local Co-ordinate Reference:</b>	Well File 4-2-17
<b>Company:</b>	DJ/Paradox/WTX	<b>TVD Reference:</b>	WELL @ 4896.0ft (Original Well Elev)
<b>Project:</b>	Wattenberg	<b>MD Reference:</b>	WELL @ 4896.0ft (Original Well Elev)
<b>Site:</b>	New Drills	<b>North Reference:</b>	True
<b>Well:</b>	File 4-2-17	<b>Survey Calculation Method:</b>	Minimum Curvature
<b>Wellbore:</b>	Wellbore #1		
<b>Design:</b>	File 4-2-17		

Planned Survey										
Measured Depth (ft)	Inclination (°)	Azimuth (°)	Vertical Depth (ft)	+N/-S (ft)	+E/-W (ft)	Map Northing (ft)	Map Easting (ft)	Latitude	Longitude	
0.0	0.00	0.00	0.0	0.0	0.0	1,295,292.24	3,133,131.57	40° 8' 34.764 N	105° 1' 25.644 W	
550.0	0.00	0.00	550.0	0.0	0.0	1,295,292.24	3,133,131.57	40° 8' 34.764 N	105° 1' 25.644 W	
Surface										
600.0	0.00	0.00	600.0	0.0	0.0	1,295,292.24	3,133,131.57	40° 8' 34.764 N	105° 1' 25.644 W	
1,056.5	9.13	249.08	1,054.6	-13.0	-33.9	1,295,279.10	3,133,097.74	40° 8' 34.636 N	105° 1' 26.081 W	
4,197.7	9.13	249.08	4,156.0	-190.9	-499.5	1,295,098.63	3,132,633.12	40° 8' 32.877 N	105° 1' 32.076 W	
Sussex										
5,154.9	9.13	249.08	5,101.0	-245.2	-641.4	1,295,043.65	3,132,491.55	40° 8' 32.341 N	105° 1' 33.903 W	
Shannon										
6,578.3	9.13	249.08	6,506.4	-325.8	-852.3	1,294,961.87	3,132,281.00	40° 8' 31.544 N	105° 1' 36.619 W	
7,034.8	0.00	0.00	6,961.0	-338.8	-886.2	1,294,948.73	3,132,247.17	40° 8' 31.416 N	105° 1' 37.056 W	
7,229.8	0.00	0.00	7,156.0	-338.8	-886.2	1,294,948.73	3,132,247.17	40° 8' 31.416 N	105° 1' 37.056 W	
Niobrara										
7,519.8	0.00	0.00	7,446.0	-338.8	-886.2	1,294,948.73	3,132,247.17	40° 8' 31.416 N	105° 1' 37.056 W	
Codell										
7,934.8	0.00	0.00	7,861.0	-338.8	-886.2	1,294,948.73	3,132,247.17	40° 8' 31.416 N	105° 1' 37.056 W	
J Sand										
8,004.8	0.00	0.00	7,931.0	-338.8	-886.2	1,294,948.73	3,132,247.17	40° 8' 31.416 N	105° 1' 37.056 W	
A Marker										
8,084.8	0.00	0.00	8,011.0	-338.8	-886.2	1,294,948.73	3,132,247.17	40° 8' 31.416 N	105° 1' 37.056 W	
Production - File 4-2-17										

Design Targets										
Target Name	Dip Angle (°)	Dip Dir. (°)	TVD (ft)	+N/-S (ft)	+E/-W (ft)	Northing (ft)	Easting (ft)	Latitude	Longitude	
- hit/miss target										
- Shape										
File 4-2-17	0.00	0.00	8,011.0	-338.8	-886.2	1,294,948.73	3,132,247.17	40° 8' 31.416 N	105° 1' 37.056 W	
- plan hits target										
- Point										

Casing Points					
Measured Depth (ft)	Vertical Depth (ft)	Name	Casing Diameter (in)	Hole Diameter (in)	
550.0	550.0	Surface	8.625	12.250	
8,084.8	8,011.0	Production	4.500	7.785	

Formations						
Measured Depth (ft)	Vertical Depth (ft)	Name	Lithology	Dip (°)	Dip Direction (°)	
4,197.7	4,156.0	Sussex		0.00		
5,154.9	5,101.0	Shannon		0.00		
7,229.8	7,156.0	Niobrara		0.00		
7,519.8	7,446.0	Codell		0.00		
7,934.8	7,861.0	J Sand		0.00		
8,004.8	7,931.0	A Marker		0.00		

**EnCana Corporation**  
Planning Report - Geographic

<b>Database:</b>	EDM	<b>Local Co-ordinate Reference:</b>	Well File 4-2-17
<b>Company:</b>	DJ/Paradox/WTX	<b>TVD Reference:</b>	WELL @ 4896.0ft (Original Well Elev)
<b>Project:</b>	Wattenberg	<b>MD Reference:</b>	WELL @ 4896.0ft (Original Well Elev)
<b>Site:</b>	New Drills	<b>North Reference:</b>	True
<b>Well:</b>	File 4-2-17	<b>Survey Calculation Method:</b>	Minimum Curvature
<b>Wellbore:</b>	Wellbore #1		
<b>Design:</b>	File 4-2-17		