

REFERENCE INFORMATION										
Co-ordinate (NE) Reference: Well File 41-17, True North										
Vertical (TVD) Reference: WELL @ 4895.0ft (Original Well Elev)										
Section (VS) Reference: Slot - (0.0N, 0.0E)										
Measured Depth Reference: WELL @ 4895.0ft (Original Well Elev)										
Calculation Method:										
WELL DETAILS: File 41-17										
+N/-S	+E/-W	Northing		Ground Level: 4882.0		Easting		Latitude	Longitude	Slot
0.0	0.0	1295270.50		3133154.06		40° 8' 34.548 N		105° 1' 25.356 W		
SECTION DETAILS										
Sec	MD	Inc	Azi	TVD	+N/-S	+E/-W	DLeg	TFace	VSec	Target
1	0.0	0.00	0.00	0.0	0.0	0.0	0.00	0.00	0.0	
2	600.0	0.00	0.00	600.0	0.0	0.0	0.00	0.00	0.0	
3	1227.7	12.55	70.32	1222.7	23.1	64.5	2.00	70.32	68.5	
4	6470.6	12.55	70.32	6340.3	406.8	1137.6	0.00	0.00	1208.2	
5	7098.4	0.00	0.00	6963.0	429.9	1202.1	2.00	180.00	1276.7	
6	8148.4	0.00	0.00	8013.0	429.9	1202.1	0.00	0.00	1276.7	File 41-17

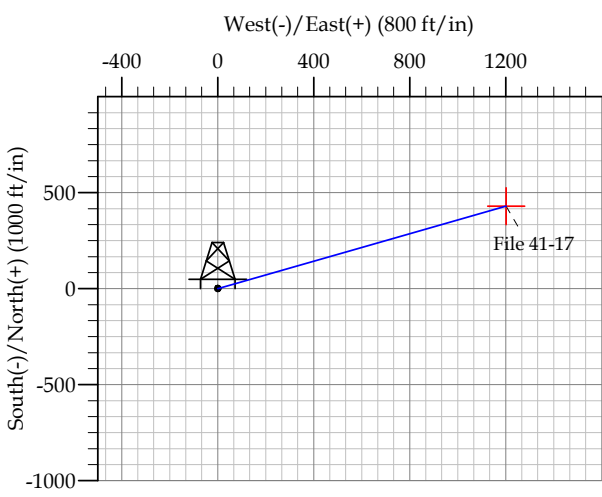

FORMATION TOP DETAILS			
TVDPath	MDPath	Formation	
4140.0	4216.5	Sussex	
5105.0	5205.1	Shannon	
7145.0	7280.4	Niobrara	
7440.0	7575.4	Codell	
7863.0	7998.4	J Sand	
7933.0	8068.4	A Marker	
CASING DETAILS			
TVD	MD	Name	Size
550.0	550.0	Surface	8.625
8013.0	8148.4	Production	4.500

EnCana Corporation

Planning Report - Geographic

Database:	EDM	Local Co-ordinate Reference:	Well File 41-17
Company:	DJ/Paradox/WTX	TVD Reference:	WELL @ 4895.0ft (Original Well Elev)
Project:	Wattenberg	MD Reference:	WELL @ 4895.0ft (Original Well Elev)
Site:	New Drills	North Reference:	True
Well:	File 41-17	Survey Calculation Method:	Minimum Curvature
Wellbore:	Wellbore #1		
Design:	File 41-17		

Project	Wattenberg,		
Map System:	US State Plane 1983	System Datum:	Mean Sea Level
Geo Datum:	North American Datum 1983		
Map Zone:	Colorado Northern Zone		

Site		New Drills				
Site Position:		Northing:	1,278,589.08ft	Latitude:	40° 5' 49.848 N	
From:	Lat/Long	Easting:	3,130,247.44ft	Longitude:	105° 2' 3.912 W	
Position Uncertainty:		ft	Slot Radius:	in	Grid Convergence:	0.30 °

Well	File 41-17					
Well Position	+N-S	16,665.6 ft	Northing:	1,295,270.50 ft	Latitude:	40° 8' 34.548 N
	+E-W	2,996.2 ft	Easting:	3,133,154.06 ft	Longitude:	105° 1' 25.356 W
Position Uncertainty		ft	Wellhead Elevation:	ft	Ground Level:	4,882.0 ft

Wellbore	Wellbore #1				
Magnetics	Model Name	Sample Date	Declination (°)	Dip Angle (°)	Field Strength (nT)
	IGRF200510	12/31/2009	9.14	66.86	53,140

Design	File 41-17				
Audit Notes:					
Version:	Phase:	PROTOTYPE		Tie On Depth:	0.0
Vertical Section:	Depth From (TVD) (ft)	+N/-S (ft)	+E/-W (ft)	Direction (°)	
	0.0	0.0	0.0	70.32	

Plan Sections										
Measured Depth (ft)	Inclination (°)	Azimuth (°)	Vertical Depth (ft)	+N/-S (ft)	+E/-W (ft)	Dogleg Rate (°/100ft)	Build Rate (°/100ft)	Turn Rate (°/100ft)	TFO (°)	Target
0.0	0.00	0.00	0.0	0.0	0.0	0.00	0.00	0.00	0.00	
600.0	0.00	0.00	600.0	0.0	0.0	0.00	0.00	0.00	0.00	
1,227.7	12.55	70.32	1,222.7	23.1	64.5	2.00	2.00	0.00	70.32	
6,470.6	12.55	70.32	6,340.3	406.8	1,137.6	0.00	0.00	0.00	0.00	
7,098.4	0.00	0.00	6,963.0	429.9	1,202.1	2.00	-2.00	0.00	180.00	
8,148.4	0.00	0.00	8,013.0	429.9	1,202.1	0.00	0.00	0.00	0.00	File 41-17

EnCana Corporation

Planning Report - Geographic

Database:	EDM	Local Co-ordinate Reference:	Well File 41-17
Company:	DJ/Paradox/WTX	TVD Reference:	WELL @ 4895.0ft (Original Well Elev)
Project:	Wattenberg	MD Reference:	WELL @ 4895.0ft (Original Well Elev)
Site:	New Drills	North Reference:	True
Well:	File 41-17	Survey Calculation Method:	Minimum Curvature
Wellbore:	Wellbore #1		
Design:	File 41-17		

Planned Survey										
Measured Depth (ft)	Inclination (°)	Azimuth (°)	Vertical Depth (ft)	+N/-S (ft)	+E/-W (ft)	Map Northing (ft)	Map Easting (ft)	Latitude	Longitude	
0.0	0.00	0.00	0.0	0.0	0.0	1,295,270.50	3,133,154.06	40° 8' 34.548 N	105° 1' 25.356 W	
550.0	0.00	0.00	550.0	0.0	0.0	1,295,270.50	3,133,154.06	40° 8' 34.548 N	105° 1' 25.356 W	
Surface										
600.0	0.00	0.00	600.0	0.0	0.0	1,295,270.50	3,133,154.06	40° 8' 34.548 N	105° 1' 25.356 W	
1,227.7	12.55	70.32	1,222.7	23.1	64.5	1,295,293.91	3,133,218.43	40° 8' 34.776 N	105° 1' 24.525 W	
4,216.5	12.55	70.32	4,140.0	241.8	676.2	1,295,515.96	3,133,828.98	40° 8' 36.938 N	105° 1' 16.648 W	
Sussex										
5,205.1	12.55	70.32	5,105.0	314.2	878.6	1,295,589.41	3,134,030.94	40° 8' 37.653 N	105° 1' 14.042 W	
Shannon										
6,470.6	12.55	70.32	6,340.3	406.8	1,137.6	1,295,683.43	3,134,289.47	40° 8' 38.568 N	105° 1' 10.707 W	
7,098.4	0.00	0.00	6,963.0	429.9	1,202.1	1,295,706.84	3,134,353.85	40° 8' 38.796 N	105° 1' 9.876 W	
7,280.4	0.00	0.00	7,145.0	429.9	1,202.1	1,295,706.84	3,134,353.85	40° 8' 38.796 N	105° 1' 9.876 W	
Niobrara										
7,575.4	0.00	0.00	7,440.0	429.9	1,202.1	1,295,706.84	3,134,353.85	40° 8' 38.796 N	105° 1' 9.876 W	
Codell										
7,998.4	0.00	0.00	7,863.0	429.9	1,202.1	1,295,706.84	3,134,353.85	40° 8' 38.796 N	105° 1' 9.876 W	
J Sand										
8,068.4	0.00	0.00	7,933.0	429.9	1,202.1	1,295,706.84	3,134,353.85	40° 8' 38.796 N	105° 1' 9.876 W	
A Marker										
8,148.4	0.00	0.00	8,013.0	429.9	1,202.1	1,295,706.84	3,134,353.85	40° 8' 38.796 N	105° 1' 9.876 W	
Production - File 41-17										

Design Targets										
Target Name	Dip Angle (°)	Dip Dir. (°)	TVD (ft)	+N/-S (ft)	+E/-W (ft)	Northing (ft)	Easting (ft)	Latitude	Longitude	
- hit/miss target										
- Shape										
File 41-17	0.00	0.00	8,013.0	429.9	1,202.1	1,295,706.84	3,134,353.85	40° 8' 38.796 N	105° 1' 9.876 W	
- plan hits target										
- Point										

Casing Points					
Measured Depth (ft)	Vertical Depth (ft)	Name	Casing Diameter (in)	Hole Diameter (in)	
550.0	550.0	Surface	8.625	12.250	
8,148.4	8,013.0	Production	4.500	7.785	

Formations						
Measured Depth (ft)	Vertical Depth (ft)	Name	Lithology	Dip (°)	Dip Direction (°)	
4,216.5	4,140.0	Sussex		0.00		
5,205.1	5,105.0	Shannon		0.00		
7,280.4	7,145.0	Niobrara		0.00		
7,575.4	7,440.0	Codell		0.00		
7,998.4	7,863.0	J Sand		0.00		
8,068.4	7,933.0	A Marker		0.00		

EnCana Corporation
Planning Report - Geographic

Database:	EDM	Local Co-ordinate Reference:	Well File 41-17
Company:	DJ/Paradox/WTX	TVD Reference:	WELL @ 4895.0ft (Original Well Elev)
Project:	Wattenberg	MD Reference:	WELL @ 4895.0ft (Original Well Elev)
Site:	New Drills	North Reference:	True
Well:	File 41-17	Survey Calculation Method:	Minimum Curvature
Wellbore:	Wellbore #1		
Design:	File 41-17		