

REFERENCE INFORMATION

Co-ordinate (NE) Reference: Well File 32-17, True North
Vertical (TVD) Reference: WELL @ 4896.0ft (Original Well Elev)
Section (VS) Reference: Slot - (0.0N, 0.0E)
Measured Depth Reference: WELL @ 4896.0ft (Original Well Elev)
Calculation Method:

WELL DETAILS: File 32-17

+N/-S	+E/-W	Northing	Ground Level:	Easting	Latitude	Longitude	Slot
0.0	0.0	1295285.00	4883.0	3133140.00	40° 8' 34.692 N	105° 1' 25.536 W	

SECTION DETAILS

Sec	MD	Inc	Azi	TVD	+N/-S	+E/-W	DLeg	TFace	VSec	Target
1	0.0	0.00	0.00	0.0	0.0	0.0	0.00	0.00	0.0	
2	600.0	0.00	0.00	600.0	0.0	0.0	0.00	0.00	0.0	
3	1174.4	11.49	201.88	1170.6	-53.3	-21.4	2.00	201.88	57.4	
4	6549.9	11.49	201.88	6438.4	-1046.8	-420.3	0.00	0.00	1128.1	
5	7124.4	0.00	0.00	7009.0	-1100.1	-441.7	2.00	180.00	1185.5	
6	8134.4	0.00	0.00	8019.0	-1100.1	-441.7	0.00	0.00	1185.5	File 32-17

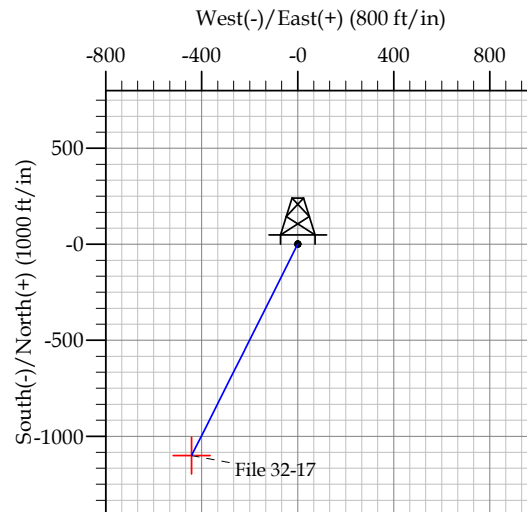

FORMATION TOP DETAILS

TVDPath	MDPath	Formation
4171.0	4236.2	Sussex
5096.0	5180.1	Shannon
7166.0	7281.4	Niobrara
7451.0	7566.4	Codell
7869.0	7984.4	J Sand
7929.0	8044.4	A Marker

CASING DETAILS

TVD	MD	Name	Size
550.0	550.0	Surface	8.625
8019.0	8134.4	Production	4.500

EnCana Corporation

Planning Report - Geographic

Database:	EDM	Local Co-ordinate Reference:	Well File 32-17
Company:	DJ/Paradox/WTX	TVD Reference:	WELL @ 4896.0ft (Original Well Elev)
Project:	Wattenberg	MD Reference:	WELL @ 4896.0ft (Original Well Elev)
Site:	New Drills	North Reference:	True
Well:	File 32-17	Survey Calculation Method:	Minimum Curvature
Wellbore:	Wellbore #1		
Design:	File 32-17		

Project	Wattenberg,		
Map System:	US State Plane 1983	System Datum:	Mean Sea Level
Geo Datum:	North American Datum 1983		
Map Zone:	Colorado Northern Zone		

Site	New Drills				
Site Position:		Northing:	1,278,589.08ft	Latitude:	40° 5' 49.848 N
From:	Lat/Long	Easting:	3,130,247.44ft	Longitude:	105° 2' 3.912 W
Position Uncertainty:	ft	Slot Radius:	in	Grid Convergence:	0.30 °

Well		File 32-17				
Well Position	+N-S	16,680.2 ft	Northing:	1,295,285.00 ft	Latitude:	40° 8' 34.692 N
	+E-W	2,982.2 ft	Easting:	3,133,140.00 ft	Longitude:	105° 1' 25.536 W
Position Uncertainty		ft	Wellhead Elevation:	ft	Ground Level:	4,883.0 ft

Wellbore	Wellbore #1				
Magnetics	Model Name	Sample Date	Declination (°)	Dip Angle (°)	Field Strength (nT)
	IGRF200510	12/31/2009	9.14	66.86	53,140

Design	File 32-17				
Audit Notes:					
Version:	Phase:	PROTOTYPE	Tie On Depth:	0.0	
Vertical Section:	Depth From (TVD) (ft)	+N-S (ft)	+E-W (ft)	Direction (°)	
	0.0	0.0	0.0	201.88	

Plan Sections										
Measured Depth (ft)	Inclination (°)	Azimuth (°)	Vertical Depth (ft)	+N-S (ft)	+E-W (ft)	Dogleg Rate (°/100ft)	Build Rate (°/100ft)	Turn Rate (°/100ft)	TFO (°)	Target
0.0	0.00	0.00	0.0	0.0	0.0	0.00	0.00	0.00	0.00	
600.0	0.00	0.00	600.0	0.0	0.0	0.00	0.00	0.00	0.00	
1,174.4	11.49	201.88	1,170.6	-53.3	-21.4	2.00	2.00	0.00	201.88	
6,549.9	11.49	201.88	6,438.4	-1,046.8	-420.3	0.00	0.00	0.00	0.00	
7,124.4	0.00	0.00	7,009.0	-1,100.1	-441.7	2.00	-2.00	0.00	180.00	
8,134.4	0.00	0.00	8,019.0	-1,100.1	-441.7	0.00	0.00	0.00	0.00	File 32-17

EnCana Corporation

Planning Report - Geographic

Database:	EDM	Local Co-ordinate Reference:	Well File 32-17
Company:	DJ/Paradox/WTX	TVD Reference:	WELL @ 4896.0ft (Original Well Elev)
Project:	Wattenberg	MD Reference:	WELL @ 4896.0ft (Original Well Elev)
Site:	New Drills	North Reference:	True
Well:	File 32-17	Survey Calculation Method:	Minimum Curvature
Wellbore:	Wellbore #1		
Design:	File 32-17		

Planned Survey									
Measured Depth (ft)	Inclination (°)	Azimuth (°)	Vertical Depth (ft)	+N/-S (ft)	+E/-W (ft)	Map Northing (ft)	Map Easting (ft)	Latitude	Longitude
0.0	0.00	0.00	0.0	0.0	0.0	1,295,285.00	3,133,140.00	40° 8' 34.692 N	105° 1' 25.536 W
550.0	0.00	0.00	550.0	0.0	0.0	1,295,285.00	3,133,140.00	40° 8' 34.692 N	105° 1' 25.536 W
Surface									
600.0	0.00	0.00	600.0	0.0	0.0	1,295,285.00	3,133,140.00	40° 8' 34.692 N	105° 1' 25.536 W
1,174.4	11.49	201.88	1,170.6	-53.3	-21.4	1,295,231.62	3,133,118.90	40° 8' 34.165 N	105° 1' 25.811 W
4,236.2	11.49	201.88	4,171.0	-619.2	-248.6	1,294,664.49	3,132,894.71	40° 8' 28.573 N	105° 1' 28.737 W
Sussex									
5,180.1	11.49	201.88	5,096.0	-793.7	-318.7	1,294,489.65	3,132,825.59	40° 8' 26.849 N	105° 1' 29.640 W
Shannon									
6,549.9	11.49	201.88	6,438.4	-1,046.8	-420.3	1,294,235.91	3,132,725.28	40° 8' 24.346 N	105° 1' 30.949 W
7,124.4	0.00	0.00	7,009.0	-1,100.1	-441.7	1,294,182.53	3,132,704.18	40° 8' 23.820 N	105° 1' 31.224 W
7,281.4	0.00	0.00	7,166.0	-1,100.1	-441.7	1,294,182.53	3,132,704.18	40° 8' 23.820 N	105° 1' 31.224 W
Niobrara									
7,566.4	0.00	0.00	7,451.0	-1,100.1	-441.7	1,294,182.53	3,132,704.18	40° 8' 23.820 N	105° 1' 31.224 W
Codell									
7,984.4	0.00	0.00	7,869.0	-1,100.1	-441.7	1,294,182.53	3,132,704.18	40° 8' 23.820 N	105° 1' 31.224 W
J Sand									
8,044.4	0.00	0.00	7,929.0	-1,100.1	-441.7	1,294,182.53	3,132,704.18	40° 8' 23.820 N	105° 1' 31.224 W
A Marker									
8,134.4	0.00	0.00	8,019.0	-1,100.1	-441.7	1,294,182.53	3,132,704.18	40° 8' 23.820 N	105° 1' 31.224 W
Production - File 32-17									

Design Targets									
Target Name	Dip Angle (°)	Dip Dir. (°)	TVD (ft)	+N/-S (ft)	+E/-W (ft)	Northing (ft)	Easting (ft)	Latitude	Longitude
- hit/miss target									
- Shape									
File 32-17	0.00	0.00	8,019.0	-1,100.1	-441.7	1,294,182.53	3,132,704.18	40° 8' 23.820 N	105° 1' 31.224 W
- plan hits target									
- Point									

Casing Points					
Measured Depth (ft)	Vertical Depth (ft)	Name	Casing Diameter (in)	Hole Diameter (in)	
550.0	550.0	Surface	8.625	12.250	
8,134.4	8,019.0	Production	4.500	7.785	

Formations						
Measured Depth (ft)	Vertical Depth (ft)	Name	Lithology	Dip (°)	Dip Direction (°)	
4,236.2	4,171.0	Sussex		0.00		
5,180.1	5,096.0	Shannon		0.00		
7,281.4	7,166.0	Niobrara		0.00		
7,566.4	7,451.0	Codell		0.00		
7,984.4	7,869.0	J Sand		0.00		
8,044.4	7,929.0	A Marker		0.00		

EnCana Corporation
Planning Report - Geographic

Database:	EDM	Local Co-ordinate Reference:	Well File 32-17
Company:	DJ/Paradox/WTX	TVD Reference:	WELL @ 4896.0ft (Original Well Elev)
Project:	Wattenberg	MD Reference:	WELL @ 4896.0ft (Original Well Elev)
Site:	New Drills	North Reference:	True
Well:	File 32-17	Survey Calculation Method:	Minimum Curvature
Wellbore:	Wellbore #1		
Design:	File 32-17		