

CASCADE CREEK SURFACE WELL CC 697-05-67A

WELL PAD 697-08A
GRADED ELEVATION: 8400.40'

NAD83
N39.544700
W108.234155

SHL CC 697-05-67A LAT./LONG. (NAD83)

N39°32'37.45597" (N39 543738")
W108°14'47.19264" (W108 246442")

CSP (NAD 83)
N=1634641.64
E=2225596.31

BHL CC 697-05-67A LAT./LONG. (NAD83)

N39°32'51.77778" (N39 547716")
W108°14'46.61340" (W108 246282")

CSP (NAD 83)
N=1636088.67
E=2225685.46

N1° 39' 44"E 5261.83'



1" = 1,200'

Scale in feet

2,400' 1,200' 0 2,400'

NAD83
N39.530200
W108.234135

8

NAD83
N39.530188
W108.243517

S88° 21' 57"E 2646.55'

NAD83
N39.530197
W108.252852

S88° 11' 21"E 2632.91'

N1° 42' 02"E 2637.65'

N1° 46' 47"E 2639.47'

N1° 36' 57"E 2638.62'

NAD83
N39.544885
W108.252851

1917 BC
GLO

NAD83
N39.544695
W108.243518

1917 BC
GLO

1855'
FWL

1102'
FSL

N331°33'E
1449.76'

1807'
FWL

347'
FNL

SURVEYORS CERTIFICATE:

This is to certify that this exhibit was prepared and location as shown was staked on the ground from actual surveys made by me or under my direct supervision.

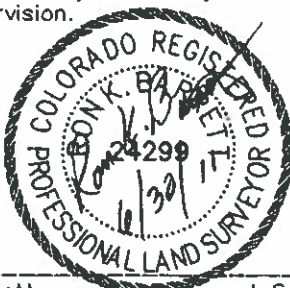

Ron K. Barrett L.S. 24299
On behalf of Del-Mont Consultants Inc.

LEGEND

- FOUND MONUMENT
- CALCULATED CORNER
- ◆ WELL LOCATION
- ⊙ TARGET LOCATION
- BOTTOM HOLE LOCATION
- SHL - SURFACE HOLE LOCATION
- THL - TARGET HOLE LOCATION
- BHL - BOTTOM HOLE LOCATION

NOTES:

- 1) GPS OPERATOR A LEWIS OBSERVED A PDOP OF 1.2
- 2) ALL GPS OBSERVATIONS ARE IN COMPLIANCE WITH COGCC RULE 215.
- 3) ALL DISTANCES ARE GRID DISTANCE IN U.S. SURVEY FEET, NAD83, COLORADO CENTRAL ZONE
- 4) THIS PLAN COMPLIES WITH COGCC RULE 303c
- 5) NO VISIBLE IMPROVEMENTS WITHIN 400' OF WELL HEAD.
- 6) VEGETATION: SCRUB OAK, ASPEN, NATIVE SHRUBS & GRASSES
- 7) TARGET HOLE AND BOTTOM HOLE NAD83 COORDINATES SHOWN ON THIS PLAN ARE CONVERTED FROM A DRILLING REPORT TRANSMITTED JUNE 8, 2011.

BASIS OF BEARING/DATUM

A GPS OBSERVATION FROM NGS PID AJ3463 (McCARY)

BASIS OF ELEVATION

A GPS OBSERVATION FROM NGS PID AJ3463 (McCARY). ELEVATION IS 5174.69'

DIMENSIONAL TIES

ALL DIMENSIONAL TIES TO SECTION LINES ARE MEASURED AT A 90° ANGLE TO THE SECTION LINE

DATE REVISED

DEL-MONT CONSULTANTS IS PROVIDING GRADING DESIGN FOR THIS PROJECT THAT PROVIDES DIMENSIONS AND VOLUME INFORMATION FOR CONSTRUCTION.



DEL-MONT CONSULTANTS, INC.
ENGINEERING • SURVEYING • PLANNING
138 Colorado Ave. • Montrose, CO 81401 • (970) 248-2281 • (970) 248-2542 fax
www.del-mont.com • info@del-mont.com



SECTIONS 5 & 8, T6S, R97W, 6TH PM
WELL LOCATION PLAT
SURFACE WELL CC 697-05-67A
WELL PAD 697-08A
GARFIELD COUNTY, COLORADO
OXY USA WTP LP

DESIGNED BY: MGW/SNS
CHECKED BY: R. BARRETT
SCALE: AS NOTED
FILE NAME: 10082V-007-08A.PLAT

DMC JOB NO: 10080
DATE ISSUED: 2011-06-01
DATE SURVEYED: 2008-08-19
PLAT: 1 of 9

