

ESTIMATED EARTHWORK				
ITEM	CUT	FILL	TOPSOIL	EXCESS
PAD	0 CY	0 CY	0 CY	0 CY
PIT	1389 CY			1389 CY
TOTALS	1389 CY	0 CY	0 CY	1389 CY

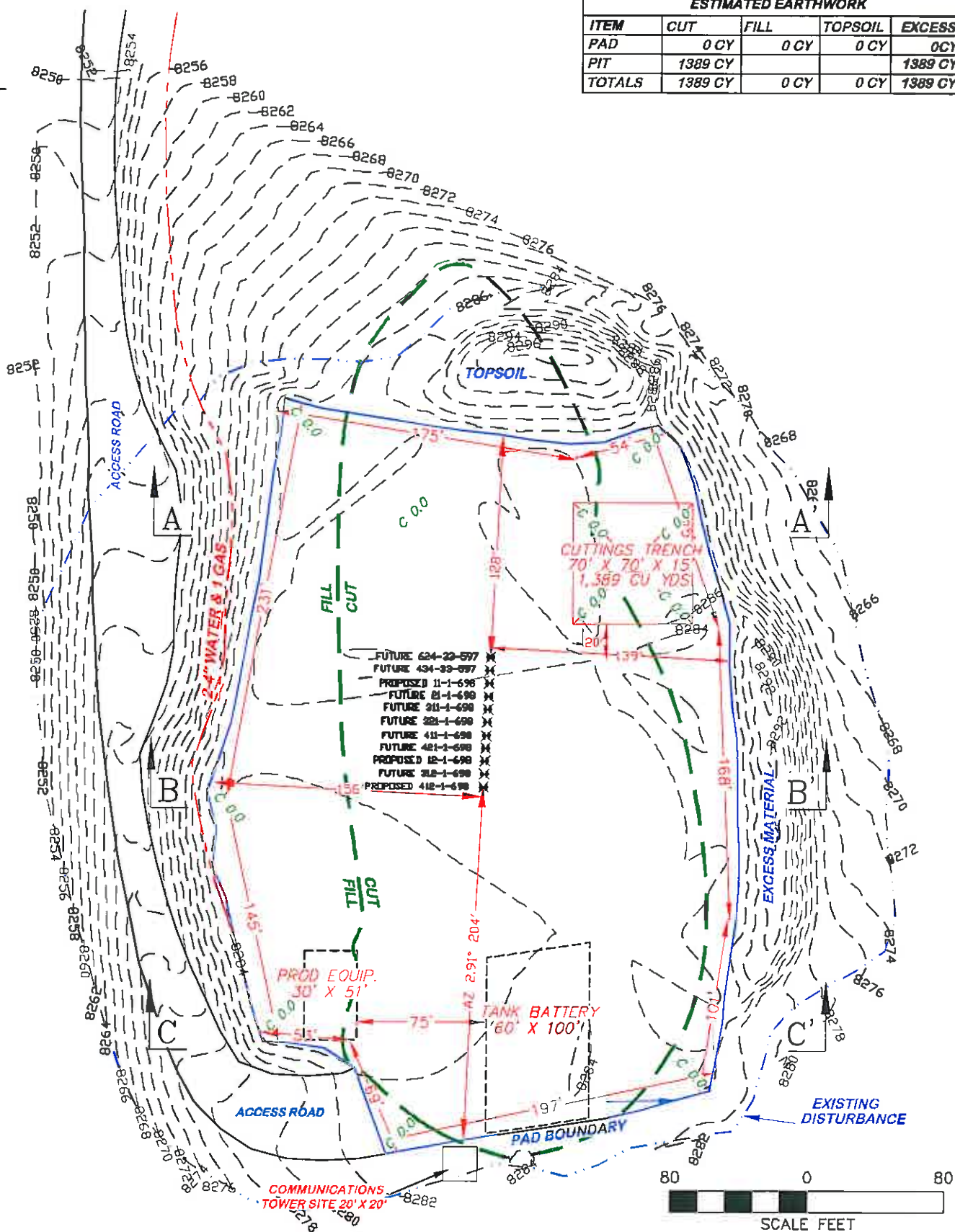

TR 11-1-698 PAD



RIFFIN & ASSOCIATES, INC.

(307) 382-5028

1414 ELK ST., ROCK SPRINGS, WY 82901

DRAWN: 1/16/08

SCALE: 1" = 80'

REVISED: 6/29/11 - RAB

DRG JOB No. 14324

REMOVED FRESHWATER PIT

PLAT 2

CONSTRUCTION LAYOUT

**WILLIAMS PRODUCTION RMT
COMPANY**

TR 11-1-698

NWNW, SECTION 1, T6S, R98W, 6th P.M.

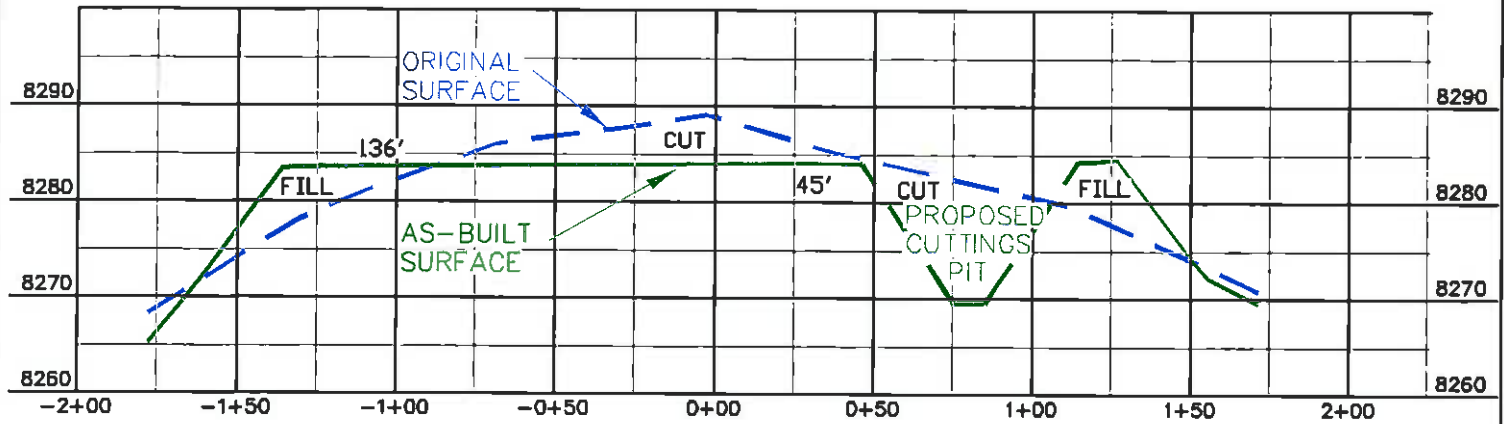

A - A'

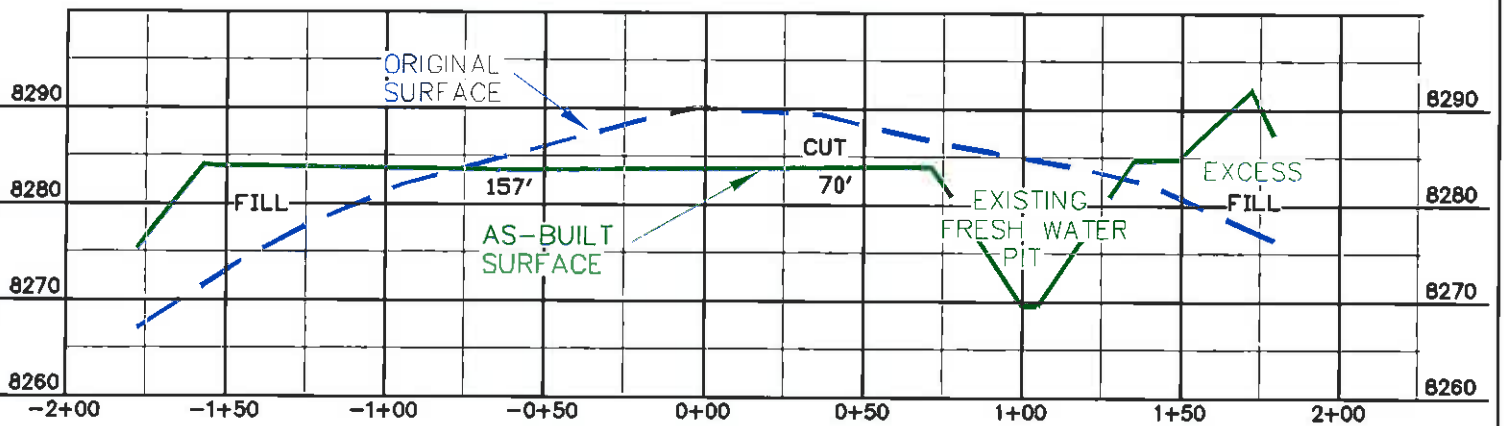

B - B'

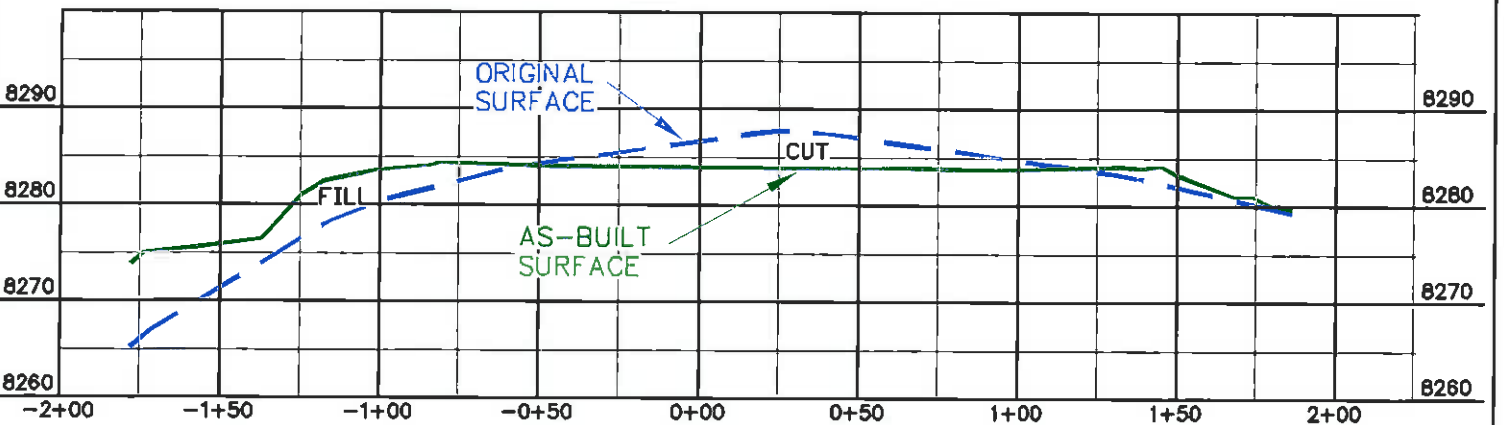

C - C'



RIFFIN & ASSOCIATES, INC.

(307) 382-5026

1414 ELK ST., ROCK SPRINGS, WY 82901

DRAWN: 1/16/08

HORZ. 1" = 60' VERT. 1" = 20'

REVISED: 6/15/11 - RAB

DRG JOB No. 14324

REVISED TO WILLIAMS EXAMPLE

PLAT 3

CONSTRUCTION LAYOUT CROSS SECTIONS

WILLIAMS PRODUCTION RMT
COMPANY

TR 11-1-698

NWNW, SECTION 1, T6S, R98W, 6th P.M.