

R. 67 W.

S 89°33'16" W 5324.51'

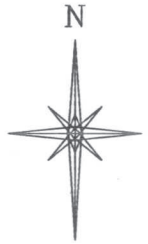

SCALE 1" = 1000'

T. 9 N.

BHL
LATITUDE (NAD 83)
NORTH 40.767237 DEG.
LONGITUDE (NAD 83)
WEST 104.841589 DEG.
LATITUDE (NAD 27)
NORTH 40.767256 DEG.
LONGITUDE (NAD 27)
WEST 104.841063 DEG.

NORTHING
523026
EASTING
2182530

LATITUDE (NAD 83)
NORTH 40.755197 DEG.
LONGITUDE (NAD 83)
WEST 104.841738 DEG.

LATITUDE (NAD 27)
NORTH 40.755215 DEG.
LONGITUDE (NAD 27)
WEST 104.841212 DEG.

NORTHING
518638.97
EASTING
2182521.06

BASIS OF BEARING/DATUM
SPCS CO NORTH NAD 27
BASED ON NGS TRIANGULATION
STATION "DOVER"

12
LOVELAND
12-9-67 1H
UNGRADED ELEVATION:
5342.7'

BASIS OF ELEVATION: USGS SPOT
ELEVATION LOCATED AT THE SW
CORNER SECTION 12, T9N, R67W,
ELEVATION: 5414'

S 00°06'38" W 5228.84'

N 00°32'07" W 5303.89'

S 89°38'13" E 2691.90'

S 89°39'07" E 2692.20'

NOTES

PRAIRIE LANDS
EXISTING TWO-TRACK & TELEPHONE LINE
WITHIN 400' RADIUS OF WELL SITE.

GPS OPERATOR PAUL ORME
OBSERVED A PDOP OF 2.4.
ALL GPS OBSERVATIONS ARE IN
COMPLIANCE WITH COGCC RULE No.215.



SURVEYOR'S STATEMENT

I, CLEMENT R. WILLIAMS, OF ROCK SPRINGS, WYOMING, HEREBY STATE: THIS MAP WAS MADE FROM NOTES TAKEN DURING AN ACTUAL FIELD SURVEY DONE UNDER MY DIRECT SUPERVISION ON JUNE 22, 2011 AND THAT THIS PLAT CORRECTLY SHOWS THE LOCATION OF LOVELAND 12-9-67 1H AS STAKED ON THE GROUND.

LEGEND

- ◆ WELL LOCATION
- BOTTOM HOLE LOC. (APPROX)
- FOUND MONUMENT
- ▲ PREVIOUSLY FOUND MONUMENT

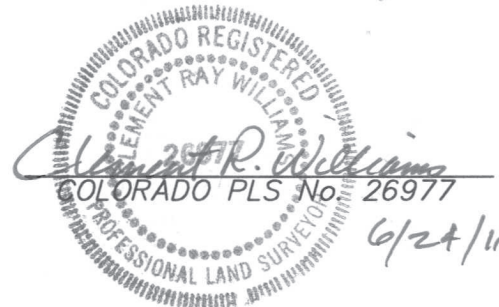

(307) 362-5028

DRIFFIN & ASSOCIATES, INC.
1414 ELK ST., ROCK SPRINGS, WY 82901

DRAWN: 6/24/11 - MMM

SCALE: 1" = 1000'

REVISED: NA

DRG JOB No. 18651

EXHIBIT 1

**PLAT OF DRILLING LOCATION
FOR
CHESAPEAKE ENERGY, LLC.**

**270' F/SL & 1980' F/WL, SESW, SECTION 12,
T. 6 N., R. 67 W., 6th P.M.
WELD COUNTY, COLORADO**