

Steil Surveying Services, LLC

1102 West 19th Street P.O. BOX 2073

Cheyenne, Wyoming 82001

LOCATION DRAWING

SECTION 6  
TOWNSHIP 4 NORTH  
RANGE 65 WEST

DATE: 02/24/2011

THIS MAP DOES NOT REPRESENT A BOUNDARY SURVEY

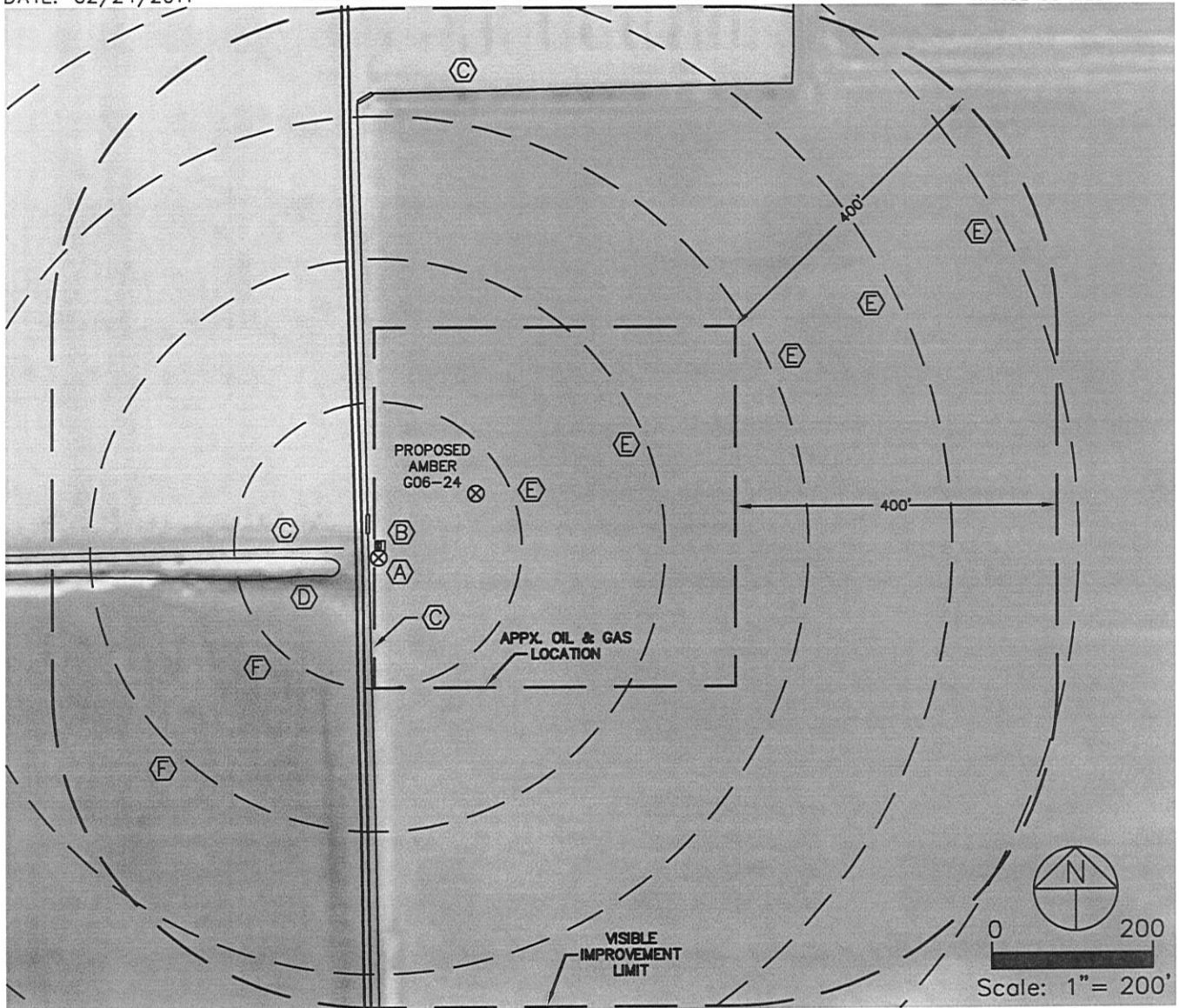

IMPROVEMENTS:

- (A) IRRIGATION WELL - 145' SOUTHWEST
  - (B) PIVOT ON CONCRETE PAD - 138' SOUTHWEST
  - (C) CONCRETE DITCHES - 136' WEST, 178' SOUTHWEST & 503' NORTH
  - (D) DIRT CANAL - 191' SOUTHWEST
  - (E) IRRIGATION WHEEL TRACKS - 41', 220', 398', 577' AND 734' NORTHEAST
  - (F) IRRIGATION WHEEL TRACKS - 317' AND 496' SOUTHWEST
- THE NEAREST OVERHEAD POWER LINE IS 890' WEST.

NEW WELL DATA

ELEV = 4691', PDOP: 2.1  
NW $\frac{1}{4}$ SE $\frac{1}{4}$  SEC 6  
1370' FSL, 2490' FEL  
LAT: N 40.33813  
LONG: W 104.70550  
NEAREST PROP LINE: 157' WEST  
NEAREST ACTIVE RAILROAD: 1640' +/-  
NORTHWEST  
NEAREST BUILDING: 1150' +/- NORTH  
PAVED COUNTY ROAD NO. 48 1/2:  
1550' +/- NORTHEAST

NOTE: The orientation of the oil & gas location as shown was determined by Noble Energy.

NOTICE: According to Colorado law you MUST commence any legal action based upon any defect in this W.L.C. within three years after you first discover such defect. In no event may any action based upon any defect in this W.L.C. be commenced more than ten years from this sold date of the certification shown hereon.