

EOG RESOURCES, INC.
RANDALL CREEK #13-27H
SECTION 27, T12N, R62W, 6th P.M.

PROCEED IN A NORTHWESTERLY, THEN NORTHERLY DIRECTION FROM HEREFORD, COLORADO ON COUNTY ROAD 390 APPROXIMATELY 1.3 MILES TO THE JUNCTION OF THIS ROAD AND AN COUNTY ROAD 138 TO THE EAST; TURN RIGHT AND PROCEED IN A EASTERLY DIRECTION APPROXIMATELY 0.6 MILES TO THE BEGINNING OF THE PROPOSED ACCESS TO THE SOUTH; FOLLOW ROAD FLAGS IN A SOUTHERLY DIRECTION APPROXIMATELY 235' TO THE PROPOSED LOCATION.

TOTAL DISTANCE FROM HEREFORD, COLORADO TO THE PROPOSED LOCATION IS APPROXIMATELY 1.9 MILES.

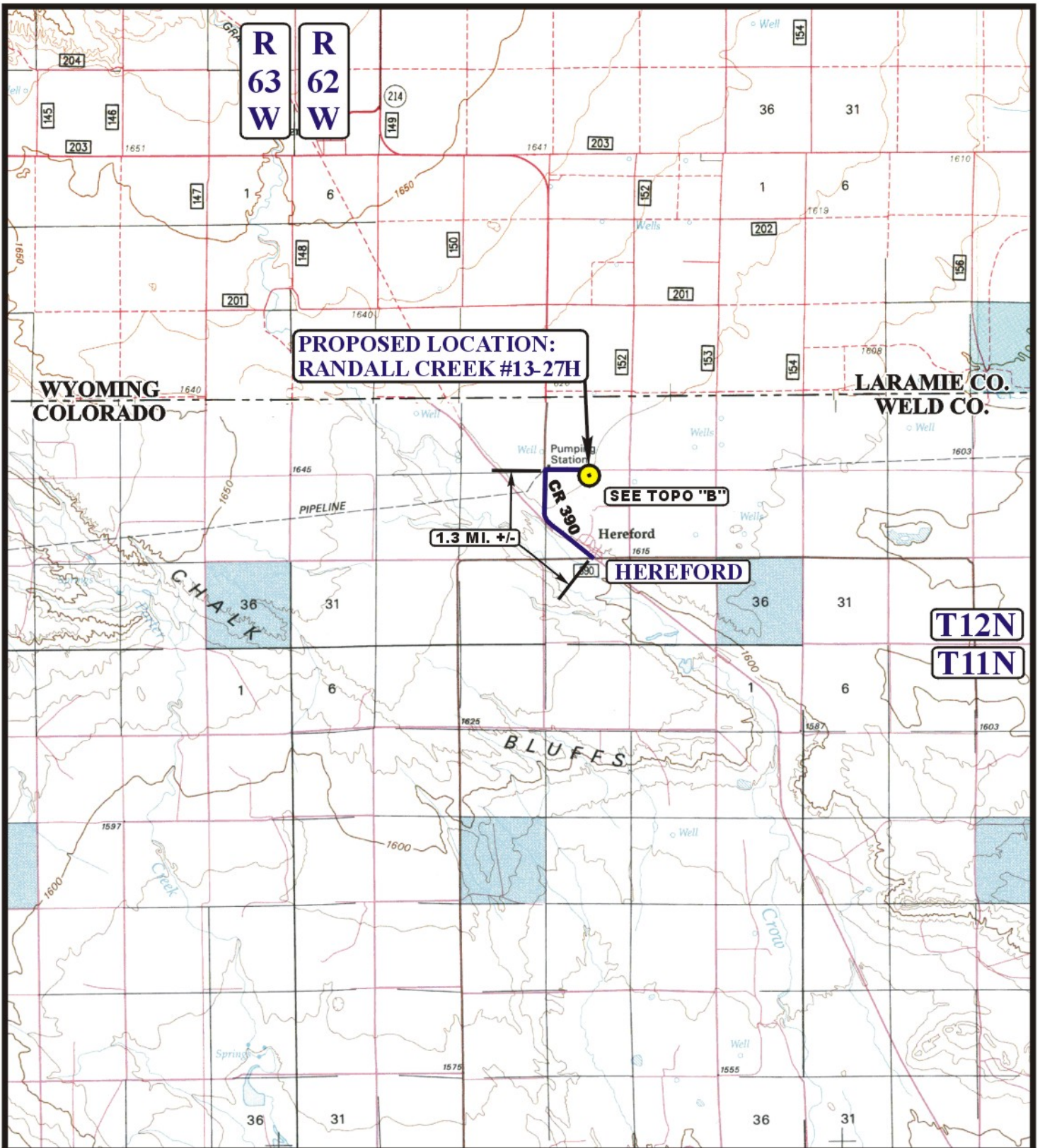

**PROPOSED LOCATION:
RANDALL CREEK #13-27H**

**WYOMING
COLORADO**

**LARAMIE CO.
WELD CO.**

SEE TOPO "B"

HEREFORD

T12N

T11N

LEGEND:

 **PROPOSED LOCATION**

EOG RESOURCES, INC.

**RANDALL CREEK #13-27H
SECTION 27, T12N, R62W, 6th P.M.
364' FNL 2465' FEL**

U&L S Uintah Engineering & Land Surveying
85 South 200 East Vernal, Utah 84078
(435) 789-1017 * FAX (435) 789-1813



**ACCESS ROAD
MAP**



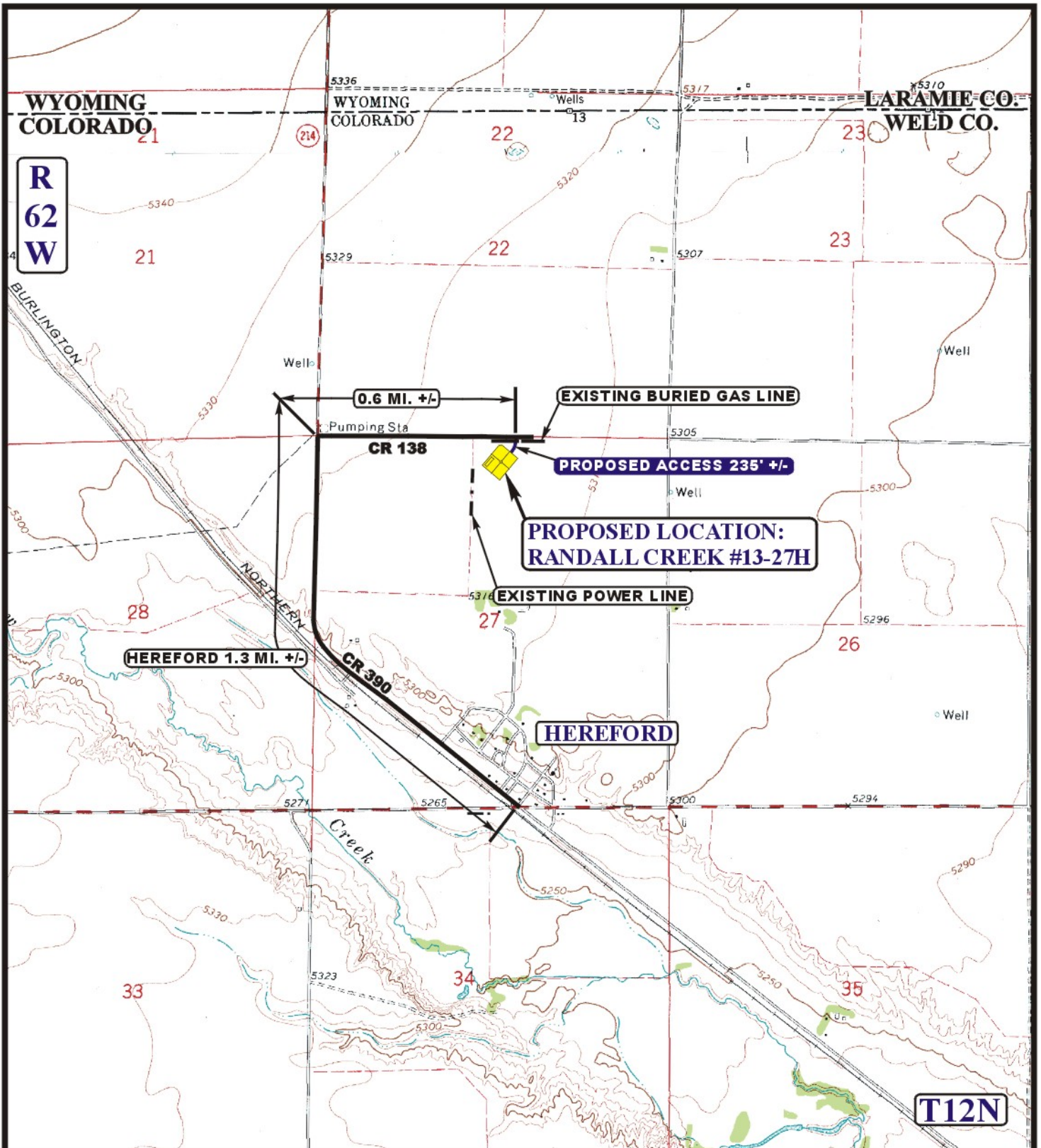

05	03	11
MONTH	DAY	YEAR

SCALE: 1:100,000 DRAWN BY: C.A.G. REVISED: 00-00-00





LEGEND:

-  EXISTING ROAD
-  PROPOSED ACCESS ROAD
-  EXISTING BURIED GAS LINE
-  EXISTING POWER LINE

EOG RESOURCES, INC.

RANDALL CREEK #13-27H
SECTION 27, T12N, R62W, 6th P.M.
364' FNL 2465' FEL



Utah Engineering & Land Surveying
 85 South 200 East Vernal, Utah 84078
 (435) 789-1017 * FAX (435) 789-1813



ACCESS ROAD MAP	05	03	11
	<small>MONTH</small>	<small>DAY</small>	<small>YEAR</small>
SCALE: 1" = 2000'		DRAWN BY: C.A.G. REVISED: 00-00-00	

B
TOPO