

UINTAH ENGINEERING & LAND SURVEYING  
85 So. 200 East \* Vernal, Utah 84078 \* (435) 789-1017

1" = 20'  
 X-Section  
 Scale  
 1" = 50'  
 DATE: 02-15-11  
 DRAWN BY: M.D.

# FOUNDATION ENERGY MANAGEMENT

## TYPICAL CROSS SECTIONS FOR

BANTA RIDGE FEDERAL #4A-18-1-103,

#5-18-1-103, & #6-18-1-103

SECTION 18, T1S, R103W, 6th P.M.

LOT 4

FIGURE #2

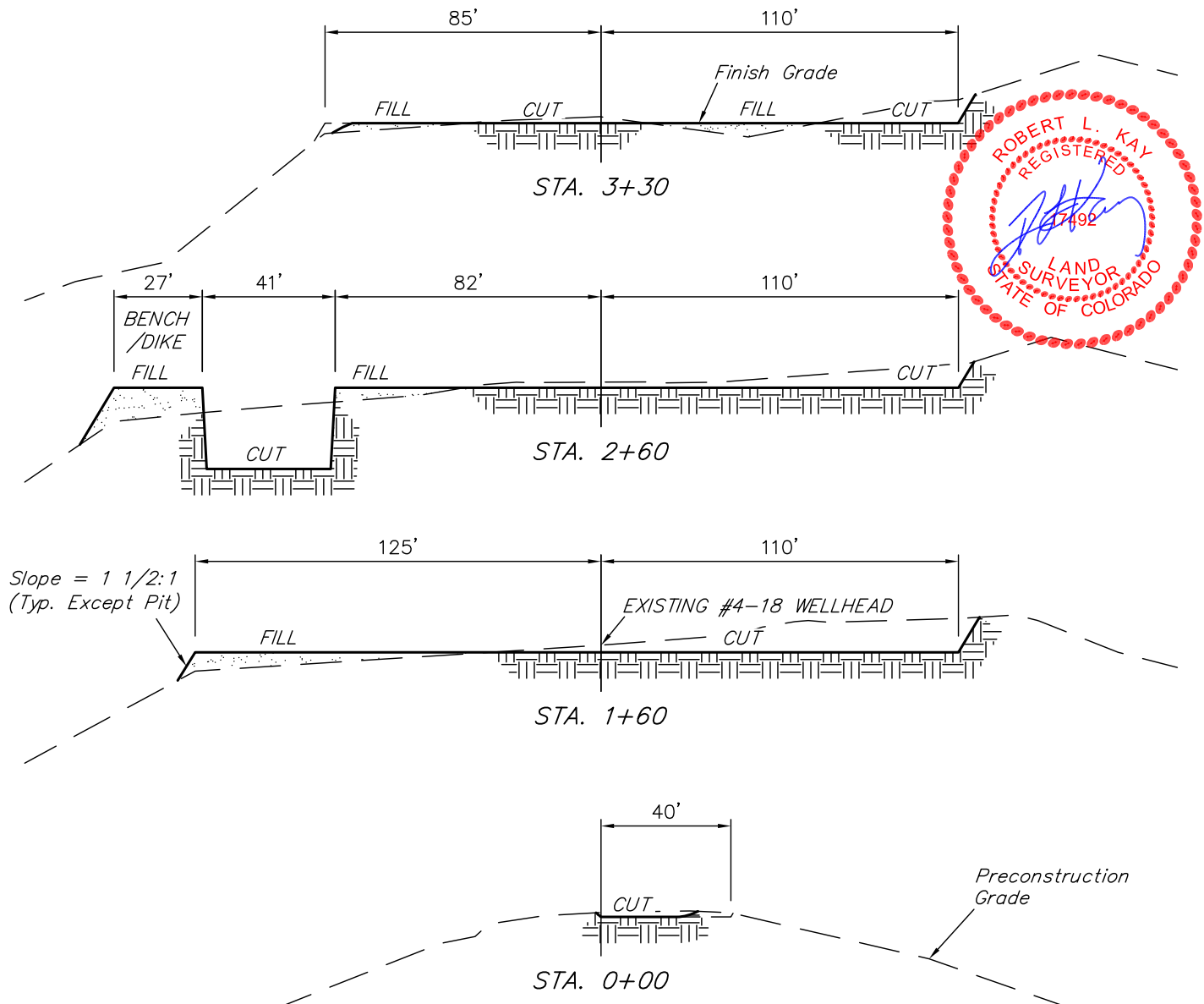

APPROXIMATE ACREAGES  
 WELL SITE DISTURBANCE = ± 2.117 ACRES

\* NOTE:  
 FILL QUANTITY INCLUDES  
 5% FOR COMPACTION

### APPROXIMATE YARDAGES

Topsoil Stripping = 0 Cu. Yds.  
 Remaining Location = 2,250 Cu. Yds.  
 TOTAL CUT = 2,250 CU.YDS.  
 FILL = 1,780 CU.YDS.

EXCESS MATERIAL = 470 Cu. Yds.  
 Topsoil & Pit Backfill = 470 Cu. Yds.  
 (1/2 Pit Vol.)  
 EXCESS UNBALANCE = 0 Cu. Yds.  
 (After Interim Rehabilitation)

UINTAH ENGINEERING & LAND SURVEYING  
 85 So. 200 East \* Vernal, Utah 84078 \* (435) 789-1017

# FOUNDATION ENERGY MANAGEMENT

## TYPICAL RIG LAYOUT FOR

BANTA RIDGE FEDERAL #4A-18-1-103,  
#5-18-1-103, & #6-18-1-103  
SECTION 18, T1S, R103W, 6th P.M.  
LOT 4

FIGURE #3

SCALE: 1" = 50'  
DATE: 02-15-11  
DRAWN BY: M.D.

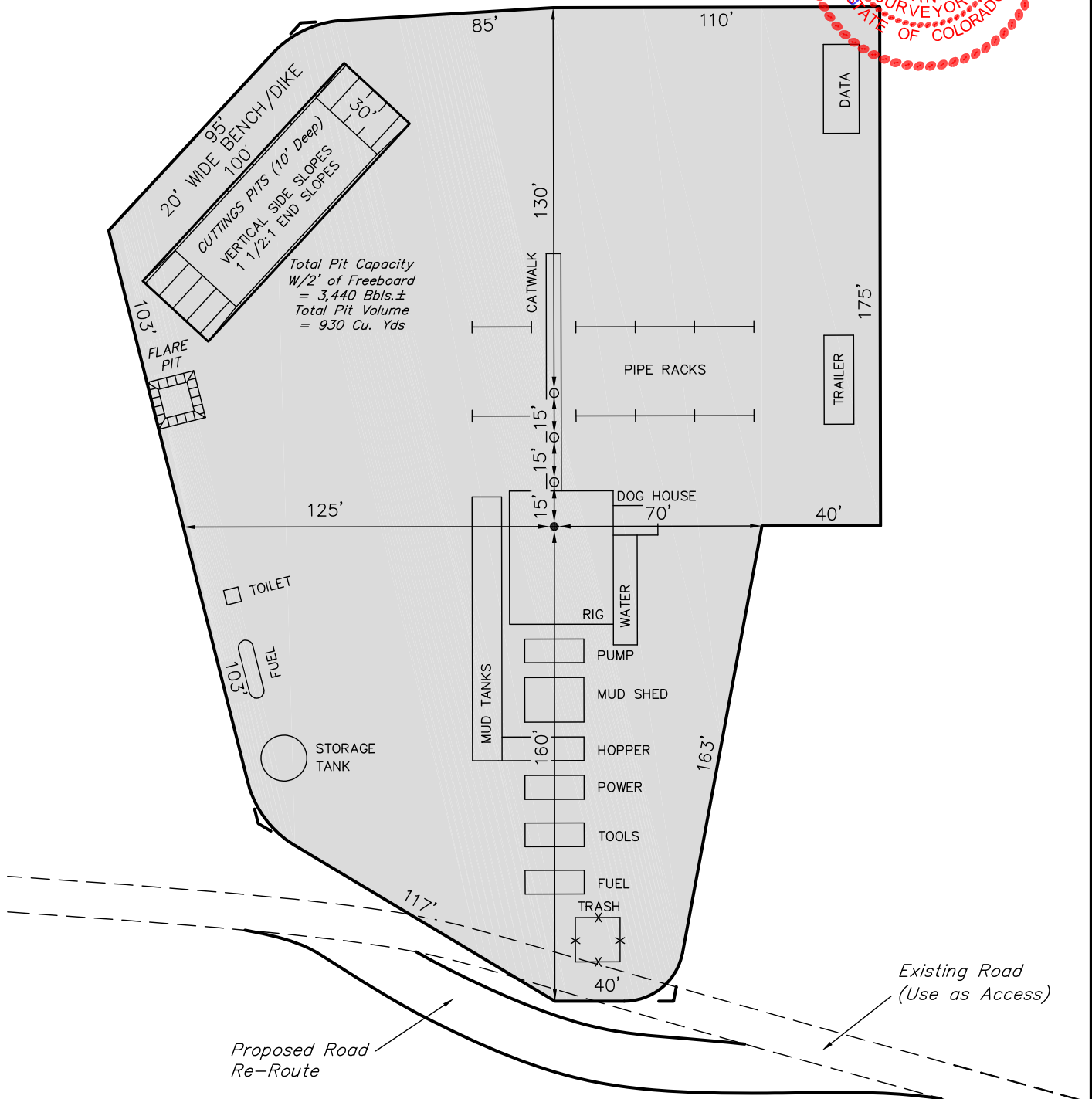
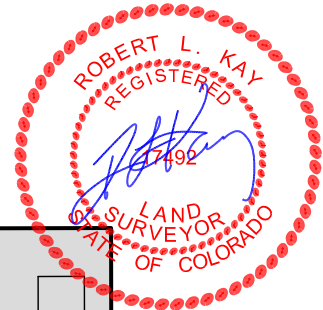

# FOUNDATION ENERGY MANAGEMENT

## LOCATION DRAWING FOR

BANTA RIDGE FEDERAL #4A-18-1-103,  
#5-18-1-103, & #6-18-1-103  
SECTION 18, T1S, R103W, 6th P.M.  
LOT 4

FIGURE #4

SCALE: 1" = 500'

DATE: 02-15-11

DRAWN BY: M.D.

NW Cor. Sec. 18  
1936 Brass Cap,  
1.0' High, Pile of Stones,  
Lat: 39.968467°  
Long: 109.007658°

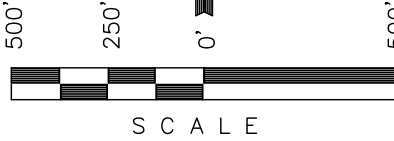

SCALE

1936 Brass Cap,  
2.0' High, Pile of Stones  
Lat: 39.961227°  
Long: 109.007683°

N04°W 13.1 Mi.  
(To Railroad)  
N02°W 5.5 Mi.  
(To Building and Powerline)

B.L.M.

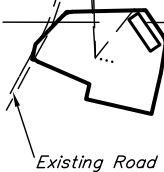

Existing Road

B.L.M.

500°09'44"W  
2638.43' (Meas.)  
Section Line

1/16 Section Line

1/4 Section Line

18

1/4 Section Line

1/16 Section Line

589°56'03"E - 2471.01' (Meas.)

1936 Brass Cap,  
2.0' High, Pile of Stones  
Lat: 39.953952°  
Long: 109.007675°

1936 Brass Cap,  
0.5' High, Pile of Stones  
Lat: 39.953947°  
Long: 108.998864°

Section Line

589°58'02"E  
2649.57' (Meas.)

W.C.  
1936 Brass Cap,  
1.0' High,  
Lat: 39.954058°  
Long: 108.989414°  
40.92'  
(G.L.O.)

True  
Position



### PLANT COMMUNITY

- ☐ DISTURBED GRASSLAND
- ☐ NATIVE GRASSLAND
- ☐ SHRUB LAND
- ☐ PLAINS RIPARIAN
- ☐ MOUNTAIN RIPARIAN
- ☐ FOREST LAND
- ☐ WETLANDS AQUATIC
- ☐ ALPINE
- ☐ OTHER (Describe): \_\_\_\_\_

### CURRENT LAND USE

- |                |                                     |                                     |   |   |                              |
|----------------|-------------------------------------|-------------------------------------|---|---|------------------------------|
| CROP LAND:     | <input type="checkbox"/> IRRIGATED  | <input type="checkbox"/> DRY LAND   | <input type="checkbox"/> IMPROVED PASTURE | <input type="checkbox"/> HAY MEADOW             | <input type="checkbox"/> CRP |
| NON-CROP LAND: | <input type="checkbox"/> RANGELAND  | <input type="checkbox"/> TIMBER     | <input type="checkbox"/> RECREATIONAL     | <input type="checkbox"/> OTHER (Describe) _____ |                              |
| SUBDIVIDED:    | <input type="checkbox"/> INDUSTRIAL | <input type="checkbox"/> COMMERCIAL | <input type="checkbox"/> RESIDENTIAL      | _____   |                              |

### FUTURE LAND USE

- |                |                                     |                                     |   |   |                              |
|----------------|-------------------------------------|-------------------------------------|---|---|------------------------------|
| CROP LAND:     | <input type="checkbox"/> IRRIGATED  | <input type="checkbox"/> DRY LAND   | <input type="checkbox"/> IMPROVED PASTURE | <input type="checkbox"/> HAY MEADOW             | <input type="checkbox"/> CRP |
| NON-CROP LAND: | <input type="checkbox"/> RANGELAND  | <input type="checkbox"/> TIMBER     | <input type="checkbox"/> RECREATIONAL     | <input type="checkbox"/> OTHER (Describe) _____ |                              |
| SUBDIVIDED:    | <input type="checkbox"/> INDUSTRIAL | <input type="checkbox"/> COMMERCIAL | <input type="checkbox"/> RESIDENTIAL      | _____   |                              |

UINTAH ENGINEERING & LAND SURVEYING

85 So. 200 East \* Vernal, Utah 84078 \* (435) 789-1017