

WWG:	G:\GEOSURV\WeldzNorth\Carrizo	110004\Wellplats\Pergamos	3-44-7-60\Pergamos	3-44-7-60	F2A.dwg	USER:	MTC	DATE:	Apr 14, 2011	8:23am
------	-------------------------------	---------------------------	--------------------	-----------	---------	-------	-----	-------	--------------	--------

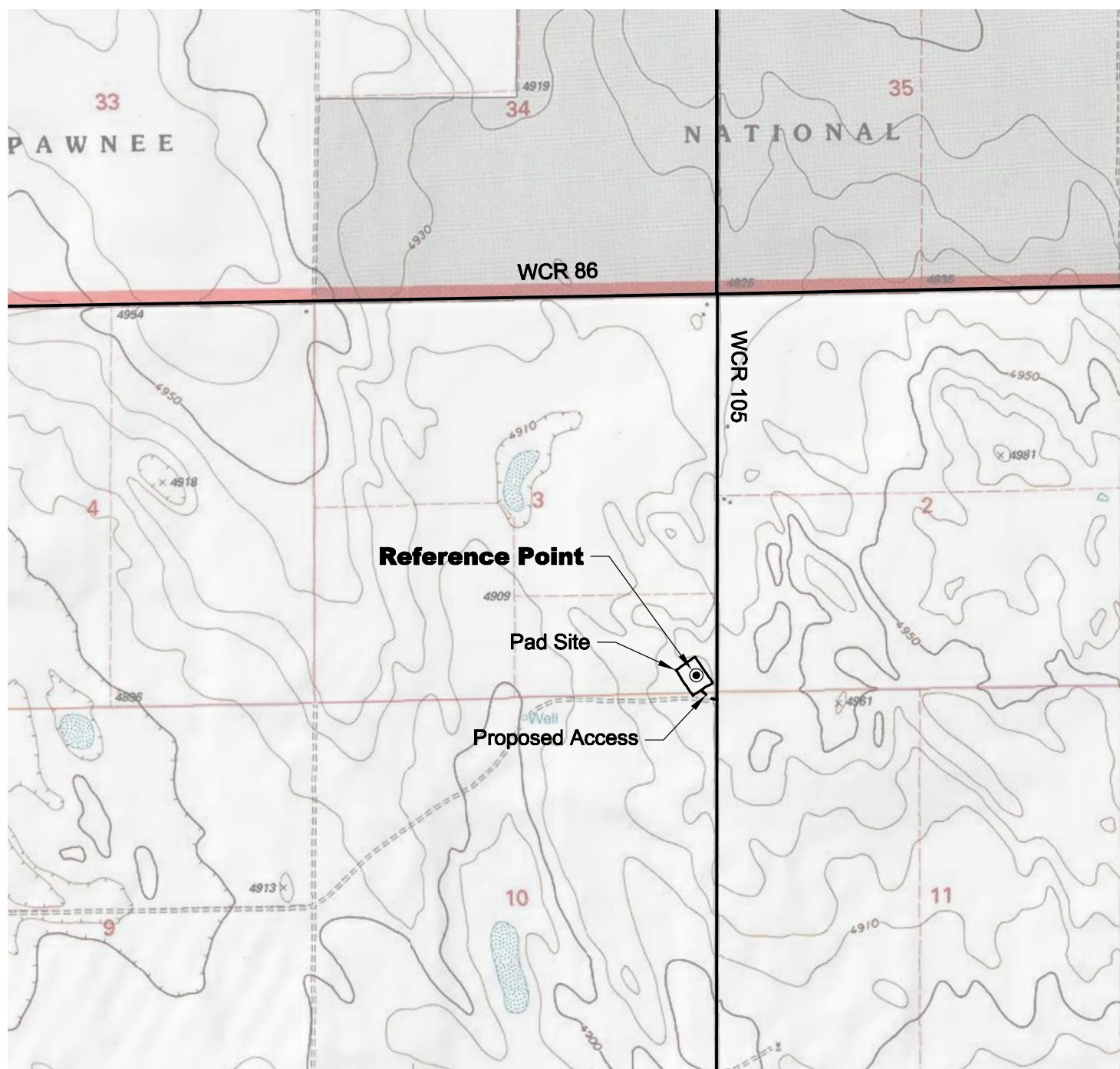

MP 0.0 - Intersection of Highway 14 a.k.a. WCR 90 & Highway 392 a.k.a. WCR 77 in Briggsdale; East on Highway 14
MP 13.9 - Right on WCR 105
MP 16.9 - Right on access onto Pergamos 3-44-7-60 Pad

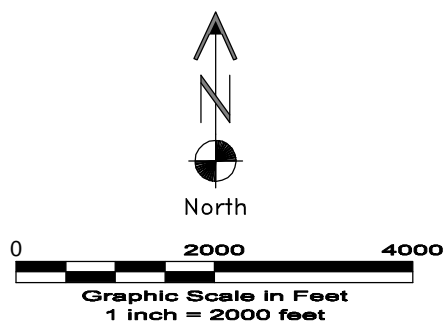

CARRIZO OIL & GAS, INC
PERGAMOS 3-44-7-60 PAD

SE1/4 SE1/4 SECTION 3 T7N R60W
6th PM WELD COUNTY COLORADO

4/14/11