

REFERENCE INFORMATION										
Co-ordinate (NE) Reference: Well Norris 23-32, True North										
Vertical (TVD) Reference: WELL @ 4844.0ft (Original Well Elev)										
Section (VS) Reference: Slot - (0.0N, 0.0E)										
Measured Depth Reference: WELL @ 4844.0ft (Original Well Elev)										
Calculation Method:										
WELL DETAILS: Norris 23-32										
+N/-S	+E/-W	Northing		Ground Level: 4831.0		Longitude		Slot		
0.0	0.0	1308940.16		Easting 3257028.48		Latitude 40° 10' 39.997 N		04° 34' 48.468 W		
SECTION DETAILS										
Sec	MD	Inc	Azi	TVD	+N/-S	+E/-W	DLeg	TFace	VSec	Target
1	0.0	0.00	0.00	0.0	0.0	0.0	0.00	0.00	0.0	
2	800.0	0.00	0.00	800.0	0.0	0.0	0.00	0.00	0.0	
3	1461.7	13.23	42.73	1455.9	55.9	51.6	2.00	42.73	76.1	
4	6067.3	13.23	42.73	5939.1	830.4	767.1	0.00	0.00	1130.5	
5	6729.1	0.00	0.00	6595.0	886.3	818.7	2.00	180.00	1206.6	
6	7779.1	0.00	0.00	7645.0	886.3	818.7	0.00	0.00	1206.6	Norris 23-32

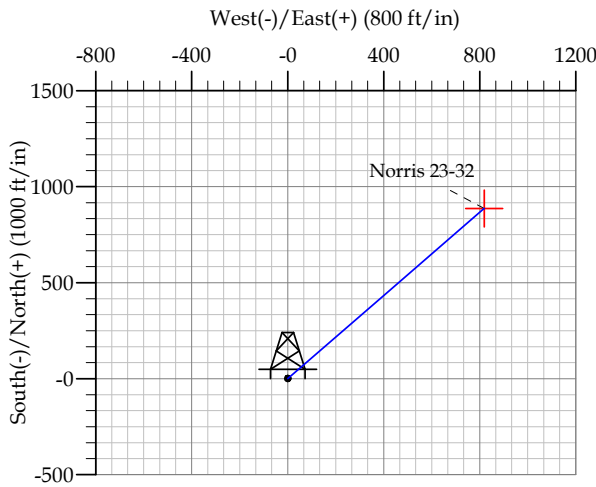

FORMATION TOP DETAILS			
TVDPath	MDPath	Formation	
5264.0	5373.8	Sussex	
6839.0	6973.1	Niobrara	
7069.0	7203.1	Codell	
7495.0	7629.1	J Sand	
7584.0	7718.1	A Marker	
CASING DETAILS			
TVD	MD	Name	Size
750.0	750.0	Surface	8.625
7645.0	7779.1	Production	4.500

# EnCana Corporation

## Planning Report - Geographic

<b>Database:</b>	EDM	<b>Local Co-ordinate Reference:</b>	Well Norris 23-32
<b>Company:</b>	DJ/Paradox/WTX	<b>TVD Reference:</b>	WELL @ 4844.0ft (Original Well Elev)
<b>Project:</b>	Wattenberg	<b>MD Reference:</b>	WELL @ 4844.0ft (Original Well Elev)
<b>Site:</b>	New Drills	<b>North Reference:</b>	True
<b>Well:</b>	Norris 23-32	<b>Survey Calculation Method:</b>	Minimum Curvature
<b>Wellbore:</b>	Wellbore #1		
<b>Design:</b>	Norris 23-32		

<b>Project</b>	Wattenberg,		
<b>Map System:</b>	US State Plane 1983	<b>System Datum:</b>	Mean Sea Level
<b>Geo Datum:</b>	North American Datum 1983		
<b>Map Zone:</b>	Colorado Northern Zone		

Site		New Drills				
Site Position:		Northing:	1,278,589.08ft	Latitude:	40° 5' 49.848 N	
From:	Lat/Long	Easting:	3,130,247.44ft	Longitude:	105° 2' 3.912 W	
Position Uncertainty:		ft	Slot Radius:	in	Grid Convergence:	0.30 °

Well	Norris 23-32					
Well Position	+N-S	29,034.4 ft	Northing:	1,308,940.16 ft	Latitude:	40° 10' 39.997 N
	+E-W	127,089.3 ft	Easting:	3,257,028.48 ft	Longitude:	104° 34' 48.468 W
Position Uncertainty		ft	Wellhead Elevation:	ft	Ground Level:	4,831.0 ft

<b>Wellbore</b>	Wellbore #1				
<b>Magnetics</b>	<b>Model Name</b>	<b>Sample Date</b>	<b>Declination (°)</b>	<b>Dip Angle (°)</b>	<b>Field Strength (nT)</b>
	IGRF200510	12/31/2009	8.90	66.96	53,207

<b>Design</b>	Norris 23-32				
<b>Audit Notes:</b>					
<b>Version:</b>	<b>Phase:</b>	PROTOTYPE		<b>Tie On Depth:</b>	0.0
<b>Vertical Section:</b>	<b>Depth From (TVD) (ft)</b>	<b>+N/-S (ft)</b>	<b>+E/-W (ft)</b>	<b>Direction (°)</b>	
	0.0	0.0	0.0	42.73	

<b>Plan Sections</b>										
Measured Depth (ft)	Inclination (°)	Azimuth (°)	Vertical Depth (ft)	+N/-S (ft)	+E/-W (ft)	Dogleg Rate (°/100ft)	Build Rate (°/100ft)	Turn Rate (°/100ft)	TFO (°)	Target
0.0	0.00	0.00	0.0	0.0	0.0	0.00	0.00	0.00	0.00	
800.0	0.00	0.00	800.0	0.0	0.0	0.00	0.00	0.00	0.00	
1,461.7	13.23	42.73	1,455.9	55.9	51.6	2.00	2.00	0.00	42.73	
6,067.3	13.23	42.73	5,939.1	830.4	767.1	0.00	0.00	0.00	0.00	
6,729.1	0.00	0.00	6,595.0	886.3	818.7	2.00	-2.00	0.00	180.00	
7,779.1	0.00	0.00	7,645.0	886.3	818.7	0.00	0.00	0.00	0.00	Norris 23-32

# EnCana Corporation

## Planning Report - Geographic

<b>Database:</b>	EDM	<b>Local Co-ordinate Reference:</b>	Well Norris 23-32
<b>Company:</b>	DJ/Paradox/WTX	<b>TVD Reference:</b>	WELL @ 4844.0ft (Original Well Elev)
<b>Project:</b>	Wattenberg	<b>MD Reference:</b>	WELL @ 4844.0ft (Original Well Elev)
<b>Site:</b>	New Drills	<b>North Reference:</b>	True
<b>Well:</b>	Norris 23-32	<b>Survey Calculation Method:</b>	Minimum Curvature
<b>Wellbore:</b>	Wellbore #1		
<b>Design:</b>	Norris 23-32		

Planned Survey										
Measured Depth (ft)	Inclination (°)	Azimuth (°)	Vertical Depth (ft)	+N/-S (ft)	+E/-W (ft)	Map Northing (ft)	Map Easting (ft)	Latitude	Longitude	
0.0	0.00	0.00	0.0	0.0	0.0	1,308,940.16	3,257,028.48	40° 10' 39.997 N	104° 34' 48.468 W	
750.0	0.00	0.00	750.0	0.0	0.0	1,308,940.16	3,257,028.48	40° 10' 39.997 N	104° 34' 48.468 W	
Surface										
800.0	0.00	0.00	800.0	0.0	0.0	1,308,940.16	3,257,028.48	40° 10' 39.997 N	104° 34' 48.468 W	
1,461.7	13.23	42.73	1,455.9	55.9	51.6	1,308,996.58	3,257,079.53	40° 10' 40.549 N	104° 34' 47.803 W	
5,373.8	13.23	42.73	5,264.0	713.8	659.3	1,309,660.75	3,257,680.36	40° 10' 47.051 N	104° 34' 39.973 W	
Sussex										
6,067.3	13.23	42.73	5,939.1	830.4	767.1	1,309,778.50	3,257,786.88	40° 10' 48.204 N	104° 34' 38.585 W	
6,729.1	0.00	0.00	6,595.0	886.3	818.7	1,309,834.92	3,257,837.93	40° 10' 48.756 N	104° 34' 37.920 W	
6,973.1	0.00	0.00	6,839.0	886.3	818.7	1,309,834.92	3,257,837.93	40° 10' 48.756 N	104° 34' 37.920 W	
Niobrara										
7,203.1	0.00	0.00	7,069.0	886.3	818.7	1,309,834.92	3,257,837.93	40° 10' 48.756 N	104° 34' 37.920 W	
Codell										
7,629.1	0.00	0.00	7,495.0	886.3	818.7	1,309,834.92	3,257,837.93	40° 10' 48.756 N	104° 34' 37.920 W	
J Sand										
7,718.1	0.00	0.00	7,584.0	886.3	818.7	1,309,834.92	3,257,837.93	40° 10' 48.756 N	104° 34' 37.920 W	
A Marker										
7,779.1	0.00	0.00	7,645.0	886.3	818.7	1,309,834.92	3,257,837.93	40° 10' 48.756 N	104° 34' 37.920 W	
Production - Norris 23-32										

Design Targets										
Target Name	Dip Angle (°)	Dip Dir. (°)	TVD (ft)	+N/-S (ft)	+E/-W (ft)	Northing (ft)	Easting (ft)	Latitude	Longitude	
Norris 23-32	0.00	0.00	7,645.0	886.3	818.7	1,309,834.92	3,257,837.93	40° 10' 48.756 N	104° 34' 37.920 W	
- hit/miss target										
- Shape										
- plan hits target										
- Point										

Casing Points					
Measured Depth (ft)	Vertical Depth (ft)	Name	Casing Diameter (in)	Hole Diameter (in)	
750.0	750.0	Surface	8.625	12.250	
7,779.1	7,645.0	Production	4.500	7.785	

Formations						
Measured Depth (ft)	Vertical Depth (ft)	Name	Lithology	Dip (°)	Dip Direction (°)	
5,373.8	5,264.0	Sussex		0.00		
6,973.1	6,839.0	Niobrara		0.00		
7,203.1	7,069.0	Codell		0.00		
7,629.1	7,495.0	J Sand		0.00		
7,718.1	7,584.0	A Marker		0.00		