



# KERR MCGEE OIL & GAS ONSHORE LP

Location: COLORADO Slot: SLOT#17 PINNACLE 10-2 (386'FSL & 1998'FEL)  
 Field: WELD COUNTY (KERR MCGEE) Well: PINNACLE 10-2  
 Facility: SEC.02-T1N-R68W Wellbore: PINNACLE 10-2 PWB



INTEQ

Plot reference wellpath is PINNACLE 10-2 (REV-A.0) PWP	
True vertical depths are referenced to XTREME 12 (RKB)	Grid System: NAD83 / Lambert Colorado State Planes, Northern Zone (501), US feet
Measured depths are referenced to XTREME 12 (RKB)	North Reference: True north
XTREME 12 (RKB) to Mean Sea Level: 5020 feet	Scale: True distance
Mean Sea Level to Mud line (Facility: SEC.02-T1N-R68W): 0 feet	Depths are in feet
Coordinates are in feet referenced to Slot	Created by: cookdam on 6/8/2011

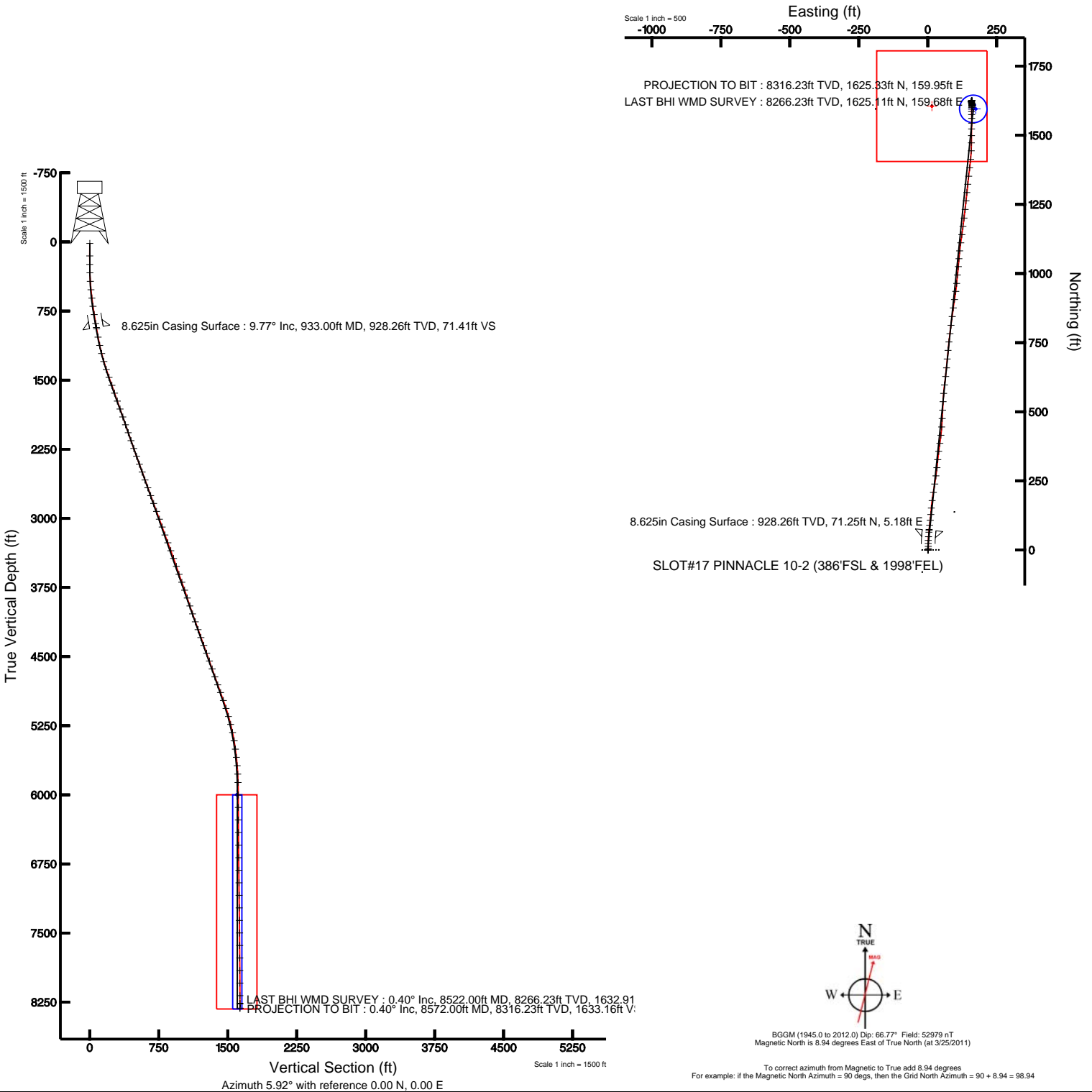



# Actual Wellpath Report

PINNACLE 10-2 awb

Page 1 of 5



INTEQ

## REFERENCE WELLPATH IDENTIFICATION

Operator	<b>KERR MCGEE OIL &amp; GAS ONSHORE LP</b>	Slot	<b>SLOT#17 PINNACLE 10-2 (386'FSL &amp; 1998'FEL)</b>
Area	<b>COLORADO</b>	Well	<b>PINNACLE 10-2</b>
Field	<b>WELD COUNTY (KERR MCGEE)</b>	Wellbore	<b>PINNACLE 10-2 awb</b>
Facility	<b>SEC.02-T1N-R68W</b>		

## REPORT SETUP INFORMATION

Projection System	<b>NAD83 / Lambert Colorado State Planes, Northern Zone (501), US feet</b>	Software System	<b>WellArchitect® 2.0</b>
North Reference	<b>True</b>	User	<b>Cookdanm</b>
Scale	<b>0.999962</b>	Report Generated	<b>6/8/2011 at 1:07:27 PM</b>
Convergence at slot	<b>0.34° East</b>	Database/Source file	<b>WA_DENVER/PINNACLE_10-2_awb.xml</b>

## WELLPATH LOCATION

	Local coordinates		Grid coordinates		Geographic coordinates	
	North[ft]	East[ft]	Easting[USft]	Northing[USft]	Latitude	Longitude
Slot Location	-871.70	1624.87	3148802.61	1270310.18	<b>40°04'27.001"N</b>	<b>104°58'05.779"W</b>
Facility Reference Pt			3147172.67	1271172.18	<b>40°04'35.616"N</b>	<b>104°58'26.681"W</b>
Field Reference Pt			<b>3197771.84</b>	<b>1268891.29</b>	40°04'09.600"N	104°47'36.000"W

## WELLPATH DATUM

Calculation method	<b>Minimum curvature</b>	XTREME 12 (RKB) to Facility Vertical Datum	<b>5020.00ft</b>
Horizontal Reference Pt	<b>Slot</b>	XTREME 12 (RKB) to Mean Sea Level	<b>5020.00ft</b>
Vertical Reference Pt	<b>XTREME 12 (RKB)</b>	Facility Vertical Datum to Mud Line (Facility)	<b>0.00ft</b>
MD Reference Pt	<b>XTREME 12 (RKB)</b>	Section Origin	<b>N 0.00, E 0.00 ft</b>
Field Vertical Reference	<b>Mean Sea Level</b>	Section Azimuth	<b>5.92°</b>



# Actual Wellpath Report

PINNACLE 10-2 awp

Page 2 of 5



INTEQ

REFERENCE WELLPATH IDENTIFICATION			
Operator	KERR MCGEE OIL & GAS ONSHORE LP	Slot	SLOT#17 PINNACLE 10-2 (386'FSL & 1998'FEL)
Area	COLORADO	Well	PINNACLE 10-2
Field	WELD COUNTY (KERR MCGEE)	Wellbore	PINNACLE 10-2 awb
Facility	SEC.02-T1N-R68W		

WELLPATH DATA (88 stations) † = interpolated/extrapolated station								
MD [ft]	Inclination [°]	Azimuth [°]	TVD [ft]	Vert Sect [ft]	North [ft]	East [ft]	DLS [°/100ft]	Comments
0.00†	0.000	138.400	0.00	0.00	0.00	0.00	0.00	
15.00	0.000	138.400	15.00	0.00	0.00	0.00	0.00	
151.00	0.900	138.400	150.99	-0.72	-0.80	0.71	0.66	
243.00	0.500	54.300	242.99	-0.94	-1.10	1.51	1.07	
335.00	2.100	12.800	334.96	1.00	0.77	2.21	1.91	
427.00	3.600	358.100	426.85	5.53	5.30	2.49	1.80	
519.00	5.600	358.400	518.55	12.85	12.68	2.27	2.17	
610.00	6.900	358.800	609.00	22.67	22.58	2.03	1.43	
700.00	8.000	2.600	698.24	34.29	34.24	2.20	1.34	
791.00	9.200	4.800	788.22	47.88	47.82	3.10	1.37	
890.00	9.700	5.100	885.88	64.14	64.01	4.50	0.51	
948.00	9.800	5.800	943.04	73.96	73.79	5.44	0.27	
1039.00	10.100	6.500	1032.67	89.68	89.42	7.12	0.36	
1130.00	12.400	7.200	1121.91	107.43	107.05	9.25	2.53	
1221.00	14.100	5.100	1210.49	128.28	127.78	11.46	1.94	
1311.00	16.400	4.100	1297.31	151.95	151.38	13.34	2.57	
1402.00	18.500	7.600	1384.12	179.22	178.51	16.17	2.58	
1493.00	19.900	9.700	1470.06	209.11	208.08	20.69	1.72	
1584.00	19.300	8.600	1555.79	239.58	238.22	25.55	0.77	
1674.00	19.300	8.300	1640.73	269.30	267.64	29.92	0.11	
1765.00	18.900	5.800	1726.72	299.07	297.19	33.58	1.00	
1856.00	18.900	5.500	1812.82	328.54	326.52	36.48	0.11	
1947.00	19.600	7.600	1898.73	358.54	356.32	39.91	1.08	
2037.00	18.700	9.000	1983.75	388.03	385.53	44.17	1.12	
2128.00	19.300	5.800	2069.79	417.64	414.91	47.97	1.32	
2219.00	19.300	5.100	2155.68	447.72	444.85	50.83	0.25	
2310.00	19.400	1.900	2241.54	477.83	474.93	52.66	1.17	
2400.00	20.200	3.400	2326.22	508.26	505.38	54.08	1.05	
2491.00	19.600	3.400	2411.79	539.21	536.30	55.92	0.66	
2582.00	19.200	4.100	2497.62	569.41	566.46	57.89	0.51	
2673.00	19.900	7.600	2583.37	599.85	596.74	61.01	1.50	
2763.00	20.200	7.900	2667.92	630.69	627.31	65.17	0.35	
2854.00	20.200	3.400	2753.33	662.09	658.56	68.26	1.71	
2945.00	21.300	5.500	2838.43	694.31	690.70	70.78	1.46	
3036.00	19.300	5.100	2923.77	725.88	722.13	73.70	2.20	
3127.00	19.900	7.900	3009.50	756.40	752.45	77.17	1.22	
3217.00	19.400	5.800	3094.26	786.65	782.49	80.78	0.96	
3308.00	19.800	8.300	3179.99	817.17	812.78	84.54	1.02	
3399.00	20.900	7.600	3265.31	848.79	844.12	88.91	1.24	
3490.00	20.000	6.900	3350.57	880.58	875.66	92.92	1.02	
3580.00	19.600	9.700	3435.25	911.03	905.82	97.32	1.14	
3671.00	18.800	7.900	3521.19	940.91	935.39	101.90	1.09	
3762.00	18.600	4.400	3607.39	970.08	964.39	105.03	1.25	
3853.00	20.200	6.500	3693.22	1000.30	994.47	107.92	1.92	
3944.00	18.900	5.100	3778.97	1030.74	1024.76	111.01	1.52	



# Actual Wellpath Report

PINNACLE 10-2 awp

Page 3 of 5



INTEQ

## REFERENCE WELLPATH IDENTIFICATION

Operator	KERR MCGEE OIL & GAS ONSHORE LP	Slot	SLOT#17 PINNACLE 10-2 (386'FSL & 1998'FEL)
Area	COLORADO	Well	PINNACLE 10-2
Field	WELD COUNTY (KERR MCGEE)	Wellbore	PINNACLE 10-2 awb
Facility	SEC.02-T1N-R68W		

## WELLPATH DATA (88 stations)

MD [ft]	Inclination [°]	Azimuth [°]	TVD [ft]	Vert Sect [ft]	North [ft]	East [ft]	DLS [°/100ft]	Comments
4034.00	18.600	4.400	3864.20	1059.67	1053.59	113.41	0.42	
4125.00	18.200	6.500	3950.54	1088.39	1082.18	116.13	0.85	
4216.00	19.100	8.300	4036.77	1117.47	1111.03	119.89	1.17	
4307.00	19.500	7.200	4122.65	1147.53	1140.83	123.94	0.59	
4397.00	19.200	7.900	4207.57	1177.34	1170.40	127.86	0.42	
4488.00	19.900	6.900	4293.32	1207.78	1200.59	131.78	0.85	
4579.00	20.700	7.900	4378.67	1239.34	1231.90	135.85	0.96	
4670.00	19.600	4.800	4464.10	1270.68	1263.04	139.34	1.68	
4760.00	19.700	5.400	4548.86	1300.94	1293.19	142.03	0.25	
4851.00	18.500	7.200	4634.85	1330.71	1322.78	145.28	1.47	
4942.00	19.300	5.800	4720.94	1360.18	1352.07	148.61	1.01	
5033.00	20.000	7.600	4806.64	1390.78	1382.45	152.19	1.02	
5123.00	20.600	5.800	4891.05	1421.99	1413.46	155.82	0.96	
5214.00	19.100	1.900	4976.65	1452.86	1444.27	157.93	2.20	
5305.00	17.400	0.500	5063.07	1481.26	1472.76	158.55	1.93	
5396.00	16.300	0.500	5150.16	1507.52	1499.14	158.78	1.21	
5486.00	14.700	1.600	5236.88	1531.48	1523.18	159.21	1.81	
5577.00	12.000	1.200	5325.42	1552.42	1544.19	159.73	2.97	
5668.00	9.900	358.800	5414.75	1569.62	1561.47	159.76	2.36	
5759.00	7.700	358.800	5504.68	1583.43	1575.38	159.47	2.42	
5849.00	6.100	359.500	5594.02	1594.17	1586.19	159.30	1.78	
5940.00	4.700	0.200	5684.62	1602.68	1594.76	159.27	1.54	
6031.00	2.800	11.100	5775.42	1608.60	1600.67	159.71	2.22	
6122.00	1.600	11.800	5866.35	1612.08	1604.09	160.40	1.32	
6258.00	0.400	321.200	6002.33	1614.31	1606.32	160.49	1.02	
6394.00	0.300	31.100	6138.33	1614.97	1607.00	160.38	0.30	
6530.00	0.200	26.200	6274.33	1615.51	1607.51	160.67	0.08	
6666.00	0.600	351.400	6410.32	1616.42	1608.43	160.67	0.33	
6803.00	0.800	359.100	6547.31	1618.07	1610.10	160.54	0.16	
6939.00	0.700	2.600	6683.30	1619.84	1611.88	160.57	0.08	
7075.00	0.600	349.600	6819.29	1621.35	1613.41	160.47	0.13	
7211.00	0.400	335.600	6955.29	1622.45	1614.54	160.15	0.17	
7347.00	0.600	340.500	7091.28	1623.50	1615.64	159.72	0.15	
7483.00	0.600	346.100	7227.27	1624.81	1617.00	159.31	0.04	
7619.00	0.800	357.200	7363.26	1626.42	1618.64	159.09	0.18	
7756.00	0.700	346.100	7500.25	1628.15	1620.41	158.84	0.13	
7892.00	0.500	348.900	7636.24	1629.50	1621.80	158.53	0.15	
8028.00	0.400	13.190	7772.24	1630.54	1622.85	158.52	0.16	
8164.00	0.300	22.330	7908.24	1631.35	1623.64	158.77	0.08	
8300.00	0.200	353.100	8044.24	1631.93	1624.20	158.87	0.12	
8436.00	0.400	52.200	8180.23	1632.49	1624.73	159.22	0.25	
8522.00	0.400	49.400	8266.23	1632.91	1625.11	159.68	0.02	LAST BHI WMD SURVEY
8572.00	0.400	49.400	8316.23	1633.16	1625.33	159.95	0.00	PROJECTION TO BIT



# Actual Wellpath Report

PINNACLE 10-2 awp

Page 4 of 5



INTEQ

REFERENCE WELLPATH IDENTIFICATION			
Operator	KERR MCGEE OIL & GAS ONSHORE LP	Slot	SLOT#17 PINNACLE 10-2 (386'FSL & 1998'FEL)
Area	COLORADO	Well	PINNACLE 10-2
Field	WELD COUNTY (KERR MCGEE)	Wellbore	PINNACLE 10-2 awb
Facility	SEC.02-T1N-R68W		

HOLE & CASING SECTIONS Ref Wellbore: PINNACLE 10-2 awb Ref Wellpath: PINNACLE 10-2 awp									
String/Diameter	Start MD [ft]	End MD [ft]	Interval [ft]	Start TVD [ft]	End TVD [ft]	Start N/S [ft]	Start E/W [ft]	End N/S [ft]	End E/W [ft]
12.25in Open Hole	15.00	945.00	930.00	15.00	940.08	0.00	0.00	73.28	5.38
8.625in Casing Surface	15.00	933.00	918.00	15.00	928.26	0.00	0.00	71.25	5.18
7.875in Open Hole	933.00	8572.00	7639.00	928.26	8316.23	71.25	5.18	1625.33	159.95

TARGETS									
Name	MD [ft]	TVD [ft]	North [ft]	East [ft]	Grid East [srv ft]	Grid North [srv ft]	Latitude	Longitude	Shape
PINNACLE 10-2 BHL ON PLAT (1980'FSL & 1817'FEL, REV-1)		6000.00	1595.60	174.34	3148967.38	1271906.72	40°04'42.769"N	104°58'03.536"W	point
PINNACLE 10-2 GEO TARGET 50' RADIUS (1980'FSL & 1826'FEL, REV-2)		6000.00	1595.60	165.34	3148958.37	1271906.67	40°04'42.769"N	104°58'03.652"W	circle
PINNACLE 10-2 LEGAL BOX (190'S,210'N,50'E,350'W OF GEO TARGET)		6000.00	1605.60	15.34	3148808.32	1271915.77	40°04'42.868"N	104°58'05.582"W	square

WELLPATH COMPOSITION Ref Wellbore: PINNACLE 10-2 awb Ref Wellpath: PINNACLE 10-2 awp				
Start MD [ft]	End MD [ft]	Positional Uncertainty Model	Log Name/Comment	Wellbore
15.00	890.00	NaviTrak (Standard)	BHI NAVITRAK 12.25 HOLE <151-890>	PINNACLE 10-2 awb
890.00	8522.00	NaviTrak (Standard)	BHI NAVITRAK 7.875 HOLE <948-8522>	PINNACLE 10-2 awb
8522.00	8572.00	Blind Drilling (std)	Projection to bit	PINNACLE 10-2 awb



# Actual Wellpath Report

PINNACLE 10-2 awp

Page 5 of 5



**INTEQ**

REFERENCE WELLPATH IDENTIFICATION			
Operator	KERR MCGEE OIL & GAS ONSHORE LP	Slot	SLOT#17 PINNACLE 10-2 (386'FSL & 1998'FEL)
Area	COLORADO	Well	PINNACLE 10-2
Field	WELD COUNTY (KERR MCGEE)	Wellbore	PINNACLE 10-2 awb
Facility	SEC.02-T1N-R68W		

WELLPATH COMMENTS				
MD [ft]	Inclination [°]	Azimuth [°]	TVD [ft]	Comment
8522.00	0.400	49.400	8266.23	LAST BHI WMD SURVEY
8572.00	0.400	49.400	8316.23	PROJECTION TO BIT