

CHRISTNER 8-66-5-3H TOPO HYDROLOGY MAP

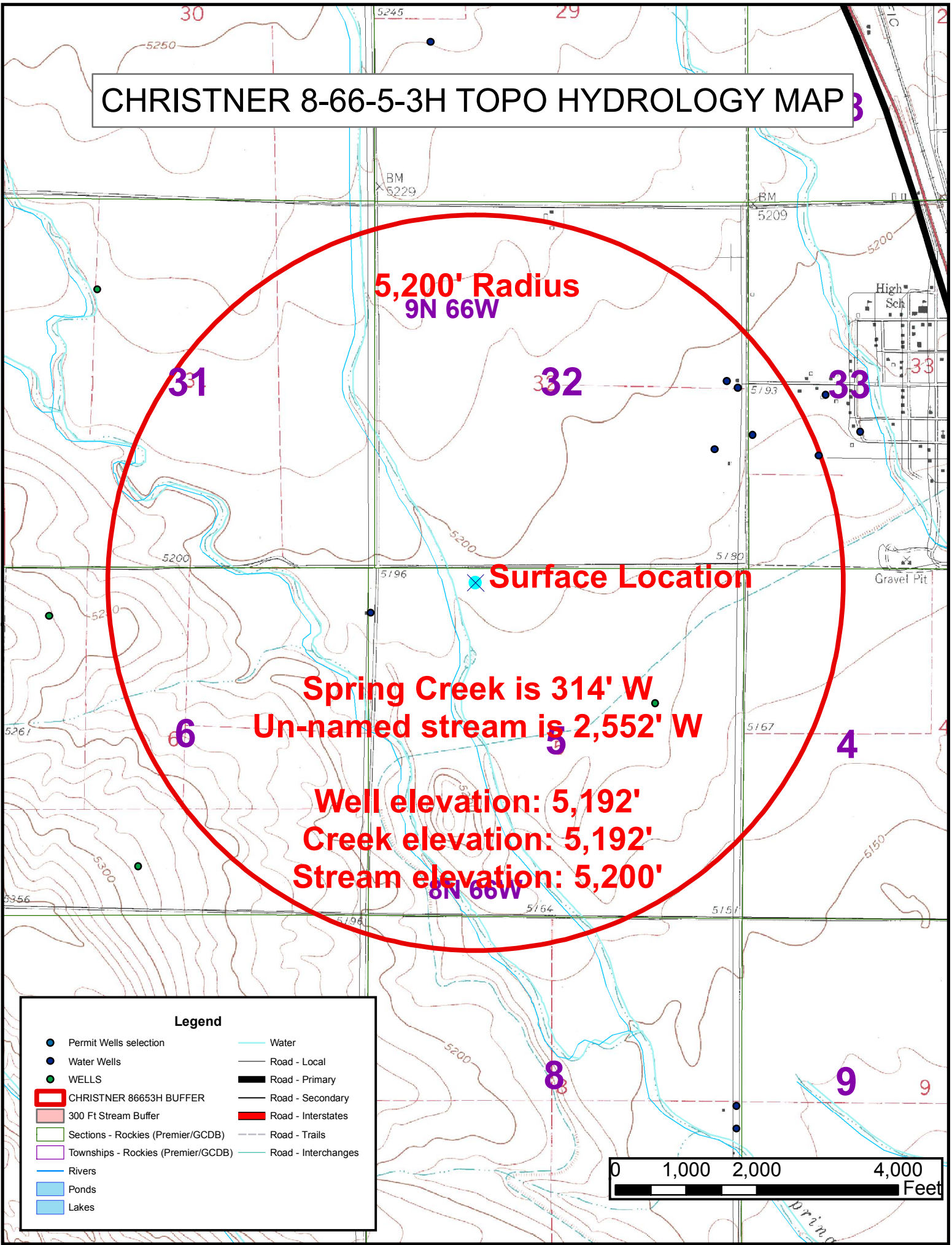

5,200' Radius
9N 66W

Surface Location

Spring Creek is 314' W
Un-named stream is 2,552' W

Well elevation: 5,192'
Creek elevation: 5,192'
Stream elevation: 5,200'

Legend

Permit Wells selection

Water Wells

WELLS

CHRISTNER 86653H BUFFER

300 Ft Stream Buffer

Sections - Rockies (Premier/GCDB)

Townships - Rockies (Premier/GCDB)

Rivers

Ponds

Lakes

Water

Road - Local

Road - Primary

Road - Secondary

Road - Trails

Road - Interchanges