

# REFERENCE AREA MAP

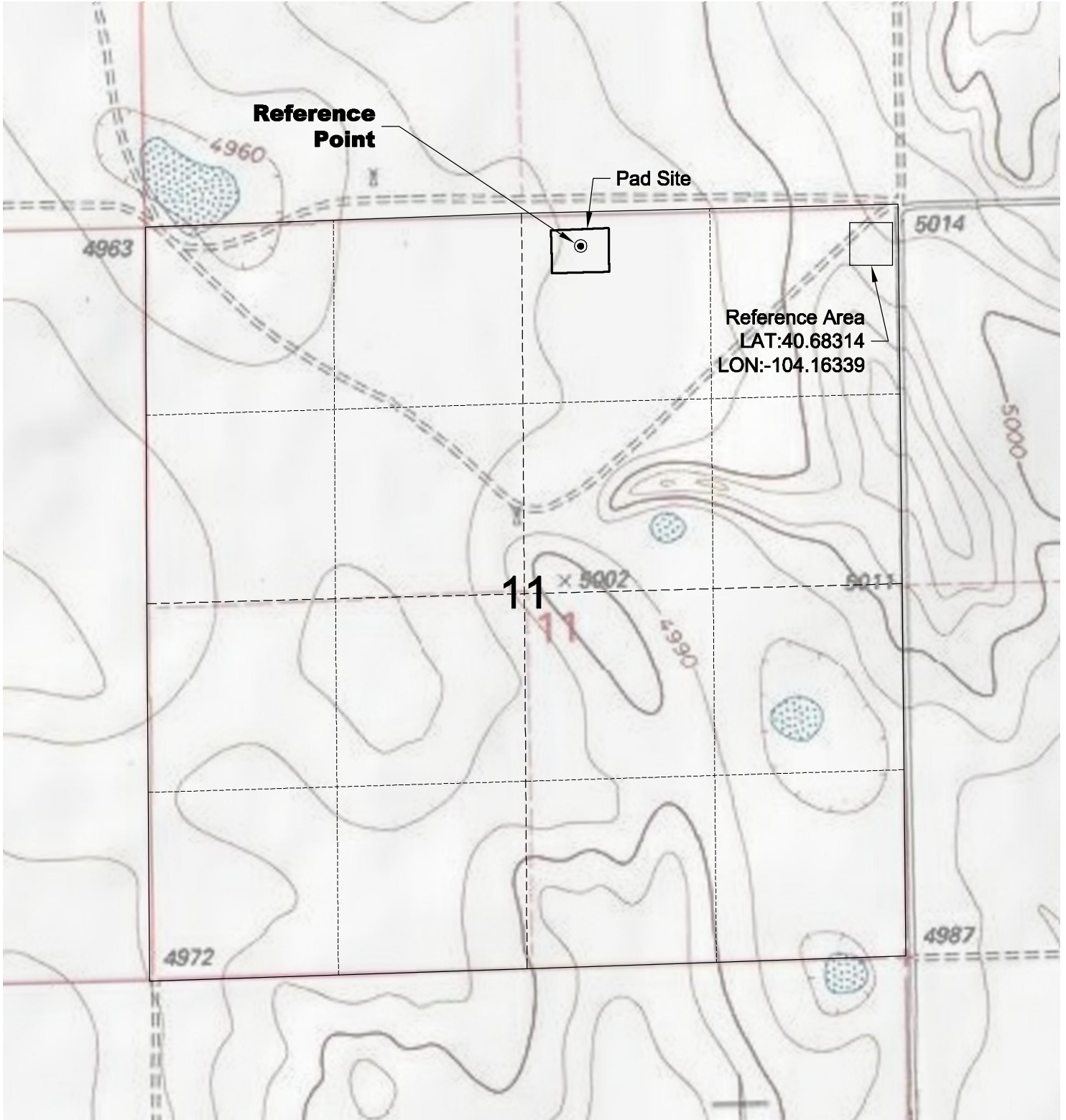

Reference Area  
LAT:40.68314  
LON:-104.16339

DWG: G:\GEO SURV\WeldzNorth\Carrizo 110004\Wellplats\Vawter 11-31-8-61\Vawter 11-31-8-61 F2A.dwg USER: MTC DATE: Jun 02, 2011 3:33pm



North

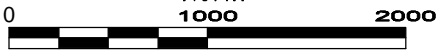

Graphic Scale in Feet  
1 inch = 1000 feet

6/2/11



LAND SURVEYING AND MAPPING  
LAFAYETTE - WINTER PARK  
Ph 303 666 0379 Fx 303 665 6320

CARRIZO OIL & GAS, INC  
VAWTER 11-31-8-61 PAD

NW1/4 NE1/4 SEC. 11 T8N R61W  
6th PM WELD COUNTY COLORADO