

Lat40°, Inc. 1635 Foxtrail Drive, Suite 325 Loveland, CO 970-776-3321

LOCATION DRAWING

ROHN PC LD09-01

SECTION: 9
TOWNSHIP: 9N
RANGE: 58W

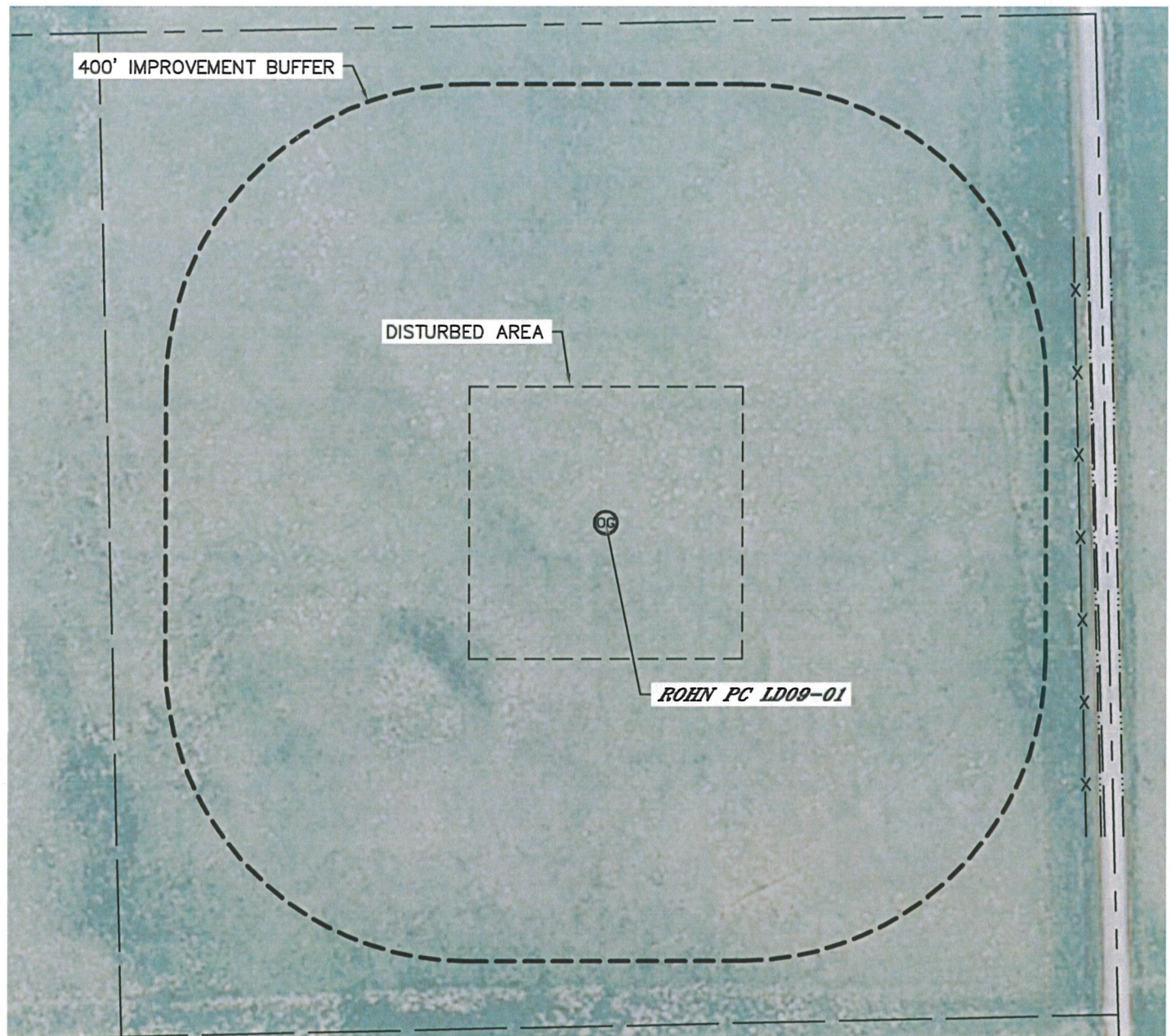

IMPROVEMENTS:

NOTE: NO IMPROVEMENTS WITHIN 400' OF DISTURBED AREA

NEAREST: BUILDING 5280+, PUBLIC ROAD 645' E (CR 127),
ABOVE GROUND UTILITY 3750' NE, RAILROAD 5280+, PROPERTY LINE 660' N & E

