

EOG RESOURCES, INC.
SNOW DRAW #05-07H
SECTION 7, T8N, R60W, 6th P.M.

PROCEED IN A SOUTHWESTERLY, THEN NORTHWESTERLY, THEN WESTERLY DIRECTION FROM RAYMER, COLORADO ALONG HIGHWAY 14 APPROXIMATELY 14.1 MILES TO THE JUNCTION OF THIS ROAD AND COUNTY ROAD 103 TO THE NORTH; TURN RIGHT AND PROCEED IN A NORTHERLY DIRECTION APPROXIMATELY 3.0 MILES TO THE JUNCTION OF THIS ROAD AND COUNTY ROAD 96 TO THE WEST; TURN LEFT AND PROCEED IN A WESTERLY DIRECTION APPROXIMATELY 2.3 MILES TO THE BEGINNING OF THE PROPOSED ACCESS FOR THE SNOW DRAW #13-20H TO THE SOUTH; FOLLOW ROAD FLAGS IN A SOUTHERLY, THEN SOUTHEASTERLY, THEN SOUTHERLY DIRECTION APPROXIMATELY 5,497' TO THE BEGINNING OF THE PROPOSED ACCESS TO THE WEST; FOLLOW ROAD FLAGS IN A WESTERLY DIRECTION APPROXIMATELY 237' TO THE PROPOSED LOCATION.

TOTAL DISTANCE FROM RAYMER, COLORADO TO THE PROPOSED LOCATION IS APPROXIMATELY 20.5 MILES.

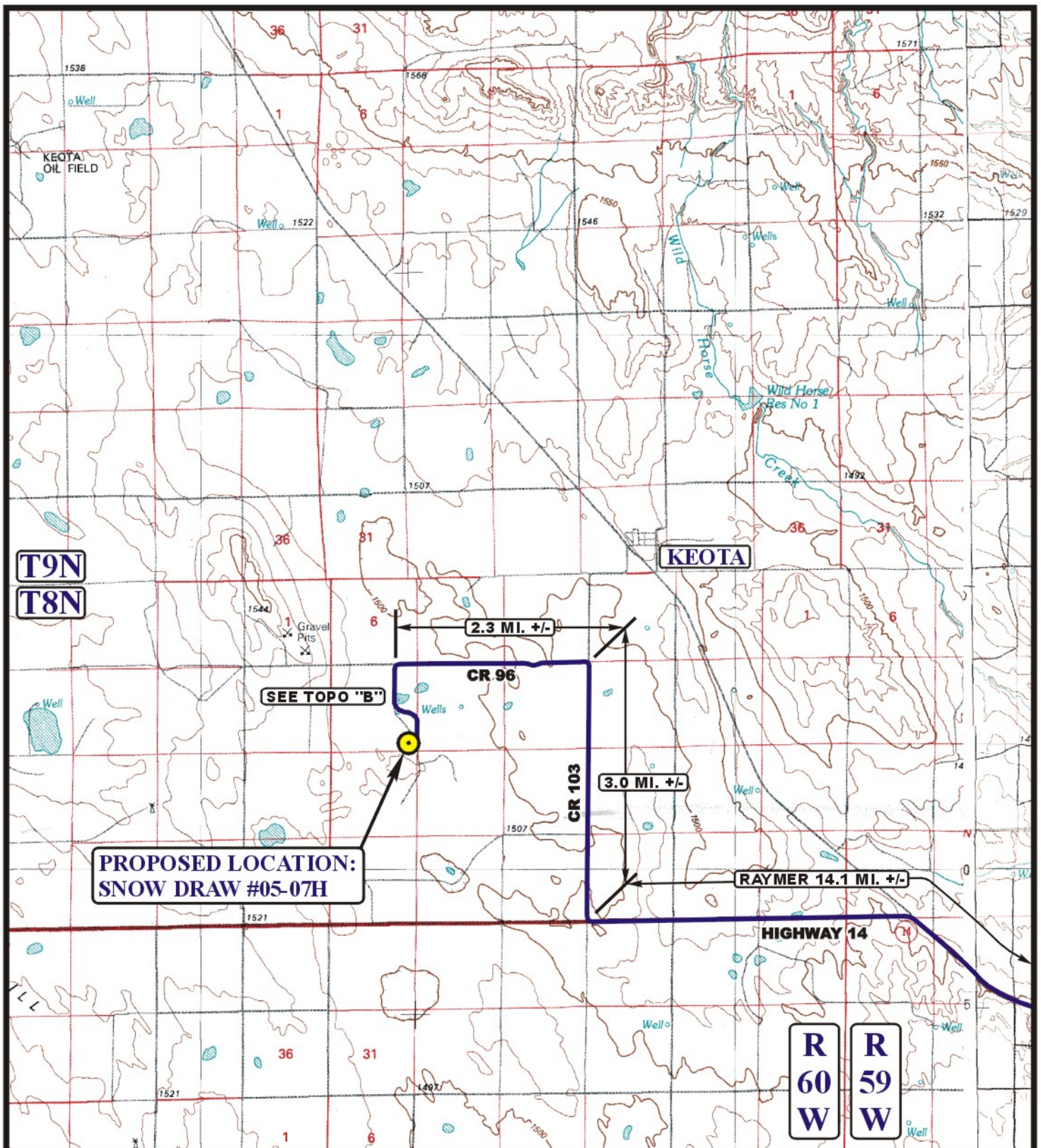

LEGEND:

PROPOSED LOCATION

EOG RESOURCES, INC.

SNOW DRAW #05-07H
SECTION 7, T8N, R60W, 6th P.M.
501' FSL 501' FEL



Uintah Engineering & Land Surveying
85 South 200 East Vernal, Utah 84078
(435) 789-1017 * FAX (435) 789-1813



ACCESS ROAD
MAP

03 02 11
MONTH DAY YEAR

SCALE: 1:100,000 **DRAWN BY: C.A.G.** **REVISED: 00-00-00**



