



KERR MCGEE OIL & GAS ONSHORE LP

Location: COLORADO Slot: SLOT#01 PEAKS 36-2 (1272'FSL & 1647'FWL)
Field: WELD COUNTY (KERR MCGEE) Well: PEAKS 36-2
Facility: SEC.02-T1N-R68W Wellbore: PEAKS 36-2 PWB



Plot reference wellpath is PEAKS 36-2 (REV-C.O) PWP	
True vertical depths are referenced to XTREME 12 (RKB)	Grid System: NAD83 / Lambert Colorado State Planes, Northern Zone (501), US feet
Measured depths are referenced to XTREME 12 (RKB)	North Reference: True north
XTREME 12 (RKB) to Mean Sea Level: 5046 feet	Scale: True distance
Mean Sea Level to Mud line (Facility: SEC.02-T1N-R68W): 0 feet	Depths are in feet
Coordinates are in feet referenced to Slot	
Created by: cookdarm on 5/18/2011	

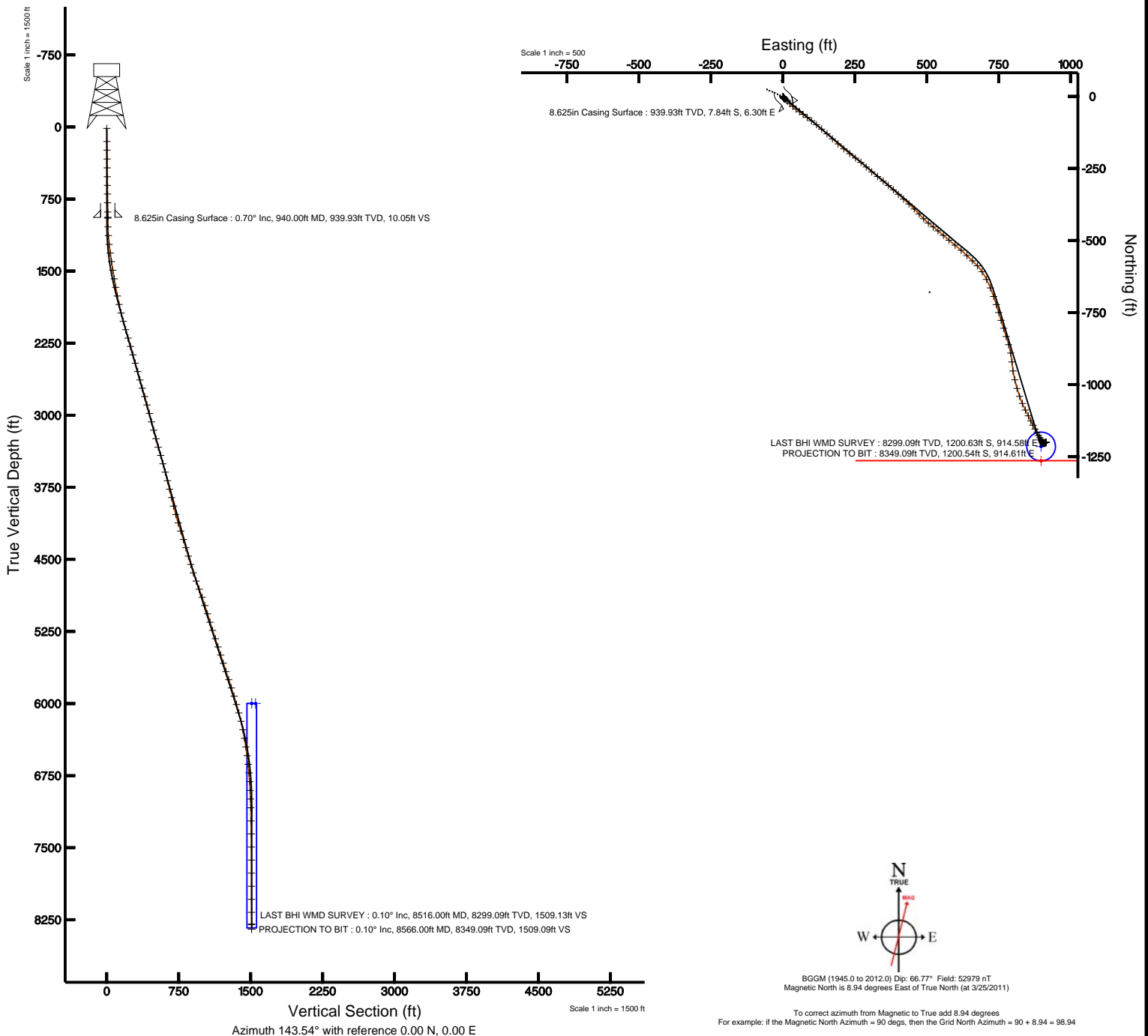



Actual Wellpath Report

PEAKS 36-2 AWP

Page 1 of 5



INTEQ

REFERENCE WELLPATH IDENTIFICATION

Operator	KERR MCGEE OIL & GAS ONSHORE LP	Slot	SLOT#01 PEAKS 36-2 (1272'FSL & 1647'FWL)
Area	COLORADO	Well	PEAKS 36-2
Field	WELD COUNTY (KERR MCGEE)	Wellbore	PEAKS 36-2 AWP
Facility	SEC.02-T1N-R68W		

REPORT SETUP INFORMATION

Projection System	NAD83 / Lambert Colorado State Planes, Northern Zone (501), US feet	Software System	WellArchitect® 2.0
North Reference	True	User	Cookdanm
Scale	0.999961	Report Generated	5/18/2011 at 1:09:03 PM
Convergence at slot	0.34° East	Database/Source file	Denver Server/PEAKS_36-2_AWP.xml

WELLPATH LOCATION

	Local coordinates		Grid coordinates		Geographic coordinates	
	North[ft]	East[ft]	Easting[USft]	Northing[USft]	Latitude	Longitude
Slot Location	0.00	0.00	3147172.67	1271172.18	40°04'35.616"N	104°58'26.681"W
Facility Reference Pt			3147172.67	1271172.18	40°04'35.616"N	104°58'26.681"W
Field Reference Pt			3197771.84	1268891.29	40°04'09.600"N	104°47'36.000"W

WELLPATH DATUM

Calculation method	Minimum curvature	XTREME 12 (RKB) to Facility Vertical Datum	5046.00ft
Horizontal Reference Pt	Slot	XTREME 12 (RKB) to Mean Sea Level	5046.00ft
Vertical Reference Pt	XTREME 12 (RKB)	Facility Vertical Datum to Mud Line (Facility)	0.00ft
MD Reference Pt	XTREME 12 (RKB)	Section Origin	N 0.00, E 0.00 ft
Field Vertical Reference	Mean Sea Level	Section Azimuth	143.54°



Actual Wellpath Report

PEAKS 36-2 AWP

Page 2 of 5



INTEQ

REFERENCE WELLPATH IDENTIFICATION

Operator	KERR MCGEE OIL & GAS ONSHORE LP	Slot	SLOT#01 PEAKS 36-2 (1272'FSL & 1647'FWL)
Area	COLORADO	Well	PEAKS 36-2
Field	WELD COUNTY (KERR MCGEE)	Wellbore	PEAKS 36-2 AWP
Facility	SEC.02-T1N-R68W		

WELLPATH DATA (92 stations) † = interpolated/extrapolated station

MD [ft]	Inclination [°]	Azimuth [°]	TVD [ft]	Vert Sect [ft]	North [ft]	East [ft]	DLS [°/100ft]	Comments
0.00†	0.000	113.400	0.00	0.00	0.00	0.00	0.00	
15.00	0.000	113.400	15.00	0.00	0.00	0.00	0.00	
150.00	0.700	113.400	150.00	0.71	-0.33	0.76	0.52	
241.00	0.700	145.000	240.99	1.75	-1.00	1.59	0.42	
333.00	0.600	143.900	332.98	2.79	-1.85	2.19	0.11	
425.00	0.700	176.600	424.98	3.75	-2.80	2.51	0.41	
517.00	0.800	196.700	516.97	4.60	-3.98	2.36	0.30	
607.00	1.000	158.700	606.96	5.74	-5.31	2.46	0.68	
698.00	0.900	117.200	697.95	7.14	-6.38	3.39	0.75	
789.00	0.800	109.500	788.94	8.31	-6.92	4.62	0.17	
885.00	0.700	122.900	884.93	9.41	-7.46	5.75	0.21	
949.00	0.700	126.400	948.93	10.15	-7.90	6.39	0.07	
1040.00	1.800	133.000	1039.90	12.09	-9.21	7.88	1.22	
1131.00	3.600	122.900	1130.80	16.17	-11.74	11.33	2.04	
1222.00	5.700	135.900	1221.50	23.32	-16.53	16.87	2.57	
1312.00	8.500	135.900	1310.80	34.35	-24.52	24.61	3.11	
1403.00	9.300	130.900	1400.70	48.19	-34.17	34.85	1.22	
1494.00	9.300	127.800	1490.51	62.44	-43.49	46.22	0.55	
1585.00	9.700	127.800	1580.26	76.90	-52.69	58.08	0.44	
1675.00	10.800	126.400	1668.82	92.25	-62.34	70.86	1.25	
1766.00	11.500	127.100	1758.10	109.10	-72.88	84.96	0.78	
1857.00	12.700	128.100	1847.08	127.45	-84.52	100.07	1.34	
1948.00	14.800	129.900	1935.47	148.39	-98.15	116.86	2.35	
2038.00	15.600	130.200	2022.32	171.33	-113.33	134.92	0.89	
2129.00	16.300	132.700	2109.82	195.78	-129.89	153.65	1.08	
2220.00	16.300	132.000	2197.16	220.84	-147.10	172.53	0.22	
2311.00	17.200	131.300	2284.30	246.50	-164.52	192.12	1.01	
2402.00	16.700	129.900	2371.34	272.35	-181.79	212.26	0.71	
2492.00	17.100	128.500	2457.46	297.70	-198.32	232.54	0.63	
2583.00	15.200	126.400	2544.86	322.02	-213.73	252.61	2.18	
2674.00	15.500	129.900	2632.62	345.24	-228.61	271.54	1.07	
2764.00	16.400	133.000	2719.15	369.42	-244.99	290.06	1.38	
2855.00	16.200	128.800	2806.50	394.33	-261.71	309.35	1.31	
2946.00	16.500	128.800	2893.82	419.10	-277.76	329.32	0.33	
3037.00	15.700	129.600	2981.25	443.55	-293.70	348.87	0.91	
3128.00	14.400	131.700	3069.13	466.57	-309.08	366.81	1.55	
3218.00	15.200	129.600	3156.14	488.98	-324.05	384.26	1.07	
3309.00	15.000	133.100	3244.00	512.14	-339.70	402.05	1.03	
3400.00	15.800	132.700	3331.73	535.89	-356.14	419.75	0.89	
3490.00	17.000	132.400	3418.07	560.83	-373.33	438.47	1.34	
3581.00	15.600	134.100	3505.41	585.96	-390.81	457.09	1.63	
3672.00	15.000	137.300	3593.19	609.74	-407.98	473.86	1.14	
3763.00	13.700	136.200	3681.34	632.13	-424.42	489.30	1.46	
3854.00	14.800	127.500	3769.55	653.99	-439.27	505.99	2.64	
3944.00	13.100	130.600	3856.90	674.98	-452.91	522.85	2.06	



Actual Wellpath Report

PEAKS 36-2 AWP

Page 3 of 5



INTEQ

REFERENCE WELLPATH IDENTIFICATION			
Operator	KERR MCGEE OIL & GAS ONSHORE LP	Slot	SLOT#01 PEAKS 36-2 (1272'FSL & 1647'FWL)
Area	COLORADO	Well	PEAKS 36-2
Field	WELD COUNTY (KERR MCGEE)	Wellbore	PEAKS 36-2 AWP
Facility	SEC.02-T1N-R68W		

WELLPATH DATA (92 stations)								
MD [ft]	Inclination [°]	Azimuth [°]	TVD [ft]	Vert Sect [ft]	North [ft]	East [ft]	DLS [°/100ft]	Comments
4035.00	14.200	127.800	3945.33	695.78	-466.46	539.50	1.41	
4126.00	16.500	131.300	4033.08	719.15	-481.83	558.03	2.72	
4217.00	16.800	130.600	4120.26	744.60	-498.92	577.73	0.40	
4307.00	18.300	128.500	4206.07	770.92	-516.18	598.66	1.81	
4398.00	17.100	131.000	4292.76	797.78	-533.85	619.94	1.56	
4489.00	17.600	134.100	4379.62	824.42	-552.21	639.92	1.15	
4580.00	16.200	132.700	4466.69	850.46	-570.39	659.13	1.60	
4670.00	15.500	137.300	4553.27	874.74	-587.74	676.51	1.60	
4761.00	18.500	145.400	4640.30	901.27	-608.57	692.96	4.19	
4852.00	20.700	154.200	4726.04	931.51	-634.94	708.16	4.04	
4943.00	21.200	156.600	4811.02	963.35	-664.52	721.70	1.09	
5033.00	20.000	161.600	4895.28	993.84	-694.07	733.02	2.37	
5124.00	18.400	162.300	4981.21	1022.23	-722.52	742.30	1.78	
5215.00	18.500	163.700	5067.53	1049.38	-750.06	750.72	0.50	
5306.00	17.800	162.300	5154.01	1076.11	-777.16	759.00	0.91	
5396.00	19.500	162.600	5239.28	1103.33	-804.60	767.67	1.89	
5487.00	18.800	162.600	5325.24	1131.55	-833.09	776.60	0.77	
5578.00	19.300	163.700	5411.26	1159.52	-861.52	785.21	0.68	
5668.00	19.800	169.300	5496.08	1187.21	-890.77	792.21	2.15	
5759.00	20.000	174.500	5581.65	1214.44	-921.41	796.57	1.96	
5850.00	20.600	172.100	5667.00	1241.84	-952.76	800.26	1.13	
5941.00	20.200	164.400	5752.31	1270.59	-983.75	806.68	2.98	
6032.00	19.200	166.500	5837.98	1299.05	-1013.44	814.40	1.35	
6123.00	17.900	158.400	5924.26	1326.35	-1041.00	823.05	3.17	
6213.00	16.400	158.700	6010.26	1351.98	-1065.69	832.75	1.67	
6304.00	15.700	152.100	6097.72	1376.56	-1088.55	843.18	2.15	
6395.00	13.100	153.100	6185.85	1398.91	-1108.63	853.61	2.87	
6485.00	12.000	155.200	6273.70	1418.13	-1126.22	862.15	1.32	
6576.00	9.100	151.700	6363.16	1434.52	-1141.14	869.53	3.26	
6667.00	9.800	151.000	6452.92	1449.32	-1154.25	876.70	0.78	
6758.00	7.800	151.000	6542.84	1463.13	-1166.43	883.45	2.20	
6849.00	6.200	150.700	6633.16	1474.13	-1176.12	888.85	1.76	
6939.00	4.900	149.200	6722.74	1482.77	-1183.66	893.19	1.45	
7030.00	3.800	152.800	6813.48	1489.62	-1189.68	896.56	1.24	
7121.00	2.600	155.900	6904.33	1494.61	-1194.24	898.78	1.33	
7212.00	1.900	148.200	6995.26	1498.13	-1197.41	900.42	0.84	
7303.00	1.400	146.800	7086.22	1500.74	-1199.62	901.82	0.55	
7439.00	0.900	163.700	7222.20	1503.40	-1202.04	903.03	0.44	
7575.00	0.800	141.200	7358.18	1505.35	-1203.80	903.93	0.25	
7711.00	0.800	76.500	7494.17	1506.67	-1204.32	905.45	0.63	
7847.00	1.400	78.600	7630.15	1507.75	-1203.77	908.00	0.44	
7983.00	1.100	56.400	7766.11	1508.52	-1202.72	910.71	0.41	
8119.00	0.500	63.500	7902.10	1508.69	-1201.73	912.33	0.45	
8255.00	0.400	56.100	8038.10	1508.81	-1201.20	913.26	0.08	
8391.00	0.400	76.500	8174.09	1509.02	-1200.83	914.11	0.10	



Actual Wellpath Report

PEAKS 36-2 AWP

Page 4 of 5



INTEQ

REFERENCE WELLPATH IDENTIFICATION

Operator	KERR MCGEE OIL & GAS ONSHORE LP	Slot	SLOT#01 PEAKS 36-2 (1272'FSL & 1647'FWL)
Area	COLORADO	Well	PEAKS 36-2
Field	WELD COUNTY (KERR MCGEE)	Wellbore	PEAKS 36-2 AWP
Facility	SEC.02-T1N-R68W		

WELLPATH DATA (92 stations)

MD [ft]	Inclination [°]	Azimuth [°]	TVD [ft]	Vert Sect [ft]	North [ft]	East [ft]	DLS [°/100ft]	Comments
8516.00	0.100	22.700	8299.09	1509.13	-1200.63	914.58	0.28	LAST BHI WMD SURVEY
8566.00	0.100	22.700	8349.09	1509.09	-1200.54	914.61	0.00	PROJECTION TO BIT

HOLE & CASING SECTIONS Ref Wellbore: PEAKS 36-2 AWP Ref Wellpath: PEAKS 36-2 AWP

String/Diameter	Start MD [ft]	End MD [ft]	Interval [ft]	Start TVD [ft]	End TVD [ft]	Start N/S [ft]	Start E/W [ft]	End N/S [ft]	End E/W [ft]
12.25in Open Hole	15.00	940.00	925.00	15.00	939.93	0.00	0.00	-7.84	6.30
8.625in Casing Surface	15.00	940.00	925.00	15.00	939.93	0.00	0.00	-7.84	6.30
7.875in Open Hole	940.00	8566.00	7626.00	939.93	8349.09	-7.84	6.30	-1200.54	914.61

TARGETS

Name	MD [ft]	TVD [ft]	North [ft]	East [ft]	Grid East [srv ft]	Grid North [srv ft]	Latitude	Longitude	Shape
PEAKS 36-2 GEO TARGET 50' RADIUS (50'FSL & 2550'FWL, REV-1)		6000.00	-1214.90	897.80	3148077.62	1269962.68	40°04'23.610"N	104°58'15.132"W	circle
PEAKS 36-2 HARDLINE 50'S OF GEO TARGET		6000.00	-1264.90	897.80	3148077.92	1269912.68	40°04'23.116"N	104°58'15.132"W	point

WELLPATH COMPOSITION Ref Wellbore: PEAKS 36-2 AWP Ref Wellpath: PEAKS 36-2 AWP

Start MD [ft]	End MD [ft]	Positional Uncertainty Model	Log Name/Comment	Wellbore
15.00	885.00	NaviTrak (Standard)	SURFACE BHI MWD SURVEYS 12.25 HOLE <150-885>	PEAKS 36-2 AWP
885.00	8516.00	NaviTrak (Standard)	PRODUCTION BHI MWD SURVEY <949-8516>	PEAKS 36-2 AWP
8516.00	8566.00	Blind Drilling (std)	Projection to bit	PEAKS 36-2 AWP



Actual Wellpath Report

PEAKS 36-2 AWP

Page 5 of 5



INTEQ

REFERENCE WELLPATH IDENTIFICATION

Operator	KERR MCGEE OIL & GAS ONSHORE LP	Slot	SLOT#01 PEAKS 36-2 (1272'FSL & 1647'FWL)
Area	COLORADO	Well	PEAKS 36-2
Field	WELD COUNTY (KERR MCGEE)	Wellbore	PEAKS 36-2 AWB
Facility	SEC.02-T1N-R68W		

WELLPATH COMMENTS

MD [ft]	Inclination [°]	Azimuth [°]	TVD [ft]	Comment
8516.00	0.100	22.700	8299.09	LAST BHI WMD SURVEY
8566.00	0.100	22.700	8349.09	PROJECTION TO BIT