

ROWE 13N-27HZ TOPO HYDROLOGY MAP

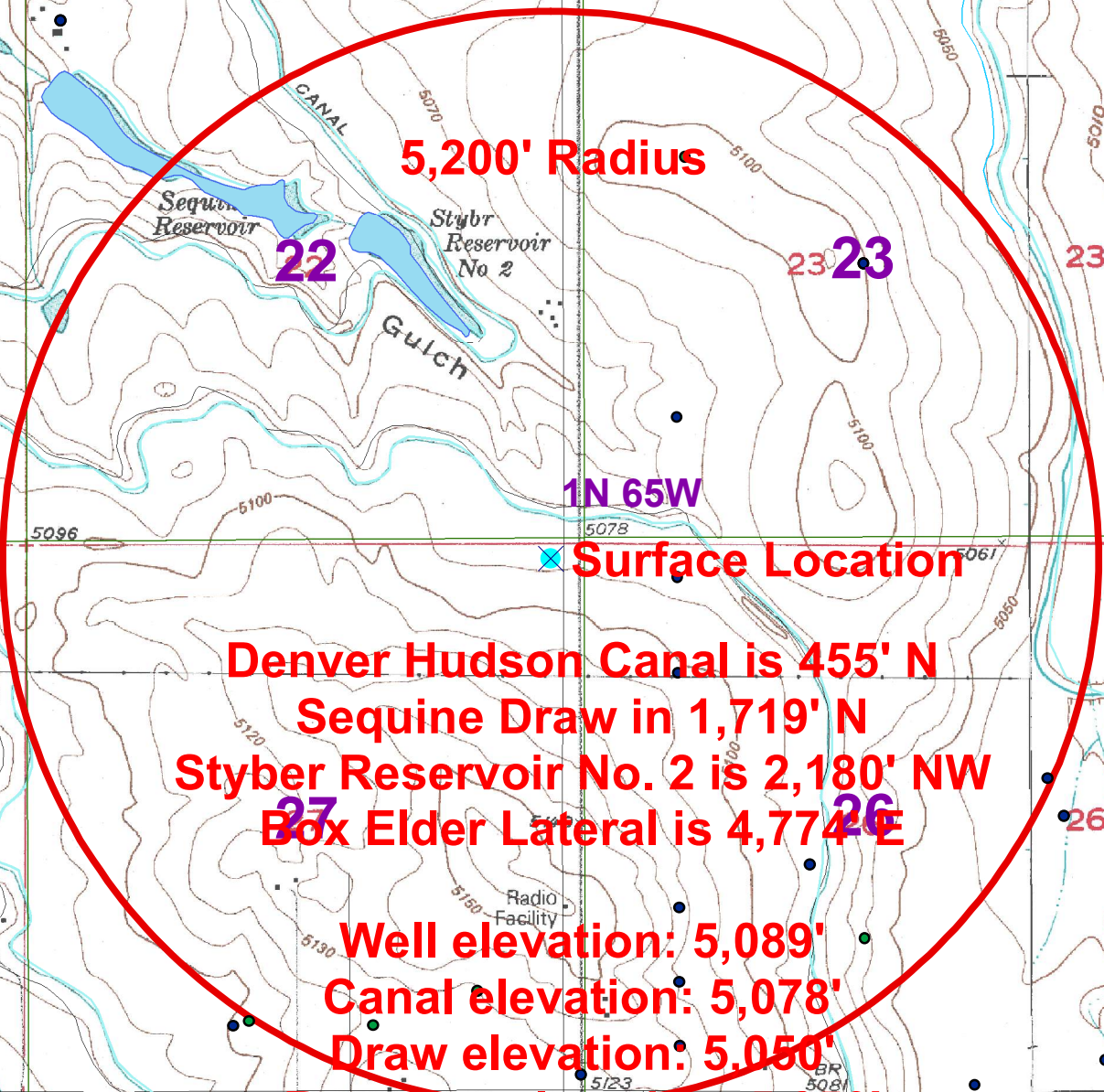

5,200' Radius

Surface Location

1N 65W

Denver Hudson Canal is 455' N
Sequine Draw is 1,719' N
Styber Reservoir No. 2 is 2,180' NW
Box Elder Lateral is 4,774' E

Well elevation: 5,089'
Canal elevation: 5,078'
Draw elevation: 5,050'
Reservoir elevation: 5,050'
Lateral elevation: 5,040'

Legend

| | |
|--------------------------------------|-----------------------|
| ● Permit Wells selection | — Water |
| ● Water Wells | — Road - Local |
| ● WELLS | — Road - Primary |
| ▭ ROWE 13N27HZ BUFFER | — Road - Secondary |
| ▭ 300 Ft Stream Buffer | — Road - Interstates |
| ▭ Sections - Rockies (Premier/GCDB) | — Road - Trails |
| ▭ Townships - Rockies (Premier/GCDB) | — Road - Interchanges |
| — Rivers | |
| — Ponds | |
| — Lakes | |

