

WELL	Federal 28-11H	FIELD	CO, Mesa Co.(NAD83UTM13)	STRUCTURE	Encana 28-09S-96W (PL28SW)
------	-----------------------	-------	---------------------------------	-----------	-----------------------------------

Magnetic Parameters	Model: BGGM 2010	Dip: 65.541°	Date: March 17, 2011	Surface Location	Lat: N 39 14 35.545	North: NAD83 UTM Zone 13N US Feet	Grid Conv: -1.96997873°	Miscellaneous	Slot: Federal 28-11H	TVD Ref: RKB(61078 above MSL)
	Mag Dec: 10.405°	FS: 52103.5eT		Lon: W 108 6 43.823	East: 759217.14 RUS	Scale Fact: 1.00048835		Plan: Federal 28-11H	Lat: R6 on 06-Apr-11	Srvy Date: March 17, 2011

Critical Point	MD	INCL	AZIM	TRIP	SSSEC	NC/SL	ELI/WT	DLS	Target Name	Shape	Major Axis	NC/SL	ELI/WT	TRIP	SSSEC	NC/SL	ELI/WT
Marker M/Line	22.00	0.00	247.00	22.00	0.00	0.00	0.00	0.00	Federal 28-11H	Point	0.00	1426.4077.58	753.932.58	7204.50	3738.15	-2242.07	-5241.99
Ohio Creek (Top Km)	1175.00	0.00	247.00	1175.00	0.00	0.00	0.00	0.00									
Williams Fork Fm	1527.00	0.00	247.00	1527.00	0.00	0.00	0.00	0.00									
Top Gas	2561.00	0.00	247.00	2463.00	0.00	0.00	0.00	0.00									
Coal Ridge (Paludal)	3554.00	0.00	247.00	3554.00	0.00	0.00	0.00	0.00									
Rollins Ss (lies Fm)	3661.00	0.00	247.00	3663.00	0.00	0.00	0.00	0.00									
Corcoran Ss	4112.00	0.00	247.00	4112.00	0.00	0.00	0.00	0.00									
Corcoran Ss	4301.00	0.00	247.00	4301.00	0.00	0.00	0.00	0.00									
Manco A	5016.00	0.00	247.00	5016.00	0.00	0.00	0.00	0.00									
Buck Tongue	5023.00	0.00	247.00	5021.00	0.00	0.00	0.00	0.00									
Tie-In to Pilot	5200.00	0.00	247.00	5200.00	0.00	0.00	0.00	0.00									
Castlegate	5548.00	0.00	247.00	5549.00	0.00	0.00	0.00	0.00									
Manco B	5795.00	0.00	247.00	5795.00	0.00	0.00	0.00	0.00									
Prairie Canyon	6170.00	0.00	247.00	6170.00	0.00	0.00	0.00	0.00									
KOP, Build 5 DLS	6200.00	0.00	247.00	6200.00	0.00	0.00	0.00	0.00									
Hold	6300.00	5.00	247.00	6299.87	4.36	-1.70	-4.01	5.00									
KOP, Build 8 DLS	6750.44	5.00	247.00	6724.72	41.88	-16.36	-38.55	0.00									
Niobrara Fm	7130.09	16.97	247.00	7097.00	183.14	-71.56	-148.58	8.00									
Hold	7818.04	92.00	247.00	7382.05	780.41	-304.93	-718.37	8.00									
Horizontal Target	Inf			7383.00													
Federal 28-11 PBHL/TD	12778.82	92.00	247.00	7204.50	3738.15	-2242.07	-5241.99	0.00									
No. Laminated Silt	Inf			7883.00													



Rev 6



Grid North
Tot Corr (M -> G 12.3745°)
Mag Dec (10.405°)
Grid Conv (-1.96997873°)

<<< W Scale = 1(in):1500(ft) E >>>

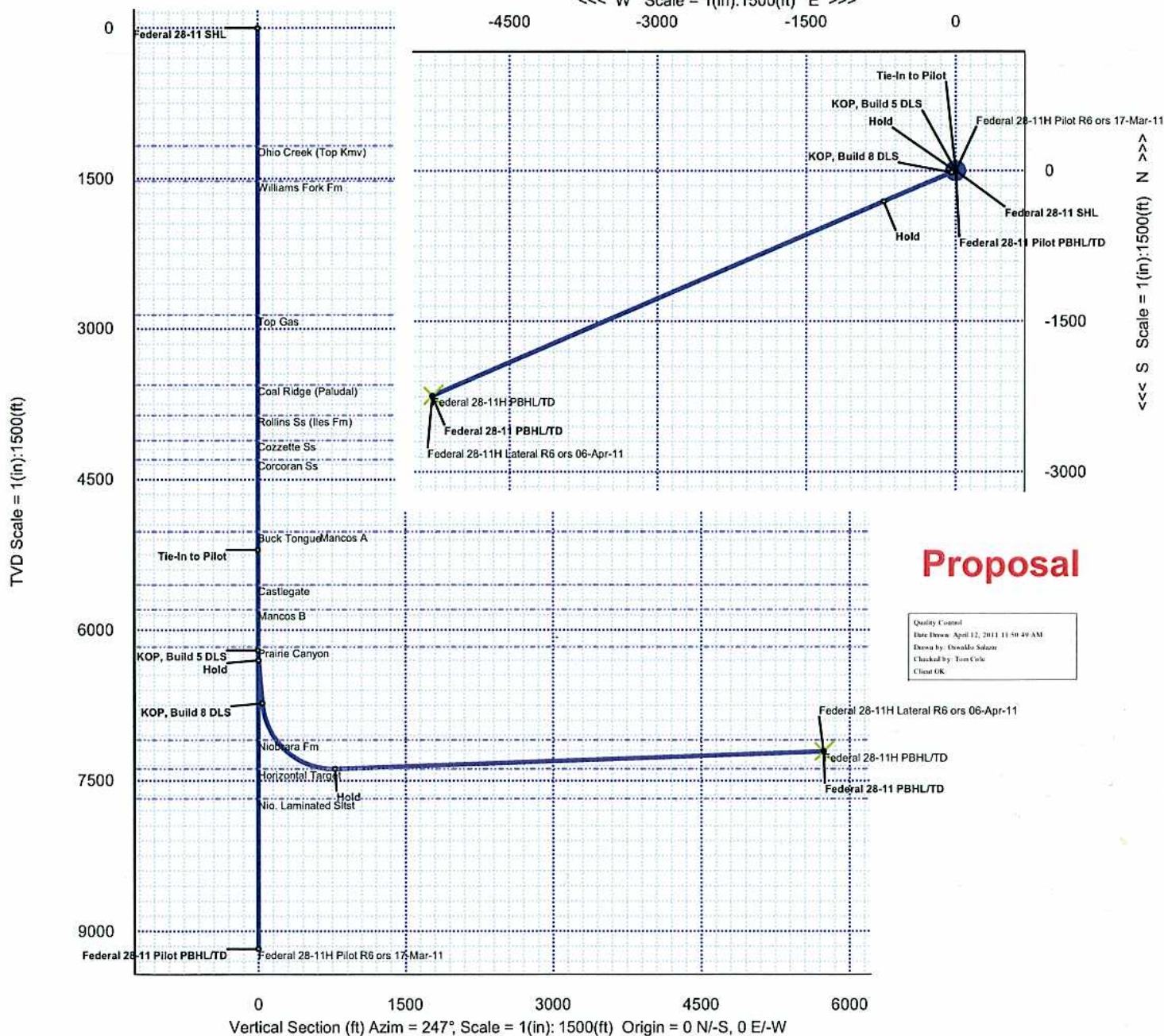

Proposal

Quality Control
Date Drawn: April 12, 2011 11:50:49 AM
Drawn by: Oswald Salazar
Checked by: Tom Cole
Client OK

Federal 28-11H Lateral R6 ors 06-Apr-11 Proposal Report

(Def Plan)

Report Date: April 12, 2011 - 01:21 PM
 Client: EnCana Oil & Gas (USA) Inc.
 Field: CO, Mesa County (NAD 83 UTM 13) EnCana 2010
 Structure / Slot: Encana 28-09S-96W (PL28SW Pad) / Federal 28-11H
 Well: Federal 28-11H
 Borehole: Lateral
 UWI / API#: Unknown / Unknown
 Survey Name: Federal 28-11H Lateral R6 ors 06-Apr-11
 Survey Date: March 17, 2011
 Tort / AHD / DDI / ERD Ratio: 92.005 * / 5738.150 ft / 5.961 / 0.777
 Coordinate Reference System: NAD83 UTM Zone 13N, US Feet
 Location Lat / Long: N 39° 14' 35.54500", W 108° 6' 43.82302"
 Location Grid N/E Y/X: N 14266320.744 ftUS, E 759217.144 ftUS
 CRS Grid Convergence Angle: -1.96997873 *
 Grid Scale Factor: 1.00048835

Survey / DLS Computation: Minimum Curvature / Lubinski
 Vertical Section Azimuth: 247.000 * (Grid North)
 Vertical Section Origin: 0.000 ft, 0.000 ft
 TVD Reference Datum: RKB
 TVD Reference Elevation: 6107.000 ft above MSL
 Seabed / Ground Elevation: 6085.000 ft above MSL
 Magnetic Declination: 10.405 *
 Total Field Strength: 52103.495 nT
 Magnetic Dip Angle: 65.541 *
 Declination Date: March 17, 2011
 Magnetic Declination Model: BGGM 2010
 North Reference: Grid North
 Grid Convergence Used: -1.970 *
 Total Corr Mag North->Grid North: 12.375 *
 Local Coord Referenced To: Well Head

Comments	MD (ft)	Incl (°)	Azim Grid (°)	TVD (ft)	VSEC (ft)	NS (ft)	EW (ft)	DLS (°/100ft)	Northing (ftUS)	Easting (ftUS)	Latitude (N/S ° ' ")	Longitude (E/W ° ' ")
Federal 28-11 SHL	0.00	0.00	220.00	0.00	0.00	0.00	0.00	N/A	14266320.74	759217.14	N 39 14 35.55	W 108 6 43.82
Marker MudLine	22.00	0.00	247.00	22.00	0.00	0.00	0.00	0.00	14266320.74	759217.14	N 39 14 35.55	W 108 6 43.82
Ohio Creek (Top Kmv)	1175.00	0.00	247.00	1175.00	0.00	0.00	0.00	0.00	14266320.74	759217.14	N 39 14 35.55	W 108 6 43.82
Williams Fork Fm	1527.00	0.00	247.00	1527.00	0.00	0.00	0.00	0.00	14266320.74	759217.14	N 39 14 35.55	W 108 6 43.82
Top Gas	2863.00	0.00	247.00	2863.00	0.00	0.00	0.00	0.00	14266320.74	759217.14	N 39 14 35.55	W 108 6 43.82
Coal Ridge (Paludal)	3558.00	0.00	247.00	3558.00	0.00	0.00	0.00	0.00	14266320.74	759217.14	N 39 14 35.55	W 108 6 43.82
Rollins Ss (Iles Fm)	3863.00	0.00	247.00	3863.00	0.00	0.00	0.00	0.00	14266320.74	759217.14	N 39 14 35.55	W 108 6 43.82
Cozzette Ss	4112.00	0.00	247.00	4112.00	0.00	0.00	0.00	0.00	14266320.74	759217.14	N 39 14 35.55	W 108 6 43.82
Corcoran Ss	4301.00	0.00	247.00	4301.00	0.00	0.00	0.00	0.00	14266320.74	759217.14	N 39 14 35.55	W 108 6 43.82
Mancos A	5016.00	0.00	247.00	5016.00	0.00	0.00	0.00	0.00	14266320.74	759217.14	N 39 14 35.55	W 108 6 43.82
Buck Tongue	5021.00	0.00	247.00	5021.00	0.00	0.00	0.00	0.00	14266320.74	759217.14	N 39 14 35.55	W 108 6 43.82
Tie-In to Pilot	5200.00	0.00	247.00	5200.00	0.00	0.00	0.00	0.00	14266320.74	759217.14	N 39 14 35.55	W 108 6 43.82
	5300.00	0.00	247.00	5300.00	0.00	0.00	0.00	0.00	14266320.74	759217.14	N 39 14 35.55	W 108 6 43.82
	5400.00	0.00	247.00	5400.00	0.00	0.00	0.00	0.00	14266320.74	759217.14	N 39 14 35.55	W 108 6 43.82
	5500.00	0.00	247.00	5500.00	0.00	0.00	0.00	0.00	14266320.74	759217.14	N 39 14 35.55	W 108 6 43.82
Castlegale	5549.00	0.00	247.00	5549.00	0.00	0.00	0.00	0.00	14266320.74	759217.14	N 39 14 35.55	W 108 6 43.82
	5600.00	0.00	247.00	5600.00	0.00	0.00	0.00	0.00	14266320.74	759217.14	N 39 14 35.55	W 108 6 43.82
	5700.00	0.00	247.00	5700.00	0.00	0.00	0.00	0.00	14266320.74	759217.14	N 39 14 35.55	W 108 6 43.82
Mancos B	5795.00	0.00	247.00	5795.00	0.00	0.00	0.00	0.00	14266320.74	759217.14	N 39 14 35.55	W 108 6 43.82
	5800.00	0.00	247.00	5800.00	0.00	0.00	0.00	0.00	14266320.74	759217.14	N 39 14 35.55	W 108 6 43.82
	5900.00	0.00	247.00	5900.00	0.00	0.00	0.00	0.00	14266320.74	759217.14	N 39 14 35.55	W 108 6 43.82
	6000.00	0.00	247.00	6000.00	0.00	0.00	0.00	0.00	14266320.74	759217.14	N 39 14 35.55	W 108 6 43.82
	6100.00	0.00	247.00	6100.00	0.00	0.00	0.00	0.00	14266320.74	759217.14	N 39 14 35.55	W 108 6 43.82
Prairie Canyon	6170.00	0.00	247.00	6170.00	0.00	0.00	0.00	0.00	14266320.74	759217.14	N 39 14 35.55	W 108 6 43.82
KOP, Build 5 DLS	6200.00	0.00	247.00	6200.00	0.00	0.00	0.00	0.00	14266320.74	759217.14	N 39 14 35.55	W 108 6 43.82
Hold	6300.00	5.00	247.00	6299.87	4.36	-1.70	-4.01	5.00	14266319.04	759213.13	N 39 14 35.53	W 108 6 43.87
	6400.00	5.00	247.00	6399.49	13.08	-5.11	-12.04	0.00	14266315.63	759205.10	N 39 14 35.49	W 108 6 43.97
	6500.00	5.00	247.00	6499.11	21.79	-8.51	-20.06	0.00	14266312.23	759197.08	N 39 14 35.45	W 108 6 44.07
	6600.00	5.00	247.00	6598.73	30.51	-11.92	-28.08	0.00	14266308.82	759189.05	N 39 14 35.42	W 108 6 44.17
	6700.00	5.00	247.00	6698.35	39.22	-15.33	-36.10	0.00	14266305.41	759181.02	N 39 14 35.38	W 108 6 44.27
KOP, Build 8 DLS	6730.48	5.00	247.00	6728.72	41.88	-16.36	-38.55	0.00	14266304.37	759178.58	N 39 14 35.37	W 108 6 44.31
	6800.00	10.56	247.00	6797.57	51.29	-20.04	-47.21	8.00	14266300.69	759169.91	N 39 14 35.33	W 108 6 44.41
	6900.00	18.56	247.00	6894.28	76.41	-29.86	-70.34	8.00	14266290.87	759146.78	N 39 14 35.23	W 108 6 44.70
	7000.00	26.56	247.00	6986.55	114.75	-44.83	-105.62	8.00	14266275.89	759111.47	N 39 14 35.07	W 108 6 45.15
	7100.00	34.56	247.00	7072.59	165.55	-64.69	-152.39	8.00	14266256.03	759064.68	N 39 14 34.85	W 108 6 45.73
Niobrara Fm	7130.09	36.97	247.00	7097.00	183.14	-71.56	-168.58	8.00	14266249.15	759048.49	N 39 14 34.78	W 108 6 45.93
	7200.00	42.56	247.00	7150.72	227.84	-89.02	-209.72	8.00	14266231.68	759007.32	N 39 14 34.59	W 108 6 46.45
	7300.00	50.56	247.00	7219.42	300.39	-117.37	-276.51	8.00	14266203.32	758940.50	N 39 14 34.29	W 108 6 47.28
	7400.00	58.56	247.00	7277.35	381.80	-149.18	-351.45	8.00	14266171.49	758865.53	N 39 14 33.95	W 108 6 48.22
	7500.00	66.56	247.00	7323.40	470.47	-183.83	-433.07	8.00	14266136.83	758783.86	N 39 14 33.58	W 108 6 49.24
	7600.00	74.56	247.00	7356.65	564.70	-220.65	-519.81	8.00	14266099.99	758697.08	N 39 14 33.19	W 108 6 50.33
	7700.00	82.56	247.00	7376.46	662.63	-258.91	-609.96	8.00	14266061.71	758606.89	N 39 14 32.78	W 108 6 51.46
	7800.00	90.56	247.00	7382.46	762.37	-297.88	-701.77	8.00	14266022.72	758515.04	N 39 14 32.36	W 108 6 52.61
Hold	7818.04	92.00	247.00	7382.05	780.41	-304.93	-718.37	8.00	14266015.67	758498.43	N 39 14 32.29	W 108 6 52.82
	7900.00	92.00	247.00	7379.19	862.32	-336.93	-793.77	0.00	14265983.65	758422.99	N 39 14 31.95	W 108 6 53.76
	8000.00	92.00	247.00	7375.69	962.25	-375.98	-885.76	0.00	14265944.58	758330.95	N 39 14 31.53	W 108 6 54.91
	8100.00	92.00	247.00	7372.19	1062.19	-415.03	-977.75	0.00	14265905.51	758238.91	N 39 14 31.11	W 108 6 56.06
	8200.00	92.00	247.00	7368.69	1162.13	-454.08	-1069.75	0.00	14265866.44	758146.88	N 39 14 30.70	W 108 6 57.21
	8300.00	92.00	247.00	7365.19	1262.07	-493.13	-1161.74	0.00	14265827.37	758054.84	N 39 14 30.28	W 108 6 58.36
	8400.00	92.00	247.00	7361.69	1362.01	-532.18	-1253.74	0.00	14265788.31	757962.80	N 39 14 29.86	W 108 6 59.52
	8500.00	92.00	247.00	7358.19	1461.95	-571.23	-1345.73	0.00	14265749.24	757870.76	N 39 14 29.44	W 108 7 0.67
	8600.00	92.00	247.00	7354.70	1561.89	-610.28	-1437.72	0.00	14265710.17	757778.72	N 39 14 29.03	W 108 7 1.82
	8700.00	92.00	247.00	7351.20	1661.83	-649.33	-1529.72	0.00	14265671.10	757686.68	N 39 14 28.61	W 108 7 2.97
	8800.00	92.00	247.00	7347.70	1761.77	-688.38	-1621.71	0.00	14265632.03	757594.64	N 39 14 28.19	W 108 7 4.12
	8900.00	92.00	247.00	7344.20	1861.70	-727.43	-1713.71	0.00	14265592.96	757502.60	N 39 14 27.78	W 108 7 5.27
	9000.00	92.00	247.00	7340.70	1961.64	-766.47	-1805.70	0.00	14265553.90	757410.56	N 39 14 27.36	W 108 7 6.43
	9100.00	92.00	247.00	7337.20	2061.58	-805.52	-1897.70	0.00	14265514.83	757318.53	N 39 14 26.94	W 108 7 7.58
	9200.00	92.00	247.00	7333.71	2161.52	-844.57	-1989.69	0.00	14265475.76	757226.49	N 39 14 26.53	W 108 7 8.73
	9300.00	92.00	247.00	7330.21	2261.46	-883.62	-2081.68	0.00	14265436.69	757134.45	N 39 14 26.11	W 108 7 9.88
	9400.00	92.00	247.00	7326.71	2361.40	-922.67	-2173.68	0.00	14265397.62	757042.41	N 39 14 25.69	W 108 7 11.03
	9500.00	92.00	247.00	7323.21	2461.34	-961.72	-2265.67	0.00	14265358.56	756950.37	N 39 14 25.27	W 108 7 12.18
	9600.00	92.00	247.00	7319.71	2561.28	-1000.77	-2357.67	0.00	14265319.49	756858.33	N 39 14 24.86	W 108 7 13.33
	9700.00	92.00	247.00	7316.21	2661.21	-1039.82	-2449.66	0.00	14265280.42	756766.29	N 39 14 24.44	W 108 7 14.49
	9800.00	92.00	247.00	7312.71	2761.15	-1078.87	-2541.65	0.00	14265241.35	756674.25	N 39 14 24.02	W 108 7 15.64
	9900.00	92.00	247.00	7309.22	2861.09	-1117.92	-2633.65	0.00	14265202.28	756582.21	N 39 14 23.61	W 108 7 16.79

Comments	MD (ft)	Incl (°)	Azim Grid (°)	TVD (ft)	VSEC (ft)	NS (ft)	EW (ft)	DLS (°/100ft)	Northing (ftUS)	Easting (ftUS)	Latitude (N/S ° ' ")	Longitude (E/W ° ' ")
	10000.00	92.00	247.00	7305.72	2961.03	-1156.97	-2725.64	0.00	14265163.21	756490.18	N 39 14 23.19 W 108 7 17.94	
	10100.00	92.00	247.00	7302.22	3060.97	-1196.02	-2817.64	0.00	14265124.15	756398.14	N 39 14 22.77 W 108 7 19.09	
	10200.00	92.00	247.00	7298.72	3160.91	-1235.07	-2909.63	0.00	14265085.08	756306.10	N 39 14 22.36 W 108 7 20.24	
	10300.00	92.00	247.00	7295.22	3260.85	-1274.11	-3001.63	0.00	14265046.01	756214.06	N 39 14 21.94 W 108 7 21.39	
	10400.00	92.00	247.00	7291.72	3360.79	-1313.16	-3093.62	0.00	14265006.94	756122.02	N 39 14 21.52 W 108 7 22.55	
	10500.00	92.00	247.00	7288.22	3460.72	-1352.21	-3185.61	0.00	14264967.87	756029.98	N 39 14 21.10 W 108 7 23.70	
	10600.00	92.00	247.00	7284.73	3560.66	-1391.26	-3277.61	0.00	14264928.81	755937.94	N 39 14 20.69 W 108 7 24.85	
	10700.00	92.00	247.00	7281.23	3660.60	-1430.31	-3369.60	0.00	14264889.74	755845.90	N 39 14 20.27 W 108 7 26.00	
	10800.00	92.00	247.00	7277.73	3760.54	-1469.36	-3461.60	0.00	14264850.67	755753.86	N 39 14 19.85 W 108 7 27.15	
	10900.00	92.00	247.00	7274.23	3860.48	-1508.41	-3553.59	0.00	14264811.60	755661.83	N 39 14 19.44 W 108 7 28.30	
	11000.00	92.00	247.00	7270.73	3960.42	-1547.46	-3645.58	0.00	14264772.53	755569.79	N 39 14 19.02 W 108 7 29.45	
	11100.00	92.00	247.00	7267.23	4060.36	-1586.51	-3737.58	0.00	14264733.46	755477.75	N 39 14 18.60 W 108 7 30.60	
	11200.00	92.00	247.00	7263.74	4160.30	-1625.56	-3829.57	0.00	14264694.40	755385.71	N 39 14 18.18 W 108 7 31.76	
	11300.00	92.00	247.00	7260.24	4260.23	-1664.61	-3921.57	0.00	14264655.33	755293.67	N 39 14 17.77 W 108 7 32.91	
	11400.00	92.00	247.00	7256.74	4360.17	-1703.66	-4013.56	0.00	14264616.26	755201.63	N 39 14 17.35 W 108 7 34.06	
	11500.00	92.00	247.00	7253.24	4460.11	-1742.70	-4105.55	0.00	14264577.19	755109.59	N 39 14 16.93 W 108 7 35.21	
	11600.00	92.00	247.00	7249.74	4560.05	-1781.75	-4197.55	0.00	14264538.12	755017.55	N 39 14 16.52 W 108 7 36.36	
	11700.00	92.00	247.00	7246.24	4659.99	-1820.80	-4289.54	0.00	14264499.06	754925.52	N 39 14 16.10 W 108 7 37.51	
	11800.00	92.00	247.00	7242.74	4759.93	-1859.85	-4381.54	0.00	14264459.99	754833.48	N 39 14 15.68 W 108 7 38.66	
	11900.00	92.00	247.00	7239.25	4859.87	-1898.90	-4473.53	0.00	14264420.92	754741.44	N 39 14 15.26 W 108 7 39.82	
	12000.00	92.00	247.00	7235.75	4959.81	-1937.95	-4565.53	0.00	14264381.85	754649.40	N 39 14 14.85 W 108 7 40.97	
	12100.00	92.00	247.00	7232.25	5059.74	-1977.00	-4657.52	0.00	14264342.78	754557.36	N 39 14 14.43 W 108 7 42.12	
	12200.00	92.00	247.00	7228.75	5159.68	-2016.05	-4749.51	0.00	14264303.71	754465.32	N 39 14 14.01 W 108 7 43.27	
	12300.00	92.00	247.00	7225.25	5259.62	-2055.10	-4841.51	0.00	14264264.65	754373.28	N 39 14 13.60 W 108 7 44.42	
	12400.00	92.00	247.00	7221.75	5359.56	-2094.15	-4933.50	0.00	14264225.58	754281.24	N 39 14 13.18 W 108 7 45.57	
	12500.00	92.00	247.00	7218.25	5459.50	-2133.20	-5025.50	0.00	14264186.51	754189.20	N 39 14 12.76 W 108 7 46.72	
	12600.00	92.00	247.00	7214.76	5559.44	-2172.25	-5117.49	0.00	14264147.44	754097.17	N 39 14 12.34 W 108 7 47.87	
	12700.00	92.00	247.00	7211.26	5659.38	-2211.29	-5209.48	0.00	14264108.37	754005.13	N 39 14 11.93 W 108 7 49.03	
Federal 28-11H PBHL/TD	12778.82	92.00	247.00	7208.50	5738.15	-2242.07	-5281.99	0.00	14264077.58	753932.58	N 39 14 11.60 W 108 7 49.93	

Survey Type: Def Plan

Survey Error Model: ISCWSA Rev 0 *** 3-D 95.000% Confidence 2.7955 sigma

Survey Program:

MD From (ft)	MD To (ft)	EOU Freq (ft)	Survey Tool Type	Borehole / Survey
0.000	22.000	1/100.000	SLB_MWD-STD-Depth Only	Pilot / Federal 28-11H Pilot R6 ors 17-Mar-11
22.000	5200.000	1/100.000	SLB_MWD-STD	Pilot / Federal 28-11H Pilot R6 ors 17-Mar-11
5200.000	12778.821	1/100.000	SLB_MWD-STD	Lateral / Federal 28-11H Lateral R6 ors 06-Apr-11