

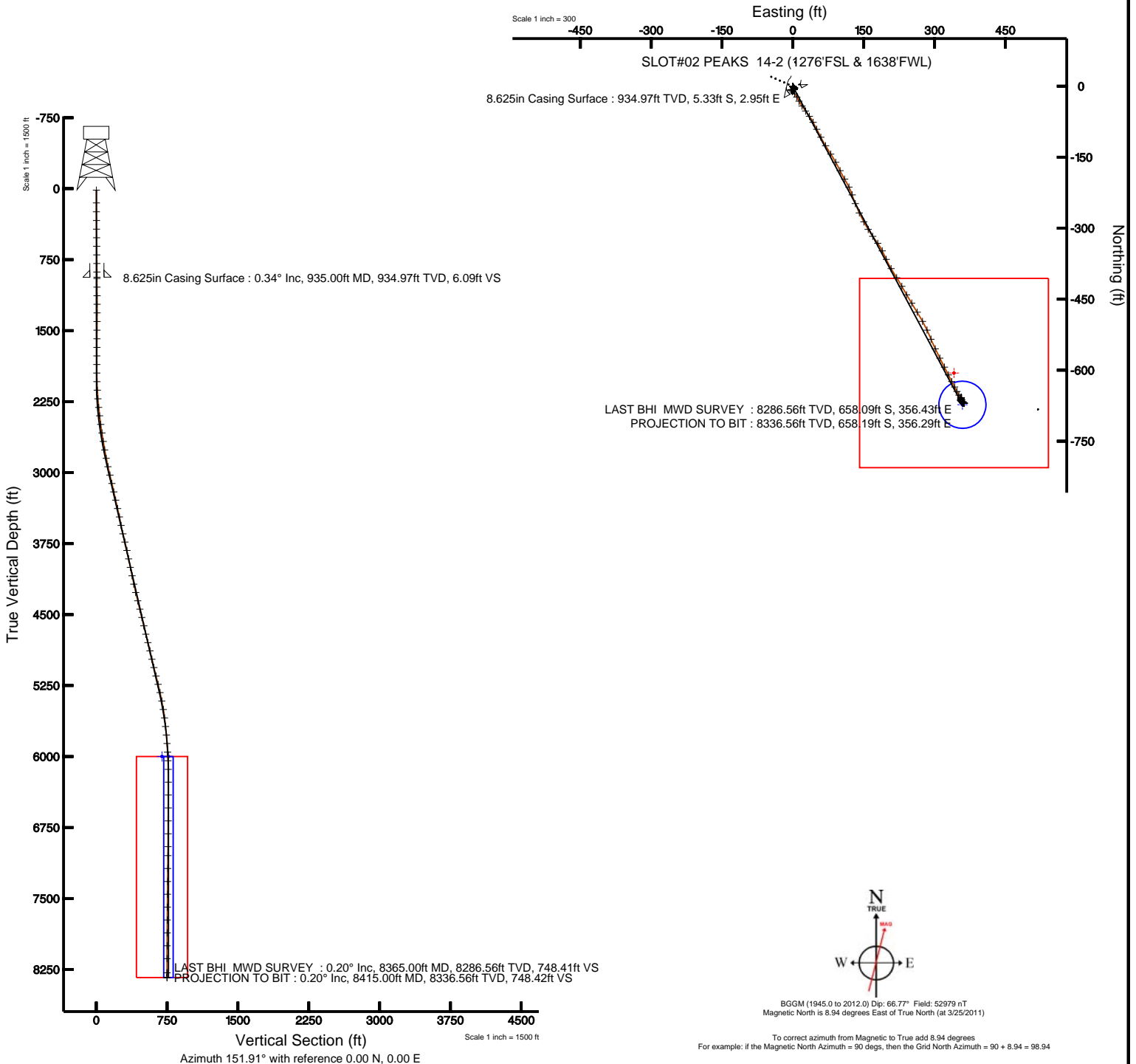

# KERR MCGEE OIL & GAS ONSHORE LP

Location: COLORADO Slot: SLOT#02 PEAKS 14-2 (1276'FSL & 1638'FWL)  
Field: WELD COUNTY (KERR MCGEE) Well: PEAKS 14-2  
Facility: SEC.02-T1N-R68W Wellbore: PEAKS 14-2 PWB

Plot reference wellpath is PEAKS 14-2 (REV-A-1) PWB	Grid System: NAD83 / Lambert Colorado State Planes, Northern Zone (501), US feet
True vertical depths are referenced to XTREME 12 (RKB)	North Reference: True north
Measured depths are referenced to XTREME 12 (RKB)	Scale: True distance
XTREME 12 (RKB) to Mean Sea Level: 6046 feet	Depths are in feet
Mean Sea Level to Mud line (Facility: SEC.02-T1N-R68W): 0 feet	Created by: cookdann on 5/18/2011
Coordinates are in feet referenced to Slot	





# Actual Wellpath Report

PEAKS 14-2 AWP

Page 1 of 5



INTEQ

## REFERENCE WELLPATH IDENTIFICATION

Operator	KERR MCGEE OIL & GAS ONSHORE LP	Slot	SLOT#02 PEAKS 14-2 (1276'FSL & 1638'FWL)
Area	COLORADO	Well	PEAKS 14-2
Field	WELD COUNTY (KERR MCGEE)	Wellbore	PEAKS 14-2 AWP
Facility	SEC.02-T1N-R68W		

## REPORT SETUP INFORMATION

Projection System	NAD83 / Lambert Colorado State Planes, Northern Zone (501), US feet	Software System	WellArchitect® 2.0
North Reference	True	User	Cookdanm
Scale	0.999961	Report Generated	5/18/2011 at 1:51:31 PM
Convergence at slot	0.34° East	Database/Source file	Denver Server/PEAKS_14-2_AWP.xml

## WELLPATH LOCATION

	Local coordinates		Grid coordinates		Geographic coordinates	
	North[ft]	East[ft]	Easting[USft]	Northing[USft]	Latitude	Longitude
Slot Location	4.01	-9.24	3147163.41	1271176.14	40°04'35.656"N	104°58'26.800"W
Facility Reference Pt			3147172.67	1271172.18	40°04'35.616"N	104°58'26.681"W
Field Reference Pt			3197771.84	1268891.29	40°04'09.600"N	104°47'36.000"W

## WELLPATH DATUM

Calculation method	Minimum curvature	XTREME 12 (RKB) to Facility Vertical Datum	5046.00ft
Horizontal Reference Pt	Slot	XTREME 12 (RKB) to Mean Sea Level	5046.00ft
Vertical Reference Pt	XTREME 12 (RKB)	Facility Vertical Datum to Mud Line (Facility)	0.00ft
MD Reference Pt	XTREME 12 (RKB)	Section Origin	N 0.00, E 0.00 ft
Field Vertical Reference	Mean Sea Level	Section Azimuth	151.91°



# Actual Wellpath Report

PEAKS 14-2 AWP

Page 2 of 5



## REFERENCE WELLPATH IDENTIFICATION

Operator	KERR MCGEE OIL & GAS ONSHORE LP	Slot	SLOT#02 PEAKS 14-2 (1276'FSL & 1638'FWL)
Area	COLORADO	Well	PEAKS 14-2
Field	WELD COUNTY (KERR MCGEE)	Wellbore	PEAKS 14-2 AWP
Facility	SEC.02-T1N-R68W		

## WELLPATH DATA (87 stations) † = interpolated/extrapolated station

MD [ft]	Inclination [°]	Azimuth [°]	TVD [ft]	Vert Sect [ft]	North [ft]	East [ft]	DLS [°/100ft]	Comments
0.00†	0.000	242.800	0.00	0.00	0.00	0.00	0.00	
15.00	0.000	242.800	15.00	0.00	0.00	0.00	0.00	
150.00	0.100	242.800	150.00	0.00	-0.05	-0.10	0.07	
243.00	0.500	142.900	243.00	0.40	-0.41	0.07	0.57	
335.00	0.400	122.500	335.00	1.07	-0.91	0.58	0.20	
427.00	0.500	158.300	426.99	1.75	-1.45	1.00	0.32	
518.00	0.500	153.800	517.99	2.54	-2.18	1.32	0.04	
608.00	0.500	152.000	607.99	3.33	-2.88	1.68	0.02	
699.00	0.500	150.700	698.98	4.12	-3.57	2.06	0.01	
790.00	0.500	147.500	789.98	4.92	-4.26	2.47	0.03	
880.00	0.500	159.100	879.98	5.70	-4.95	2.82	0.11	
949.00	0.300	167.800	948.97	6.17	-5.41	2.96	0.30	
1040.00	0.400	174.200	1039.97	6.69	-5.96	3.05	0.12	
1131.00	0.400	214.000	1130.97	7.14	-6.54	2.90	0.30	
1221.00	0.400	228.700	1220.97	7.35	-7.01	2.49	0.11	
1312.00	0.500	256.800	1311.97	7.32	-7.31	1.86	0.26	
1403.00	0.500	271.900	1402.96	7.02	-7.38	1.08	0.14	
1494.00	0.400	276.800	1493.96	6.64	-7.33	0.37	0.12	
1585.00	0.700	260.300	1584.96	6.29	-7.39	-0.49	0.37	
1676.00	0.500	277.200	1675.95	5.88	-7.43	-1.44	0.29	
1766.00	0.600	270.200	1765.95	5.43	-7.38	-2.30	0.13	
1857.00	0.800	283.900	1856.94	4.78	-7.23	-3.39	0.29	
1947.00	0.100	82.100	1946.94	4.39	-7.07	-3.92	0.99	
2038.00	1.900	150.300	2037.92	5.92	-8.37	-3.10	2.05	
2129.00	3.100	138.400	2128.83	9.82	-11.52	-0.71	1.43	
2220.00	4.700	136.600	2219.62	15.81	-16.07	3.48	1.76	
2311.00	5.800	150.300	2310.24	24.01	-22.77	8.32	1.82	
2401.00	6.900	153.100	2399.69	33.96	-31.54	13.02	1.27	
2492.00	8.200	143.300	2489.90	45.84	-41.62	19.37	2.01	
2583.00	8.400	145.000	2579.95	58.85	-52.27	27.06	0.35	
2674.00	9.100	144.300	2669.89	72.59	-63.56	35.07	0.78	
2765.00	9.800	152.100	2759.65	87.46	-76.25	42.90	1.60	
2856.00	11.300	152.400	2849.11	104.12	-90.99	50.65	1.65	
2946.00	12.800	153.100	2937.13	122.91	-107.70	59.25	1.67	
3037.00	13.400	148.200	3025.76	143.51	-125.65	69.37	1.39	
3128.00	13.000	148.200	3114.36	164.25	-143.31	80.32	0.44	
3219.00	12.700	150.000	3203.08	184.46	-160.67	90.71	0.55	
3309.00	13.100	154.500	3290.81	204.54	-178.45	100.05	1.20	
3400.00	12.700	148.900	3379.52	224.83	-196.32	109.66	1.44	
3491.00	11.400	154.200	3468.51	243.81	-212.98	118.74	1.87	
3582.00	11.500	160.500	3557.70	261.76	-229.63	125.68	1.38	
3673.00	13.200	160.100	3646.59	281.02	-247.95	132.25	1.87	
3763.00	14.400	153.500	3734.00	302.38	-267.63	140.74	2.20	
3854.00	12.600	152.800	3822.48	323.61	-286.59	150.33	1.99	
3945.00	10.800	146.800	3911.59	342.03	-302.55	159.53	2.39	



# Actual Wellpath Report

PEAKS 14-2 AWP

Page 3 of 5



INTEQ

## REFERENCE WELLPATH IDENTIFICATION

Operator	KERR MCGEE OIL & GAS ONSHORE LP	Slot	SLOT#02 PEAKS 14-2 (1276'FSL & 1638'FWL)
Area	COLORADO	Well	PEAKS 14-2
Field	WELD COUNTY (KERR MCGEE)	Wellbore	PEAKS 14-2 AWP
Facility	SEC.02-T1N-R68W		

## WELLPATH DATA (87 stations)

MD [ft]	Inclination [°]	Azimuth [°]	TVD [ft]	Vert Sect [ft]	North [ft]	East [ft]	DLS [°/100ft]	Comments
4036.00	11.400	146.100	4000.89	359.47	-317.15	169.22	0.68	
4127.00	11.800	142.900	4090.03	377.61	-332.04	179.84	0.83	
4217.00	11.900	155.200	4178.13	395.96	-347.80	189.29	2.80	
4308.00	13.500	154.200	4266.90	415.95	-365.89	197.85	1.77	
4399.00	14.500	150.300	4355.20	437.95	-385.35	208.12	1.51	
4490.00	14.200	146.800	4443.36	460.45	-404.58	219.87	1.01	
4580.00	13.200	151.400	4530.80	481.73	-422.84	230.84	1.64	
4671.00	13.100	150.300	4619.41	502.42	-440.92	240.92	0.30	
4762.00	13.200	146.100	4708.03	523.07	-458.50	251.82	1.06	
4853.00	15.300	150.300	4796.23	545.41	-477.56	263.57	2.57	
4943.00	13.500	150.700	4883.40	567.78	-497.04	274.59	2.00	
5034.00	12.900	154.200	4971.99	588.55	-515.44	284.21	1.10	
5125.00	13.800	158.400	5060.53	609.49	-534.68	292.63	1.45	
5217.00	14.100	153.800	5149.82	631.59	-554.94	301.62	1.25	
5307.00	14.500	153.100	5237.03	653.81	-574.82	311.56	0.48	
5397.00	12.600	153.100	5324.53	674.89	-593.63	321.10	2.11	
5488.00	10.900	153.100	5413.62	693.42	-610.15	329.48	1.87	
5579.00	9.000	152.400	5503.24	709.14	-624.14	336.67	2.09	
5669.00	7.600	152.100	5592.30	722.13	-635.63	342.72	1.56	
5760.00	6.000	153.100	5682.65	732.91	-645.19	347.68	1.76	
5851.00	4.900	150.000	5773.24	741.55	-652.80	351.78	1.25	
5941.00	3.800	147.100	5862.98	748.36	-658.63	355.32	1.25	
6032.00	3.100	147.500	5953.82	753.82	-663.24	358.28	0.77	
6123.00	2.700	140.800	6044.70	758.37	-666.98	360.96	0.58	
6214.00	0.700	130.600	6135.66	761.00	-669.00	362.74	2.21	
6350.00	0.300	166.800	6271.65	762.11	-669.89	363.45	0.36	
6486.00	0.300	272.600	6407.65	762.28	-670.22	363.17	0.35	
6622.00	0.600	277.500	6543.64	761.68	-670.11	362.11	0.22	
6759.00	0.500	275.100	6680.64	760.94	-669.96	360.81	0.07	
6895.00	0.400	316.500	6816.63	760.15	-669.57	359.89	0.24	
7031.00	0.700	332.600	6952.63	758.86	-668.48	359.18	0.25	
7126.00	0.700	323.900	7047.62	757.71	-667.50	358.57	0.11	
7262.00	0.700	306.300	7183.61	756.14	-666.34	357.41	0.16	
7399.00	0.700	308.800	7320.60	754.61	-665.32	356.08	0.02	
7535.00	0.900	331.700	7456.59	752.78	-663.86	354.93	0.27	
7671.00	0.800	42.000	7592.58	751.39	-662.21	355.06	0.72	
7807.00	0.600	28.000	7728.57	750.67	-660.88	356.03	0.19	
7943.00	0.400	25.100	7864.56	749.99	-659.82	356.56	0.15	
8079.00	0.300	3.700	8000.56	749.40	-659.03	356.79	0.12	
8215.00	0.300	347.500	8136.56	748.75	-658.33	356.73	0.06	
8365.00	0.200	235.700	8286.56	748.41	-658.09	356.43	0.28	LAST BHI MWD SURVEY
8415.00	0.200	235.700	8336.56	748.42	-658.19	356.29	0.00	PROJECTION TO BIT



# Actual Wellpath Report

PEAKS 14-2 AWP

Page 4 of 5



INTEQ

REFERENCE WELLPATH IDENTIFICATION			
Operator	KERR MCGEE OIL & GAS ONSHORE LP	Slot	SLOT#02 PEAKS 14-2 (1276'FSL & 1638'FWL)
Area	COLORADO	Well	PEAKS 14-2
Field	WELD COUNTY (KERR MCGEE)	Wellbore	PEAKS 14-2 AWP
Facility	SEC.02-T1N-R68W		

HOLE & CASING SECTIONS				Ref Wellbore: PEAKS 14-2 AWP		Ref Wellpath: PEAKS 14-2 AWP			
String/Diameter	Start MD [ft]	End MD [ft]	Interval [ft]	Start TVD [ft]	End TVD [ft]	Start N/S [ft]	Start E/W [ft]	End N/S [ft]	End E/W [ft]
12.25in Open Hole	15.00	935.00	920.00	15.00	934.97	0.00	0.00	-5.33	2.95
8.625in Casing Surface	15.00	935.00	920.00	15.00	934.97	0.00	0.00	-5.33	2.95
7.875in Open Hole	935.00	8415.00	7480.00	934.97	8336.56	-5.33	2.95	-658.19	356.29

TARGETS									
Name	MD [ft]	TVD [ft]	North [ft]	East [ft]	Grid East [srv ft]	Grid North [srv ft]	Latitude	Longitude	Shape
PEAKS 14-2 GEO TARGET 50' RADIUS (600'FSL & 2000'FWL, REV-1)		6000.00	-673.21	359.34	3147526.72	1270505.10	40°04'29.003"N	104°58'22.177"W	circle
PEAKS 14-2 LEGAL BOX (267°N,133°S,218°W,182°E OF GEO TARGET)		6000.00	-606.21	341.33	3147508.32	1270571.99	40°04'29.665"N	104°58'22.409"W	square

WELLPATH COMPOSITION			Ref Wellbore: PEAKS 14-2 AWB	Ref Wellpath: PEAKS 14-2 AWP	
Start MD [ft]	End MD [ft]	Positional Uncertainty Model	Log Name/Comment		Wellbore
15.00	880.00	NaviTrak (Standard)	SURFACE BHI MWD SURVEY 12.25 HOLE <150-880>		PEAKS 14-2 AWB
880.00	8365.00	NaviTrak (Standard)	PRODUCTION BHI MWD SURVEYS 7.875 HOLE <949-8365>		PEAKS 14-2 AWB
8365.00	8415.00	Blind Drilling (std)	Projection to bit		PEAKS 14-2 AWB



# Actual Wellpath Report

PEAKS 14-2 AWP

Page 5 of 5



INTEQ

## REFERENCE WELLPATH IDENTIFICATION

Operator	KERR MCGEE OIL & GAS ONSHORE LP	Slot	SLOT#02 PEAKS 14-2 (1276'FSL & 1638'FWL)
Area	COLORADO	Well	PEAKS 14-2
Field	WELD COUNTY (KERR MCGEE)	Wellbore	PEAKS 14-2 AWB
Facility	SEC.02-T1N-R68W		

## WELLPATH COMMENTS

MD [ft]	Inclination [°]	Azimuth [°]	TVD [ft]	Comment
8365.00	0.200	235.700	8286.56	LAST BHI MWD SURVEY
8415.00	0.200	235.700	8336.56	PROJECTION TO BIT