



Lat40°, Inc. 1635 Foxtrail Drive, Suite 325 Loveland, CO 970-776-3321

LOCATION DRAWING

E.L. MINCH 35-4, E.L. MINCH 14-4D

SECTION: 4
TOWNSHIP: 3N
RANGE: 68W

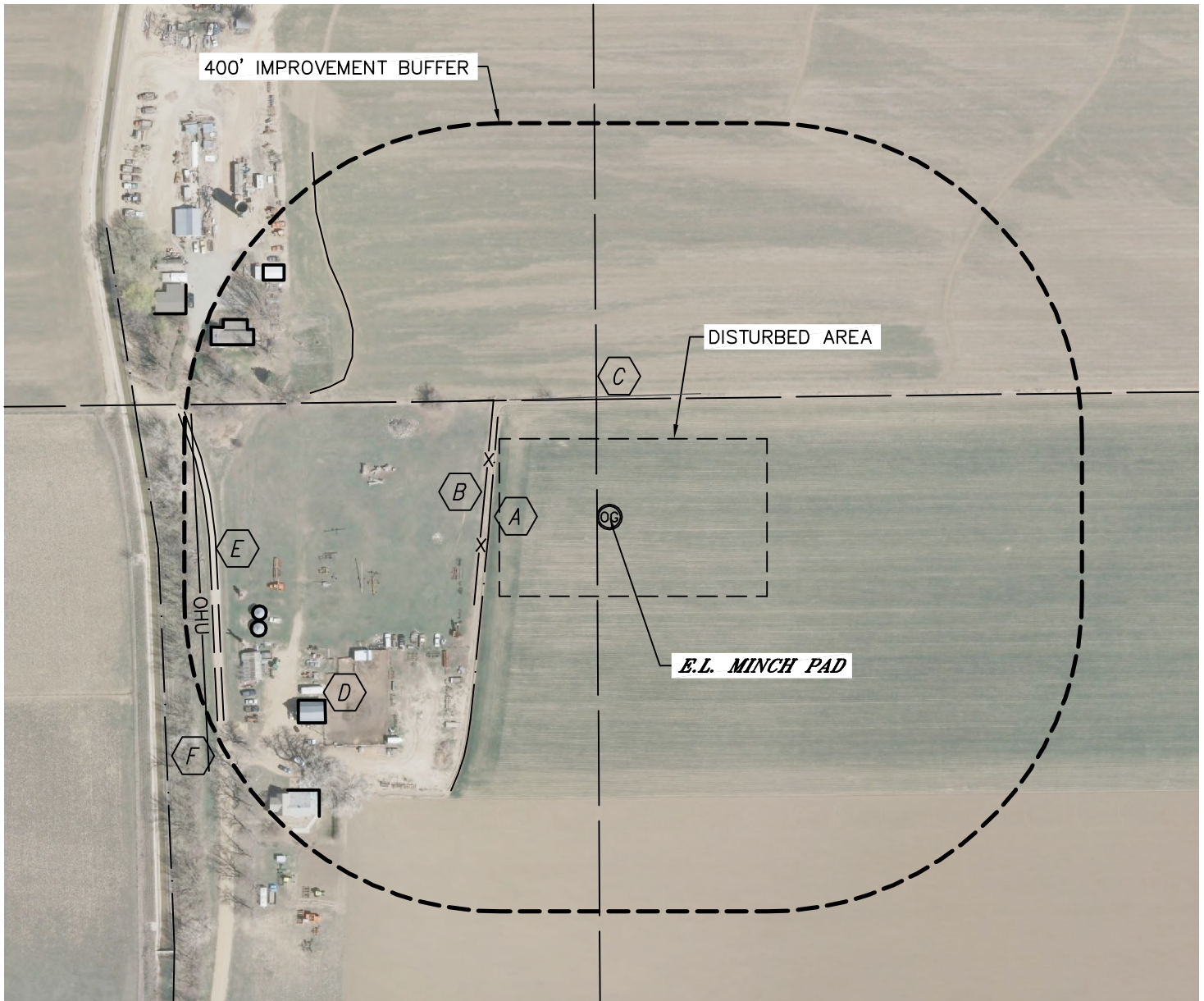

IMPROVEMENTS:
(MEASURED FROM E.L. MINCH 14-4D)

- A** DITCH 151' W, 380' NW
- B** FENCE 160' W
- C** FIELD BREAK 153' N
- D** BUILDINGS 430', 458', 475' & 506 SW,
501' & 511' NW
- E** DRIVEWAY 501' W
- F** OVERHEAD UTILITY 524' W

NEAREST: BUILDING 430' SW, PUBLIC ROAD 913' SW (CR 36),
ABOVE GROUND UTILITY 524' W, RAILROAD 5280'+ SE, PROPERTY LINE 150' N

